

# .100 SERIES 3 ROW PLUG or RECEPTACLE CRIMP REMOVABLE

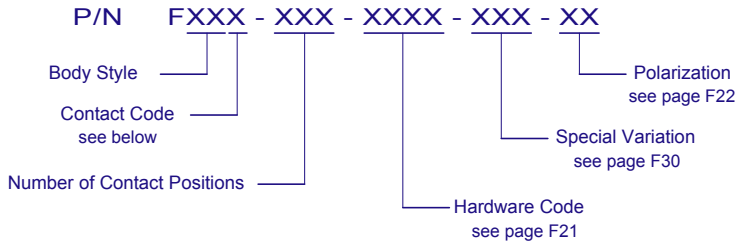

Dimensions					
No. of Cnt's	"A"	"B"	"C"	"D"	"E"
050	2.500	1.800	1.600	2.250	2.000
062	2.900	2.200	2.000	2.650	2.400
080	3.500	2.800	2.600	3.250	3.000
092	3.900	3.200	3.000	3.650	3.400
104	4.300	3.600	3.400	4.050	3.800

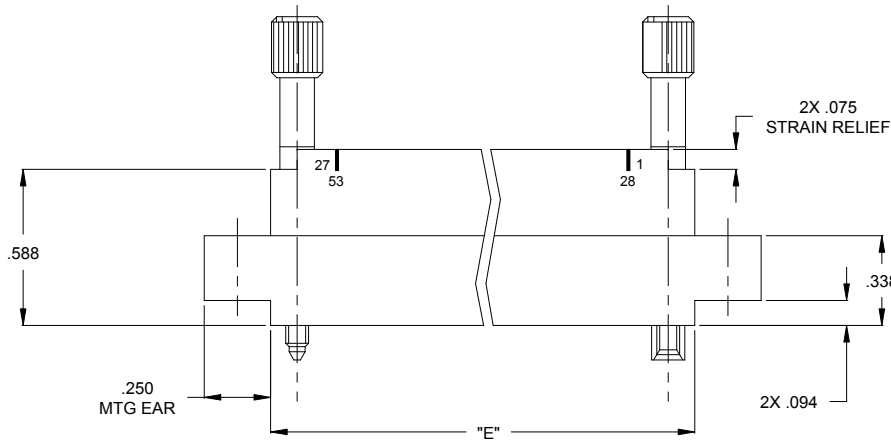
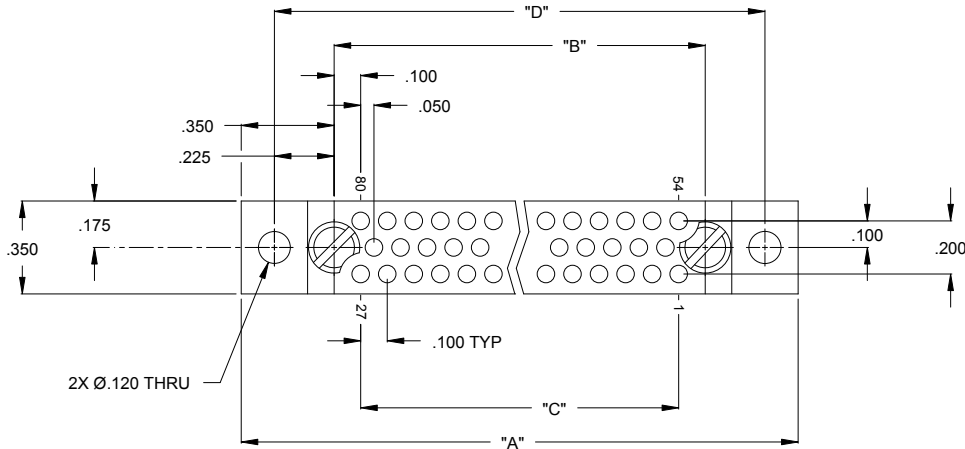

## CONTACT CODES:

P  
PIN CONTACT

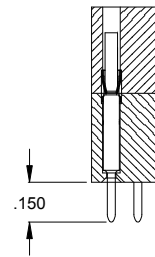

S  
SOCKET CONTACT  
M55302 / 65-02

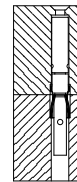

## MATING CONNECTORS:

FLR, FMR

FKM - AS SHOWN WITH STRAIN RELIEF & WITH MTG EARS

FKN - WITH STRAIN RELIEF & WITHOUT MTG EARS

\*NEW\* FKC - WITHOUT STRAIN RELIEF & WITH MTG EARS

\*NEW\* FKX - WITHOUT STRAIN RELIEF & WITHOUT MTG EARS

\*NEW\* FKI - AS SHOWN WITH STRAIN RELIEF & WITH MTG EARS (RECESSED HARDWARE)

\*NEW\* FKK - WITH STRAIN RELIEF & WITHOUT MTG EARS (RECESSED HARDWARE)

\*NEW\* FKO - WITHOUT STRAIN RELIEF & WITH MTG EARS (RECESSED HARDWARE)

\*NEW\* FKQ - WITHOUT STRAIN RELIEF & WITHOUT MTG EARS (RECESSED HARDWARE)

# INCON Inc.

5 Flagstone Drive Hudson, New Hampshire 03051  
Phone 603-595-0550 Fax 603-595-0555 Email: techsupport@inconconnector.com  
Web Address: www.InconConnector.com