

# LED-Arrays

<b>Technical Data</b>	
Housing Material	PC
Ambient Temperature	-40 deg.C... +85 deg.C
Soldering Temperature	260 deg.C ≤ 5 sec.

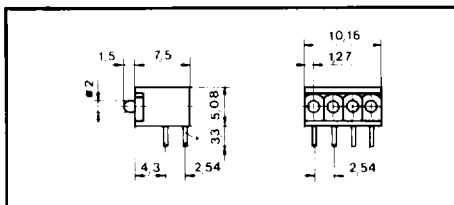

LED Type	Color	Order No.
C12	4 x red	<b>90-RTZ-2041R</b>
C13	4 x yellow	<b>90-RTZ-2041Y</b>
C14	4 x green	<b>90-RTZ-2041G</b>

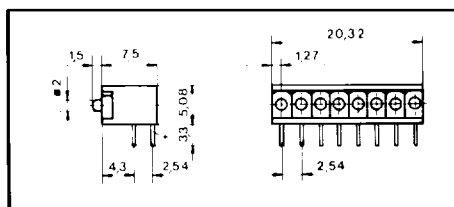
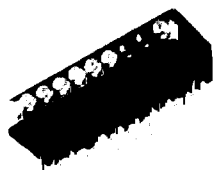

C12	8 x red	<b>90-RTZ-2081R</b>
C13	8 x yellow	<b>90-RTZ-2081Y</b>
C14	8 x green	<b>90-RTZ-2081G</b>

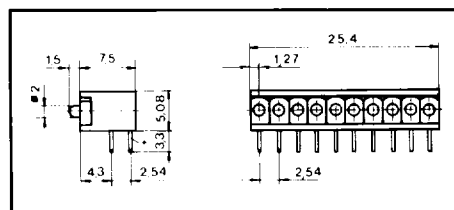

C12	10 x red	<b>90-RTZ-2101R</b>
C13	10 x yellow	<b>90-RTZ-2101Y</b>
C14	10 x green	<b>90-RTZ-2101G</b>

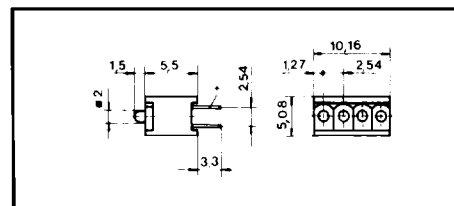

A22	4 x red	<b>90-RTZ-2040R</b>
A23	4 x yellow	<b>90-RTZ-2040Y</b>
A24	4 x green	<b>90-RTZ-2040G</b>

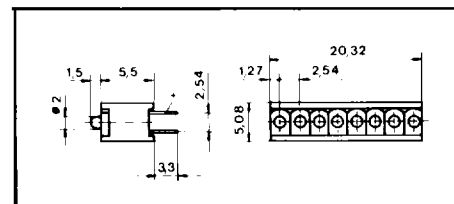
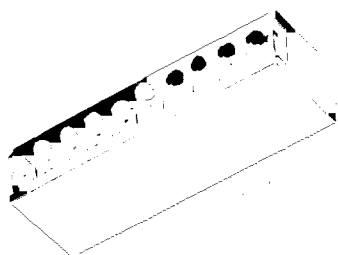

A22	8 x red	<b>90-RTZ-2080R</b>
A23	8 x yellow	<b>90-RTZ-2080Y</b>
A24	8 x green	<b>90-RTZ-2080G</b>

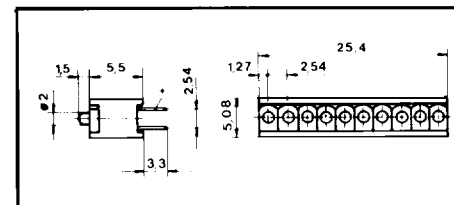

A22	10 x red	<b>90-RTZ-2100R</b>
A23	10 x yellow	<b>90-RTZ-2100Y</b>
A24	10 x green	<b>90-RTZ-2100G</b>