

230-002 Hermetic Receptacle, Jam Nut Mount MIL-DTL-38999 Series II

HOW TO ORDER:

EXAMPLE: 230-002 P 8 - 35 C N

BASIC NO _____

MAT'L & FINISH
 FT = CARBON STEEL, FUSED TIN
 Z1 = CRES, PASSIVATED
 P = CRES, NICKEL FINISH

SHELL SIZE, TABLE I _____

INSERT ARRANGEMENT, Δ
 TABLE II _____

CONTACT STYLE:
 P = PIN, SOLDER CUP
 X = PIN, EYELET
 C = PIN, FEEDTHROUGH

POLARIZATION _____
 A,B,C,D,E (N = NORMAL)

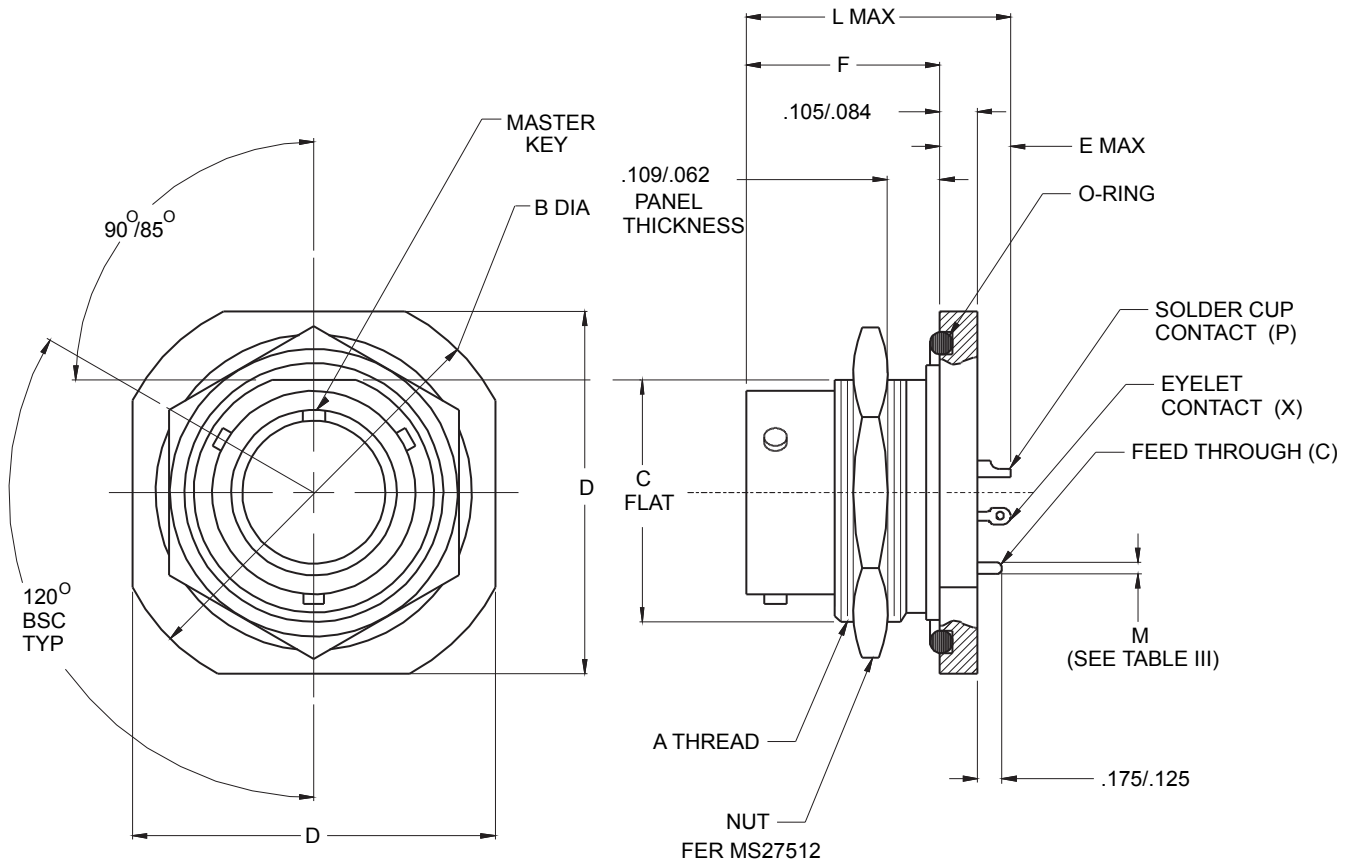
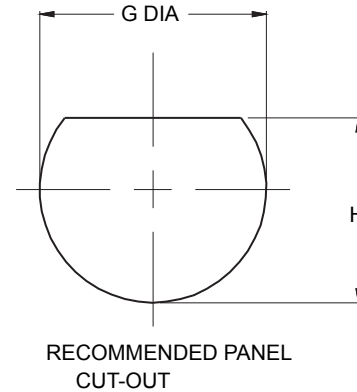

230-002
Hermetic Receptacle, Jam Nut Mount
MIL-DTL-38999 Series II



MIL-DTL-38999

SHELL SIZE	A THREAD CLASS 2A	B DIA ±.016 (0.4)	C FLAT ±.004 (0.1)	D A/F ±.016 (0.4)
8	.875-20 UNEF	1.375 (34.9)	.815 (20.7)	1.25 (31.8)
10	1.000-20 UNEF	1.5 (38.1)	.939 (23.9)	1.375 (34.9)
12	1.125-18 UNEF	1.625 (41.3)	1.063 (27.0)	1.5 (38.1)
14	1.250-18 UNEF	1.75 (44.5)	1.188 (30.2)	1.625 (41.3)
16	1.375-18 UNEF	1.938 (49.2)	1.318 (33.5)	1.781 (45.2)
18	1.500-18 UNEF	2.016 (51.2)	1.438 (36.5)	1.890 (48.0)
20	1.625-18 UNEF	2.141 (54.4)	1.563 (39.7)	2.016 (51.2)
22	1.750-18 UNS	2.265 (57.5)	1.688 (42.9)	2.140 (54.4)
24	1.875-16 UN	2.39 (60.7)	1.813 (46.1)	2.265 (57.5)

SHELL SIZE	E MAX	F ±.005 (0.1)	G DIA ±.005 (0.1)	H ±.005 (0.1)	L MAX
8	.281 (7.1)	.438 (11.1)	.889 (22.6)	.828 (21.0)	.724 (18.4)
10	.281 (7.1)	.438 (11.1)	1.015 (25.8)	.952 (24.2)	.724 (18.4)
12	.281 (7.1)	.438 (11.1)	1.139 (28.9)	1.076 (27.3)	.724 (18.4)
14	.281 (7.1)	.438 (11.1)	1.264 (32.1)	1.201 (30.5)	.724 (18.4)
16	.281 (7.1)	.438 (11.1)	1.389 (35.3)	1.331 (33.8)	.724 (18.4)
18	.281 (7.1)	.438 (11.1)	1.515 (38.5)	1.451 (36.9)	.724 (18.4)
20	.250 (6.4)	.464 (11.8)	1.640 (41.7)	1.576 (40.0)	.719 (18.3)
22	.250 (6.4)	.464 (11.8)	1.745 (44.3)	1.701 (43.2)	.719 (18.3)
24	.250 (6.4)	.464 (11.8)	1.890 (48.0)	1.826 (46.4)	.719 (18.3)

PATTERN	22D	20	16	12
8-98		3		
8-35	6			
10-5		5		
10-98		6		
10-99		7		
10-35	13			
12-3			3	
12-4			4	
12-8		8		
12-98		10		
12-35	22			
14-5			5	
14-15		14	1	
14-18		18		
14-97		8	4	
14-35	37			
16-6				6
16-8			8	
16-26		26		
16-99		21	2	
16-35	55			
18-11			11	
18-28		26	2	
18-30		29	1	
18-32		32		
18-35	66			
18-45	67			
18-96				9
20-16			16	
20-24		24		
20-25		25		
20-27		27		
20-41		41		
20-39		37	2	
20-35	79			
22-35	100			
22-21			21	
22-32		32		
22-34		34		
22-36		36		
22-53		53		
22-97			16	
22-99			11	
22-55		55		
24-35	128			
24-29			29	
24-61		61		
24-4		48	8	
24-19				19
24-24			12	12

NOTES:

- ASSEMBLY IDENTIFIED WITH MANUFACTURER'S NAME AND P/N, SPACE PERMITTING.
- INSERT ARRANGEMENTS IN ACCORDANCE WITH MIL-STD-1560, SEE TABLE II.
- GLENAIR 230-002 RECEPTACLE CONNECTOR IS DESIGNED TO MATE WITH ANY QPL MANUFACTURER'S MIL-C-38999 SERIES I PLUG CONNECTOR HAVING THE SAME INSERT ARRANGEMENT & POLARIZATION.
- MATERIAL/FINISH:
 SHELL, NUT - CRES/PASSIVATED, CARBON STEEL/FUSED TIN OR CRES/
 NICKEL PER QQ-N-290.
 CONTACTS - NICKEL-IRON ALLOY 52/GOLD
 INSULATOR - FUSED VITREOUS GLASS/N.A.
 SEALS - FLUOROSILICONE RUBBER/N.A.
- GLENAIR'S 230-002 SAME AS MS27477.

CONTACT SIZE	Ø M
22D	.011 (0.3)
	.015 (0.4)
	.024 (0.6)
20	.028 (0.7)
	.0635 (1.6)
16	.0615 (1.6)
	.095 (2.4)
12	.093 (2.4)