

## PHONE JACKS ■ DC POWER JACKS, PLUGS(EIAJ RC-5320A)

### PHONE JACKS

■ SPECIFICATIONS Contact Resistance : 30mΩ max.  
 Insulation Resistance : 100MΩ min. at DC 500V  
 Insulation Withstand Voltage: AC 500V for one minute

当製品の詳細カタログがございますので、ご請求下さい。  
 For more information, please ask for a detailed catalogue.

#### 6.5 DIA PJ3 SERIES

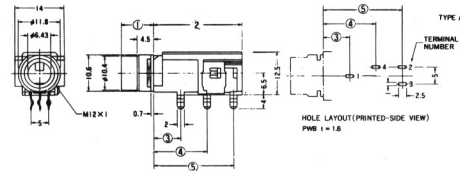
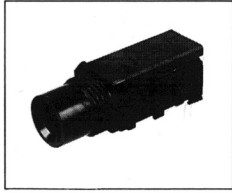

#### 6.5 DIA PJ9 SERIES

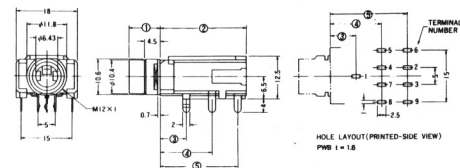
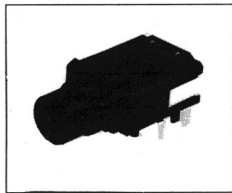

#### 6.5 DIA PX3 SERIES

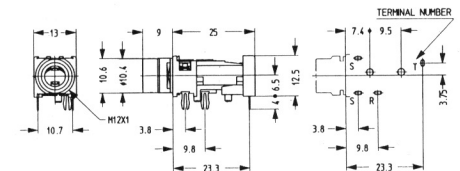
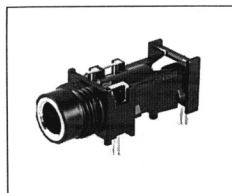

RA Type						2B	3A	3Z	
Type	①	②	③	④	⑤	Sleeve Plating			
A	9	25	7.5	15	22.5	Mold	YKB21-5012	YKB21-5010	YKB21-5074
						Metal	Ni Au	YKB21-5011 YKB21-5176	YKB21-5009 YKB21-5138
B	9	25	7.5	15	22.5	Mold	---	YKB21-5261	YKB21-5262
						Metal	Ni Au	---	YKB21-5265 YKB21-5266
	11.5	22.5	5	12.5	20	Mold	---	YKB21-5806	YKB21-5829
						Metal	Ni Au	---	YKB21-5805 YKB21-5807

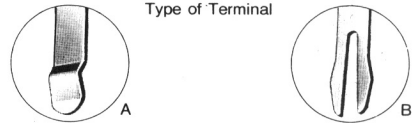

RA Type						2D	2E	3C		
Type	①	②	③	④	⑤	Sleeve Plating				
A	9	25	7.5	15	22.5	Mold	YKB21-5018	YKB21-5076	YKB21-5006	YKB21-5078
						Metal	Ni Au	YKB21-5017 YKB21-5139	YKB21-5075 YKB21-5218	YKB21-5005 YKB21-5153
B	11.5	22.5	5	12.5	20	Mold	---	---	---	---
						Metal	Ni Au	YKB21-5818 YKB21-5819	YKB21-5821 YKB21-5822	YKB21-5824 YKB21-5825

PJ9 シリーズはこじり防止用のボスを設けたタイプを用意しております。  
 \* We offer PJ9 series with boss which prevent the body from becoming pried.

RA Type						3Z	
Type	①	②	③	④	⑤	Sleeve Plating	
B	9	25	3.8	9.8	23.3	Mold	YKB21-5320
						Metal	Ni Au

### DC POWER JACKS, PLUGS(EIAJ RC-5320A)

■ SPECIFICATIONS Contact Resistance : 30mΩ max.  
 Insulation Resistance : 100MΩ min. at DC 500V  
 Insulation Withstand Voltage: AC 500V for one minute  
 Rated current : 2A

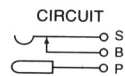

YKB31-0016

TYPE 2



YKB31-0017

TYPE 3



YKB31-0014

TYPE 3



YKB31-0022

TYPE 1



YKB31-0023

TYPE 2



YKB31-0024

TYPE 3



YKB31-0025

TYPE 4

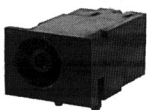

YKB31-0026

TYPE 5

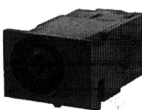

Rated Voltage  
 TYPE1 max.DC3.15  
 2 3.15 < V ≤ 6.3  
 3 6.3 < V ≤ 10.5  
 4 10.5 < V ≤ 13.5  
 5 13.5 < V ≤ 18.0

YKB31-0016, 0017

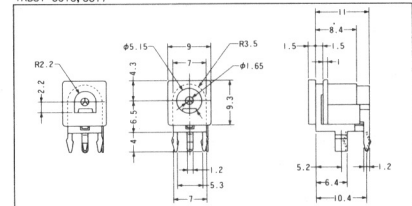

YKB31-0014

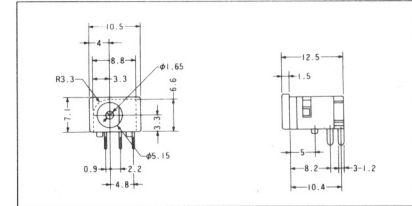

#### DC PLUGS



特徴

1. 電圧区分タイプ1~5迄品揃えております。
2. 形状はストレートタイプとライトアングルタイプの2種類あります。
3. 対応ケーブルは丸形コードと平行コードの2種類あります。

Features

1. According to the voltage classification, from type 1 to 5 are available. (EIAJ)
2. Two kinds of shape, i.e. straight type or right angle type is available.
3. Round cord or flat cord is available as matching cable.