

AMPHENOL

FXH

SNAP-IN FILTERED HEADER

Protect your Board-to-Board signals against radiated and conducted EMI. This header snaps into place without assembly tools and saves real estate.

SPECIFICATIONS

PRODUCT FEATURES:

- COMPACT, CONNECTOR-LIKE ASSEMBLY
- STRESS ISOLATED FILTERS
- .100" OR 2mm PITCH

MATERIALS AND PLATINGS:

INSULATORS	UL94V-0 THERMOPLASTIC
GROUNDING SPRING	COPPER ALLOY, NICKEL PLATED
CONTACTS	COPPER ALLOY, GOLD OVER NICKEL

ELECTRICAL RATINGS:

DVV	500 Vdc
INSULATION RESISTANCE	5 G Ω AT 200 Vdc
CAPACITANCE	+100/-0%
INSERTION LOSS	SEE BACK PAGE
CURRENT RATING	3 A
TEMPERATURE	-55°C / 125°C

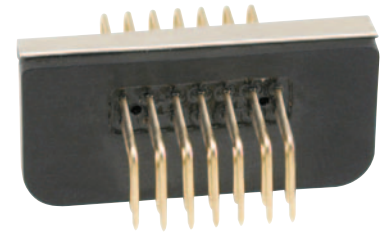

Ask us about custom designs!

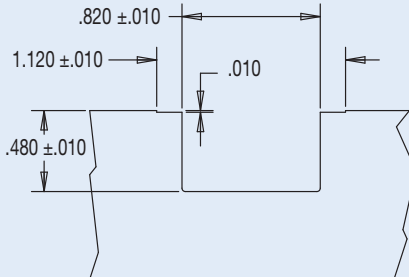
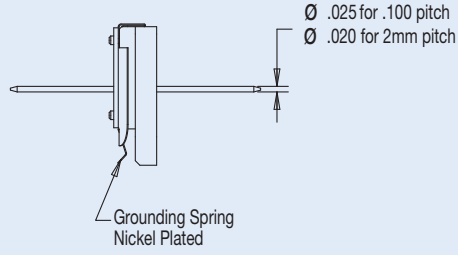
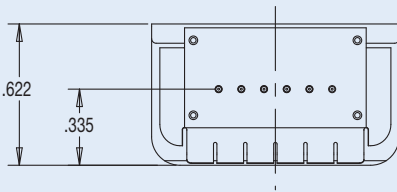
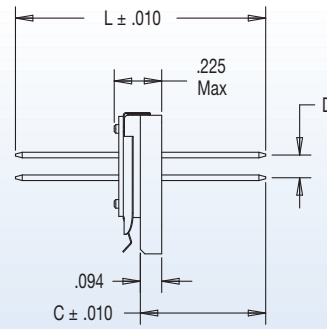
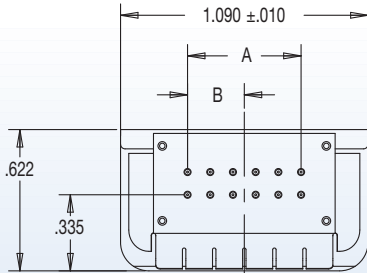

Panel Cutout
.057 ± .002 Thickness

Terminals per row	Terminal Styles 1, 2 & 3			Terminal Styles 3, 4 & 5 [mm]		
	'A'	'B'	'D'	'A'	'B'	'D'
3	0.200	0.150	0.100	4.0	2.0	2.0
4	0.300	0.150		6.0	4.0	
5	0.400	0.250		8.0	4.0	
6	0.500	0.250		10.0	6.0	
7	---	---		12.0	6.0	

Terminal Styles	Dim 'L'	Dim 'C'
1, 4	0.825	0.400
2, 5	1.100	0.550
3	Consult factory	

Visit www.amphenolcanada.com for drawings.

SNAP-IN HEADER

AMPHENOL

FXH

BOLT-IN FILTERED HEADER

This header is tougher than the average filtered array. Ceramic filter elements are isolated from mating and handling loads, which means your assembly works the first time, every time.

Economical, non-metallic designs are also available in the same footprint.

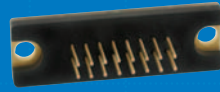

MOUNTING STYLE 0

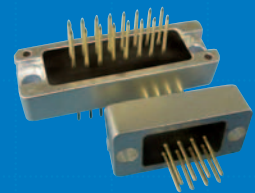

METAL BODY
MOUNTING STYLES 1, 2 & 3

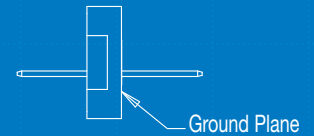
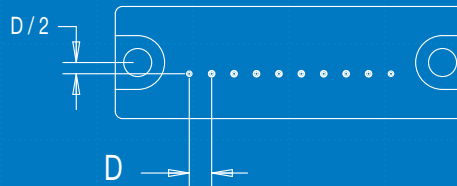
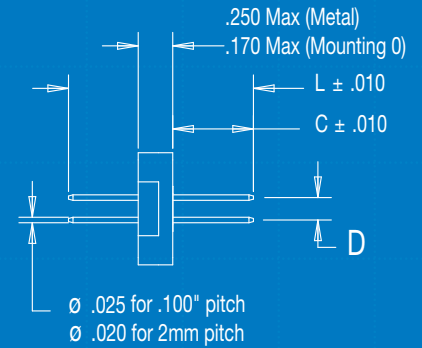
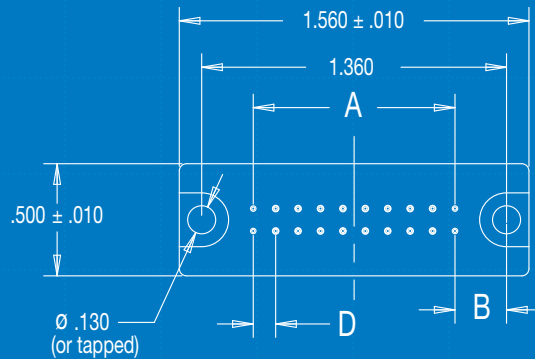

Terminals per row	Terminal Styles 1, 2 & 3			Terminal Styles 3, 4 & 5 [mm]		
	'A'	'B'	'D'	'A'	'B'	'D'
4	0.300	0.530	0.100	6.0	14.27	2.0
5	0.400	0.430		8.0	12.27	
6	0.500	0.430		10.0	12.27	
7	0.600	0.330		12.0	10.27	
8	0.700	0.330		14.0	10.27	
9	0.800	0.230		16.0	8.27	
10	0.900	0.230		18.0	8.27	
11	---	---		20.0	6.27	
12	---	---		22.0	6.27	

Terminal Styles	Dim 'L'	Dim 'C'
1,4	0.825	0.360
2, 5	1.100	0.550
3	Consult factory	

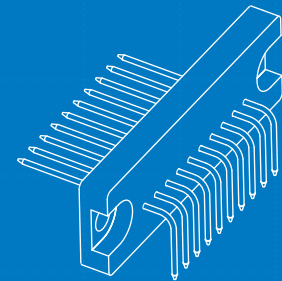

FXH - 20 C252 D 2 0 - 000

NUMBER OF TERMINALS
04 - 24

Capacitance Code
C101 = 100pF (+100%/ -0%)
C252 = 2500pF
C402 = 4000pF
(Last digit of code is the number of zeros after first 2 digits)

ROWS OF CONTACTS
S = Single Row
D = Double Row

DEVIATION
000 = Standard Part
other Deviations as required

MOUNTING STYLE
0 = Thru Hole
1 = Metal Body thru Hole
2 = Metal Body 4-40 UNC
3 = Metal Body M3 x 0.5
9 = Snap-In Header

TERMINATION STYLE
1 = Straight, Ø .025, 0.825 Long
2 = Straight, Ø .025, 1.100 Long
3 = Right Angle bend, built to suit
4 = Straight, 2mm, Ø .020, .825 Long
5 = Straight, 2mm, Ø .020, 1.100 Long

Visit www.amphenolcanada.com for drawings.

TELEPHONE: (416) 291-4401 Fax: (416) 292-0647 E-MAIL: SALES@AMPHENOLCANADA.COM

BOLT-IN HEADER