

PLEASE CHECK WWW.MOLEX.COM FOR LATEST PART INFORMATION

Part Number: [0878970507](#)
Status: **Active**
Overview: [kk](#)
Description: 2.54mm (.100") Pitch KK® Header, Right Angle, Through Hole, Breakaway, 5 Circuits, 2.50µm (98µ") Tin (Sn) Plating, Tray Packaging, 5 Circuits, Void Positions 2, 3, 4, Lead-free

Documents:

[Drawing \(PDF\)](#) [RoHS Certificate of Compliance \(PDF\)](#)
[Product Specification PS-87920-019 \(PDF\)](#)

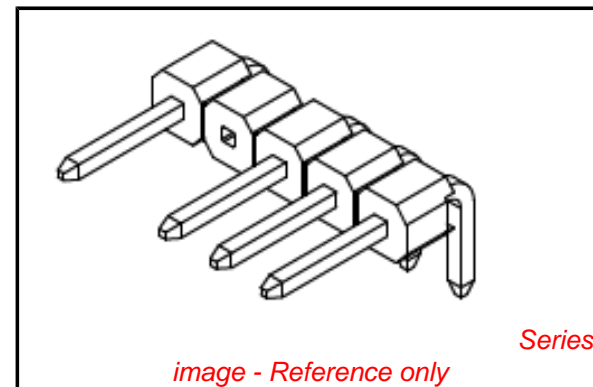

General

Product Family	PCB Headers
Series	87897
Application	Board-to-Board, Wire-to-Board
Overview	kk
Product Name	KK®

Physical

Breakaway	Yes
Circuits (Loaded)	5
Circuits (maximum)	5
Color - Resin	Black
First Mate / Last Break	No
Glow-Wire Compliant	No
Guide to Mating Part	No
Keying to Mating Part	None
Lock to Mating Part	None
Material - Metal	Copper Alloy
Material - Plating Mating	Tin
Material - Resin	Nylon
Number of Rows	1
Orientation	Right Angle
PC Tail Length (in)	0.116 In
PC Tail Length (mm)	2.95 mm
PCB Locator	No
PCB Retention	None
Packaging Type	Tray
Pitch - Mating Interface (in)	0.100 In
Pitch - Mating Interface (mm)	2.54 mm
Pitch - Term. Interface (in)	0.100 In
Pitch - Term. Interface (mm)	2.54 mm
Plating min: Mating (µin)	100
Plating min: Mating (µm)	2.54
Polarized to Mating Part	No
Polarized to PCB	No
Shrouded	No
Stackable	No
Temperature Range - Operating	-55°C to +105°C
Termination Interface: Style	Through Hole

Electrical

Current - Maximum per Contact	3A
Voltage - Maximum	250V

Solder Process Data

EU RoHS

ELV and RoHS Compliant
REACH SVHC
 Not Reviewed
Halogen-Free Status
 Not Reviewed

China RoHS



Need more information on product environmental compliance?

Email productcompliance@molex.com
 For a multiple part number RoHS Certificate of Compliance, [click here](#)

Please visit the [Contact Us](#) section for any non-product compliance questions.

Search Parts in this Series

[87897Series](#)

Mates With

KK® PCB Receptacles [4455](#). SL™ IDT Housings [70430](#) , [7720](#), [70400](#). C-Grid® PCB Receptacles [90147](#), [90148](#)

Duration at Max. Process Temperature (seconds)	10
Lead-free Process Capability	Wave Capable (TH only)
Max. Cycles at Max. Process Temperature	3
Process Temperature max. C	260

Material Info

Reference - Drawing Numbers

Packaging Specification	PK-89990-489
Product Specification	PS-87920-019

This document was generated on 05/25/2010

PLEASE CHECK WWW.MOLEX.COM FOR LATEST PART INFORMATION

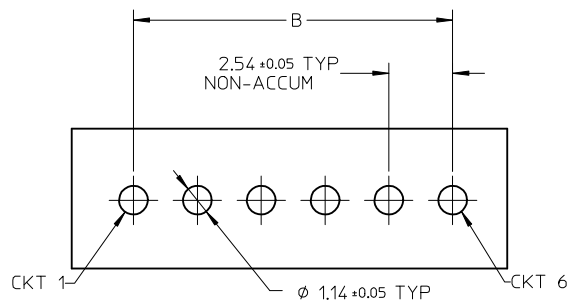
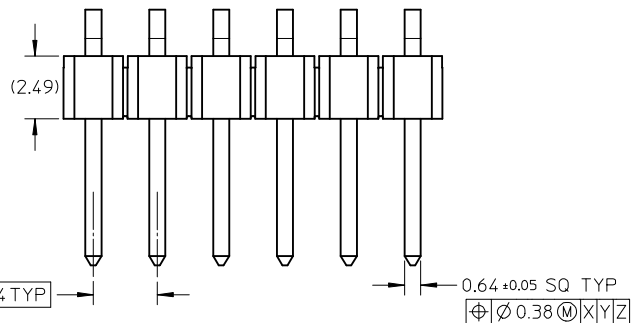

RECOMMENDED PCB LAYOUT

NOTES

- MATERIAL:**
HSG: NYLON, GLASS-FILLED, UL94V-0, COLOR: BLACK
PIN: 0.64MM SQ, COPPER ALLOY
- PLATING TYPE:**
 - GOLD FLASH OVER
1.25µm MIN. NICKEL OVERALL.
 - GOLD FLASH ON CONTACT AND
2.50µm MIN. TIN ON SOLDER TAIL OVER
1.25µm MIN. NICKEL OVERALL.
 - 0.38µm MIN. GOLD PLATE ON CONTACT AND
2.00µm MIN. TIN ON SOLDER TAIL OVER
1.25µm MIN. NICKEL OVERALL.
 - 0.75µm MIN. GOLD PLATE ON CONTACT AND
2.00µm MIN. TIN ON SOLDER TAIL OVER
1.25µm MIN. NICKEL OVERALL.
 - 2.50µm MIN. TIN OVERALL
1.25µm MIN. NICKEL OVERALL
- PRODUCT SPECIFICATION:** PS-87920-019
- PACKAGING TYPE:** SEE TABLE
- WAFER TO BE FLAT WITHIN 0.003 mm/mm**
- IRREGULAR CIRCUIT CUTOFF WITHIN BREAKAWAY SECTION IS PERMISSIBLE. CUTTING OR CHIPPING OF THE MAIN BODY IS NOT ACCEPTABLE**
- RECOMMENDED PCB THICKNESS IS 1.60mm ± 0.10**
- THE ABOVE CKT 6 IS FOR ILLUSTRATION PURPOSE ONLY**
- PACKAGING SPECIFICATION:**
 - TUBE: PK-89990-516
 - TUBE: PK-89990-578
 - TRAY: PK-89990-489
 - BULK: PK-89990-491

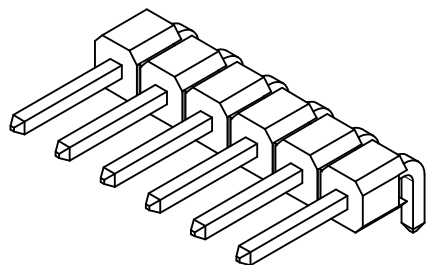
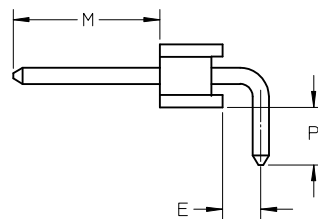
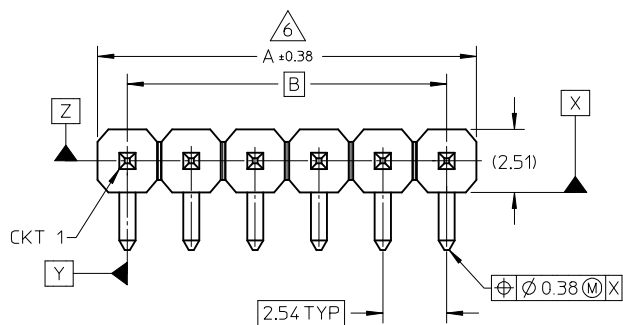

ADD P/N: 87897-0200 EC NO: S2009-0648 DRWN: SKANG 2009/03/13 CHKD: ATSEE 2009/03/13 APPR: MLONG 2009/03/14	QUALITY SYMBOLS ▽=0 ▽=0	GENERAL TOLERANCES (UNLESS SPECIFIED)		DIMENSION STYLE MM ONLY		SCALE NTS	DESIGN UNITS METRIC	THIRD ANGLE PROJECTION		
		4 PLACES ± --- ± ---	DRAWN BY SKL IM01	DATE 2006/10/18	TITLE CUSTOM HEADER 2.54MM PITCH S/ROW HDR. S/WAFER, RIGHT ANGLE					
		3 PLACES ± --- ± ---	CHECKED BY CWLAM	DATE 2006/12/13	MOLEX INCORPORATED					
		2 PLACES ± 0.2 ± --- 1 PLACE ± --- ± ---	APPROVED BY KWLEE	DATE 2006/12/13	MATERIAL NO. SEE TABLE	DOCUMENT NO. SD-87897-011	SHEET NO. 1 OF 3			
DRAFT WHERE APPLICABLE MUST REMAIN WITHIN DIMENSIONS		THIS DRAWING CONTAINS INFORMATION THAT IS PROPRIETARY TO MOLEX INCORPORATED AND SHOULD NOT BE USED WITHOUT WRITTEN PERMISSION								

**PART WITH KINKED PIN AND VOIDED PIN
(FOR REFERENCE USED ONLY)**

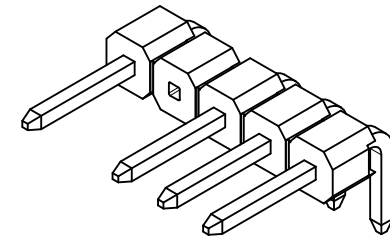
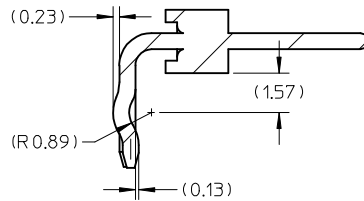
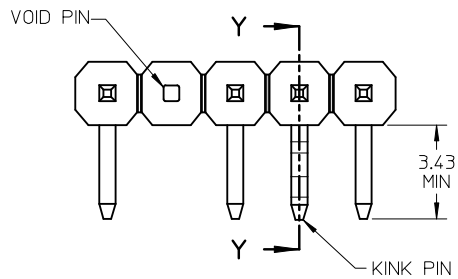

SECTION Y-Y

ADD P/N: 87897-0200 EC NO: S2009-0648 DRWN:SKANG 2009/03/13 CHKD:ATSEE 2009/03/13 APPR:MLONG 2009/03/14	DESCRIPTION REV	QUALITY SYMBOLS	GENERAL TOLERANCES (UNLESS SPECIFIED)		DIMENSION STYLE MM ONLY		SCALE NTS	DESIGN UNITS METRIC	THIRD ANGLE PROJECTION																		
		▽=0 ≡=0	<table border="1"> <thead> <tr> <th></th> <th>mm</th> <th>INCH</th> </tr> </thead> <tbody> <tr> <td>4 PLACES</td> <td>± ---</td> <td>± ---</td> </tr> <tr> <td>3 PLACES</td> <td>± ---</td> <td>± ---</td> </tr> <tr> <td>2 PLACES</td> <td>± 0.2</td> <td>± ---</td> </tr> <tr> <td>1 PLACE</td> <td>± ---</td> <td>± ---</td> </tr> </tbody> </table>		mm	INCH	4 PLACES	± ---	± ---	3 PLACES	± ---	± ---	2 PLACES	± 0.2	± ---	1 PLACE	± ---	± ---	ANGULAR ± 3 °		DRAWN BY SKLIM01	DATE 2006/10/18	TITLE CUSTOM HEADER 2.54MM PITCH S/ROW HDR. S/WAFER, RIGHT ANGLE				
			mm	INCH																							
		4 PLACES	± ---	± ---																							
3 PLACES	± ---	± ---																									
2 PLACES	± 0.2	± ---																									
1 PLACE	± ---	± ---																									
DRAFT WHERE APPLICABLE MUST REMAIN WITHIN DIMENSIONS			SEE TABLE		CHECKED BY CWLAM	DATE 2006/12/13	APPROVED BY KWLEE 2006/12/13																				
					MATERIAL NO.		DOCUMENT NO.			SHEET NO.																	

CKT SIZE	DIMENSION		PACKAGING OPTION PART NO.			CKT SIZE	KINK POSITION	VOID POSITION	PLATING TYPE	DIMENSION			PK SPEC
	A	B	TUBE	TRAY	BULK					MATING END	SOLDER TAIL	E	
	M	P											
02	5.08	2.54	-	-	87897-0200	2	-	-	5	6.75	2.90	1.75	4
03	7.62	5.08	-	87897-0299	-	2	-	-	5	8.00	5.29	1.52	3
04	10.16	7.62	87897-0300	-	-	3	-	-	5	5.30	3.20	2.87	1
05	12.70	10.16	87897-0500	-	-	5	-	-	5	5.30	3.20	2.87	1
06	15.24	12.70	-	87897-0001	-	5	-	2, 3, 4	5	14.20	3.20	1.40	3
07	17.78	15.24	-	87897-0507	-	5	-	2, 3, 4	5	15.24	2.95	1.27	3
08	20.32	17.78											
09	22.86	20.32											
10	25.40	22.86											
11	27.94	25.40											
12	30.48	27.94											
13	33.02	30.48											
14	35.56	33.02											
15	38.10	35.56											
16	40.64	38.10											
17	43.18	40.64											
18	45.72	43.18											
19	48.26	45.72											
20	50.80	48.26											
21	53.34	50.80											
22	55.88	53.34											
23	58.42	55.88											
24	60.96	58.42											
25	63.50	60.96											
26	66.04	63.50											
27	68.58	66.04											
28	71.12	68.58											
29	73.66	71.12											
30	76.20	73.66											
31	78.74	76.20											
32	81.28	78.74											
33	83.82	81.28											
34	86.36	83.82											
35	88.90	86.36											
36	91.44	88.90											
37	93.98	91.44											
38	96.52	93.98											
39	99.06	96.52											
40	101.60	99.06											

△ BELOW DIMENSION (E) ONLY APPLIED FOR PART NUMBER 87897-0300 AND -0500

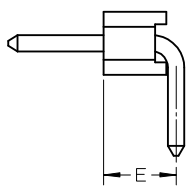

ADD P/N: 87897-0200 EC NO: S2009-0648 DRWN:SKANG 2009/03/13 CHKD:ATSEE 2009/03/13 APPR:MLONG 2009/03/14	QUALITY SYMBOLS	GENERAL TOLERANCES (UNLESS SPECIFIED)	DIMENSION STYLE	SCALE	DESIGN UNITS	THIRD ANGLE PROJECTION	
	▽=0	mm INCH	MM ONLY	NTS	METRIC		
	∇=0	4 PLACES ± --- ± ---	DRAWN BY SKLIM01	DATE 2006/10/18	TITLE CUSTOM HEADER		
		3 PLACES ± --- ± ---	CHECKED BY CWLAM	DATE 2006/12/13	2.54MM PITCH S/ROW HDR.		
	2 PLACES ± 0.2 ± ---	APPROVED BY KWLEE	DATE 2006/12/13	S/WAFER, RIGHT ANGLE			
	1 PLACE ± --- ± ---	MATERIAL NO.		MOLEX INCORPORATED			
	ANGULAR ± 3 °	SEE TABLE		DOCUMENT NO. SD-87897-011			
	DRAFT WHERE APPLICABLE MUST REMAIN WITHIN DIMENSIONS			SHEET NO. 3 OF 3			
			SIZE A3	THIS DRAWING CONTAINS INFORMATION THAT IS PROPRIETARY TO MOLEX INCORPORATED AND SHOULD NOT BE USED WITHOUT WRITTEN PERMISSION			