

## FLAT WASHER AN960 and AN960L SERIES

MIL-S-7952 - Steel - Cadmium plated per QQ-P-416  
 Stainless 300 Series 18-8  
 Aluminum Alloy 2024 per QQ-A250/4  
 Aluminum Alloy, Anodized per MIL-8625 or MIL-C-5541

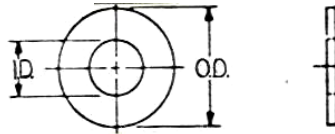

www.DataSheet4U.com

DASH NUMBERS

Washer Pricing per 100 or .10 ea

Standard Package - 100

Carbon Steel	100	CRES	100	Alum	100	Alum	100	SIZE	ID	OD	T
3L	\$3.23	C3L	\$ 4.08	D3L	\$ 4.08	PD3L	\$ 4.08	#3	0.105	0.25	0.016
3	3.23	C3	4.08	D3	4.08	PD3	4.08	#3	0.105	0.25	0.032
4L	3.28	C4L	4.08	D4L	4.08	PD4L	4.08	#4	0.125	0.312	0.016
4	3.28	C4	4.08	D4	4.08	PD4	4.08	#4	0.125	0.312	0.032
6L	3.23	C6L	4.08	D6L	4.08	PD6L	4.08	#6	0.149	0.375	0.016
6	3.28	C6	4.24	D6	4.08	PD6	4.08	#6	0.149	0.375	0.032
8L	3.23	C8L	4.91	D8L	4.91	PD8L	4.91	#8	0.174	0.375	0.016
8	3.28	C8	4.91	D8	4.91	PD8	4.91	#8	0.174	0.375	0.032
10L	3.23	C10L	4.59	D10L	4.91	PD10L	4.91	#10	0.203	0.438	0.032
10	3.28	C10	4.93	D10	5.82	PD10	5.82	#10	0.203	0.438	0.063
416L	3.28	C416L	4.75	D416L	5.64	PD416L	5.64	1/4	0.265	0.5	0.032
416	3.28	C416	5.48	D416	5.64	PD416	5.64	1/4	0.265	0.5	0.063
516L	3.28	C516L	5.47	D516L	6.11	PD516L	6.11	5/16	0.328	0.562	0.032
516	3.44	C516	8.25	D516	6.44	PD516	6.44	5/16	0.328	0.562	0.063
616L	3.28	C616L	5.61	D616L	6.52	PD616L	6.52	3/8	0.39	0.625	0.032
616	4.59	C616	6.60	D616	7.59	PD616	7.59	3/8	0.39	0.625	0.063
716L	4.39	C716L	17.60	D716L	9.67	PD716L	9.67	7/16	0.453	0.75	0.032
716	5.08	C716	14.86	D716	12.03	PD716	12.03	7/16	0.453	0.75	0.063
816L	8.69	C816L	17.60	D816L	12.84	PD816L	12.84	1/2	0.515	0.875	0.032
816	9.90	C816	18.52	D816	12.53	PD816	12.53	1/2	0.515	0.875	0.063
916L	9.08	C916L		D916L		PD916L		9/16	0.578	1.062	0.032
916	9.12	C916		D916		PD916		9/16	0.578	1.062	0.063
1016L	14.55	C1016L		D1016L		PD1016L		5/8	0.64	1.188	0.032
1016	14.30	C1016		D1016		PD1016		5/8	0.64	1.188	0.063
1216L	14.55	C1216L		D1216L		PD1216L		3/4	0.765	1.312	0.032
1216	19.71	C1216		D1216		PD1216		3/4	0.765	1.312	0.090

washers are an SAE equivalent fit.

## LARGE AREA FLAT WASHER AN970

Steel - Cadmium Plated per QQ-P-416, Type II, Class 2

AN970	Bolt Size	I.D.	O.D.	Thickness	EA	100
-3	#10	.203	.875	.063	\$.11	\$ 7.78
-4	1/4	.265	1.125	.063	.15	11.75
-5	5/16	.328	1.375	.063	.25	20.30
-6	3/8	.390	1.625	.063	.30	23.76
-7	7/16	.453	1.812	.109	.74	60.52
-8	1/2	.515	2.000	.109	.88	72.86
-9	9/16	.578	2.188	.125	.92	76.03
-10	5/8	.640	2.375	.125	1.09	90.29

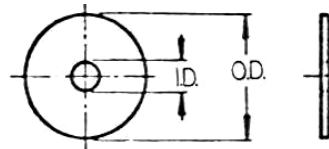

## SPRING WASHER MS35338 or AN935

Steel - Cadmium Plated per QQ-P-416,  
 Type II, Class 2. CRES - 300 Series



## HIGH STRENGTH PLAIN & CSK WASHER

### MS20002 NAS143

Heat Treated to 145,000 PSI Cadmium Plated per  
 QQ-P-416 Type II, Class 2.

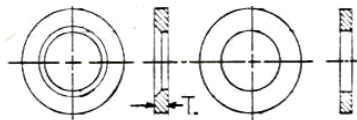

COUNTERSUNK	Price	PLAIN	Price	BOLT
MS20002	NAS143	MS20002	NAS143	SIZE
C4	-4C	\$.39	-4	1/4
C5	-5C	.52	-5	5/16
C6	-6C	.52	-6	3/8
C7	-7C	.52	-7	7/16
C8	-8C	.61	-8	1/2

Note: Sizes continue to 1-1/4 inch bolt size.

Steel	Stainless
MS35338	MS35338
-39	-2
-40	-4
-41	-6
-42	-8
-43	-10
-44	-11
-45	-12
-46	-13
-47	-14
-48	-15

Note: Sizes continue to 1-1/2 inch I.D.