



# TAI-SAW TECHNOLOGY CO., LTD.

No. 3, Industrial 2nd Rd., Ping-Chen Industrial District,  
Taoyuan, 324, Taiwan, R.O.C.

TEL: 886-3-4690038 FAX: 886-3-4697532

E-mail: [tstsales@mail.taisaw.com](mailto:tstsales@mail.taisaw.com) Web: [www.taisaw.com](http://www.taisaw.com)

## Approval Sheet For Product Specification

Issued Date:

Product Name: SAW Filter 1090MHz SMD 3.8x3.8 mm

TST Parts No.:TA0232A

Customer Parts No.:\_\_\_\_\_

Company: _____
Division: _____
Approved by : _____
Date: _____

Checked by: \_\_\_\_\_ Anne chen

Approval by: \_\_\_\_\_ Francis Chen

Date: \_\_\_\_\_ 2007/11/15



# TAI-SAW TECHNOLOGY CO., LTD.

No. 3, Industrial 2nd Rd., Ping-Chen Industrial District,  
Taoyuan, 324, Taiwan, R.O.C.

TEL: 886-3-4690038 FAX: 886-3-4697532

E-mail: [tstsales@mail.taisaw.com](mailto:tstsales@mail.taisaw.com) Web: [www.taisaw.com](http://www.taisaw.com)

## SAW Filter 1090 MHz

MODEL NO.: TA0232A

REV. NO.:4

### A. MAXIMUM RATING:

1. Input Power Level: 0 dB<sub>m</sub>
2. DC voltage: 0 V
3. Operating Temperature: -40°C to +85°C
4. Storage Temperature: -40°C to +85°C

RoHS Compliant  
Lead free  
Lead-free soldering

### B. CHARACTERISTICS:

Item	Min.	Typ.	Max.
<b>Center frequency</b> <b>Fc</b> MHz	-	1090	-
<b>Insertion loss</b> 1084 ~ 1096 MHz <b>IL</b> (dB)	-	3.9	5.3
<b>Amplitude ripple</b> 1084 ~ 1096 MHz                      (dB)	-	0.6	1.5
<b>Attenuation</b> (Reference level from 0 dB)			
500 ~ 924    MHz                      (dB)	45	48	-
924 ~ 944    MHz                      (dB)	45	50	-
944 ~ 1051 MHz                      (dB)	40	47	-
1051 ~ 1061 MHz                      (dB)	30	36	-
1170 ~ 2000 MHz                      (dB)	40	43	-
<b>Balanced to balanced operation</b>			
<b>Source impedance</b> Z <sub>s</sub> (Ω)	-	50	-
<b>Load impedance</b> Z <sub>L</sub> (Ω)	-	50	-

### C. MEASUREMENT CIRCUIT:

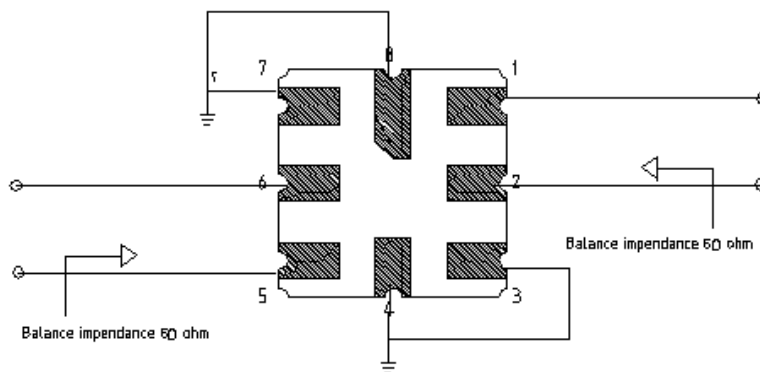

### D. Transfer Function :

Narrowband

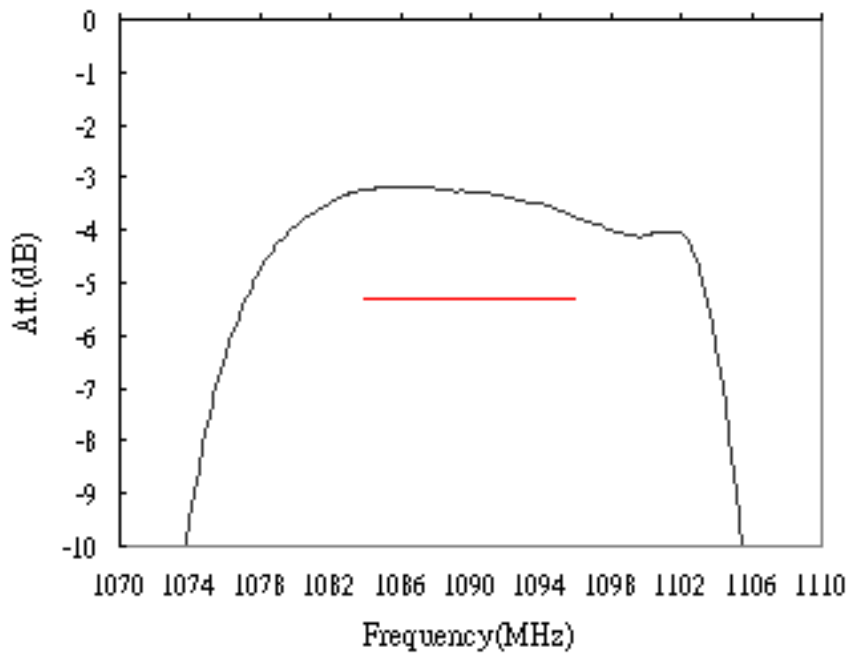
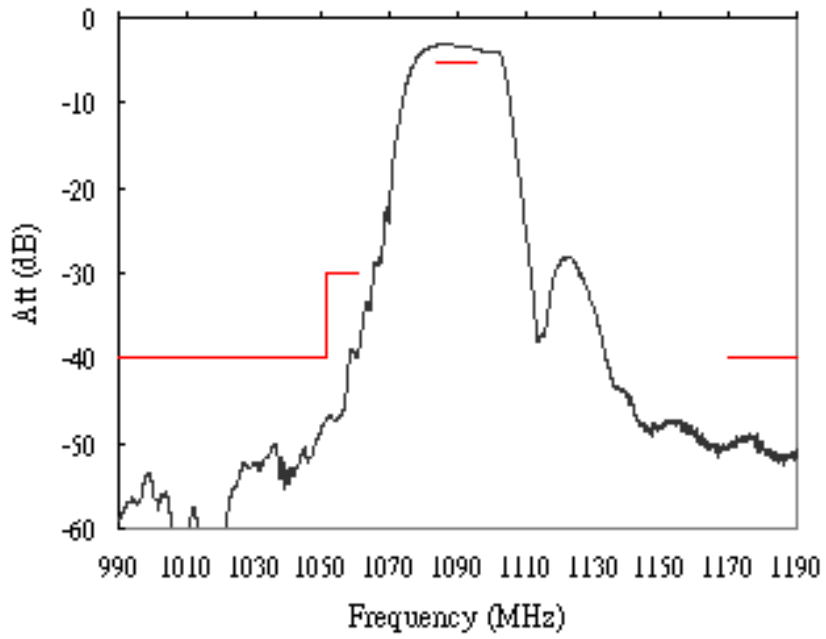

# Wideband

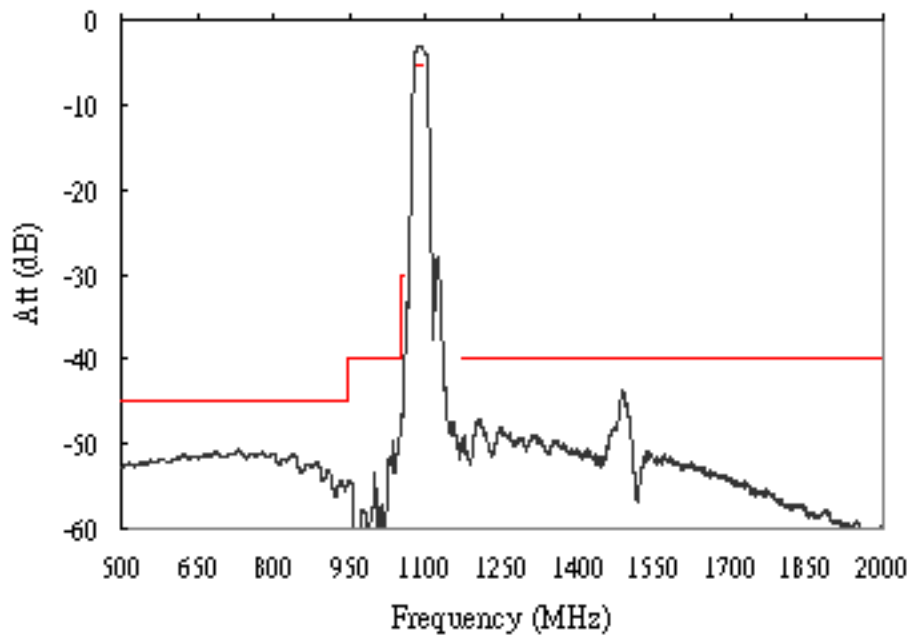

## E.OUTLINE DRAWING:

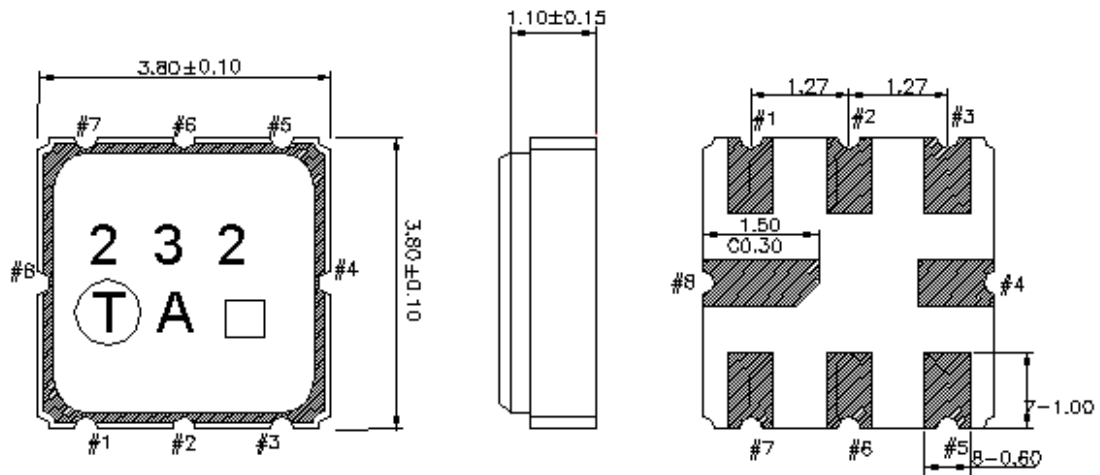

- #1,2 : Balance Input
- #5,6 : Balance Output
- #3,4,7,8: Ground
- : Date Code
- Unit : mm



## F. PACKING:

### 1. REEL DIMENSION

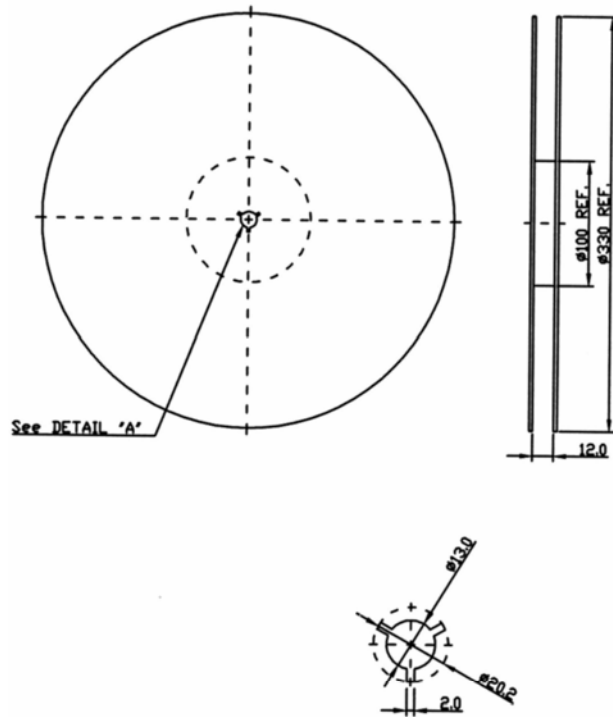

### 2. TAPE DIMENSION

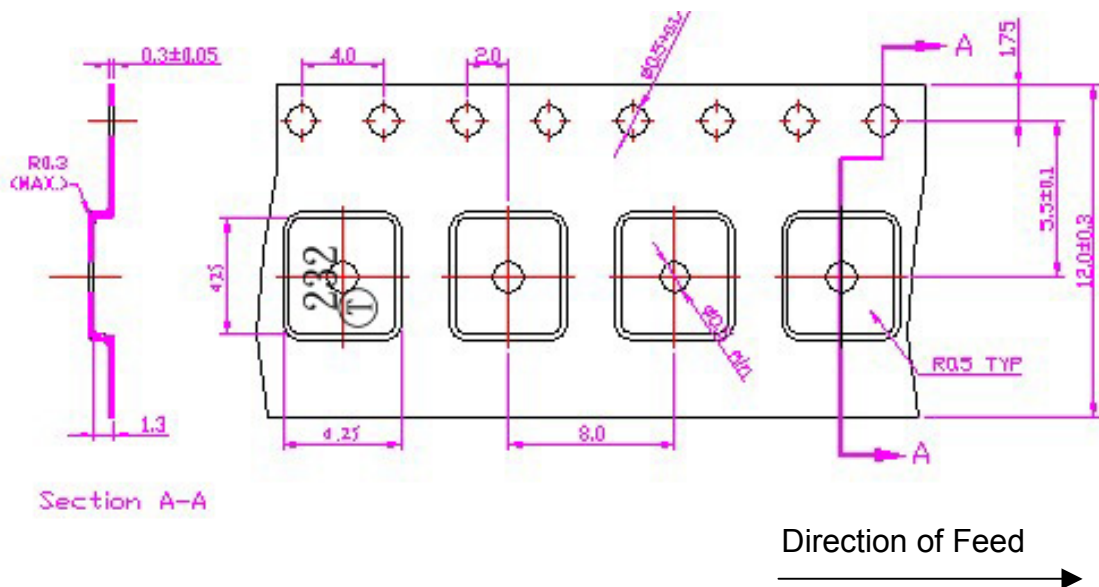

**I. RECOMMENDED REFLOW PROFILE :**

