

NOTES:

1. MATERIAL: HIGH PERFORMANCE COPPER ALLOY
2. FINISH:  
222 - OVERALL TIN: 100 MI MIN OVER NICKEL  
228 - SELECT GOLD: 30 MI MIN,  
SELECT TIN: 100 MI MIN  
OVER NICKEL
3. PRODUCT SPECIFICATION: PS-46064-001
4. PACKAGING:  
REEL PACK PER : PK-46056-002  
LOOSE PACK PER : PK-5556-003
5. TERMINAL TO BE USED WITH ASSY NUMBER: 46065
6. WIRE SPECIFICATION: SEE CHART.
7. WHEN USING OVERALL TIN PLATED TERMINALS:  
FOR APPLICATIONS INVOLVING VIBRATION AND/OR  
THERMAL CYCLING, MOLEX STRONGLY RECOMMENDS  
THE USE OF NYE LUBRICANT, NYOGEL 760G, ON  
THE MATING END OF THE TERMINAL. LUBRICANT  
MAY BE APPLIED BEFORE OR AFTER THE TERMINALS  
ARE INSERTED INTO THE HOUSING.

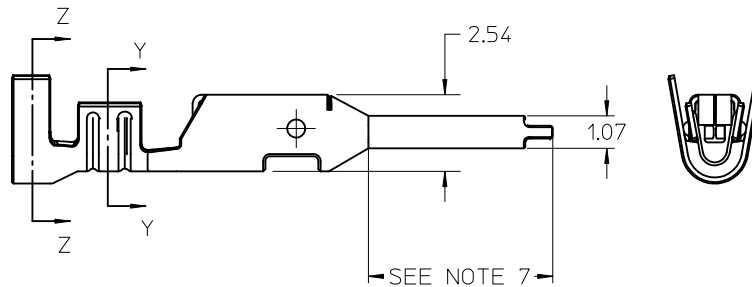
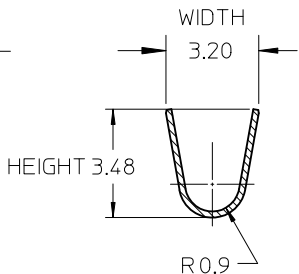
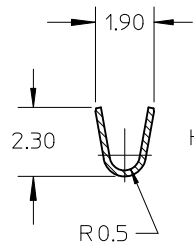
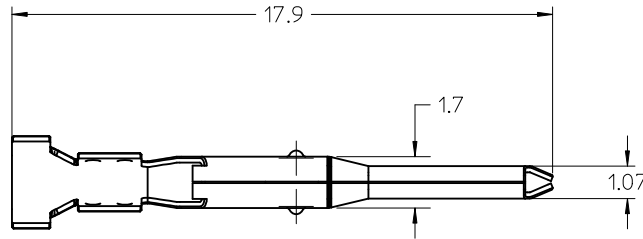
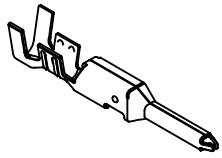

SECTION Y-Y  
CONDUCTOR CRIMP

SECTION Z-Z  
INSULATION CRIMP

LOOSE PACKAGED MATERIAL NUMBER	REEL PACKAGED MATERIAL NUMBER	FINISH	WIRE SPEC	INSULATION DIA	INSULATION (CRIMPED)			CONDUCTOR (CRIMPED)				
					HEIGHT		WIDTH		HEIGHT		WIDTH	
					MIN	MAX	MIN	MAX	MIN	MAX	MIN	MAX
46056-0004	46056-0002	222 - TIN	UL1015 18/20 AWG	2.52 / 2.81	N/A	3.20	2.70	2.90	1.05	1.15	1.50	1.70
46056-0005	46056-0003	228 - SELECT GOLD	UL1015 18/20 AWG	2.52 / 2.81	N/A	3.20	2.70	2.90	1.05	1.15	1.50	1.70

UPDATE NOTE 4 EC NO: UCP2011-1228 DRWN: JJAGUILAR 2010/10/29 CHKD: APPR: FSMITH 2010/11/09	QUALITY SYMBOLS	GENERAL TOLERANCES (UNLESS SPECIFIED)	DIMENSION STYLE	SCALE	DESIGN UNITS	THIRD ANGLE PROJECTION
	∇=0 ∇=0 ∇=0	mm    INCH 4 PLACES ± --- ± --- 3 PLACES ± --- ± --- 2 PLACES ± 0.25 ± --- 1 PLACE ± 0.38 ± --- ANGULAR ± 3 °	MM ONLY	4:1	METRIC	
	DESCRIPTION	DRAFT WHERE APPLICABLE MUST REMAIN WITHIN DIMENSIONS	DRAWN BY: KSAMIEC    DATE: 2007/03/22 CHECKED BY:            DATE:	TITLE	SEALED MINIFIT H20 PLUG TERMINAL	
	REV		APPROVED BY: FSMITH    DATE: 2010/11/09 MATERIAL NO.            SEE CHART DOCUMENT NO.            SD-46056-001 SHEET NO.                 1 OF 1	MOLEX INCORPORATED SD-46056-001		