

301-656 to 670

# Eddystone Radio

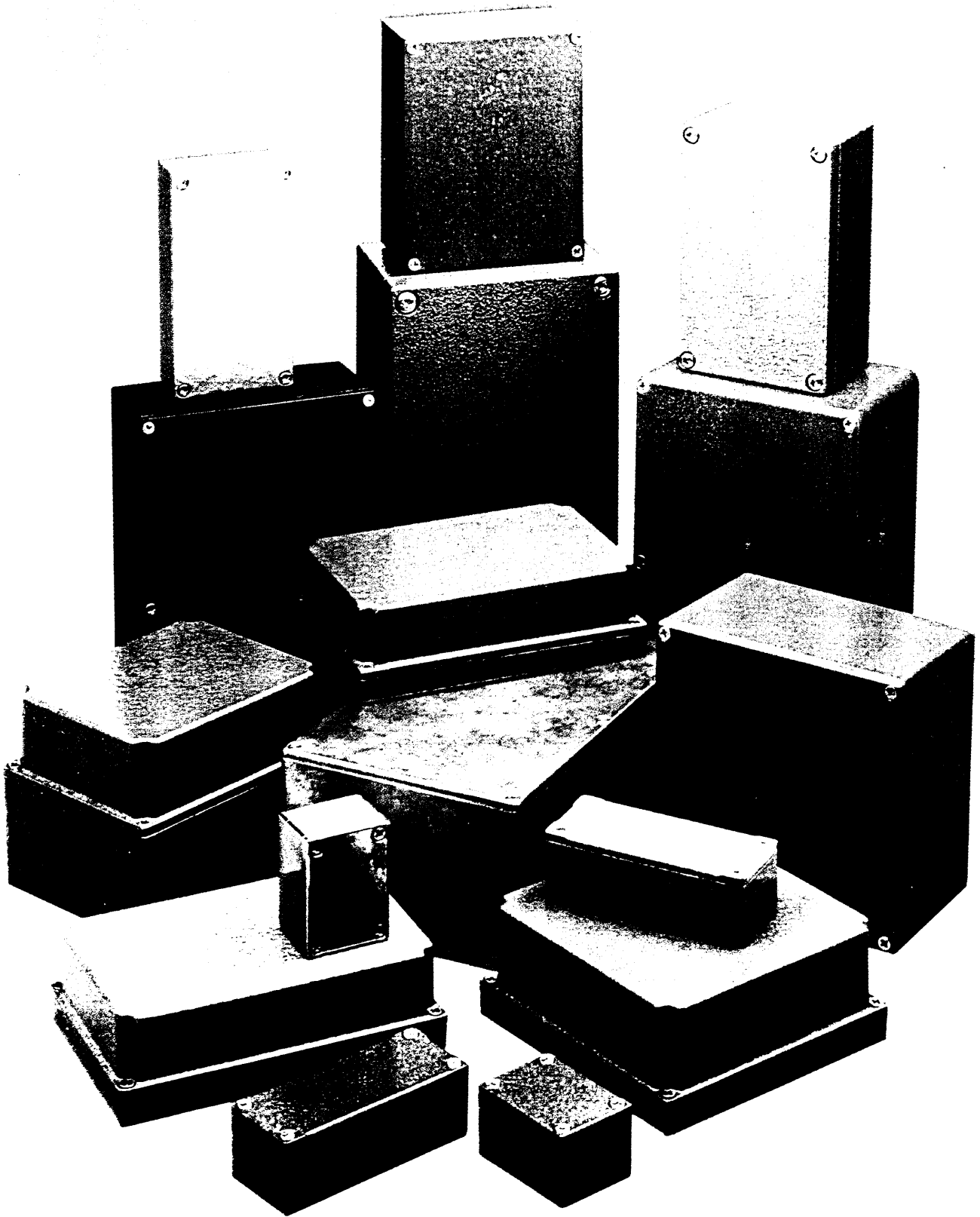

Aluminium diecast boxes  
for universal applications

# VERSATILE DIECAST BOXES

## GENERAL DESCRIPTION

- Corrosion resistant.
- High RF screening.
- Robust.
- Lightweight.
- Easily machined.
- Wide range of sizes.
- Aluminium construction.
- Material BS1490. LM2M.

These enclosures are supplied in diecast aluminium and are available in ten sizes. Five of the sizes are available with an interchangeable form of assembly using baseplates and special deep lids. On these types the deep or shallow lids can be fitted onto the box or baseplate in any desired combination. The close fitting lids are retained by four, six or eight screws according to size. The enclosures are supplied unpainted, but will accept most finishes with a minimum of preparation.

There are widespread applications for these enclosures as shown by the following examples: instrument cases, meter cases, filter housings, cable distribution boxes, switchgear housings, audio and RF equipment housings and many other uses where rigidity and good screening are needed. They are competitive both in small and larger batch situations.

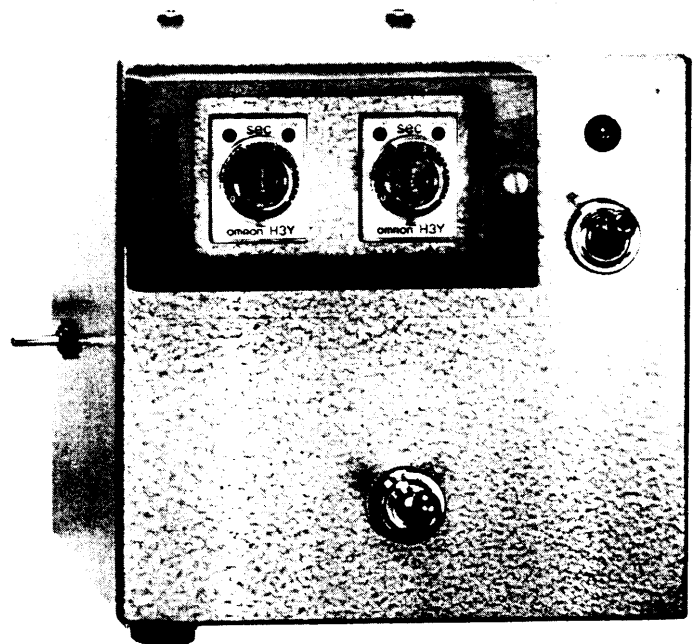
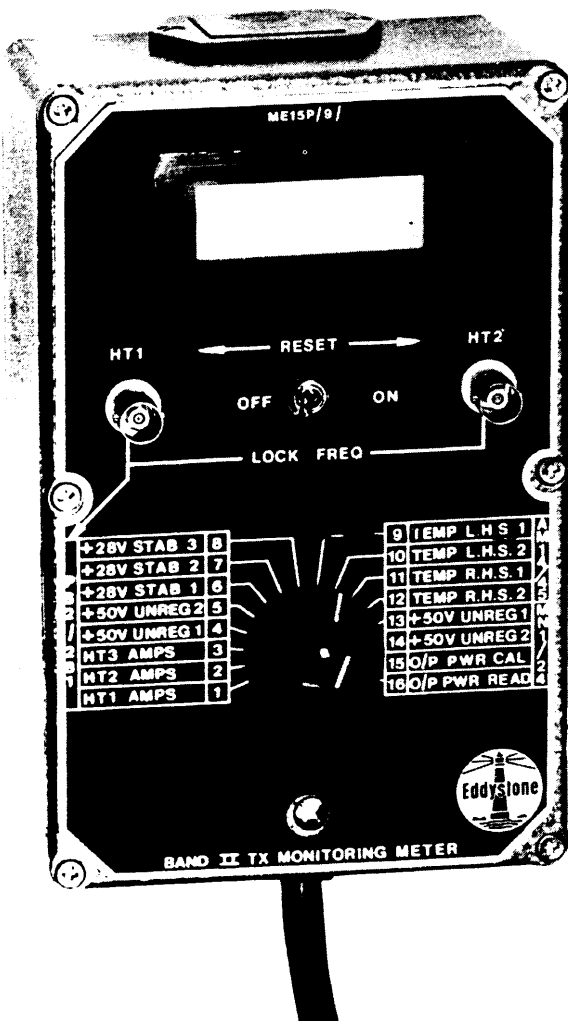

DIMENSIONS FOR VERSATILE RANGE (mm) Tolerances  $\pm 0.4\text{mm}$

CODE		A	B	C	D	E(crs)	F(crs)	G	H	J
10758P	BOX	145	95	45	—	135.6	85.6	—	4.7	2.55 Max
10758P/BP	BASE	145	95	12	—	135.6	85.6	—	4.7	4.7
10758P/DL	LID	145	95	—	34	135.6	8k5.6	32.1	4.7	—
10758P/SL	LID	145	95	—	6	135.6	85.6	4.1	4.7	—
11130P	BOX	125	125	75	—	115.6	115.6	—	4.7	2.5 Max
11130P/BP	BASE	125	125	12	—	115.6	115.6	—	4.7	4.7 Max
11130P/DL	LID	125	125	—	42	115.6	115.6	39.8	—	—
11130P/SL	LID	125	125	—	6	115.6	115.6	3.8	—	—
26908P	BOX	120	95	53	—	110.6	85.6	—	4.7	2.5 Max
26908P/BP	BASE	120	95	12	—	110.6	85.6	—	4.7	4.7
26908P/DL	LID	120	95	—	42	110.6	85.6	39.8	—	—
26908P/SL	LID	120	95	—	6	110.6	85.6	3.8	—	—
27134P	BOX	111	60	27	—	101.6	50.8	—	4.7	2.5 Max
27134P/BP	BASE	111	60	12	—	101.6	50.8	—	4.7	4.7
27134P/DL	LID	111	60	—	25	101.6	50.8	23.1	—	—
27134P/SL	LID	111	60	—	6	101.6	50.8	4.1	—	—
29830P	BOX	120	95	30	—	110.6	85.6	—	4.7	2.5 Max
29830P/BP	BASE	120	95	12	—	110.6	85.6	—	4.7	4.7
29830P/DL	LID	120	95	—	42	110.6	85.6	39.8	—	—
29830P/SL	LID	120	95	—	6	110.6	85.6	3.8	—	—
26357P	BOX	187.7	119.5	—	182.5	177.8	109.5	4	2.4	2.0/2.5
	c/w LID									
26827P	BOX	187.7	119.5	—	182.5	177.8	109.5	4	2.4	2.0/2.5
	c/w LID									
27969P	BOX	92.0	38.0	—	88.5	82.5	28.5	4	1.6	1.6/2.0
	c/w LID									
7970P	BOX	187.7	187.7	—	182.6	177.8	177.8	4	2.4	2.0/2.5
	c/w LID									
11451P	BOX	52.4	38.1	—	48.8	42.86	28.57	4	1.6	1.6
	c/w LID									

Metric Taprite Screws. M3.5 Countersunk

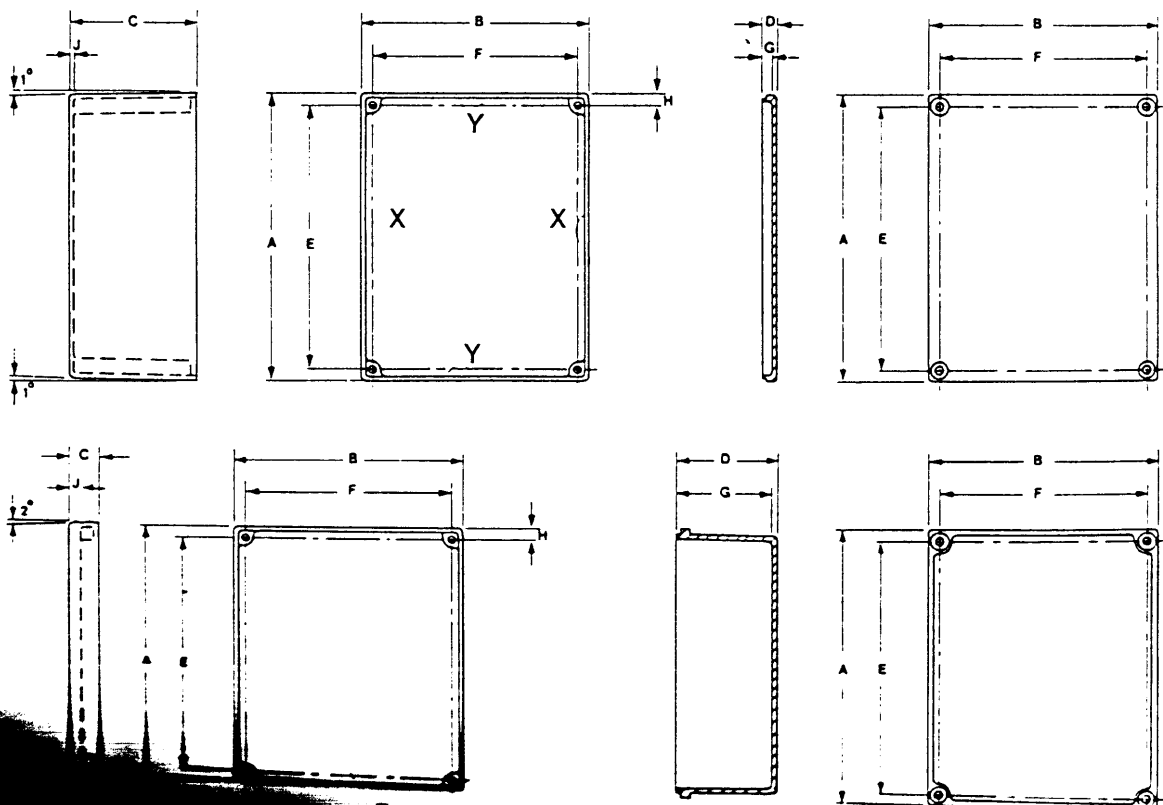

Press X on Cat. Nos. 26357P & 26827P only.  
Press X & Y on Cat. No. 7970P only.

# DIMENSIONS FOR WATERPROOF RANGE

DIMENSIONS (mm) Tolerances  $\pm 0.4\text{mm}$

CODE	A	B	C	D	E(crs)	F(crs)	G	H	J	K
9732P	125	80	45	12	113	68	9.5	4	2.5	52
9920P	220	120	66	14	202	102	11.5	4	2.5	77
11624P	191	191	66	14	172	172	11.0	4.5	3	147

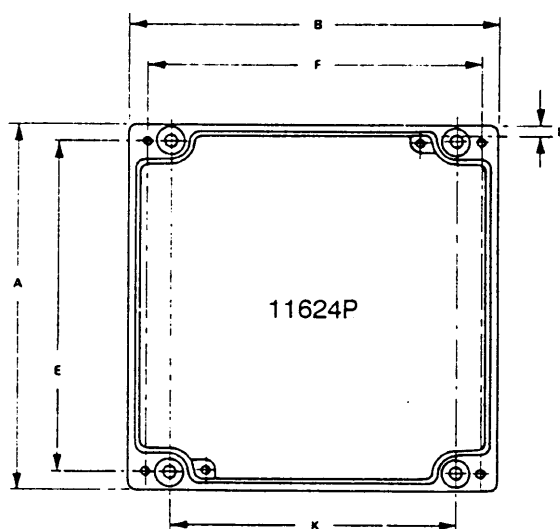
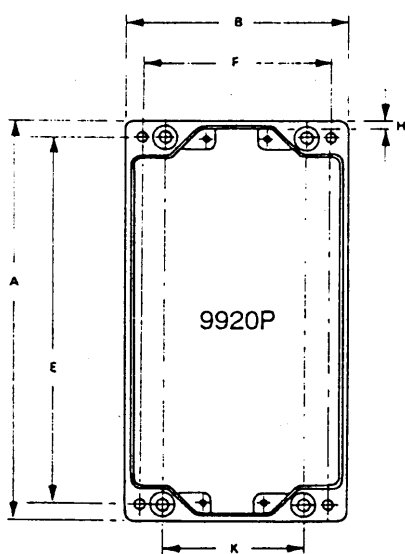
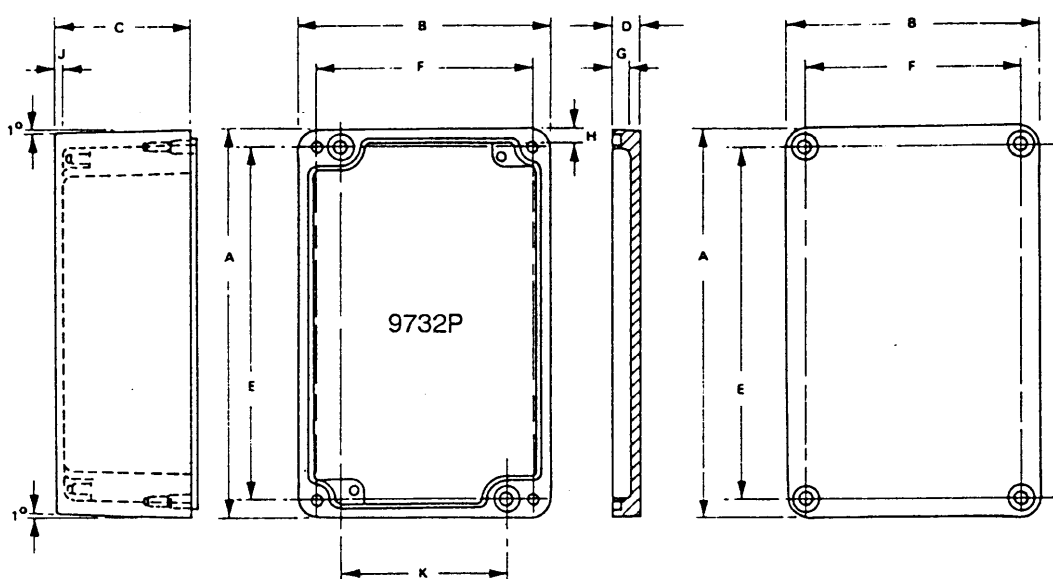

This document gives only a general description of the products of services offered, and shall not form part of any contract. From time to time changes may be made in the products or conditions of supply.

# DIECAST BOXES

## THE COMPLETE RANGE

**Standard Diecast Boxes.** BS1490. LM2M.  
Approximate external measurements.

7970P	188 x 188 x 68 mm
26357P	188 x 120 x 78 mm
26827P	188 x 120 x 52 mm
10758P with shallow lid	145 x 95 x 49 mm
Optional deep lid	145 x 95 x 34 mm
Optional base plate	145 x 95 x 12 mm
11130P with shallow lid	125 x 125 x 79 mm
Optional deep lid	125 x 125 x 42 mm
Optional base plate	125 x 125 x 12 mm
26908P with shallow lid	120 x 95 x 57 mm
Optional deep lid	120 x 95 x 42 mm
Optional base plate	120 x 95 x 12 mm
29830P with shallow lid	120 x 95 x 34 mm
Optional deep lid	120 x 95 x 42 mm
Optional base plate	120 x 95 x 12 mm
27134P with shallow lid	111 x 60 x 31 mm
Optional deep lid	111 x 60 x 25 mm
Optional base plate	111 x 60 x 12 mm
27969P	92 x 38 x 27 mm
11451P	52 x 38 x 31 mm

**Water Resistant Diecast Boxes.** BS 1490 LM6. (IP 65)  
Supplied complete with Neoprene gasket.

11624P	191 x 191 x 80 mm
9920P	220 x 120 x 80 mm
9732P	125 x 80 x 57 mm

- Diecast boxes, lids or screws may be ordered separately for all types.
- All boxes and lids are supplied in natural metal finish, except 9732P, 9920P, and 11624P, which are finished in grey hammer as standard. May also be supplied in natural finish to order.
- Boxes can be machined to customers specification drawings.
- Metric fixing screws accept POZIDRIV No. 2 Screwdriver.
- Boxes and lids can be paint finished to customers colour requirements.

DISTRIBUTOR

## User Guide

- Ministry of Defence.
- Radio equipment manufacturers.
- Electrical contractors.
- Lighting specialists.
- Computer manufacturers.
- RF engineers.
- Telephone companies.
- Electronics manufacturers.
- Aerospace industry.
- Marine engineers.
- Antenna manufacturers.
- Alarm manufacturers.

*World wide distribution network*



## Eddystone Radio



A MARCONI COMMUNICATION SYSTEMS COMPANY.  
Eddystone Radio Limited,  
Eddystone Works, Alvechurch Road, Birmingham B31 3PP, England.  
Telephone: 021-475 2231 Telex: 337081. Cables: Eddystone Birmingham  
Fax: 021-477 5224

© EDDYSTONE RADIO LIMITED.

6

# WATER RESISTANT DIECAST BOXES.

## GENERAL DESCRIPTION

- Recessed screws.
- Internal earth connection.
- Corrosion resistant.
- Stove enamel finish.
- Robust & rugged.
- Aluminium alloy to BS1490 LM6.
- B.S.5490.IEC. 529. IP65

A range of water resistant Eddystone diecast boxes providing secure enclosures for use in hostile marine and industrial applications. The aluminium alloy is corrosion resistant and easily machined.

An earthing screw is provided inside the boxes for electrical earthing purposes.

Standard finish is grey hammer paint, other finishes may be supplied according to individual customer instructions.

The intergral sealing ring is Neoprene and provides protection to IP65.

