

TR5® / No. 372

IEC 60127-3/IV, 250V, T

Specifications

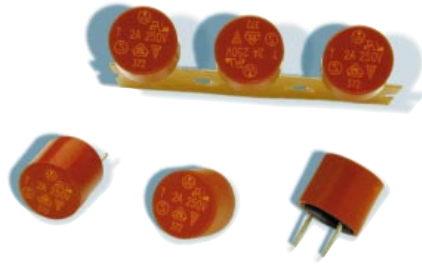

Dimensions<sup>2</sup> (mm)

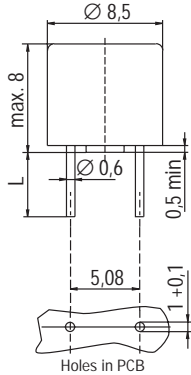

Long Leads (L=18.8mm)  
Short Leads (L=4.3mm)

Time-Current Characteristic

Time Lag (T)

Standard

IEC 60127-3/IV

Approvals

VDE: License No. 97187  
License No. 116448 (5A)  
SEMKO: Certificate No. 9812212  
Certificate No. 9748179 (5A)  
cULus Recognized: File No. E 67006  
MITI: File No. 32-1888

Features

Reduced PCB space requirements  
Direct solderable or plug-in versions  
Internationally approved  
Low internal resistance  
Shocksafe casing

WebLinks

Data Sheet

[www.wickmann.com/products/372.pdf](http://www.wickmann.com/products/372.pdf)

Approval Certificates

[www.wickmann.com/approvals](http://www.wickmann.com/approvals)

Time-Current Curve

Page 58  
[www.wickmann.com/itcurves](http://www.wickmann.com/itcurves)

Packaging

Page 118  
[www.wickmann.com/pack](http://www.wickmann.com/pack)

FaxBack Document # 300

Packaging

000: Tape/Ampopack (1000 pcs.)  
041: Short Leads - Bulk (1000 pcs.)

Materials

Base/Cap: Brown Thermoplastic  
Polyamide PA 6.6, UL 94V0  
Round Pins: Copper alloy, tin plated

Operating Temperature

-40°C to +85°C (consider de-rating)

Climatic Category

-25°C/+70°C/21 days (EN 60068-1..3)

Stock Conditions

+10°C to +60°C  
relative humidity ≤ 75% yearly average,  
without dew, maximum value for 30 days-95%

Vibration Resistance

24 cycles at 15 min. each (EN 60068-6)  
10 - 60Hz at 0.75mm amplitude  
60 - 2000Hz at 10g acceleration

Lead Pull Strength

10N (EN 60068-2-21)

Solderability

260°C, ≤ 3 sec. (Wave)  
350°C, ≤ 1 sec. (Hand)

Soldering Heat Resistance

260°C, 10 sec. (IEC 60068-2-20)

Marking

 , 372, 250V, T, Current Rating, Approvals

Unit Weight

0.77g (approx.)

Limits for Pre-arcing Time

Rated Current	1.5 x I <sub>Rated</sub>	2.1 x I <sub>Rated</sub>	2.75 x I <sub>Rated</sub>	4 x I <sub>Rated</sub>	10 x I <sub>Rated</sub>
50mA ... 5.00A	> 1h	< 2 min	400ms ... 10s	150ms ... 3s	20ms ... 150ms



Permissible continuous operating current I<sub>s</sub> ≤ 100% at ambient temperature of 23°C (73.4°F).

Rated Current	Amp Code	Voltage Rating	Breaking Capacity	Voltage Drop 1.0 x I <sub>Rated</sub> max. (mV)	Power Dissipation 1.5 x I <sub>Rated</sub> max. (mW)	Melting Integral 10 x I <sub>Rated</sub> min. (A <sup>2</sup> s)	Approvals			
							VDE	SEMKO	cURus	MITI
50mA	0050	250V		500	70	0.01	•	•	•	
63mA	0063	250V		400	80	0.02	•	•	•	
80mA	0080	250V		370	100	0.023	•	•	•	
100mA	0100	250V		300	110	0.047	•	•	•	
125mA	0125	250V		260	120	0.066	•	•	•	
160mA	0160	250V		200	130	0.14	•	•	•	
200mA	0200	250V		170	140	0.2	•	•	•	
250mA	0250	250V		150	150	0.28	•	•	•	
315mA	0315	250V	35A / 250VAC <sup>1</sup>	140	160	0.36	•	•	•	
400mA	0400	250V	50-60Hz	130	170	0.9	•	•	•	
500mA	0500	250V	cos φ = 1.0	125	180	1.3	•	•	•	
630mA	0630	250V		120	200	2.5	•	•	•	
800mA	0800	250V		110	220	3.8	•	•	•	
1.00A	1100	250V		110	360	5.5	•	•	•	•
1.25A	1125	250V		95	450	9	•	•	•	•
1.60A	1160	250V		95	450	14	•	•	•	•
2.00A <sup>2</sup>	1200	250V		85	600	23	•	•	•	•
2.50A <sup>2</sup>	1250	250V		80	700	35	•	•	•	•
3.15A <sup>2</sup>	1315	250V		80	1100	60	•	•	•	•
4.00A	1400	250V	40A / 250VAC	75	1200	95	•	•	•	•
5.00A	1500	250V	50A / 250VAC	80	1300	94	G	G	•	

<sup>1</sup> Per UL, approved breaking capacity is 50 A at 250V. <sup>G</sup> Expert Report  
<sup>2</sup> Contact WICKMANN for alternative version rated at 250V, Series No. 392.

Order Information	Qty.	Order-Number	Series	Amp Code	Packaging
				372	

## TR5<sup>®</sup> / No. 372

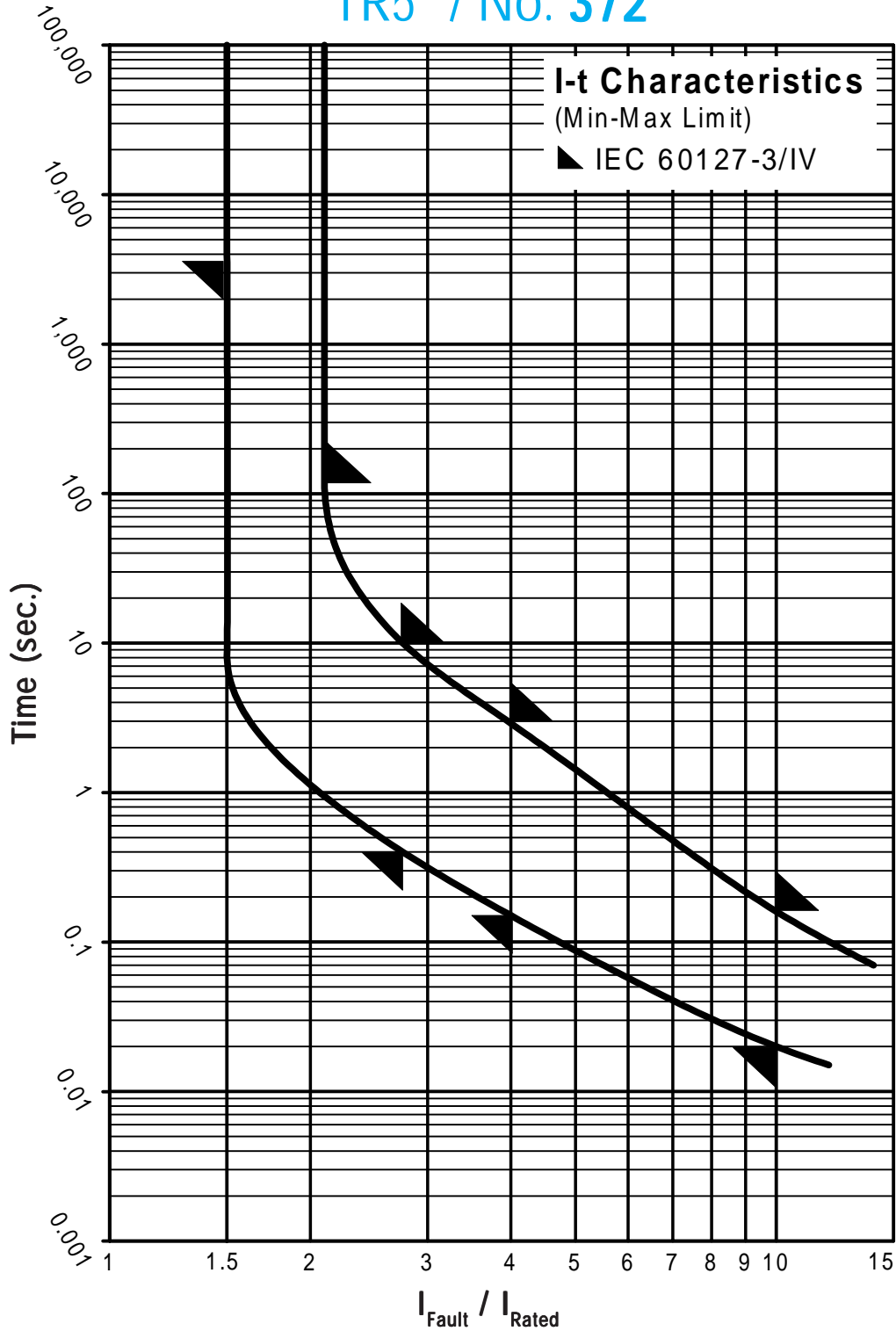

Contact WICKMANN for individual I-t curves