

PLEASE CHECK WWW.MOLEX.COM FOR LATEST PART INFORMATION

Part Number: [0482580001](#)
Status: **Active**
Description: Universal Serial Bus (USB) Shielded I/O Receptacle, Type A, Right Angle, Reverse Type, Mid Mount with side flange and Beveled Metal Pins, Gold (Au) Plated, Lead free

Documents:

[3D Model](#) [Product Specification PS-48258-001 \(PDF\)](#)
[Drawing \(PDF\)](#) [RoHS Certificate of Compliance \(PDF\)](#)

General

Product Family	I/O Connectors
Series	48258
Application	Wire-to-Board
Comments	USB A Sink
Component Type	Receptacle
Product Name	USB
Type	A

Physical

Boot Color	N/A
Circuits (Loaded)	4
Circuits (maximum)	4
Gender	Female
Keying to Mating Part	Yes
Lock to Mating Part	Yes
Material - Plating Mating	Gold
Material - Plating Termination	Tin
Number of Rows	1
Orientation	Right Angle
PC Tail Length (in)	0.059 In
PC Tail Length (mm)	1.50 mm
PCB Locator	Yes
PCB Retention	Yes
PCB Thickness Recommended (in)	0.040 In
PCB Thickness Recommended (mm)	1.00 mm
Packaging Type	Embossed Tape on Reel
Panel Mount	Yes
Pitch - Mating Interface (in)	0.098 In
Pitch - Mating Interface (mm)	2.50 mm
Pitch - Term. Interface (in)	0.098 In
Pitch - Term. Interface (mm)	2.50 mm
Polarized to Mating Part	Yes
Polarized to PCB	Yes
Ports	1
Surface Mount Compatible (SMC)	No
Temperature Range - Operating	-25°C to +85°C
Termination Interface: Style	Through Hole
Waterproof / Dustproof	No

Electrical

Current - Maximum per Contact	1.5A
Grounding to Panel	None
Shield Type	Full Shield
Shielded	Yes
Voltage - Maximum	250V AC

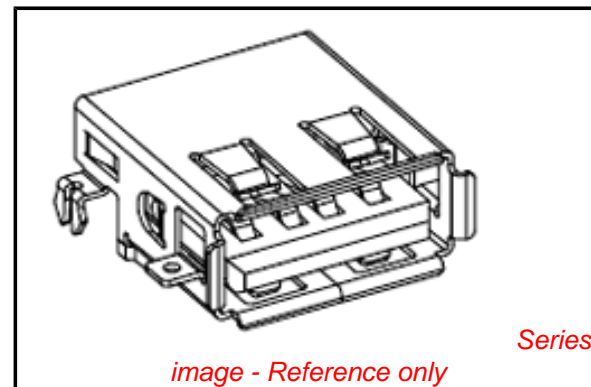

EU RoHS

**ELV and RoHS
Compliant**
REACH SVHC
 Not Reviewed
**Halogen-Free
Status**

China RoHS



Not Reviewed

**Need more information on product
environmental compliance?**

Email productcompliance@molex.com
 For a multiple part number RoHS Certificate of Compliance, [click here](#)

Please visit the [Contact Us](#) section for any non-product compliance questions.

Search Parts in this Series

[48258Series](#)

Mates With

[USB A Type Plug](#)

Material Info

Reference - Drawing Numbers

Product Specification

PS-48258-001

Sales Drawing

SD-48258-001

This document was generated on 03/31/2010

PLEASE CHECK WWW.MOLEX.COM FOR LATEST PART INFORMATION

10 9 8 7 6 5 4 3 2 1

F
E
D
C
B
A

F
E
D
C
B
A

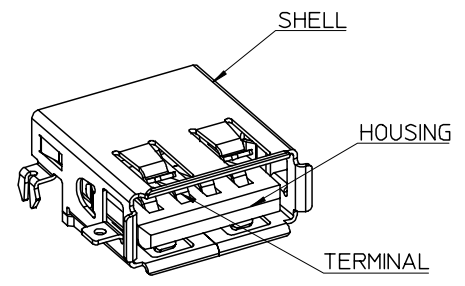
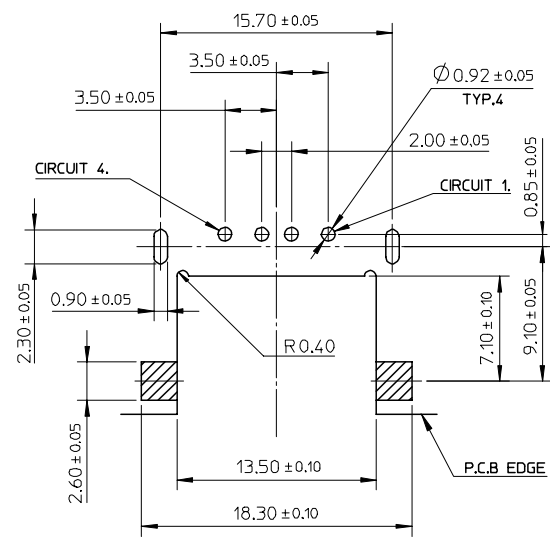
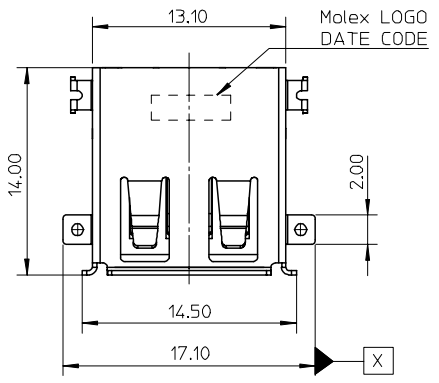

- NOTES:
- MATERIAL:
HOUSING: NYLON PA9T, FIBER GLASS FILLED, UL94V-0. COLOR:BLACK.
TERMINAL: PHOSPHOR BRONZE.
METAL SHELL: BRASS.
 - FINISH:
TERMINAL:
SELECTIVE GOLD(AU) IN CONTACT AREA, THICKNESS=30 MICROINCH MINIMUM;
SELECTIVE TIN IN SOLDER TAIL AREA, THICKNESS=120 MICROINCH MINIMUM;
NICKEL(Ni) OVERALL.
METAL SHELL:
NICKEL(Ni) OVERALL, THICKNESS=40 MICROINCH MINIMUM, UNDER PLATED: COPPER(CU) OVERALL.
 - PRODUCT SPECIFICATION REFER TO PS-48258-001.
 - PACKAGE SPECIFICATION REFER TO PK-48258-001.
 - TEST SUMMARY REFER TO TS-48258-001
 - COPLANARITY TO BE 0.10 mm MAX.
 - LEAD FREE AND RoHS COMPLIANT PRODUCT.
 - DATE CODE:
X X X X X
DAY
WEEK
YEAR

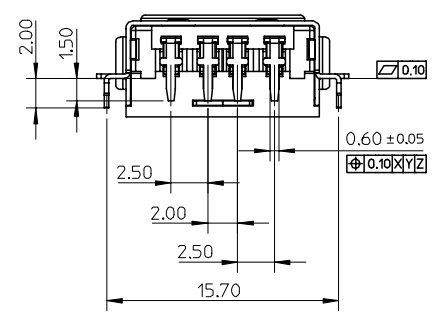
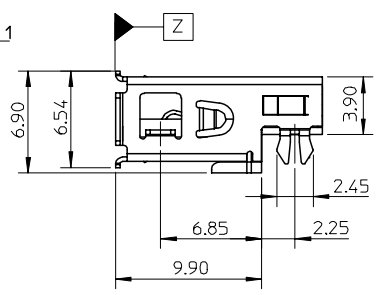
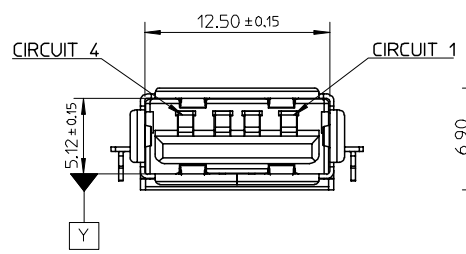

<p>NEW RELEASE EC NO: SH2006-0556 DRW:RTSAI CHKD: APPR:WWSCHANG</p>	<p>2006/07/26 2006/07/26 2006/07/27</p>	<p>DESCRIPTION REV</p>	QUALITY SYMBOLS	GENERAL TOLERANCES (UNLESS SPECIFIED)	DIMENSION STYLE	SCALE	DESIGN UNITS	THIRD ANGLE PROJECTION
			<p>▽=0 ∇=0</p>	<p>mm INCH</p>	<p>MM ONLY</p>	<p>3:1</p>	<p>METRIC</p>	<p>THIRD ANGLE PROJECTION</p>
			<p>4 PLACES ± --- ± --- 3 PLACES ± --- ± --- 2 PLACES ± 0.25 ± --- 1 PLACE ± 0.25 ± ---</p>	<p>DRAWN BY DATE TOM 2006/04/13</p>	<p>CHECKED BY DATE ROGER TSAI 2006/04/13</p>	<p>TITLE USB A SINK REVERSE TYPE (LEAD-FREE VERSION)</p>		
			<p>ANGULAR ± 3 °</p>	<p>APPROVED BY DATE ALLEN LIN 2006/04/13</p>	<p>MATERIAL NO. 48258-0001</p>	<p>DOCUMENT NO. SD-48258-001</p>	<p>SHEET NO. 1 OF 1</p>	

DRAFT WHERE APPLICABLE MUST REMAIN WITHIN DIMENSIONS

MOLEX MOLEX INCORPORATED

THIS DRAWING CONTAINS INFORMATION THAT IS PROPRIETARY TO MOLEX INCORPORATED AND SHOULD NOT BE USED WITHOUT WRITTEN PERMISSION

9 8 7 6 5 4 3 2 1