

**PLEASE CHECK WWW.MOLEX.COM FOR LATEST PART INFORMATION**

**Part Number:** [0353000250](#)  
**Status:** **Active**  
**Overview:** [kk](#)  
**Description:** 2.50mm (.098") Pitch Wire-to-Board KK® Header, Vertical, with Friction Ramp, Tube Packaged Version of 5045, 2 Circuits, Tin (Sn) Plating

**Documents:**

[3D Model](#) [Product Specification PS-35300-001 \(PDF\)](#)  
[Drawing \(PDF\)](#) [RoHS Certificate of Compliance \(PDF\)](#)

**Agency Certification**

CSA LR 19980  
 UL E29179

**General**

Product Family PCB Headers  
 Series [35300](#)  
 Application Wire-to-Board  
 Overview [kk](#)  
 Product Name KK®

**Physical**

Breakaway No  
 Circuits (Loaded) 2  
 Circuits (maximum) 2  
 Color - Resin Natural  
 Durability (mating cycles max) 30  
 First Mate / Last Break No  
 Flammability 94V-0  
 Glow-Wire Compliant No  
 Guide to Mating Part No  
 Keying to Mating Part None  
 Lock to Mating Part Yes  
 Material - Plating Mating Tin  
 Material - Plating Termination Tin  
 Material - Resin Nylon  
 Number of Rows 1  
 Orientation Vertical  
 PCB Locator No  
 PCB Retention None  
 PCB Thickness Recommended (in) 0.062 In  
 PCB Thickness Recommended (mm) 1.60 mm  
 Packaging Type Tube  
 Pitch - Mating Interface (in) 0.098 In  
 Pitch - Mating Interface (mm) 2.50 mm  
 Plating min: Mating (µin) 200  
 Plating min: Mating (µm) 5  
 Plating min: Termination (µin) 200  
 Plating min: Termination (µm) 5  
 Polarized to Mating Part No  
 Polarized to PCB No  
 Shrouded No  
 Stackable No  
 Surface Mount Compatible (SMC) No  
 Temperature Range - Operating -40°C to +105°C  
 Termination Interface: Style Through Hole

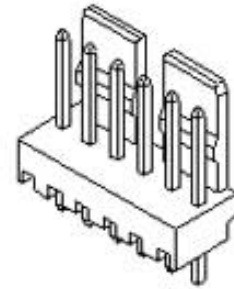

Series

image - Reference only

**EU RoHS**

**ELV and RoHS  
 Compliant**

**REACH SVHC**

**Contains SVHC: No**

**Halogen-Free**

**Status**

**Not Halogen-Free**

**Need more information on product  
 environmental compliance?**

Email [productcompliance@molex.com](mailto:productcompliance@molex.com)  
 For a multiple part number RoHS Certificate of  
 Compliance, [click here](#)

Please visit the [Contact Us](#) section for any  
 non-product compliance questions.

**China RoHS**



**Search Parts in this Series**

[35300Series](#)

**Mates With**

[5051 Housing](#), [51191 Housing](#)

**Electrical**

Current - Maximum per Contact 3A  
Voltage - Maximum 250V

**Material Info****Reference - Drawing Numbers**

Packaging Specification PK-35300-001  
Product Specification PS-35300-001  
Sales Drawing SD-35300-001, SD-35300-010

This document was generated on 05/24/2010

**PLEASE CHECK [WWW.MOLEX.COM](http://WWW.MOLEX.COM) FOR LATEST PART INFORMATION**

DWG. NO.  
SD-35300-001

SIMILAR ITEM

PROJECT NO.

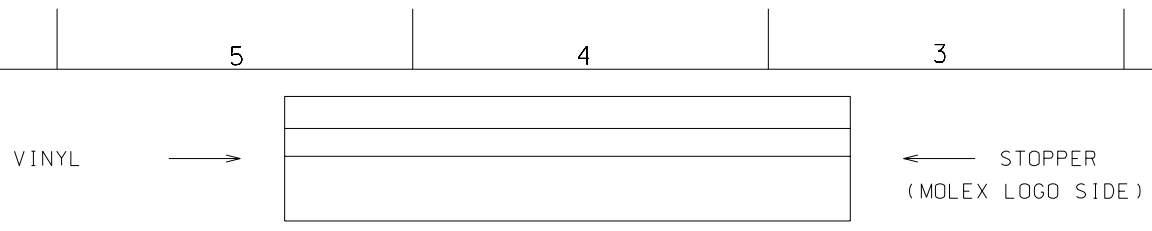

NOTES

1. TUBE : STOPPER & VINYL LOCKING TYPE
2. THICKNESS : 0.6 †
3. LENGTH : 540mm

LEGEND

35300- \*\* 5 \*  
 COLOR : 0 --- NATURAL  
 2 --- RED  
 CKT (02, 03, 04, ....)

5045-NA SERIES

TUBE

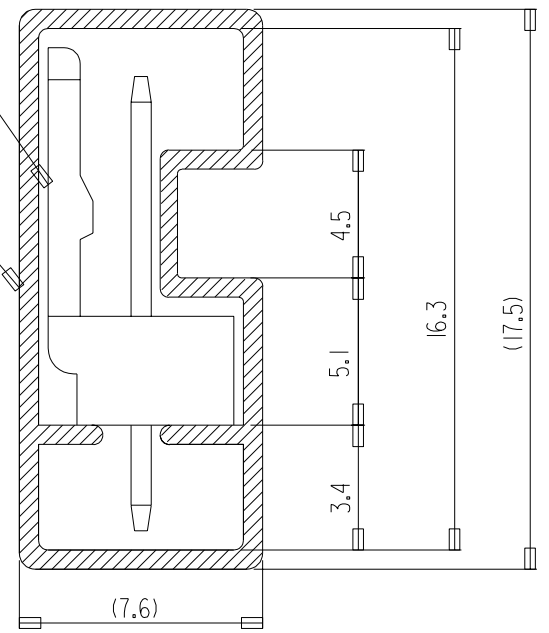

|      |            |           |                |      |
|------|------------|-----------|----------------|------|
| 15   | 35300-155* | 35300155* | 5045-NA SERIES |      |
| 14   | -145*      | 35300145* |                |      |
| 13   | -135*      | 35300135* |                |      |
| 12   | -125*      | 35300125* |                |      |
| 11   | -115*      | 35300115* |                |      |
| 10   | -105*      | 35300105* |                |      |
| 9    | -095*      | 35300095* |                |      |
| 8    | -085*      | 35300085* |                |      |
| 7    | -075*      | 35300075* |                |      |
| 6    | -065*      | 35300065* |                |      |
| 5    | -055*      | 35300055* |                |      |
| 4    | -045*      | 35300045* |                |      |
| 3    | -035*      | 35300035* |                |      |
| 2    | 35300-025* | 35300025* |                | USED |
| CKTS | ENG NO.    | MAT'L NO. |                | ON.  |

|   |                                       |   |                                      |   |  |  |  |   |           |
|---|---------------------------------------|---|--------------------------------------|---|--|--|--|---|-----------|
| NEW RELEASED<br>EC NO. KOR2004-0124<br>DRWN: K.S.KIM (040324)<br>CHK: J.K.OH<br>APPR: C.W.LEE | DESCRIPTION<br>MAJOR<br>CRITICAL<br>C | GENERAL TOLERANCES:<br>(UNLESS SPECIFIED) |                                      | SCALE<br>NONE   | DESIGN UNITS<br><input checked="" type="checkbox"/> mm <input type="checkbox"/> INCH | <input type="checkbox"/> THIRD ANGLE<br><input checked="" type="checkbox"/> PROJECTION | DIMENSIONS:<br><input type="checkbox"/> mm <input type="checkbox"/> INCH<br><input type="checkbox"/> mm ONLY | SHT<br>REV  |           |
|   |                                       | 4 PLACES ±0.    ±.                        | DRAWN BY & DATE<br>H.S.SHIN (910120) | TITLE:<br>TUBE PACKAGED<br>FOR 5045-NA SERIES           |  |  |  |   |           |
|   |                                       | 3 PLACES ±0.    ±.                        | CHECKED BY & DATE<br>J.K.OH          |   |  |  |  |   |           |
|   |                                       | 2 PLACES ±0.    ±.                        | APPROVED BY & DATE<br>C.W.LEE        | MOLEX INCORPORATED                                      |  |  |  |   |           |
| 1 PLACE ±0.    ±.   | CAD FILENAME<br>SD-35300-001.dgn      | MATERIAL NO.<br>SEE TABLE                 | DRAWING NO.<br>SD-35300-001          |   |  |  | SHEET NO.<br>1 OF 1  |   |           |
| A   | REV                                   | ANGULAR: ± °                              |                                      | DRAFT WHERE APPLICABLE MUST<br>REMAIN WITHIN DIMENSIONS |  |  |  | THIS DRAWING CONTAINS INFORMATION THAT IS PROPRIETARY TO MOLEX<br>INCORPORATED AND SHOULD NOT BE USED WITHOUT WRITTEN PERMISSION. | SIZE<br>A |

5

4

3

2

MX-A4

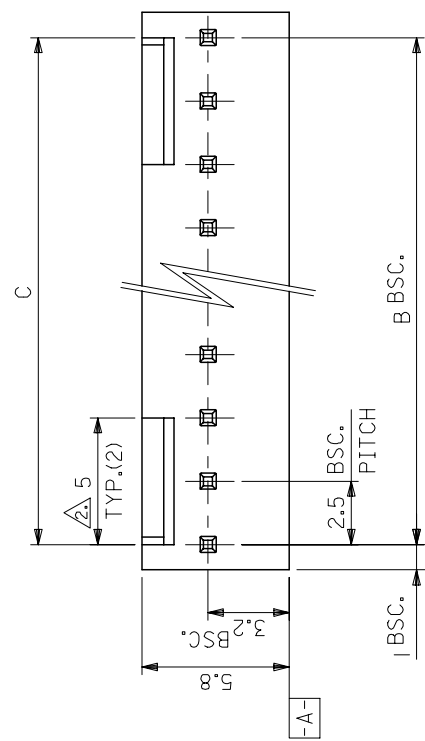

NOTE.

1. MATERIAL

- PIN: 0.635x14.2 BRASS TIN OVER COPPER PLATING.
- WAFER: NYLON66, UL94V-0
- △ TO BE APPLIED FOR 6 CKT. AND MORE THEN 6 CKT.
- 3. NO SLIT IS PROVIDED FOR 5 CKT. AND LESS THAN 5 CKT.

NON-ACCUMULATIVE

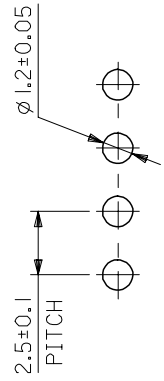

RECOMMENDED P.C.BOARD HOLE DIM.

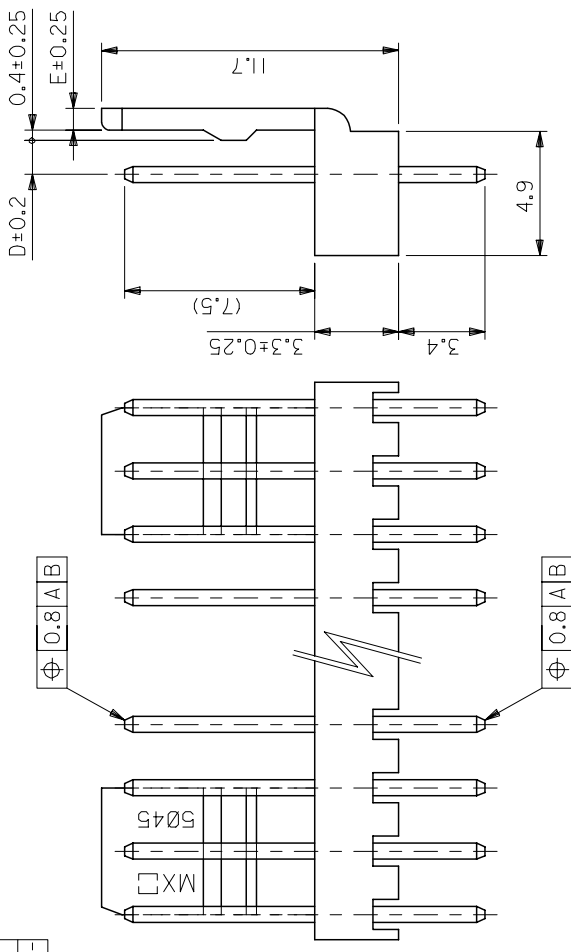

| D    | E    | C    | B    | APPLIED CONNECTOR |          | ENG. NO.   | CKT. |
|------|------|------|------|-------------------|----------|------------|------|
|      |      |      |      | EDP. NO.          | ENG. NO. |            |      |
| 1.35 | 0.85 | 35   | 35   | 22-04-1151        | 5045-15A | 35300-1550 | 15   |
|      |      | 32.5 | 32.5 | -1141             | -14A     | 35300-1450 | 14   |
|      |      | 30   | 30   | -1131             | -13A     | 35300-1350 | 13   |
|      |      | 27.5 | 27.5 | -1121             | -12A     | 35300-1250 | 12   |
|      |      | 25   | 25   | -1111             | -11A     | 35300-1150 | 11   |
|      |      | 22.5 | 22.5 | -1101             | -10A     | 35300-1050 | 10   |
|      |      | 20   | 20   | -1091             | -09A     | 35300-0950 | 9    |
|      |      | 17.5 | 17.5 | -1081             | -08A     | 35300-0850 | 8    |
|      |      | 15   | 15   | -1071             | -07A     | 35300-0750 | 7    |
|      |      | 12.5 | 12.5 | -1061             | -06A     | 35300-0650 | 6    |
|      |      | 10   | 10   | -1051             | -05A     | 35300-0550 | 5    |
| 1.35 | 0.85 | 7.5  | 7.5  | -1041             | -04A     | 35300-0450 | 4    |
| 1.2  | 1    | 5    | 5    | -1031             | -03A     | 35300-0350 | 3    |
| 1.2  | 1    | 2.5  | 2.5  | 22-04-1021        | 5045-02A | 35300-0250 | 2    |

DO NOT SCALE DRAWING  
DIMENSION IN METRIC

|              |                      |                        |               |               |     |
|--------------|----------------------|------------------------|---------------|---------------|-----|
| NEW RELEASED | ECN NO. KOR2006-0082 | DRWN: K.S.KIM (060102) | CHK: Y.SOOKIM | APP: S.H.CHOI | REV |
|              |                      |                        |               |               | A   |

|                 |             |
|-----------------|-------------|
| QUALITY SYMBOLS | DESCRIPTION |
| MAJOR           | ▲           |
| CRITICAL        | △           |

|   |       |              |                        |
|---|-------|--------------|------------------------|
| GENERAL TOLERANCES:<br>(UNLESS SPECIFIED) | SCALE | DESIGN UNITS | THIRD ANGLE PROJECTION |
| 4 PLACES ±0.                              | 5:1   | MM/INCH      | ☉                      |
| 3 PLACES ±0.                              |       |              |                        |
| 2 PLACES ±0.                              |       |              |                        |
| 1 PLACE ±0.                               |       |              |                        |
| ANGULAR: ± °                              |       |              |                        |

|                                     |  |                                       |  |
|-------------------------------------|--|---------------------------------------|--|
| TITLE: KK 2.5 WAFER ASS'Y WITH LOCK |  | SHEET NO. 1 OF 1                      |  |
| DRAWN BY & DATE: Y.SOOKIM           |  | REVISE ON CAD ONLY                    |  |
| CHECKED BY & DATE: Y.SOOKIM         |  | MATERIAL NO. DRAWING NO. SD-35300-010 |  |
| APPROVED BY & DATE: S.H.CHOI        |  | MOLEX INCORPORATED                    |  |
| CAD FILENAME                        |  | KOREA                                 |  |
| DRAWING NO. SD-35300-010            |  | MX-A3                                 |  |

|                    |      |
|--------------------|------|
| ANGLE              | ±3°  |
| 30 OVER            | ±0.4 |
| 10 OVER 30 UNDER   | ±0.4 |
| 10 UNDER           | ±0.4 |
| GENERAL TOLERANCES |      |