

PLCC-4 (BI-COLOR) PACKAGE SURFACE MOUNT LED LAMP

PACKAGE DIMENSIONS

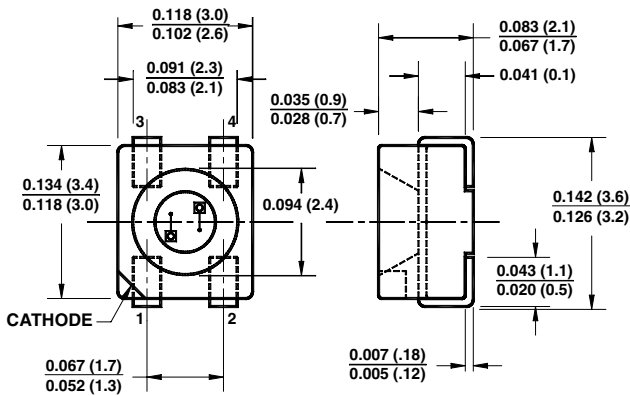

NOTE:

1. All dimensions are in inches (mm).
2. Pin-out connections are on page 3.

HER / PURE GREEN

QTLP670C25.7744D

FEATURES

- Non-diffused package excellent for back-lighting and coupling to light pipe
- Low package profile
- Wide viewing angle of 120°
- Moisture proof packaging

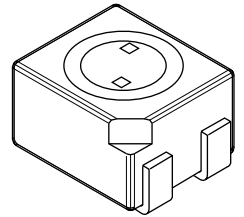

DESCRIPTION

This bi-color surface mount lamp is designed with a flat top and sides for automatic placement equipment. It is compatible with convective IR and vapor phase reflow soldering and conductive epoxy attachment process. The package size and configuration conform to EIA-535 BAAC standard specification for case size 3528 tantalum capacitor.

ABSOLUTE MAXIMUM RATINGS ($T_A = 25^\circ\text{C}$ unless otherwise specified)

Parameter	Symbol	Rating	Unit
Operating Temperature	T_{OPR}	-40 to +100	$^\circ\text{C}$
Storage Temperature	T_{STG}	-40 to +100	$^\circ\text{C}$
Lead Soldering Time	T_{SOL}	260 for 5 sec	$^\circ\text{C}$
Continuous Forward Current	I_F	30	mA
Peak Forward Current ($f = 1.0 \text{ KHz}$, Duty Factor = 1/10)	I_F	160	mA
Reverse Voltage ($I_R = 10 \mu\text{A}$)	V_R	5	V
Power Dissipation	P_D	100	mW

ELECTRICAL / OPTICAL CHARACTERISTICS ($T_A = 25^\circ\text{C}$)

Part Number	QTLP670C25.7744D	Condition
Luminous Intensity (mcd)		$I_F = 20 \text{ mA}$
Red - Cat 17 & 18	4 - 8, 6.5 - 13	
Green - Cat 15 & 16	1.5 - 3.0, 2.5 - 5.0	
Forward Voltage (V)		$I_F = 20 \text{ mA}$
Maximum	2.8 / 2.8	
Typical	2.0 / 2.0	
Wavelength (nm)		$I_F = 20 \text{ mA}$
Peak	635 / 555	
Dominant	628 / 560	
Spectral Line Half Width (nm)	45 / 22	$I_F = 20 \text{ mA}$
Viewing Angle ($^\circ$)	120	$I_F = 20 \text{ mA}$

PLCC-4 (BI-COLOR) PACKAGE SURFACE MOUNT LED LAMP

HER / PURE GREEN QTLP670C25.7744D

TYPICAL PERFORMANCE CURVES

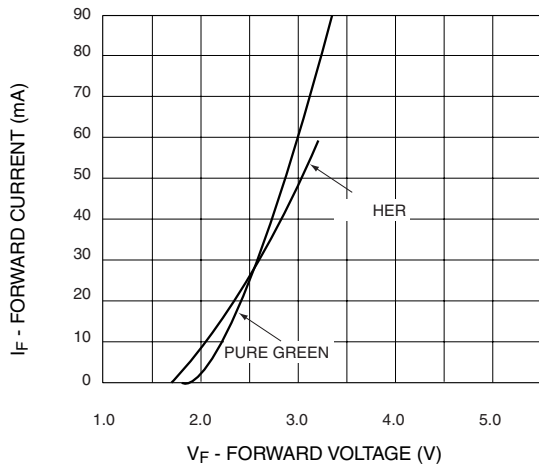

Fig. 1 Forward Current vs. Forward Voltage

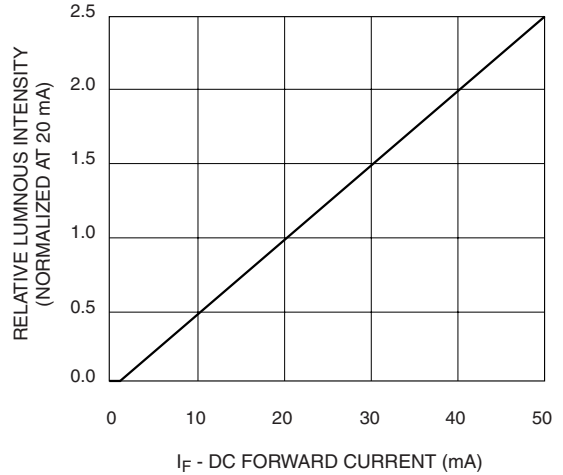

Fig. 2 Relative Luminous Intensity vs. DC Forward Current

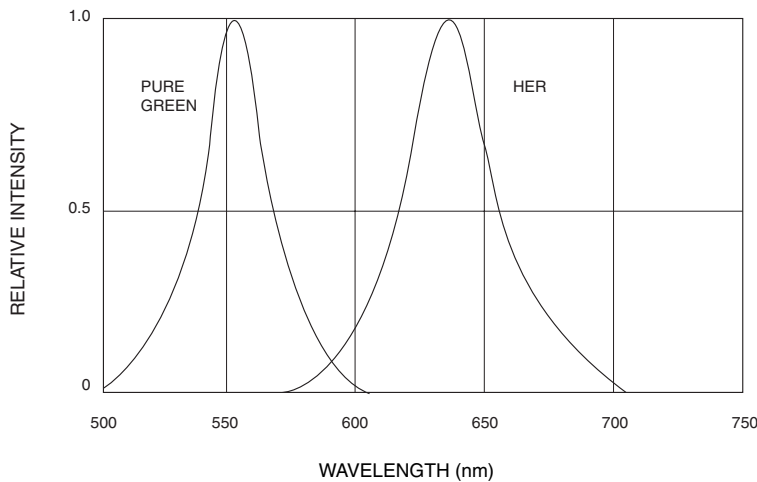

Fig. 3 Relative Intensity vs. Peak Wavelength

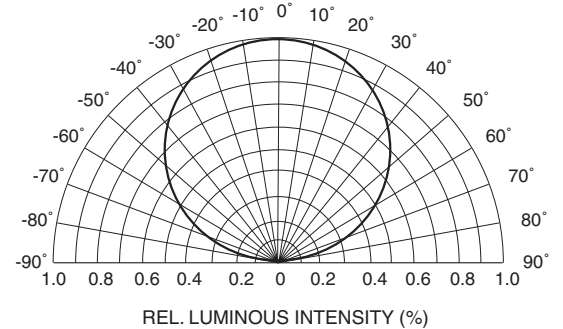

Fig. 4 Radiation Diagram

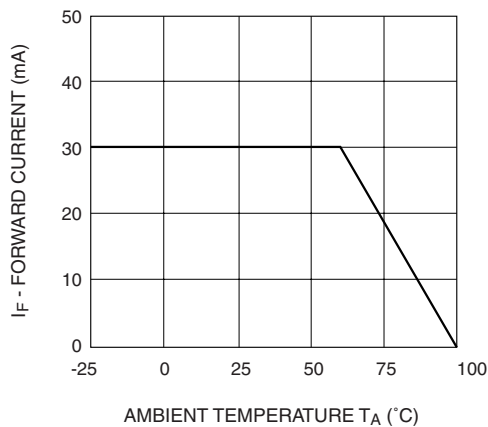

Fig. 5 Forward Current vs. Ambient Temperature



PLCC-4 (BI-COLOR) PACKAGE SURFACE MOUNT LED LAMP

HER / PURE GREEN QTLP670C25.7744D

PIN-OUT

Part Number	Pin #1	Pin #2	Pin #3	Pin #4
QTLP670C-25	HER (-)	Pure Green (+)	HER (+)	Pure Green (-)

RECOMMENDED PRINTED CIRCUIT BOARD PATTERN

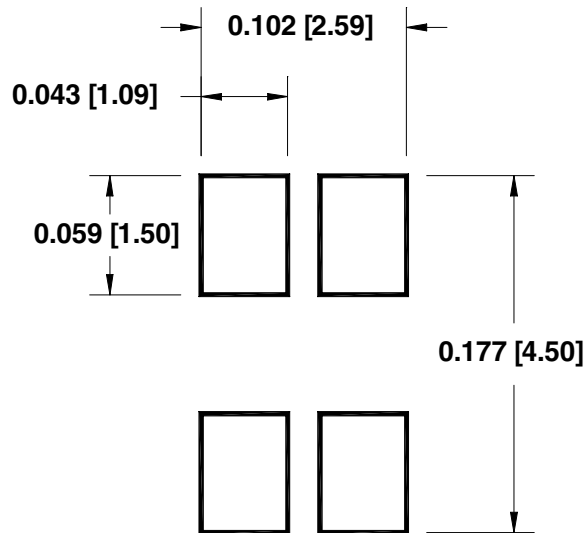

RECOMMENDED IR REFLOW SOLDERING PROFILE

