

**PLEASE CHECK WWW.MOLEX.COM FOR LATEST PART INFORMATION**

**Part Number:** [0365150128](#)  
**Status:** **Active**  
**Overview:** [din\\_41612](#)  
**Description:** 2.54mm (.100") Pitch DIN 41612 R Style Male Header with Wire-Wrap, Vertical, Through Hole Press-Fit, 0.60µm (24µ") Selective Gold (Au) Plating, 96 Circuits, with Mounting Clips, No First-Mate-Last-Break, Solder tail Length 17.00mm(.669")

**Documents:**

[Drawing \(PDF\)](#) [RoHS Certificate of Compliance \(PDF\)](#)  
[Product Specification PS-36515-001 \(PDF\)](#)

**General**

Product Family	Backplane Connectors
Series	<a href="#">36515</a>
Application	Backplane
Comments	With Mounting Clips. No First-Mate-Last-Break
Component Type	PCB Header
Overview	<a href="#">din_41612</a>
Product Name	IEC 603-2/DIN 41612
Style	R

**Physical**

Circuits (Loaded)	96
Circuits (maximum)	96
Circuits Detail	1,2,3,...32; a+b+c
Color - Resin	Gray
Durability (mating cycles max)	400
First Mate / Last Break	No
Guide to Mating Part	No
Keying to Mating Part	Yes
Material - Metal	Phosphor Bronze
Material - Plating Mating	Gold
Material - Plating Termination	Nickel
Material - Resin	Polyester
Number of Columns	32
Number of Pairs	Open Pin Field
Number of Rows	3
Orientation	Vertical
PC Tail Length (in)	0.669 In
PC Tail Length (mm)	17.00 mm
PCB Locator	No
PCB Retention	Yes
PCB Thickness Recommended (in)	0.063 In
PCB Thickness Recommended (mm)	1.60 mm
Packaging Type	Carton
Pitch - Mating Interface (in)	0.100 In
Pitch - Mating Interface (mm)	2.54 mm
Pitch - Term. Interface (in)	0.100 In
Pitch - Term. Interface (mm)	2.54 mm
Plating min: Mating (µin)	24
Plating min: Mating (µm)	0.60
Plating min: Termination (µin)	49
Plating min: Termination (µm)	1.25
Polarized to PCB	No
Stackable	No
Surface Mount Compatible (SMC)	No

**EU RoHS** **China RoHS**

**Compliance Status**

**Not Reviewed**

**REACH SVHC**

**Not Reviewed**

**Halogen-Free**

**Status**

**Not Reviewed**

**Need more information on product environmental compliance?**

Email [productcompliance@molex.com](mailto:productcompliance@molex.com)  
 For a multiple part number RoHS Certificate of Compliance, [click here](#)

Please visit the [Contact Us](#) section for any non-product compliance questions.

**Search Parts in this Series**

[36515Series](#)

Temperature Range - Operating  
Termination Interface: Style

-55°C to +125°C  
Through Hole - Compliant Pin, Wire Wrap

**Electrical**

Current - Maximum per Contact  
Data Rate  
Voltage - Maximum

1A  
622.0 Mbps  
250V AC (RMS)

**Material Info**

Old Part Number

36515 0128

**Reference - Drawing Numbers**

Product Specification  
Sales Drawing

PS-36515-001  
SD-36515-006

This document was generated on 05/13/2010

**PLEASE CHECK [WWW.MOLEX.COM](http://WWW.MOLEX.COM) FOR LATEST PART INFORMATION**

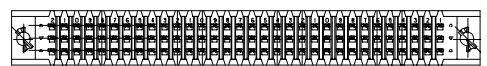
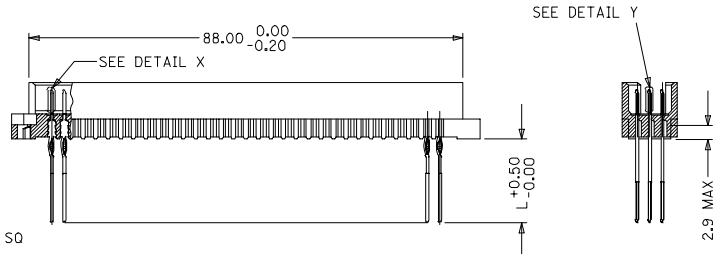
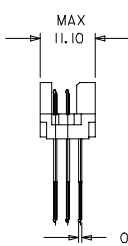
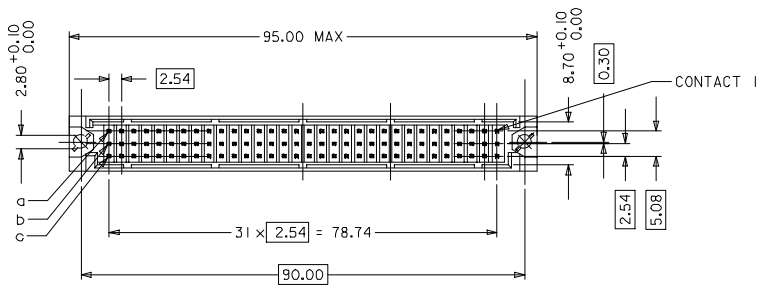

WITH MOUNTING CLIPS

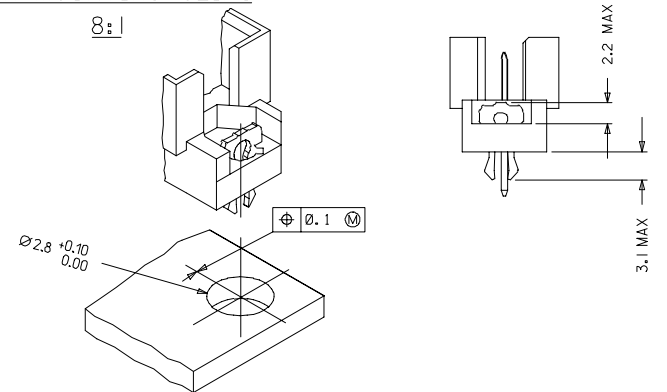

- NOTES:
- MATERIALS: THERMOPLASTIC POLYESTER, GLASS FILLED, UL94V-0, COLOUR: PEBBLE GREY RAL 7032  
TERMINAL - PHOSPHOR BRONZE  
MOUNTING CLIP: STEEL
  - FINISH: TERMINAL:-  
CONTACT AREA  
1. PERFORMANCE LEVEL 1: SELECTIVE GOLD (Au), THICKNESS = 1.1 MICROMETER OVER NICKEL, THICKNESS = 1.25 MICROMETER MIN  
2. PERFORMANCE LEVEL 2: SELECTIVE GOLD (Au), THICKNESS = 0.6 MICROMETER OVER NICKEL, THICKNESS = 1.25 MICROMETER MIN  
3. PERFORMANCE LEVEL 3: SELECTIVE GOLD (Au), THICKNESS = 0.3 MICROMETER OVER NICKEL, THICKNESS = 1.25 MICROMETER MIN  
PRESS-IN AREA: NICKEL, THICKNESS 4.25 MICROMETER MIN OVERALL  
WRAP AREA: NICKEL, THICKNESS = 1.25 MICROMETER MIN OVERALL  
ADAPTER INSERTION AREA: PERFORMANCE LEVEL 3: SELECTIVE GOLD (Au), THICKNESS = 0.3 MICROMETER OVER NICKEL, THICKNESS = 1.25 MICROMETER MIN
  - MOUNTING CLIP:-  
TIN (Sn), THICKNESS = 5-10 MICROMETER,  
OVER NICKEL (Ni), THICKNESS = 2.5 MICROMETER
  - FOR NON MOUNTING CLIP OPTION, CONNECTOR TO BE SECURED WITH RIVETS: 2 TUBULAR RIVETS 2.5 x 0.3 ... DIN 7340  
SCREWS: 2 CHEESEHEAD SCREWS M2.5 x ... DIN 84 AND 2 HEXAGONAL NUTS M2.5 DIN 934
  - MATERIAL NUMBER, BATCH CODE, UL AND CSA MARKING TO BE PRINTED ON THE CONNECTOR
  - CUT FACE OF TIP WITHOUT PLATING PERMITTED
  - PRODUCT SPECIFICATION PS-36515-001

RECOMMENDED PCB LAYOUT  
COMPONENT SIDE

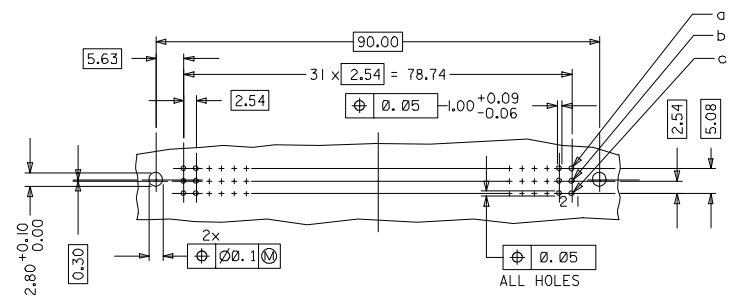

RoHS COMPLIANT

EC No: 2007-0044 DRINGSATTI/MARZO 2006/10/10 CHIKKOSUDHIR 2006/10/11 APPRESSUDHIR 2006/10/15	QUALITY SYMBOLS ▽=0 ▽=0	GENERAL TOLERANCES (UNLESS SPECIFIED)		DIMENSION STYLE MM ONLY		SCALE 2:1	DESIGN UNITS METRIC	THIRD ANGLE PROJECTION
		4 PLACES ± 0.15 ± ---	INCH	DRAWN BY SS	DATE 1999/09/24	TITLE ASSY, DIN 41612, R MALE 96P, PRESS-IN, WIRE WRAP		
C1	DESCRIPTION	3 PLACES ± 0.05 ± ---	CHECKED BY G J LOWE	DATE 1999/09/24	MATERIAL NO. SD-36515-006			
		2 PLACES ± 0.1 ± ---	APPROVED BY G J LOWE	DATE 1999/09/24	DOCUMENT NO. MOLEX INCORPORATED			
DRAFT WHERE APPLICABLE MUST REMAIN WITHIN DIMENSIONS		1 PLACE ± 0.15 ± ---	SIZE A 1		THIS DRAWING CONTAINS INFORMATION THAT IS PROPRIETARY TO MOLEX INCORPORATED AND SHOULD NOT BE USED WITHOUT WRITTEN PERMISSION			

MATERIAL No.	MOLEX ENG No.	PERF LEVEL	PLATING	CONTACT SEQUENCE/ROW	DIM "L" MM	MOUNTING CLIP	FMLB
36515-0121	MM-B1467-R960	1	Au + Ni	1,2,3...32 a+b+c	17	NO	NO
36515-0122	MM-B1567-R960	2	Au + Ni	1,2,3...32 a+b+c	17	NO	NO
36515-0123	MM-B1667-R960	3	Au + Ni	1,2,3...32 a+b+c	17	NO	NO
36515-0127	MM-B1467-R910	1	Au + Ni	1,2,3...32 a+b+c	17	YES	NO
36515-0128	MM-B1567-R910	2	Au + Ni	1,2,3...32 a+b+c	17	YES	NO
36515-0129	MM-B1667-R910	3	Au + Ni	1,2,3...32 a+b+c	17	YES	NO
36515-0133	MM-B1467-R930	1	Au + Ni	1,2,3...32 a+b+c	17	NO	1,32a 1,32b 1,32c
36515-0134	MM-B1567-R930	2	Au + Ni	1,2,3...32 a+b+c	17	NO	1,32a 1,32b 1,32c
36515-0135	MM-B1667-R930	3	Au + Ni	1,2,3...32 a+b+c	17	NO	1,32a 1,32b 1,32c
36515-0139	MM-B1467-R950	1	Au + Ni	1,2,3...32 a+b+c	17	YES	1,32a 1,32b 1,32c
36515-0140	MM-B1567-R950	2	Au + Ni	1,2,3...32 a+b+c	17	YES	1,32a 1,32b 1,32c
36515-0141	MM-B1676-R950	3	Au + Ni	1,2,3...32 a+b+c	17	YES	1,32a 1,32b 1,32c

DETAILY      DETAILX

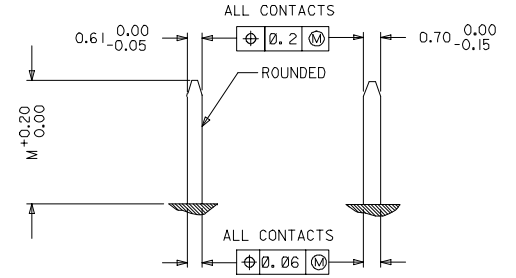

PRE MATING CONTACTS	5.4
NORMAL CONTACTS	4.8
	M

RoHS COMPLIANT

EC No: 2007/0044 DRAWING APPROVED 2006/10/10 CHECKED BY APPRESSOR 2006/10/11 APPROVED BY APPRESSOR 2006/10/15	QUALITY SYMBOLS 	GENERAL TOLERANCES (UNLESS SPECIFIED) <table border="1"> <thead> <tr> <th></th> <th>mm</th> <th>INCH</th> </tr> </thead> <tbody> <tr> <td>4 PLACES</td> <td>± 0.15</td> <td>± 0.005</td> </tr> <tr> <td>3 PLACES</td> <td>± 0.05</td> <td>± 0.002</td> </tr> <tr> <td>2 PLACES</td> <td>± 0.1</td> <td>± 0.004</td> </tr> <tr> <td>1 PLACE</td> <td>± 0.15</td> <td>± 0.006</td> </tr> </tbody> </table>		mm	INCH	4 PLACES	± 0.15	± 0.005	3 PLACES	± 0.05	± 0.002	2 PLACES	± 0.1	± 0.004	1 PLACE	± 0.15	± 0.006	DIMENSION STYLE <b>MM ONLY</b>	SCALE <b>2:1</b>	DESIGN UNITS <b>METRIC</b>	THIRD ANGLE PROJECTION 
		mm	INCH																		
4 PLACES	± 0.15	± 0.005																			
3 PLACES	± 0.05	± 0.002																			
2 PLACES	± 0.1	± 0.004																			
1 PLACE	± 0.15	± 0.006																			
DRAWN BY SS 1999/09/24 CHECKED BY GJLOWE 1999/09/24 APPROVED BY GJLOWE 1999/09/24	MATERIAL NO. <b>SEE CHART</b>	DOCUMENT NO. <b>SD-36515-006</b>	SHEET NO. <b>2 OF 2</b>																		