

DIP POWER CHOKE COIL

SHM119HJA SERIES

1. PART NO. EXPRESSION :

S H M 1 1 9 H J A - 1 R 0 M F
 (a) (b) (c) (d)(e)

- (a) Series code
- (b) Dimension code
- (c) Inductance code : 1R0 = 1.00uH
- (d) Tolerance code : M = ±20%
- (e) F : RoHS Compliant

2. CONFIGURATION & DIMENSIONS :

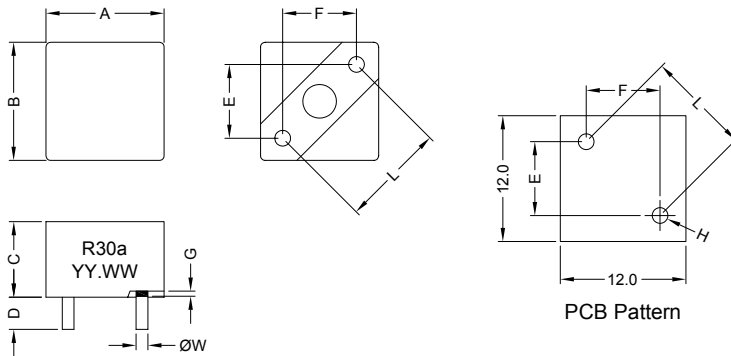

Unit:m/m

Series	A	B	C	D	E	F	ØW	L	G	H
SHM119HJA-R30MF	11.5 Max.	11.5 Max.	10.0 Max.	3.4±0.5	6.6±0.5	6.6±0.5	1.5±0.1	9.3±0.5	0.5±0.2	1.8 Typ.
SHM119HJA-R45MF	11.5 Max.	11.5 Max.	10.0 Max.	3.4±0.5	6.6±0.5	6.6±0.5	1.5±0.1	9.3±0.5	0.5±0.2	1.8 Typ.
SHM119HJA-R68MF	11.5 Max.	11.5 Max.	10.0 Max.	3.4±0.5	6.6±0.5	6.6±0.5	1.5±0.1	9.3±0.5	0.5±0.2	1.8 Typ.
SHM119HJA-1R0MF	11.5 Max.	11.5 Max.	10.0 Max.	3.4±0.5	6.6±0.5	6.6±0.5	1.5±0.1	9.3±0.5	0.5±0.2	1.8 Typ.
SHM119HJA-1R2MF	11.5 Max.	11.5 Max.	10.0 Max.	3.4±0.5	6.6±0.5	6.6±0.5	1.4±0.1	9.3±0.5	0.5±0.2	1.7 Typ.
SHM119HJA-1R5MF	11.5 Max.	11.5 Max.	10.0 Max.	3.4±0.5	6.6±0.5	6.6±0.5	1.3±0.1	9.3±0.5	0.5±0.2	1.6 Typ.
SHM119HJA-2R2MF	11.5 Max.	11.5 Max.	10.0 Max.	3.4±0.5	6.6±0.5	6.6±0.5	1.2±0.1	9.3±0.5	0.5±0.2	1.5 Typ.

3. SCHEMATIC :

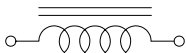

4. MATERIALS :

- (a) Core : SF3 Alloy Powder
- (b) Wire : Enamelled Copper Wire
- (c) Solder : Sn99.95%-Cu0.05%



RoHS Compliant

NOTE : Specifications subject to change without notice. Please check our website for latest information.

12.05.2010



SUPERWORLD ELECTRONICS (S) PTE LTD

5. GENERAL SPECIFICATION :

- a) Test Frequency : 100KHz/1.0V
- b) Operating temp. : -25°C to +125°C
- c) Ambient temp. : 20°C
- d) Irms (A) : Will cause an approximately temp. rise $\Delta T \leq 40^\circ\text{C}$
- e) Isat (A) : Will cause L₀ to drop approximately 30%
- f) Part temperature (ambient + temp. rise) : Should not exceed 125°C under worst case operating conditions.

6. ELECTRICAL CHARACTERISTICS :

Part No.	Inductance L ₀ (uH) ±20% @ 0A _{dc}	Irms (A) Max.	Isat (A) Max.	DCR (mΩ) ±8%	Q Min.
SHM119HJA-R30MF	0.30	40	55	0.37	20
SHM119HJA-R45MF	0.45	35	50	0.36	40
SHM119HJA-R68MF	0.68	34	44	0.56	40
SHM119HJA-1R0MF	1.00	32	40	0.76	40
SHM119HJA-1R2MF	1.20	30	36	0.90	40
SHM119HJA-1R5MF	1.50	28	35	1.30	40
SHM119HJA-2R2MF	2.20	25	30	1.80	40

7. CHARACTERISTICS CURVES :

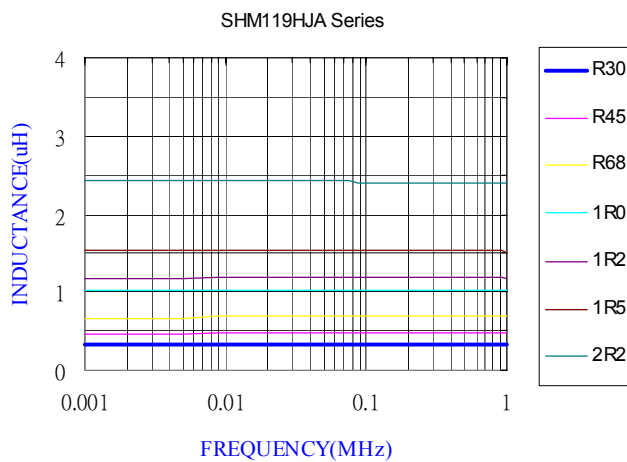

Frequency (MHz)	Inductance (uH)						
	R30	R45	R68	1R0	1R2	1R5	2R2
0.001	0.31	0.46	0.67	1.02	1.17	1.53	2.42
0.05	0.33	0.48	0.69	1.03	1.19	1.54	2.42
0.1	0.33	0.48	0.69	1.03	1.18	1.54	2.41
0.3	0.33	0.48	0.69	1.02	1.18	1.53	2.40
0.5	0.32	0.48	0.69	1.02	1.18	1.53	2.40
0.8	0.32	0.48	0.69	1.02	1.18	1.53	2.40
1.0	0.32	0.47	0.68	1.02	1.17	1.52	2.39



RoHS Compliant

NOTE : Specifications subject to change without notice. Please check our website for latest information.

12.05.2010



SUPERWORLD ELECTRONICS (S) PTE LTD

7. CHARACTERISTICS CURVES :

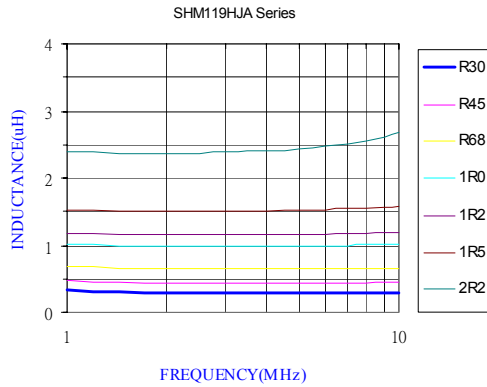

Frequency (MHz)	Inductance (uH)						
	R30	R45	R68	1R0	1R2	1R5	2R2
1	0.32	0.47	0.68	1.02	1.17	1.52	2.39
2	0.29	0.44	0.65	0.99	1.15	1.50	2.37
3	0.29	0.44	0.65	0.99	1.15	1.50	2.39
4	0.29	0.44	0.65	0.99	1.15	1.51	2.41
5	0.29	0.44	0.65	0.99	1.16	1.52	2.43
6	0.29	0.44	0.65	1.00	1.16	1.53	2.47
7	0.29	0.44	0.65	1.00	1.17	1.54	2.51
8	0.29	0.44	0.66	1.01	1.18	1.55	2.56
9	0.29	0.45	0.66	1.01	1.19	1.57	2.62
10	0.29	0.45	0.66	1.02	1.20	1.59	2.69

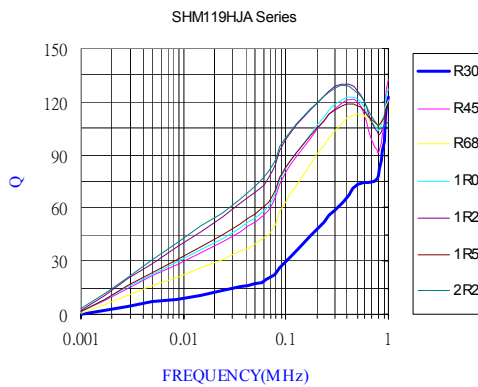

Frequency (MHz)	Q						
	R30	R45	R68	1R0	1R2	1R5	2R2
0.001	0.34	1.19	0.95	1.54	2.16	1.82	2.75
0.05	16.8	51.8	39.7	54	68.9	56.5	71.8
0.1	29.4	79.7	63.3	81.6	98.2	82.6	100.1
0.3	59.1	115.7	103.6	118.3	128.5	115.4	127.4
0.5	73.5	119.8	112.8	121.7	126.3	117.9	124.5
0.8	77.8	91.1	106.5	103.7	101.3	106.4	105.5
1.0	122.1	132	121	126.7	117.6	118.3	108

NOTE : Specifications subject to change without notice. Please check our website for latest information.



RoHS Compliant

12.05.2010



7. CHARACTERISTICS CURVES :

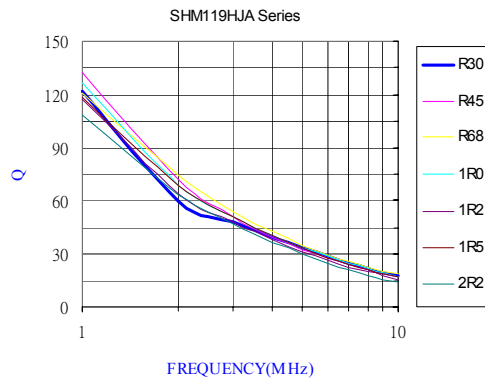

Frequency (MHz)	Q						
	R30	R45	R68	1R0	1R2	1R5	2R2
1	122.1	132	121	126.7	117.6	118.3	108
2	59.9	72.1	74.3	68.5	63.8	68.9	63.7
3	48.1	51.3	54.2	51.1	47.6	51.2	46.9
4	39.2	39.8	42.5	40.5	37.6	40.5	36.7
5	33.1	32.7	35.1	33.4	31.1	33.4	29.8
6	28.3	27.6	29.7	28.4	26.3	28.2	24.8
7	24.6	23.9	25.7	24.6	22.7	24.3	21
8	21.8	21	22.6	21.6	19.9	21.2	18
9	19.5	18.8	20.2	19.2	17.7	18.8	15.6
10	17.6	17	18.2	17.2	15.8	16.7	13.6



RoHS Compliant

NOTE : Specifications subject to change without notice. Please check our website for latest information.

12.05.2010



SUPERWORLD ELECTRONICS (S) PTE LTD

7. CHARACTERISTICS CURVES :

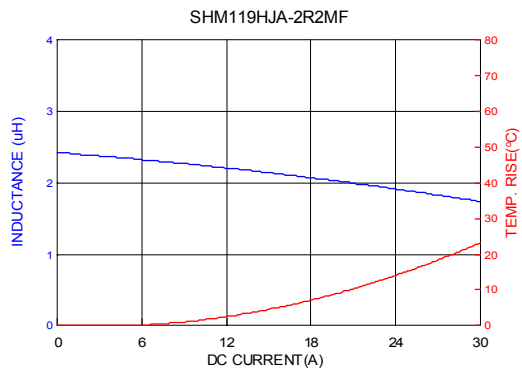
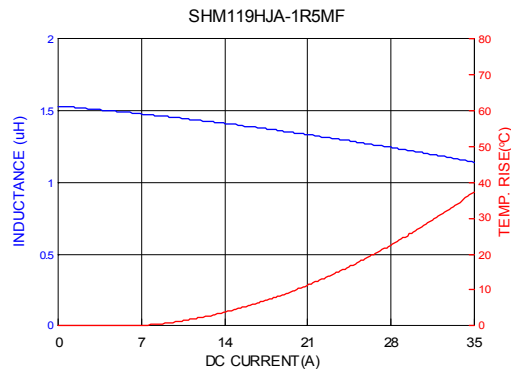
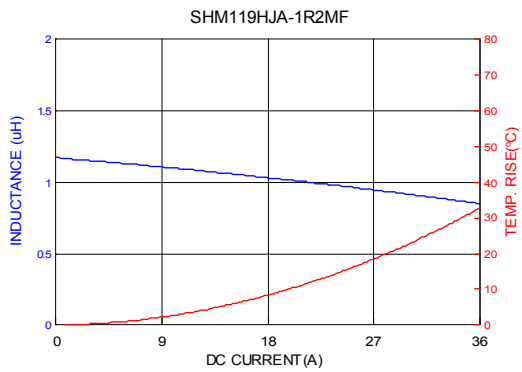
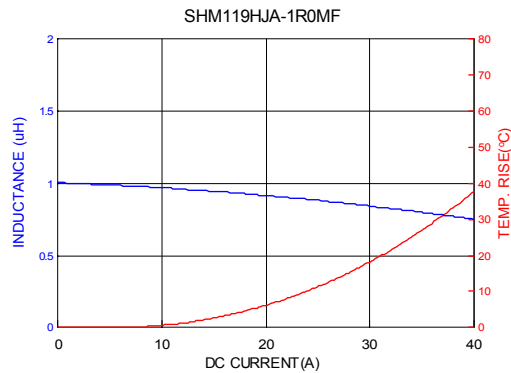
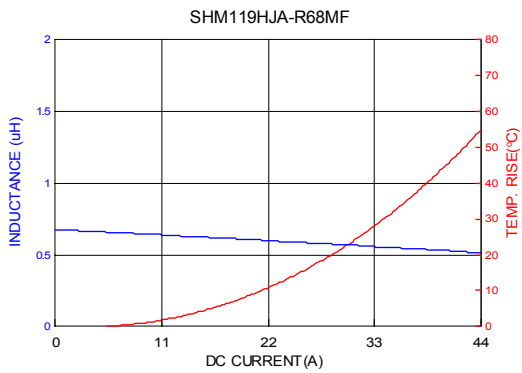
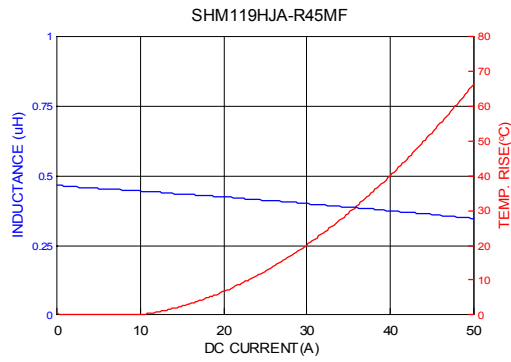
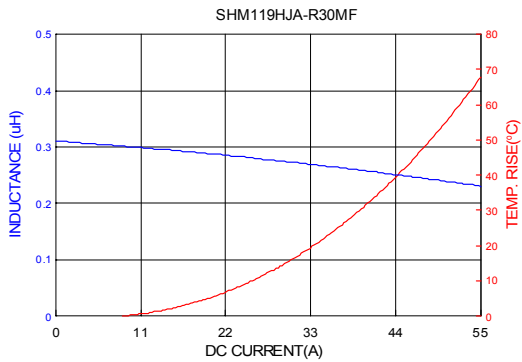

RoHS Compliant

NOTE : Specifications subject to change without notice. Please check our website for latest information.

12.05.2010



SUPERWORLD ELECTRONICS (S) PTE LTD

8. RELIABILITY AND TEST CONDITION :

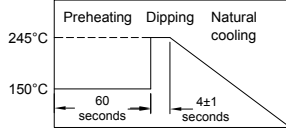
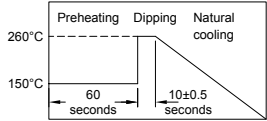
ITEM	PERFORMANCE	TEST CONDITION														
Electrical Characteristics Test																
Inductance	Refer to standard electrical characteristics list	HP4284A or CH3302/1320/1320S														
DCR		HIOKI3540														
Heat Rated Current (Irms)		Irms(A) will cause an temp rise $\leq 40^{\circ}\text{C}$ typ.														
Saturation Current (Isat)		Isat(A) will cause Lo to drop approximately 30%														
Mechanical Performance Test																
Solderability Test	More than 90% of the terminal electrode should be covered with solder.	 <p>After fluxing, component shall be dipped in a melted solder bath at $245\pm 5^{\circ}\text{C}$ for 5 seconds</p>														
Solder Heat Resistance	1. Appearance : No significant abnormality 2. Inductance change : Within $\pm 10\%$ of initial value	Preheat : 150°C , 60sec. Solder : lead free Solder Temperature : $260\pm 5^{\circ}\text{C}$ Flux : rosin Dip Time : 10 ± 0.5 sec. 														
Reliability Test																
High Temperature Life Test	1. Appearance : No damage 2. Inductance : Within $\pm 10\%$ of initial value.	Temperature : $85\pm 5^{\circ}\text{C}$ Time : 500 ± 12 hours Recovery: 4 to 24hrs of recovery under the standard condition after the removal from test chamber														
Low Temperature Life Test		Temperature : $-20\pm 5^{\circ}\text{C}$ Time : 500 ± 12 hours Recovery: 4 to 24hrs of recovery under the standard condition after the removal from test chamber														
Thermal Shock		No disconnection or short circuit. Conditions of 1 cycle. <table border="1" data-bbox="922 1305 1286 1435"> <thead> <tr> <th>Step</th> <th>Temperature ($^{\circ}\text{C}$)</th> <th>Times (min.)</th> </tr> </thead> <tbody> <tr> <td>1</td> <td>-25 ± 3</td> <td>30 ± 3</td> </tr> <tr> <td>2</td> <td>Room Temperature</td> <td>Within 3</td> </tr> <tr> <td>3</td> <td>125 ± 3</td> <td>30 ± 3</td> </tr> <tr> <td>4</td> <td>Room Temperature</td> <td>Within 3</td> </tr> </tbody> </table> Total : 5 cycles Recovery: 4 to 24hrs of recovery under the standard condition after the removal from test chamber	Step	Temperature ($^{\circ}\text{C}$)	Times (min.)	1	-25 ± 3	30 ± 3	2	Room Temperature	Within 3	3	125 ± 3	30 ± 3	4	Room Temperature
Step	Temperature ($^{\circ}\text{C}$)	Times (min.)														
1	-25 ± 3	30 ± 3														
2	Room Temperature	Within 3														
3	125 ± 3	30 ± 3														
4	Room Temperature	Within 3														
Humidity Resistance	1. Appearance : No damage 2. Inductance : Within $\pm 10\%$ of initial value. No disconnection or short circuit.	Temperature : $40\pm 5^{\circ}\text{C}$ Humidity : 90% to 95% Applied Current : Rated Current Time : 500 ± 12 hours Recovery: 4 to 24hrs of recovery under the standard condition after the removal from test chamber														
Random Vibration Test	Appearance : Cracking, chipping and any other defects harmful to the characteristics should not be allowed.	Frequency : 10-55-10Hz for 1 min. Amplitude : 1.52mm Directions and times : X, Y, Z directions for 2 hours. A period of 2 hours in each of 3 mutually perpendicular directions (Total 6 hours).														

NOTE : Specifications subject to change without notice. Please check our website for latest information.

12.05.2010



9. SOLDERING AND MOUNTING :

9-1. Recommended PC Board Pattern

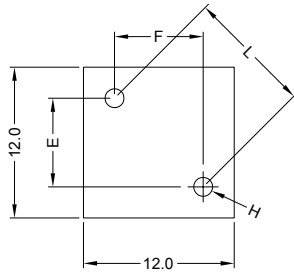

Unit:m/m

Series	E	F	L	H
SHM119HJA-R30MF	6.6±0.5	6.6±0.5	9.3±0.5	1.8 Typ.
SHM119HJA-R45MF	6.6±0.5	6.6±0.5	9.3±0.5	1.8 Typ.
SHM119HJA-R68MF	6.6±0.5	6.6±0.5	9.3±0.5	1.8 Typ.
SHM119HJA-1R0MF	6.6±0.5	6.6±0.5	9.3±0.5	1.8 Typ.
SHM119HJA-1R2MF	6.6±0.5	6.6±0.5	9.3±0.5	1.7 Typ.
SHM119HJA-1R5MF	6.6±0.5	6.6±0.5	9.3±0.5	1.6 Typ.
SHM119HJA-2R2MF	6.6±0.5	6.6±0.5	9.3±0.5	1.5 Typ.

9-2. Soldering

Mildly activated rosin fluxes are preferred. The minimum amount of solder can lead to damage from the stresses caused by the difference in coefficients of expansion between solder, chip and substrate. Our terminations are suitable for all wave and re-flow soldering systems. If hand soldering cannot be avoided, the preferred technique is the utilization of hot air soldering tools.

9-2.1 Solder Re-flow :

Recommended temperature profiles for re-flow soldering in Figure 1.

9-2.2 Soldering Iron (Figure 2) :

Products attachment with soldering iron is discouraged due to the inherent process control limitations. In the event that a soldering iron must be employed the following precautions are recommended.

Note :

- Preheat circuit and products to 150°C.
- 280°C tip temperature (max)
- Never contact the ceramic with the iron tip
- 1.0mm tip diameter (max)
- Use a 20 watt soldering iron with tip diameter of 1.0mm
- Limit soldering time to 3 secs.

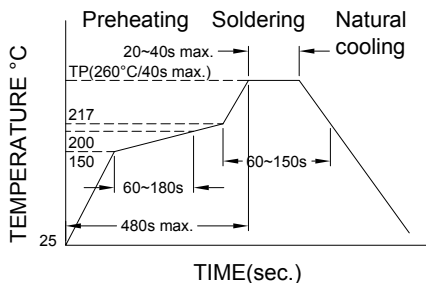

Figure 1. Re-flow Soldering

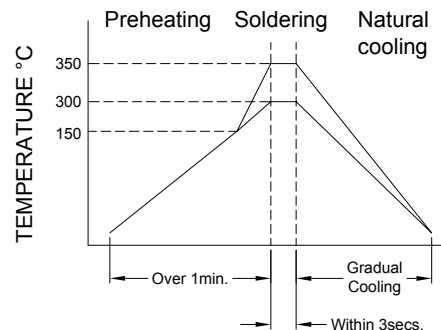

Figure 2. Iron Soldering



RoHS Compliant

NOTE : Specifications subject to change without notice. Please check our website for latest information.



10. PACKING AND QUANTITY :

Size	SHM119HJA
Styrofoam	108
Inner Box	756
Carton	1512

Application Notice

1. Storage Conditions :

To maintain the solderability of terminal electrodes :

- a) Temperature and humidity conditions : Less than 30°C and 70% RH.
- b) Recommended products should be used within 6 months from the time of delivery.
- c) The packaging material should be kept where no chlorine or sulfur exists in the air.

2. Transportation :

- a) Products should be handled with care to avoid damage or contamination from perspiration and skin oils.
- b) The use of tweezers or vacuum pick up is strongly recommended for individual components.
- c) Bulk handling should ensure that abrasion and mechanical shock are minimized.



RoHS Compliant

NOTE : Specifications subject to change without notice. Please check our website for latest information.

12.05.2010



SUPERWORLD ELECTRONICS (S) PTE LTD

PG. 8