



## Sw12350E(12V35AH)



### Specifications

Nominal Voltage		12V
Rated capacity (20 hour rate)		35 Ah
Dimensions	Total Height	179mm (7.05 inches)
	Height	163 mm (6.42 inches)
	Length	196 mm (7.70 inches)
	Width	130mm (5.12 inches)
Weight Approx		11.0Kg (24.2lbs)

### Characteristics

Capacity 25°C(77°F)	20 hour rate(1.75 A)	35.0 AH
	5 hour rate(5.6 A)	28.0 AH
	1 hour rate(19.25 A)	19.25 AH
Internal Resistance	1.5 hour discharge to 10.5V	14 A
	Full charged Battery at 25°C(77°F)	8.3 mΩ
Capacity affected by Temperature (10hour rate)	40°C(104°F)	102%
	25°C(77°F)	100%
	0°C(32°F)	85%
	-15°C(5°F)	65%
Self-Discharge at 25°C(77°F)	Capacity after 3 month storage	91%
	Capacity after 6 month storage	82%
	Capacity after 12 month storage	64%
Terminal		T64、T16
Charge (constant Voltage)	Cycle	Initial Charging Current less than 8.75 A Voltage 14.10-14.40V
	Float	Voltage 13.50-13.80V

### Outer dimensions (mm)

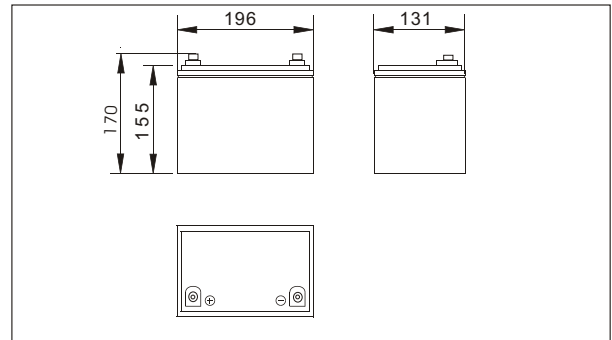

### Terminal Type (mm)

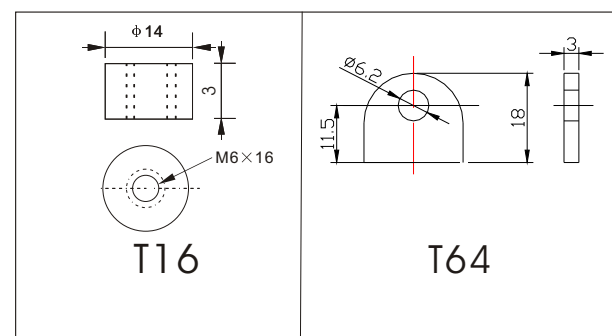

### Discharge Curves 25°C(77°F)

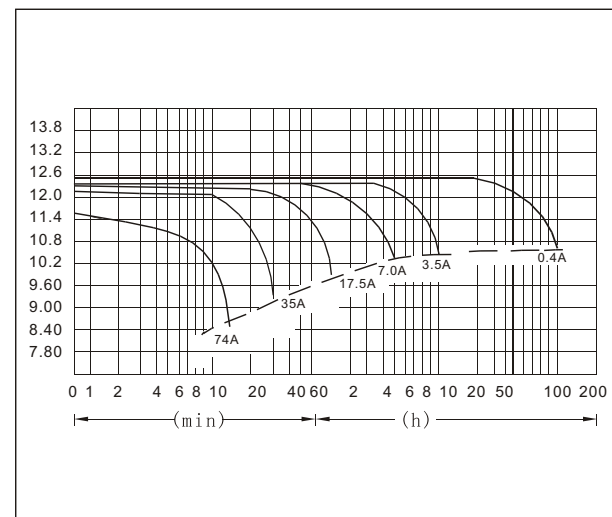

Constant Current(Amp) and Constant Power(Watt) Discharge Table at 25°C(77°F)

Time		10min	30min	1h	3h	4h	5h	8h	10h	20h	50h	100h
9.60V	A	74	40	21	9.0	7.0	5.8	4.1	3.7	1.98	0.83	0.42
	W	820	427	243	104	81	67	47	43	23.0	9.8	5.0
10.20V	A	72	39	19.7	8.8	6.8	5.7	4.0	3.6	1.94	0.80	0.41
	W	789	423	229	101	79	66	46	42	22.4	9.5	4.9
10.50V	A	69	37	19	8.5	6.7	5.6	4.0	3.5	1.91	0.78	0.40
	W	764	400	221	99	78	65	46	41	22.1	9.3	4.8
10.80V	A	64	36	18	8.3	6.6	5.5	3.9	3.4	1.89	0.77	0.40
	W	735	385	212	97	76	64	45	41	22.0	9.2	4.8
11.10V	A	59	33	17	8.1	6.4	5.3	3.7	3.33	1.80	0.76	0.39
	W	722	382	206	96	76	63	45	40	21.4	9.0	4.6