

PLEASE CHECK WWW.MOLEX.COM FOR LATEST PART INFORMATION

Part Number: [0003062062](#)
Status: **Active**
Overview: [standard_062](#)
Description: 1.57mm (.062") Diameter Standard .062 Pin and Socket Plug Housing, 6 Circuits, With Standard Mounting Ears

Documents:

[3D Model](#) [Product Specification PS-02-06 \(PDF\)](#)
[Drawing \(PDF\)](#) [RoHS Certificate of Compliance \(PDF\)](#)
[Packaging Specification \(PDF\)](#)

Agency Certification

| | |
|-----|-----------|
| CSA | LR19980 |
| TUV | R72081037 |
| UL | E29179 |

General

| | |
|----------------|------------------------------|
| Product Family | Crimp Housings |
| Series | 1625 |
| Comments | Polarized to Mating Part |
| MolexKits | Yes |
| Overview | standard_062 |
| Product Name | Standard .062" |

Physical

| | |
|-------------------------------|-----------------|
| Breakaway | No |
| Circuits (maximum) | 6 |
| Circuits Detail | 2x3 |
| Color - Resin | Natural |
| Flammability | 94V-2 |
| Gender | Plug |
| Glow-Wire Compliant | No |
| Keying to Mating Part | None |
| Lock to Mating Part | Yes |
| Material - Resin | Nylon |
| Number of Rows | 3 |
| Packaging Type | Bag |
| Panel Mount | Yes |
| Pitch - Mating Interface (in) | 0.145 In |
| Pitch - Mating Interface (mm) | 3.68 mm |
| Pitch - Term. Interface (in) | 0.145 In |
| Pitch - Term. Interface (mm) | 3.96 mm |
| Polarized to Mating Part | Yes |
| Stackable | No |
| Temperature Range - Operating | -40°C to +105°C |

Electrical

| | |
|-------------------------------|----|
| Current - Maximum per Contact | 5A |
|-------------------------------|----|

Material Info

| | |
|-----------------|---------|
| Old Part Number | 1625-6P |
|-----------------|---------|

Reference - Drawing Numbers

| | |
|-------------------------|-------------|
| Packaging Specification | PK-1625-001 |
| Product Specification | PS-02-06 |
| Sales Drawing | SD-1625-6* |

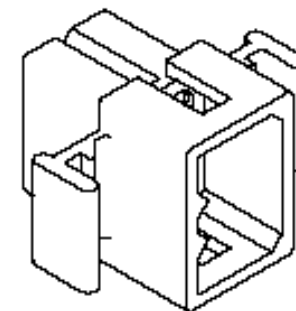

Series

image - Reference only

EU RoHS

ELV and RoHS Compliant

REACH SVHC

Contains SVHC: No

Halogen-Free

Status

Not Reviewed

China RoHS



Need more information on product environmental compliance?

Email productcompliance@molex.com
 For a multiple part number RoHS Certificate of Compliance, [click here](#)

Please visit the [Contact Us](#) section for any non-product compliance questions.

Search Parts in this Series

[1625Series](#)

Mates With

[1625](#) Receptacle

Use With

Female Crimp Terminals [1561](#)[Link:4559](#), [4529](#), [2190](#), [2189](#), [1787](#), [1855](#). Male Crimp Terminals [1560](#), [1786](#), [1854](#), [1778](#). Male PC Tail Terminals. [1779](#) Female PC Tail Terminals

This document was generated on 06/07/2010

PLEASE CHECK WWW.MOLEX.COM FOR LATEST PART INFORMATION

RECEPTACLE

PLUG

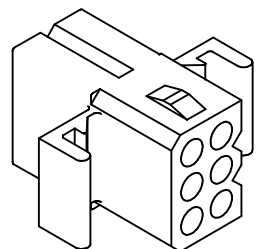
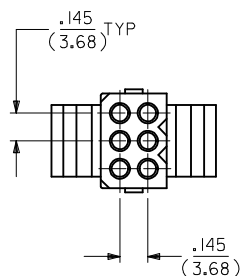
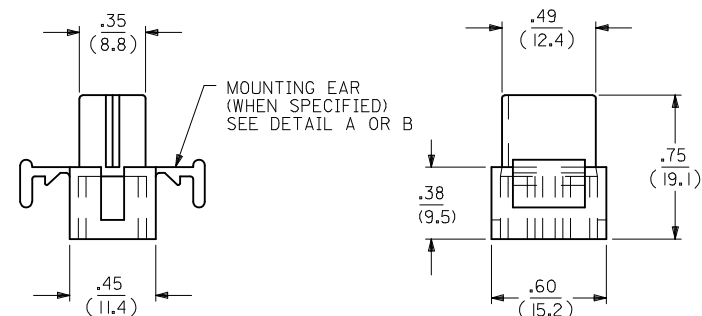
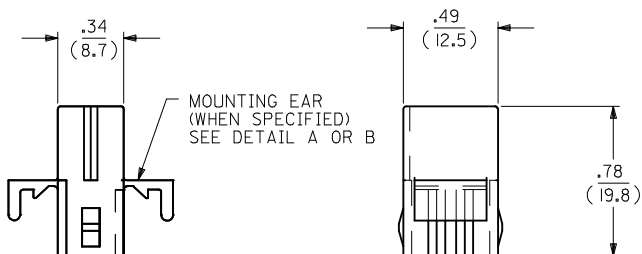
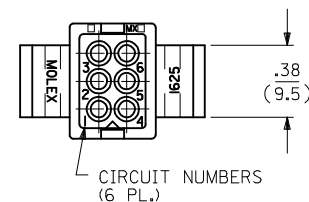
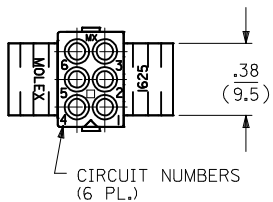

SHOWN WITH STANDARD EAR

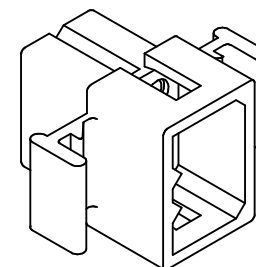
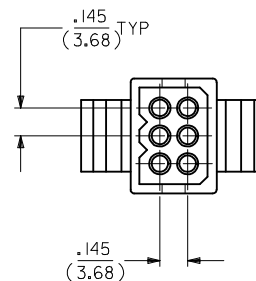

SHOWN WITH STANDARD EAR

| | | | | | | | | |
|--|-------------------------------|---|---------|---------------------------------|--|-----------------------------------|------------------------|--|
| UPDATE TITLE BLOCK EC NO: UCP2006-1431 DRW: NAEHAG 2006/08/29 CHKD: LSCHMIDT 2006/08/29 APPR: FSMITH 2006/08/30 | QUALITY SYMBOLS ▽=0 ▽=0 | GENERAL TOLERANCES (UNLESS SPECIFIED) | | DIMENSION STYLE IN/MM | SCALE --- | DESIGN UNITS INCH | THIRD ANGLE PROJECTION | |
| | | 4 PLACES ± --- ± --- 3 PLACES ± --- ± .010 2 PLACES ± 0.25 ± .014 1 PLACE ± 0.35 ± --- | mm INCH | DRAWN BY DATE KBW 7/22/88 | TITLE .062/(1.57) HOUSING PLUG & RECEPTACLE 6 CKT, .145/(3.68) C.L. | | | |
| | | ANGULAR ± 1/2° | | CHECKED BY DATE RW 7/22/88 | MOLEX MOLEX INCORPORATED | | | |
| | | DRAFT WHERE APPLICABLE MUST REMAIN WITHIN DIMENSIONS | | APPROVED BY DATE RAS 7/22/88 | MATERIAL NO. SEE CHART | DOCUMENT NO. SD-1625-6* | SHEET NO. 1 OF 2 | |
| REV J1 | DESCRIPTION | THIS DRAWING CONTAINS INFORMATION THAT IS PROPRIETARY TO MOLEX INCORPORATED AND SHOULD NOT BE USED WITHOUT WRITTEN PERMISSION | | | | | | |

| PLUG | | |
|------------|------------|----------|
| ORDER NO | ENG NO | |
| 03-06-2062 | I625-6P | |
| 03-06-2061 | I625-6P1 | |
| 03-06-7062 | I625-6PBK | |
| 03-06-7061 | I625-6P1BK | |
| 03-06-7063 | I625-6POR | OBSOLETE |
| - | - | |

| RECEPTACLE | | |
|------------|------------|----------|
| ORDER NO | ENG NO | |
| 03-06-1061 | I625-6R | |
| 03-06-1062 | I625-6R1 | |
| 03-06-6061 | I625-6RBK | |
| 03-06-6062 | I625-6R1BK | |
| 03-06-6063 | I625-6ROR | OBSOLETE |
| 03-06-6064 | I625-6RBU | |
| NOT TOOLED | I625-6R2 | |

LEGEND:

I625-6****

CIRCUIT SIZE

P = PLUG
R = RECEPTACLE

BLANK = WITH STANDARD EARS
1 = WITHOUT EARS
2 = WITH PREBENT EARS

COLOR:

BLANK = NATURAL COLOR
AM = AMBER BK = BLACK BU = BLUE
BN = BROWN GY = GRAY GN = GREEN
OR = ORANGE RD = RED YW = YELLOW

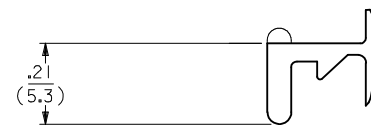

DETAIL A

.062/(1.57) STANDARD MOUNTING EAR
(SCALE 4:1)

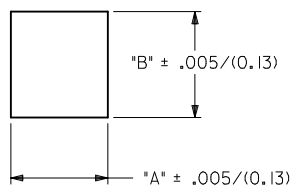
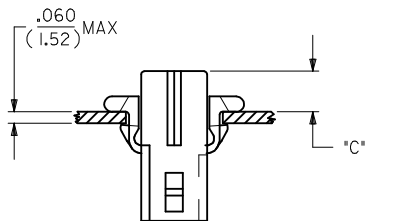

| HOUSING | DIM. "A" | DIM. "B" | "C" PREBENT EAR | "C" STANDARD EAR |
|---------|--------------|--------------|-----------------|------------------|
| PLUG | .607/(15.42) | .615/(15.62) | .22/(5.6) | .18/(4.6) |
| RECEPT. | .505/(12.83) | .552/(14.02) | .23/(5.8) | .19/(4.8) |

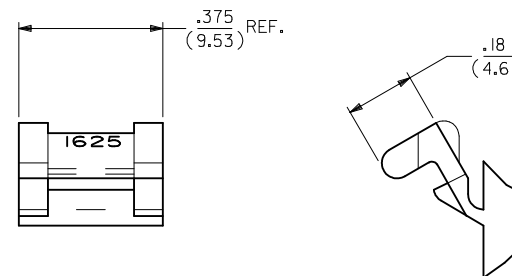

DETAIL B

.062/(1.57)PREBENT MOUNTING EAR
(SCALE 4:1)

NOTES:-

1. MATERIAL NYLON TYPE 6/6, 94-2.
2. FINISH: NONE.
3. PRODUCT SPECS: MOLEX PRODUCT SPECS 02-06 APPLIES.
4. PACKAGING SPECS: BULK PACK PER PK-1625-001.

| REINSTATE PARTS EC NO: UCP2006-1431 DRWINAELHAG 2006/08/29 CHKD:LSCHMIDT 2006/08/29 APPR:FSMITH 2006/08/30 | QUALITY SYMBOLS ▽=0 ▽=0 | GENERAL TOLERANCES (UNLESS SPECIFIED) <table border="1"> <thead> <tr> <th></th> <th>mm</th> <th>INCH</th> </tr> </thead> <tbody> <tr> <td>4 PLACES</td> <td>± .010</td> <td>± .0004</td> </tr> <tr> <td>3 PLACES</td> <td>± .010</td> <td>± .0004</td> </tr> <tr> <td>2 PLACES</td> <td>± 0.25</td> <td>± .010</td> </tr> <tr> <td>1 PLACE</td> <td>± 0.35</td> <td>± .014</td> </tr> </tbody> </table> | | mm | INCH | 4 PLACES | ± .010 | ± .0004 | 3 PLACES | ± .010 | ± .0004 | 2 PLACES | ± 0.25 | ± .010 | 1 PLACE | ± 0.35 | ± .014 | DIMENSION STYLE IN/MM | SCALE --- | DESIGN UNITS INCH | THIRD ANGLE PROJECTION |
|---|-------------------------------|--|-----------------------------------|----------------------------|------|----------|--------|---------|----------|--------|---------|----------|--------|--------|---------|--------|--------|---------------------------------|--------------|-----------------------------|------------------------|
| | | mm | INCH | | | | | | | | | | | | | | | | | | |
| | 4 PLACES | ± .010 | ± .0004 | | | | | | | | | | | | | | | | | | |
| | 3 PLACES | ± .010 | ± .0004 | | | | | | | | | | | | | | | | | | |
| 2 PLACES | ± 0.25 | ± .010 | | | | | | | | | | | | | | | | | | | |
| 1 PLACE | ± 0.35 | ± .014 | | | | | | | | | | | | | | | | | | | |
| DRAWN BY KBW | DATE 7/22/88 | TITLE .062 / (1.57) HOUSINGS PLUG & RECEPTACLE 6 CKT, .145/(3.683) C.L. | | | | | | | | | | | | | | | | | | | |
| CHECKED BY RW | DATE 7/22/88 | MOLEX INCORPORATED | | | | | | | | | | | | | | | | | | | |
| APPROVED BY RAS | DATE 7/22/88 | MATERIAL NO. SEE CHART | DOCUMENT NO. SD-1625-6* | SHEET NO. 2 OF 2 | | | | | | | | | | | | | | | | | |

DRAFT WHERE APPLICABLE
MUST REMAIN
WITHIN DIMENSIONS

THIS DRAWING CONTAINS INFORMATION THAT IS PROPRIETARY TO MOLEX INCORPORATED AND SHOULD NOT BE USED WITHOUT WRITTEN PERMISSION