

**PLEASE CHECK WWW.MOLEX.COM FOR LATEST PART INFORMATION**

**Part Number:** [0350211001](#)  
**Status:** **Active**  
**Description:** Board-In Right Angle Crimp Terminal 35021, Reel, Brass Tin (Sn)

**Documents:**

<a href="#">3D Model</a>	<a href="#">Product Specification PS-35022-003 (PDF)</a>
<a href="#">Drawing (PDF)</a>	<a href="#">Product Specification PS-35808-001 (PDF)</a>
<a href="#">Product Specification PS-35021-001 (PDF)</a>	<a href="#">RoHS Certificate of Compliance (PDF)</a>

**General**

Product Family	Crimp Terminals
Series	<a href="#">35021</a>
Comments	Right Angle, Use with Housing 35022
Crimp Quality Equipment	Yes
Product Name	Board-In

**Physical**

Gender	Male
Material - Metal	Brass
Material - Plating Mating	Tin
Material - Plating Termination	Tin
Packaging Type	Reel
Plating min: Mating (µin)	32.00
Plating min: Mating (µm)	0.800
Plating min: Termination (µin)	32.00
Plating min: Termination (µm)	0.80
Termination Interface: Style	Crimp or Compression
Wire Insulation Diameter	1.9 mm Max (.075" Max)
Wire Size AWG	22, 30
Wire Size mm <sup>2</sup>	N/A

**Material Info**

**Reference - Drawing Numbers**

Product Specification	PS-35021-001, PS-35022-003, PS-35808-001, RPS-35022-001
Sales Drawing	SD-35021-001, SD-35021-1***

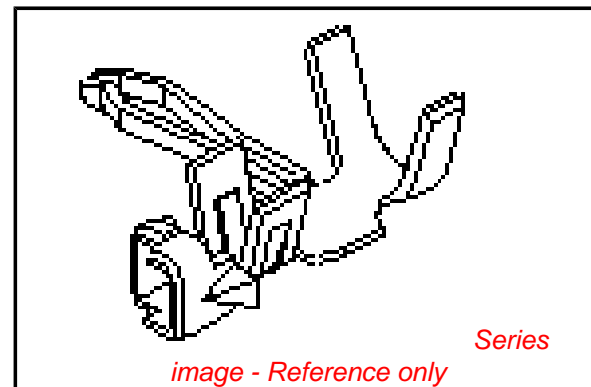

**EU RoHS**

**ELV and RoHS Compliant**  
**REACH SVHC**  
**Contains SVHC: No**  
**Halogen-Free Status**

**China RoHS**



**Need more information on product environmental compliance?**

Email [productcompliance@molex.com](mailto:productcompliance@molex.com)  
 For a multiple part number RoHS Certificate of Compliance, [click here](#)

Please visit the [Contact Us](#) section for any non-product compliance questions.

**Search Parts in this Series**

[35021Series](#)

**Use With**

[35023 Housing](#)

**Application Tooling | FAQ**

*Tooling specifications and manuals are found by selecting the products below. Crimp Height Specifications are then contained in the Application Tooling Specification document.*

**Global**

Description	Product #
HAND CRIMP TOOL	<a href="#">0638116900</a>
T2 Terminator Die	<a href="#">0638532000</a>
T2 Terminator	<a href="#">0638532100</a>
Tooling Die	
FineAdjust™	<a href="#">0638632000</a>
Applicator	
FineAdjust™	<a href="#">0638632100</a>
Applicator	

This document was generated on 04/15/2010

**PLEASE CHECK [WWW.MOLEX.COM](http://WWW.MOLEX.COM) FOR LATEST PART INFORMATION**

DWG. NO. SD-35021-001  
 SIMILAR ITEM  
 PROJECT NO.  
 DO NOT SCALE DRAWING DIMENSION IN METRIC

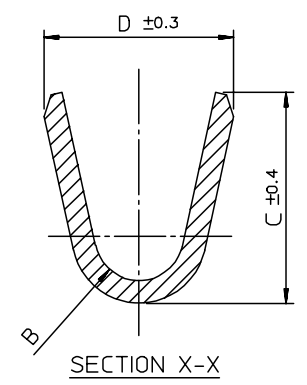
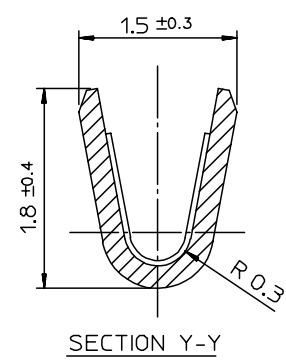
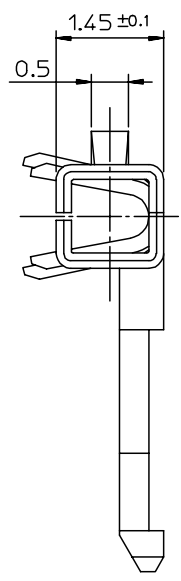
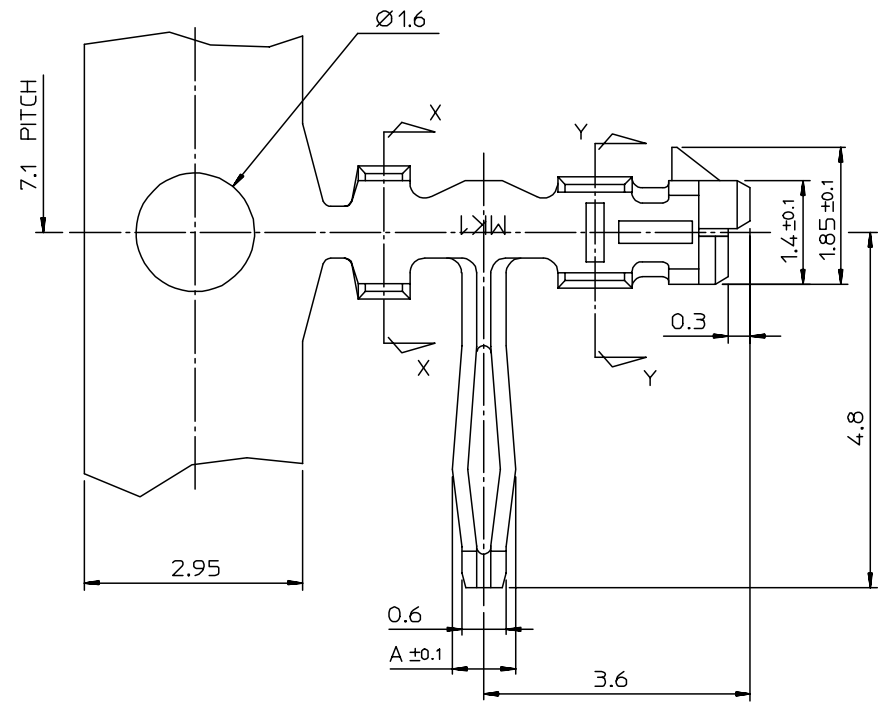

- NOTE
- MATERIAL
    - BRASS (CDA 260)
    - PHOSPHOR BRONZE (CDA 510)
  - PLATING
    - PRE PLATED - TIN OVER COPPER
    - POST PLATED - TIN/LEAD OVER COPPER
  - USED HOUSING : 35022-00\*\*/35023-00\*\*/68418-\*\*\*00

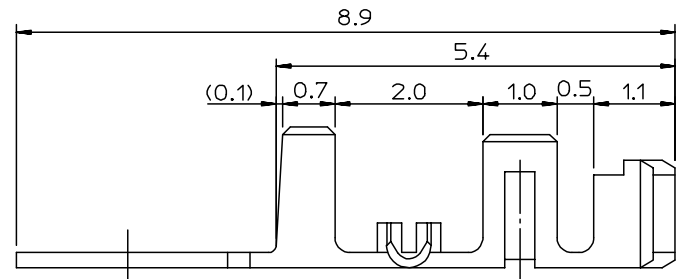

POST-PLATED	PHOS. BRON.	AWG #24-#30	1.8	1.9	R0.4	0.85	350211310	35021-1310
PRE-PLATED	PHOS. BRON.	(INS. DIA: Ø 1.5 MAX.)	2.5	2.5	R0.7	1.05	350211301	35021-1301
	BRASS						350211201	35021-1201
PRE-PLATED	PHOS. BRON.	AWG #22-#28 (INS. DIA: Ø 1.9 MAX.)	2.5	2.5	R0.7	1.05	350211101	35021-1101
	BRASS						350211001	35021-1001
POST-PLATED	PHOS. BRON.						350211110	35021-1110
PLATING	MATERIAL	WIRE RANGE	D	C	B	A	MAT'L NO.	ENG NO.

REVISED EC NO: KOR2007-0027 DRWN: JHLEE 06/09/13 CHK: KSKIM 06/09/13 APPR: YSOOKIM 06/09/13	QUALITY SYMBOLS MAJOR CRITICAL	GENERAL TOLERANCES: (UNLESS SPECIFIED)		SCALE 15-1 <input checked="" type="checkbox"/> MM <input type="checkbox"/> INCH	DESIGN UNITS <input checked="" type="checkbox"/> THIRD ANGLE PROJECTION	DIMENSIONS: <input type="checkbox"/> MM <input type="checkbox"/> INCH <input checked="" type="checkbox"/> ONLY		SHT   REV REVISE ON CAD ONLY
		DESCRIPTION R/A B-IN TERMINAL	DRAWN BY & DATE HSSHIN	TITLE:		MOLEX INCORPORATED		SHEET NO. 10F1
REV 1	4 PLACES ±0. INCH 3 PLACES ±0. INCH 2 PLACES ±0. INCH 1 PLACE ±0.3 INCH	CHECKED BY & DATE JKOH	APPROVED BY & DATE CWLEE		MATERIAL NO. SEE TABLE	DRAWING NO. SD-35021-001	SIZE B	
DRAFT WHERE APPLICABLE MUST REMAIN WITHIN DIMENSIONS		CAD FILENAME SD35021.DGN		THIS DRAWING CONTAINS INFORMATION THAT IS PROPRIETARY TO MOLEX INCORPORATED AND SHOULD NOT BE USED WITHOUT WRITTEN PERMISSION.				

8 7 6 5 4 3 2 1

F  
E  
D  
C  
B  
A

MX-A3

PROJECT NO. SIMILAR ITEM DWG. NO.  
35021-1\*\*\* SD 35021-1\*\*\*

DO NOT SCALE DRAWING  
DIMENSION IN METRIC

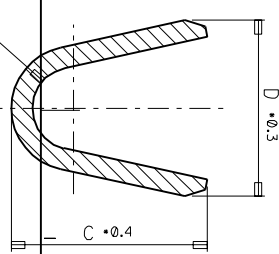
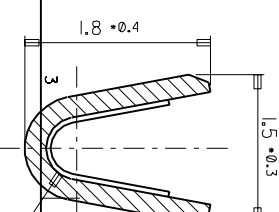
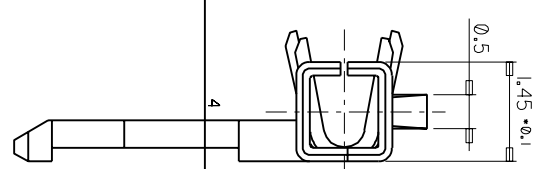
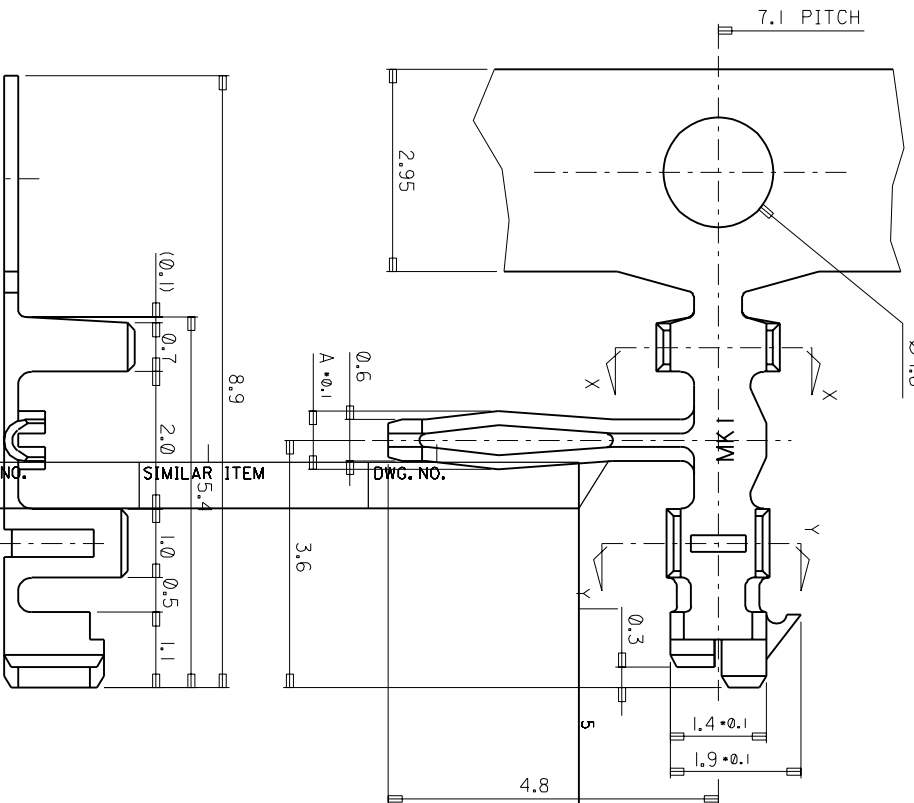

NOTE

1. MATERIAL
  - 1) BRASS (CDA 260)
  - 2) PHOSPHOR BRONZE (CDA 510)
2. PLATING
  - 1) PRE PLATED - TIN OVER COPPER
  - 2) POST PLATED - TIN/LEAD OVER COPPER
3. USED HOUSING : 35022-00\*\* / 35023-00\*\*

POST-PLATED	PHOS. BRON.	AWG #24-#30	1.8	1.9	R0.4	0.85	35021-1310
PRE-PLATED	PHOS. BRON.	(INS. DIA: Ø 1.5 MAX.)	1.8	1.9	R0.4	0.85	35021-1301
POST-PLATED	PHOS. BRON.	AWG #22-#30 (INS. DIA: Ø 1.9 MAX.)	2.5	2.5	R0.7	1.05	35021-1201
PLATING	MATERIAL	WIRE RANGE	D	C	B	A	35021-1101
							35021-1100

REVISED  
EC NO. KOR1998-0091  
DRWN: HSSHIN(980609)  
CHK: JKOH  
APPR: CWLEE

REVISIONS  
REV DESCRIPTION  
C CRITICAL

QUALITY SYMBOLS	GENERAL TOLERANCES: (UNLESS SPECIFIED)	SCALE	DESIGN UNITS	THIRD ANGLE PROJECTION	TITLE
MAJOR	MM INCH	15-1	MM INCH	<input type="checkbox"/> <input checked="" type="checkbox"/>	R/A B-IN TERMINAL
MINOR	MM INCH				
CRITICAL	MM INCH				

DRAWN BY & DATE: HSSHIN  
CHECKED BY & DATE: JKOH  
APPROVED BY & DATE: CWLEE

CAD FILENAME: SD35021.DGN  
MATERIAL NO.: 350-21-1\*\*\*  
DRAWING NO.: SD 35021-1\*\*\*  
SHEET NO.: 10F1  
SIZE: MX-A8

MOLEX INCORPORATED  
KOREA