

PIN 2 : NO PIN  
PIN 5 : NO CONNECTION

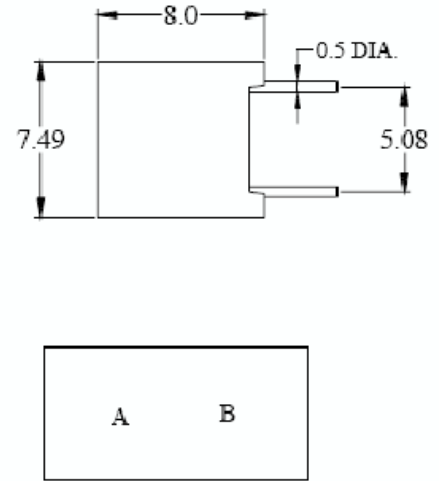
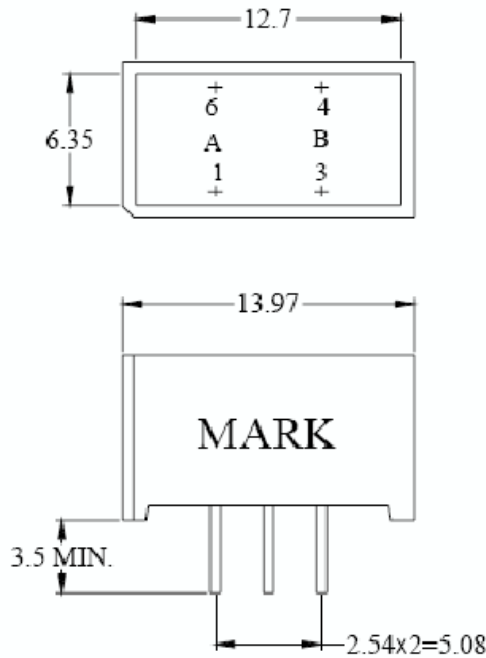

**SELECTOR GUIDE**

Part Number	Dice	Lens Color / Type	Pack Size	View Angle 2 $\theta$ 1/2
MTLB3150-Y-A	Yellow	Water Clear	0.50 in. light bar	0 °

**ELECTRICAL / OPTICAL CHARACTERISTICS AT T<sub>A</sub>=25°C**

Parameter	Symbol	Device	Min.	Typ.	Max.	Units	Test Conditions
Forward Voltage	V <sub>F</sub>	Yellow	-	2.1	2.6	V	20mA
Reverse Current	I <sub>R</sub>	Yellow	-	-	100	μA	5V
Luminous Intensity	I <sub>v</sub>	Yellow	2.2	3.7	-	mcd	10mA
Peak Wavelength	λ <sub>peak</sub>	Yellow	-	585	-	nm	20mA
Dominant Wavelength	λ <sub>D</sub>	Yellow	-	590	-	nm	20mA
Spectral Line Half-Width	Δλ 1/2	Yellow	-	35	-	nm	20mA

**ABSOLUTE MAXIMUM RATINGS AT T<sub>A</sub>=25°C**

Parameter	Rating	Units
Forward Current ( I <sub>F</sub> )	30	mA
Power Dissipation ( P <sub>D</sub> )	156	mW
Reverse Voltage ( V <sub>R</sub> )	5	V
Operating Temperature ( T <sub>OPR</sub> )	-25 ~ +85	°C
Storage Temperature ( T <sub>STG</sub> )	-40 ~ +100	°C
Lead Solder Temperature ( T <sub>SOL</sub> )	260	@ for 5 sec. max

- All Dimensions Are In Millimeters (inches).
- Tolerance Is +0.25(0.01") Unless Otherwise Noted.
- Specifications Are Subject To Change Without Notice.

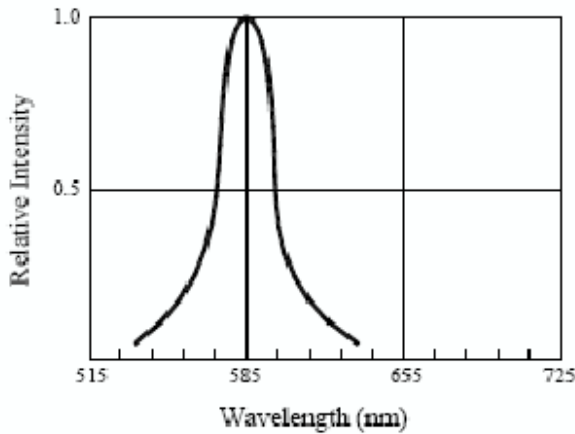

**Fig. 1 RELATIVE INTENSITY VS. WAVELENGTH**

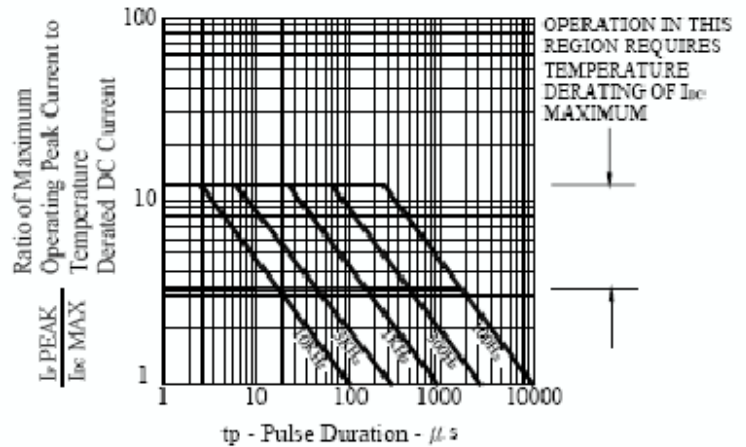

**Fig. 2 MAXIMUM TOLERABLE PEAK CURRENT VS. PULSE DURATION**

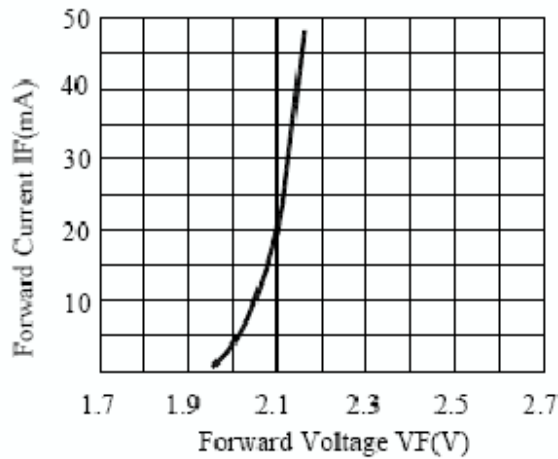

**Fig. 3 FORWARD CURRENT VS. FORWARD VOLTAGE PER CHIP**

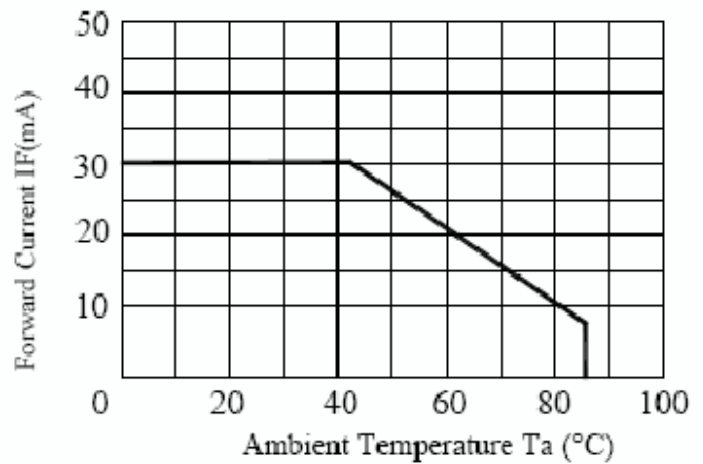

**Fig. 4 FORWARD CURRENT VS. DERATING CURVE**

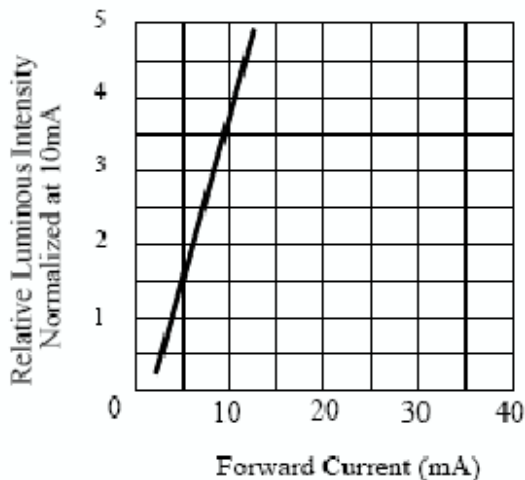

**Fig. 5 RELATIVE LUMINOUS INTENSITY VS. FORWARD CURRENT**

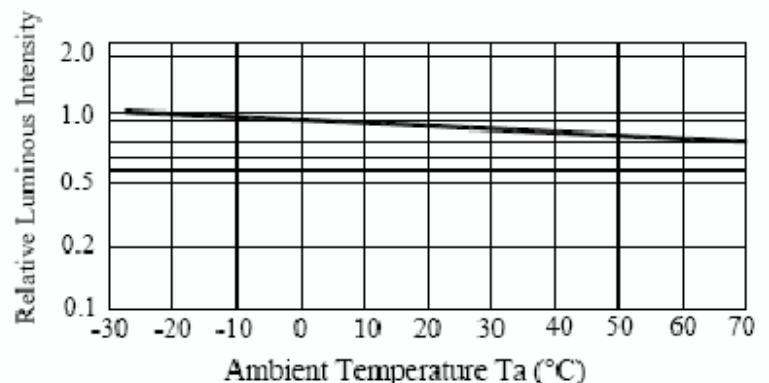

**Fig. 6 LUMINOUS INTENSITY VS. AMBIENT TEMPERATURE**

