

Pilot Bored Sprockets

ROLLER CHAIN
DRIVES

SIMPLEX

08B1 3/8" Pitch

(027A01--)

Teeth	Outer Diameter O	Pitch Diameter d _p	Hub Diameter N	Length through Bore L	Plate Thickness B	Stock Bore D	Max Bore	Type
8	28.00	24.89	15.00*	22	5.3	6	6	1
9	31.00	27.85	18.00*	22	5.3	8	8	1
10	34.00	30.82	20.00	22	5.3	8	8	1
11	37.00	33.80	22.00	25	5.3	8	8	1
12	40.00	36.80	25.00	25	5.3	8	10	1
13	43.00	39.79	28.00	25	5.3	10	12	1
14	46.30	42.80	31.00	26	5.3	10	15	1
15	49.30	45.81	34.00	25	5.3	10	18	1
16	52.30	48.82	37.00	28	5.3	10	20	1
17	55.30	51.83	40.00	28	5.3	10	23	1
18	58.30	54.85	43.00	28	5.3	10	26	1
19	61.30	57.87	45.00	28	5.3	10	28	1
20	64.30	60.89	48.00	28	5.3	10	28	1
21	68.00	63.91	48.00	28	5.3	12	30	1
22	71.00	66.93	50.00	28	5.3	12	35	1
23	73.50	69.95	52.00	28	5.3	12	35	1
24	77.00	72.97	54.00	28	5.3	12	35	1
25	80.00	76.00	57.00	28	5.3	12	40	1
26	83.00	79.02	60.00	28	5.3	12	40	1
27	86.00	82.05	60.00	28	5.3	12	40	1
28	89.00	85.07	60.00	28	5.3	12	40	1
29	92.00	88.09	60.00	28	5.3	12	40	1
30	94.70	91.12	60.00	30	5.3	12	40	1
31	98.30	94.15	65.00	30	5.3	14	43	1
32	101.30	97.17	65.00	30	5.3	14	43	1
33	104.30	100.20	65.00	30	5.3	14	43	1
34	107.30	103.23	65.00	30	5.3	14	43	1
35	110.40	106.26	65.00	30	5.3	14	43	1
36	113.40	109.29	70.00	30	5.3	16	48	1
37	116.40	112.32	70.00	30	5.3	16	48	1
38	119.50	115.35	70.00	30	5.3	16	48	1
39	122.50	118.37	70.00	30	5.3	16	48	1
40	125.50	121.40	70.00	30	5.3	16	48	1
38*	119.50	115.35	70.00	32	5.3	19	40	4
45	140.70	136.55	70.00	32	5.3	19	40	4
57	176.90	172.91	70.00	32	5.3	19	40	4
76	234.60	230.49	70.00	32	5.3	19	50	4
95	292.50	288.08	80.00	40	5.3	19	55	4

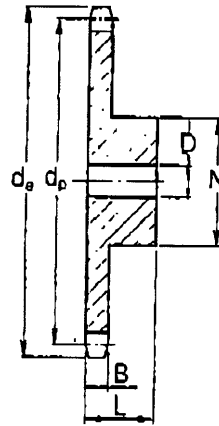

Type 1
Steel
(080M40)

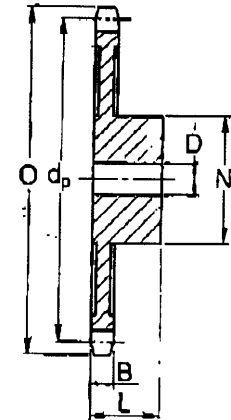

Type 4
Cast Iron
(G220)

OUTSIDE DIAMETER TOLERANCE:- + 0.00mm
- 0.25mm

HUB DIAMETER TOLERANCE:- ± 0.25mm

LENGTH THROUGH BORE TOLERANCE:- + 0.25mm
- 0.00mm

08B1 1/2" Pitch

(027B01--)

Teeth	Outer Diameter O	Pitch Diameter d _p	Hub Diameter N	Length through Bore L	Plate Thickness B	Stock Bore D	Max Bore	Type
8	37.20	33.19	20.00*	25	7.2	10	10	1
9	41.00	37.13	24.00*	25	7.2	10	10	1
10	45.20	41.10	26.00	25	7.2	10	11	1
11	49.70	45.07	29.00	28	7.2	10	13	1
12	53.00	48.07	33.00	28	7.2	10	17	1
13	57.40	52.06	37.00	28	7.2	10	20	1
14	61.80	56.07	41.00	28	7.2	10	24	1
15	65.50	60.09	45.00	28	7.2	10	28	1
16	69.50	64.10	50.00	28	7.2	12	30	1
17	73.60	68.11	52.00	28	7.2	12	30	1
18	77.80	72.14	56.00	28	7.2	12	35	1
19	81.70	76.16	60.00	28	7.2	12	40	1
20	85.80	81.19	64.00	28	7.2	12	40	1
21	89.70	85.22	68.00	28	7.2	14	40	1
22	93.80	89.24	70.00	28	7.2	14	40	1
23	98.20	93.27	70.00	28	7.2	14	40	1
24	101.80	97.29	70.00	28	7.2	14	40	1
25	106.80	101.33	70.00	28	7.2	14	40	1
26	110.00	105.36	70.00	30	7.2	16	48	1
27	114.00	109.40	70.00	30	7.2	16	48	1
28	118.00	113.42	70.00	30	7.2	16	48	1
29	122.00	117.46	80.00	30	7.2	16	46	1
30	126.10	121.50	80.00	30	7.2	16	46	1
31	130.20	125.54	90.00	30	7.2	16	46	1
32	134.30	129.56	90.00	30	7.2	16	46	1
33	138.40	133.60	90.00	30	7.2	16	46	1
34	142.60	137.64	90.00	30	7.2	16	46	1
35	146.70	141.68	90.00	30	7.2	16	46	1
36	151.00	145.72	90.00	35	7.2	16	50	1
37	154.60	149.76	90.00	35	7.2	16	50	1
38	158.60	153.80	90.00	35	7.2	16	50	1
39	162.70	157.83	90.00	35	7.2	16	50	1
40	166.80	161.87	90.00	35	7.2	16	50	1
38*	158.60	153.80	70.00	40	7.2	19	50	4
45	188.00	182.07	70.00	40	7.2	19	50	4
57	236.40	230.54	70.00	40	7.2	19	50	4
76	313.30	307.33	80.00	40	7.2	23	50	4
95	390.10	384.11	80.00	45	7.2	23	55	4

10B1 5/8" Pitch

(027C01--)

Teeth	Outer Diameter O	Pitch Diameter d _p	Hub Diameter N	Length through Bore L	Plate Thickness B	Stock Bore D	Max Bore	Type
8	47.00	41.48	25.00*	25	9.1	10	11	1
9	52.60	46.42	30.00*	25	9.1	10	15	1
10	57.50	51.37	35.00*	25	9.1	10	18	1
11	63.00	56.34	37.00	30	9.1	12	21	1
12	68.00	61.34	42.00	30	9.1	12	25	1
13	73.00	66.32	47.00	30	9.1	12	28	1
14	78.00	71.34	52.00	30	9.1	12	32	1
15	83.00	76.36	57.00	30	9.1	12	35	1
16	88.00	81.37	60.00	30	9.1	12	40	1
17	93.00	86.39	60.00	30	9.1	12	40	1
18	98.30	91.42	70.00	30	9.1	14	50	1
19	103.30	96.45	70.00	30	9.1	14	50	1
20	108.40	101.49	75.00	30	9.1	14	50	1
21	113.40	106.52	75.00	30	9.1	16	50	1
22	118.00	111.55	80.00	30	9.1	16	50	1
23	123.40	116.58	80.00	30	9.1	16	50	1
24	128.30	121.62	80.00	30	9.1	16	50	1
25	134.00	126.66	80.00	30	9.1	16	50	1
26	139.00	131.70	85.00	35	9.1	20	55	1
27	144.00	136.75	85.00	35	9.1	20	55	1
28	149.70	141.78	90.00	35	9.1	20	55	1
29	153.80	146.83	90.00	35	9.1	20	55	1
30	158.80	151.87	90.00	35	9.1	20	58	1
31	163.90	156.92	95.00	35	9.1	20	58	1
32	168.90	161.95	95.00	35	9.1	20	58	1
33	174.50	167.00	95.00	35	9.1	20	58	1
34	179.00	172.05	95.00	35	9.1	20	58	1
35	184.10	177.10	95.00	35	9.1	20	58	1
36	189.10	182.15	100.00	35	9.1	20	63	1
37	194.20	187.20	100.00	35	9.1	20	63	1
38	199.20	192.24	100.00	35	9.1	20	63	1
39	204.20	197.29	100.00	35	9.1	20	63	1
40	209.30	202.34	100.00	35	9.1	20	63	1
38*	199.20	192.24	80.00	40	9.1	19	50	4
45	235.00	227.58	80.00	40	9.1	19	55	4
57	296.00	288.18	90.00	45	9.1	23	55	4
76	392.10	384.16	80.00	50	9.1	23	60	4
95	488.60	480.14	100.00	55	9.1	23	60	4

* Has recessed groove in hub for chain clearance.
 In complete Catalogue Code insert number of teeth required.
 For Type 4, 38 tooth sprockets, designate with ninth digit 0.