

SMPS PS300 Planar transformer

A-2049-002

www.DataSheet4U.com

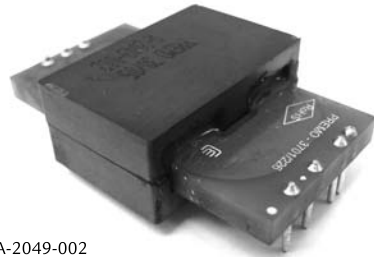

A-2049-002

Features

- Very low core & copper losses.
- Compact size.
- Design according to EN60950.
- RoHS compliant.

Electrical parameters

Converter		FLYBACK
Input voltage		85-265Vac
Output	Auxiliar	15Vdc/0.1A
	Secondary	12Vdc/5A
Total power		60W
Switching frequency		132kHz
Primary inductance @10kHz - 10mV		289 μ H+/-5%
Leakage inductance @100kHz - 100mV		5 μ H max
DC resistance @25°C	Primary	150 m Ω typ
	Secondary	1.7m Ω typ
Estimated total losses	Windings	0.4
	Core	0.4
Max. operating temp.		85°C
Storage temperature		130°C
Mounting		PTH
Voltage test @50Hz 2"	Primary vs Secondary	3000Vac
	Primary vs Core	

Electrical diagram

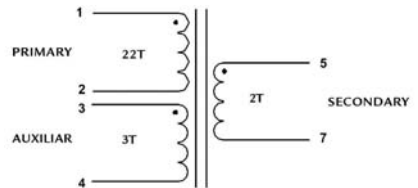

Dimensions

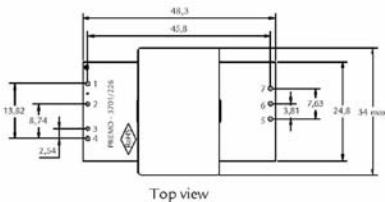

Top view

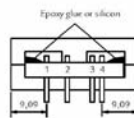

Primary side view

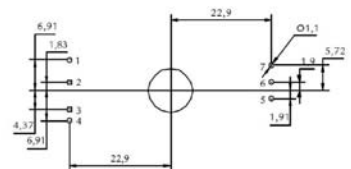
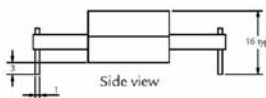
Recommended PCB layout
View in mounting direction

Side view

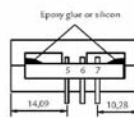

Secondary side view