

PLEASE CHECK WWW.MOLEX.COM FOR LATEST PART INFORMATION

Part Number: [0022052031](#)
Status: **Active**
Description: 2.54mm (.100") Pitch KK® Wire-to-Board Header, Single Row, Right Angle, 3 Circuits, PA Polyamide Nylon, Tin (Sn) Plating

Documents:

| | |
|---|--|
| 3D Model | Product Specification PS-10-07 (PDF) |
| Packaging Specification (PDF) | RoHS Certificate of Compliance (PDF) |
| Drawing (PDF) | |

Agency Certification

| | |
|-----|---------|
| CSA | LR19980 |
| UL | E29179 |

General

| | |
|----------------|-------------------------------|
| Product Family | PCB Headers |
| Series | 4094 |
| Application | Board-to-Board, Wire-to-Board |
| Product Name | KK® |

Physical

| | |
|--------------------------------|-----------------|
| Breakaway | No |
| Circuits (Loaded) | 3 |
| Circuits (maximum) | 3 |
| Color - Resin | Natural (White) |
| Durability (mating cycles max) | 25 |
| Flammability | 94V-0 |
| Glow-Wire Compliant | No |
| Lock to Mating Part | None |
| Material - Metal | Brass |
| Material - Plating Mating | Tin |
| Material - Resin | Nylon |
| Number of Rows | 1 |
| Orientation | Right Angle |
| PC Tail Length (in) | 0.124 In |
| PC Tail Length (mm) | 3.15 mm |
| PCB Locator | No |
| PCB Retention | None |
| PCB Thickness Recommended (in) | 0.062 In |
| PCB Thickness Recommended (mm) | 1.60 mm |
| Packaging Type | Bag |
| Pitch - Mating Interface (in) | 0.100 In |
| Pitch - Mating Interface (mm) | 2.54 mm |
| Polarized to Mating Part | No |
| Polarized to PCB | No |
| Shrouded | No |
| Stackable | Yes |
| Surface Mount Compatible (SMC) | No |
| Temperature Range - Operating | 0°C to +75°C |
| Termination Interface: Style | Through Hole |

Electrical

| | |
|-------------------------------|------|
| Current - Maximum per Contact | 4A |
| Voltage - Maximum | 250V |

Solder Process Data

| | |
|--|---|
| Duration at Max. Process Temperature (seconds) | 5 |
|--|---|

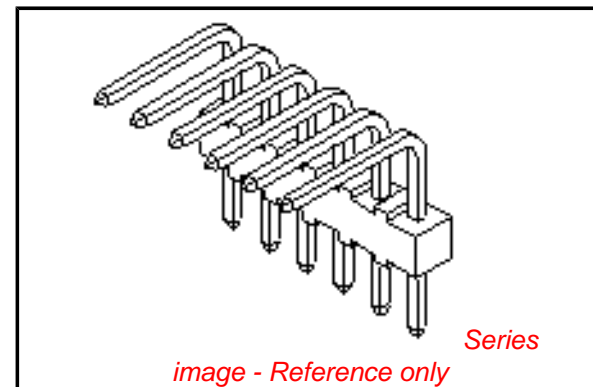

image - Reference only

EU RoHS

ELV and RoHS Compliant
REACH SVHC
 Not Reviewed
Halogen-Free Status

China RoHS



Need more information on product environmental compliance?

Email productcompliance@molex.com
 For a multiple part number RoHS Certificate of Compliance, [click here](#)

Please visit the [Contact Us](#) section for any non-product compliance questions.

Search Parts in this Series

[4094Series](#)

Mates With

[2695](#) , [6471](#) , [7880](#) , [4455](#) , [7720](#)

| | |
|---|------------------------|
| Lead-free Process Capability | Wave Capable (TH only) |
| Max. Cycles at Max. Process Temperature | 1 |
| Process Temperature max. C | 235 |

Material Info

| | |
|-----------------|---------------|
| Old Part Number | A-4094-03A102 |
|-----------------|---------------|

Reference - Drawing Numbers

| | |
|-----------------------|----------|
| Product Specification | PS-10-07 |
| Sales Drawing | SDA-4094 |

This document was generated on 04/08/2010

PLEASE CHECK WWW.MOLEX.COM FOR LATEST PART INFORMATION

CENTERLINE OF PIN IN AREA SHOWN
NOT TO VARY FROM CENTERLINE
OF PIN AT DATUM -E- BY
MORE THAN (0.20)/.008 IN ANY DIRECTION

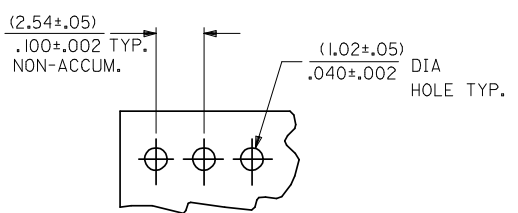
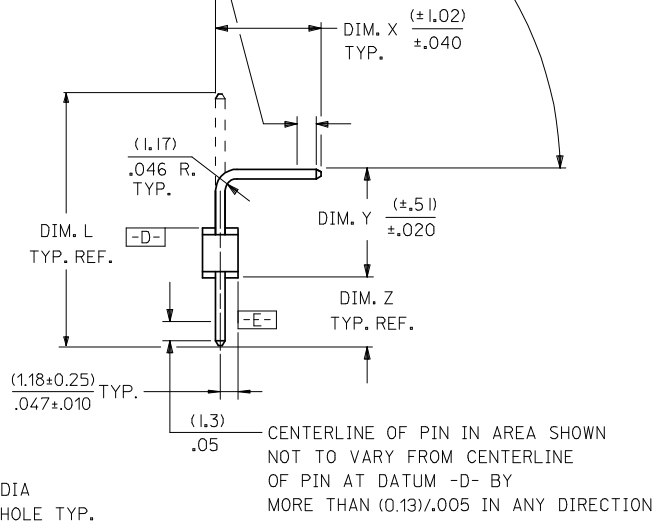
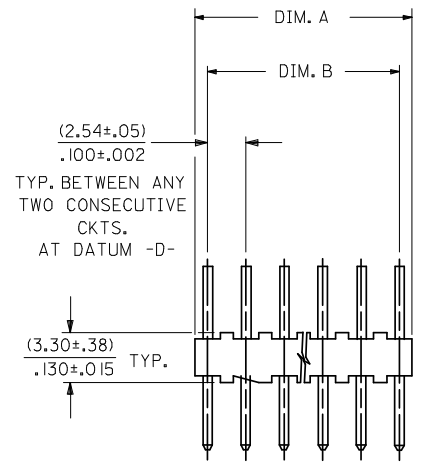

PCB LAYOUT: COMPONENT SIDE
TYPICAL PCB THICKNESS: (1.57)/.062

NOTES:

- MATERIAL: NYLON, UL 94V-0, COLOR: WHITE
- FINISH:
 - (102) OVERALL TIN: 0.00508/0.00200 MIN. OVER COPPER UNDERPLATE: 0.00254/0.00100 MIN.
 - (103) OVERALL TIN: 0.00508/0.00200 MIN. OVER COPPER UNDERPLATE: 0.00127/0.00050 MIN.
 - (501) OVERALL GOLD: 0.00051/0.00020 MIN. OVER NICKEL UNDERPLATE: 0.00076/0.00030 MIN.
 - (503) OVERALL GOLD: 0.00076/0.00030 MIN. OVER NICKEL UNDERPLATE: 0.00127/0.00050 MIN.
 - (508) OVERALL GOLD: 0.00076/0.00030 MIN. OVER NICKEL UNDERPLATE: 0.00076/0.00030 MIN.
 - (516) OVERALL GOLD: 0.00025/0.00010 MIN. OVER NICKEL UNDERPLATE: 0.00076/0.00030 MIN.
- PARTS CONFORM TO PRODUCT SPECIFICATION PS-10-07.
- PACKAGING INFORMATION: SEE LEGEND.
- PINS MUST CONFORM TO SOLDERABILITY SPECIFICATION SMES-152.
- PIN PUSHOUT FORCE: 2 LBS. MIN.
- PARTS ARE STACKABLE END TO END AND SIDE TO SIDE ON (2.54)/.100 CENTERS.
- THE PRIMARY SHIPPING CARTON WILL BE LABELED, "COMPLIANT TO RoHS DIRECTIVE 2002/95/EC AND ELV ANNEX II OF DIRECTIVE 2000/53/EC." CARTONS WITHOUT THIS LABEL MAY CONTAIN PRODUCT WITH TIN-LEAD PLATING.
- PARTS CONFORM TO CLASS B REQUIREMENTS OF COSMETIC SPECIFICATION PS-45499-002.

A-4094-N * * *
NO. OF CKTS. * * *
VERSION * * *
LETTER CHANGES WHEN PIN NO. OR PRESS DIM. CHANGES.
PLATING CODE * * *
SEE NOTE 2

| SECONDARY OPERATIONS | |
|----------------------|----------------------|
| CODE | PACKAGE |
| BLANK | BULK PER PK-4094-001 |
| A | PK-40873-0020 |

| CKTS. NO. OF | DIM. B | DIM. A |
|--------------|---------------------------------|---------------------------------|
| 2 | .100 ± .002 (2.54 ± .05) | .190 ± .008 (4.83 ± .20) |
| 3 | .200 ± .005 (5.08 ± .13) | .290 ± .008 (7.37 ± .20) |
| 4 | .300 ± .005 (7.62 ± .13) | .390 ± .008 (9.91 ± .20) |
| 5 | .400 ± .005 (10.16 ± .13) | .490 ± .008 (12.45 ± .20) |
| 6 | .500 ± .006 (12.70 ± .15) | .590 ± .009 (14.99 ± .23) |
| 7 | .600 ± .006 (15.24 ± .15) | .690 ± .009 (17.53 ± .23) |
| 8 | .700 ± .006 (17.78 ± .15) | .790 ± .009 (20.07 ± .23) |
| 9 | .800 ± .007 (20.32 ± .18) | .890 ± .010 (22.61 ± .25) |
| 10 | .900 ± .007 (22.86 ± .18) | .990 ± .010 (25.15 ± .25) |
| 11 | 1.000 ± .007 (25.40 ± .18) | 1.090 ± .010 (27.69 ± .25) |
| 12 | 1.100 ± .008 (27.94 ± .20) | 1.190 ± .011 (30.23 ± .28) |
| 13 | 1.200 ± .008 (30.48 ± .20) | 1.290 ± .011 (32.77 ± .28) |
| 14 | 1.300 ± .008 (33.02 ± .20) | 1.390 ± .011 (35.31 ± .28) |
| 15 | 1.400 ± .008 (35.56 ± .20) | 1.490 ± .011 (37.85 ± .28) |
| 16 | 1.500 ± .008 (38.10 ± .20) | 1.590 ± .011 (40.39 ± .28) |
| 17 | 1.600 ± .009 (40.64 ± .23) | 1.690 ± .012 (42.93 ± .30) |
| 18 | 1.700 ± .009 (43.18 ± .23) | 1.790 ± .012 (45.47 ± .30) |
| 19 | 1.800 ± .009 (45.72 ± .23) | 1.890 ± .012 (48.01 ± .30) |
| 20 | 1.900 ± .009 (48.26 ± .23) | 1.990 ± .012 (50.55 ± .30) |
| 21 | 2.000 ± .010 (50.80 ± .25) | 2.090 ± .013 (53.09 ± .33) |
| 22 | 2.100 ± .010 (53.34 ± .25) | 2.190 ± .013 (55.63 ± .33) |
| 23 | 2.200 ± .010 (55.88 ± .25) | 2.290 ± .013 (58.17 ± .33) |
| 24 | 2.300 ± .010 (58.42 ± .25) | 2.390 ± .013 (60.71 ± .33) |
| 25 | 2.400 ± .011 (60.96 ± .28) | 2.490 ± .014 (63.25 ± .36) |
| 26 | 2.500 ± .011 (63.50 ± .28) | 2.590 ± .014 (65.79 ± .36) |
| 27 | 2.600 ± .011 (66.04 ± .28) | 2.690 ± .014 (68.33 ± .36) |
| 28 | 2.700 ± .011 (68.58 ± .28) | 2.790 ± .014 (70.87 ± .36) |

| | |
|----|-----|
| 14 | AD1 |
| 13 | AD1 |
| 12 | AD1 |
| 11 | AD1 |
| 10 | AD1 |
| 9 | AD1 |
| 8 | AD1 |
| 7 | AD1 |
| 6 | AD1 |
| 5 | AD1 |
| 4 | AD1 |
| 3 | AD1 |
| 2 | AD1 |
| 1 | AD3 |

| ADD 1:18 DIMENSION EC NO: UCP2009-0323 DRWG:GVERILL 2008/08/22 CHKD:HK/PPER 2008/08/26 APPR:FSM/LTH 2008/08/27 REV: AD3 | QUALITY SYMBOLS ▽=0 ▽=0 | GENERAL TOLERANCES (UNLESS SPECIFIED) <table border="1"> <tr><th colspan="2">mm</th><th colspan="2">INCH</th></tr> <tr><td>4 PLACES</td><td>± ---</td><td>± ---</td><td>± ---</td></tr> <tr><td>3 PLACES</td><td>± ---</td><td>± .005</td><td>± .005</td></tr> <tr><td>2 PLACES</td><td>± 0.13</td><td>± .01</td><td>± .01</td></tr> <tr><td>1 PLACE</td><td>± 0.25</td><td>± ---</td><td>± ---</td></tr> </table> ANGULAR ±1/2° | mm | | INCH | | 4 PLACES | ± --- | ± --- | ± --- | 3 PLACES | ± --- | ± .005 | ± .005 | 2 PLACES | ± 0.13 | ± .01 | ± .01 | 1 PLACE | ± 0.25 | ± --- | ± --- | DIMENSION STYLE MM/IN SCALE --- INCH DESIGN UNITS INCH THIRD ANGLE PROJECTION | DRAWN BY KSS DATE 1984/09/10 CHECKED BY NP DATE 1984/09/10 APPROVED BY KJA DATE 1984/09/10 | TITLE WAFER ASSY FLAT MINI KK (4030 WITH BENT PINS) 4094 SERIES DRAWING | MATERIAL NO. SEE CHART DOCUMENT NO. SDA-4094 SHEET NO. 1 OF 14 |
|--|-------------------------------|---|--------|--------|------|--|----------|-------|-------|-------|----------|-------|--------|--------|----------|--------|-------|-------|---------|--------|-------|-------|---|--|--|--|
| | mm | | INCH | | | | | | | | | | | | | | | | | | | | | | | |
| | 4 PLACES | ± --- | ± --- | ± --- | | | | | | | | | | | | | | | | | | | | | | |
| | 3 PLACES | ± --- | ± .005 | ± .005 | | | | | | | | | | | | | | | | | | | | | | |
| 2 PLACES | ± 0.13 | ± .01 | ± .01 | | | | | | | | | | | | | | | | | | | | | | | |
| 1 PLACE | ± 0.25 | ± --- | ± --- | | | | | | | | | | | | | | | | | | | | | | | |
| DRAFT WHERE APPLICABLE MUST REMAIN WITHIN DIMENSIONS | | | | | | | | | | | | | | | | | | | | | | | | | | |
| THIS DRAWING CONTAINS INFORMATION THAT IS PROPRIETARY TO MOLEX INCORPORATED AND SHOULD NOT BE USED WITHOUT WRITTEN PERMISSION | | | | | | | | | | | | | | | | | | | | | | | | | | |
| MOLEX MOLEX INCORPORATED | | | | | | | | | | | | | | | | | | | | | | | | | | |

| | 13 | 12 | 11 | 10 | 9 | 8 | 7 | 6 | 5 | 4 | 3 | 2 | 1 | | | | | |
|---|---|--------------|-----------------|-----------------|----------------|-----------------|---|--------|---|--------------|---|-----------------|--|-----------------|--|--------|---|--|
| J | ENG. NO. | PIN NO. | DIM. L | DIM. X | DIM. Z | DIM. Y | DIM. W | DIM. T | ENG. NO. | PIN NO. | DIM. L | DIM. X | DIM. Z | DIM. Y | DIM. W | DIM. T | J | |
| I | A-4094-NA102 | 2766-3(102) | (17.45) .687 | (9.30) .366 | (3.15) .124 | (6.30) .248 | 90° | — | A-4094-NCM501 | 2766-1(501) | (14.22) .560 | (4.47) .176 | (5.92) .233 | (5.11) .201 | 90° | — | I | |
| I | A-4094-NA501 | 2766-3(501) | (17.45) .687 | (9.30) .366 | (3.15) .124 | (6.30) .248 | 90° | — | A-4094-NCN501 | 2766-53(501) | (20.85) .821 | SEE SHT. 7 | | | 90° | — | I | |
| I | A-4094-NAB102 | 2766-40(102) | (23.80) .937 | (14.99) .590 | (3.78) .149 | (6.30) .248 | 90° | — | A-4094-NCR501 | 2766-73(501) | (22.71) .894 | (13.92) .548 | (3.48) .137 | (6.60) .260 | 90° | — | I | |
| I | A-4094-NAC102 | 2766-54(102) | (17.86) .703 | (9.68) .381 | (4.32) .170 | (5.13) .202 | 90° | — | A-4094-NCS501 | 4166-74(501) | (31.24) 1.230 | (22.23) .875 | (3.71) .146 | (6.60) .260 | 90° | — | I | |
| I | A-4094-NAJ102 | 2766-8(102) | (21.39) .842 | (10.19) .401 | (4.09) .161 | (8.41) .331 | 90° | — | A-4094-NCV501 | 2766-28(501) | (15.88) .625 | (7.65) .301 | (3.23) .127 | (6.30) .248 | 90° | — | I | |
| I | A-4094-NAL102 | 2766-8(102) | (21.39) .842 | (12.47) .491 | (3.91) .154 | (6.30) .248 | 90° | — | A-4094-NCY508 | SEE SHT. 8 | | | | 90° | — | I | | |
| H | A-4094-NAM102 | 2766-3(102) | (17.45) .687 | (4.93) .194 | (7.29) .287 | (6.53) .257 | 90° | — | A-4094-NCZ501 | 2766-3(501) | (17.45) .687 | (9.30) .366 | (2.31) .091 | (7.11) .280 | 90° | — | H | |
| H | A-4094-NAP102 | 2766-3(102) | (17.45) .687 | (8.41) .331 | (3.78) .149 | (6.55) .258 | 90° | — | A-4094-NJ102 | 2766-28(102) | (15.88) .625 | (6.63) .261 | (3.02) .119 | (9.73) .383 | 55° | — | H | |
| H | A-4094-NB102 | 2766-43(102) | (13.46) .530 | (4.85) .191 | (3.61) .142 | (6.30) .248 | 90° | — | A-4094-NM102 | 2766-3(102) | (17.45) .687 | (7.44) .293 | (2.84) .112 | (8.46) .333 | 90° | — | H | |
| G | A-4094-NBE102 | 2766-37(102) | (20.32) .800 | (11.53) .454 | (3.56) .140 | (6.50) .256 | 90° | — | A-4094-NR102 | 2766-37(102) | (20.32) .800 | (12.24) .482 | (3.07) .121 | (6.30) .248 | 90° | — | G | |
| G | A-4094-NBE501 | 2766-37(501) | (20.32) .800 | (11.53) .454 | (3.56) .140 | (6.50) .256 | 90° | — | A-4094-NRG501 | 2766-53(501) | (20.85) .821 | (12.32) .485 | (3.53) .139 | (6.30) .248 | 90° | — | G | |
| G | A-4094-NBF102 | 2766-4(102) | (18.69) .736 | (9.30) .366 | (2.79) .110 | (7.87) .310 | 90° | — | A-4094-NW102 | 2766-37(102) | (20.32) .800 | (9.30) .366 | (3.61) .142 | (8.71) .343 | 90° | — | G | |
| G | A-4094-NBF501 | 2766-4(501) | (18.69) .736 | (9.30) .366 | (2.79) .110 | (7.87) .310 | 90° | — | A-4094-NZ102 | 2766-3(102) | (17.45) .687 | (5.13) .202 | (7.95) .313 | (5.66) .223 | 90° | — | G | |
| F | A-4094-NBH102 | 2766-37(102) | (20.32) .800 | (11.71) .461 | (2.31) .091 | (7.57) .298 | 90° | — | A-4094-NH102 | 2766-1(102) | (14.22) .560 | (5.23) .206 | (3.96) .156 | (6.30) .248 | 90° | — | F | |
| F | A-4094-NBK103 | 4166-11(103) | (16.51) .650 | (5.00) .197 | (7.67) .302 | (5.13) .202 | 90° | — | A-4094-NDA102 | 4166-38(102) | (27.00) 1.063 | (9.30) .366 | (3.15) .124 | (15.82) .623 | 90° | — | F | |
| F | A-4094-NBJ102 | 2766-4(102) | (18.69) .736 | (9.42) .371 | (3.63) .143 | (6.93) .273 | 90° | — | A-4094-NDB102 | 4166-30(102) | (30.48) 1.200 | (9.30) .366 | (3.07) .121 | (19.38) .763 | 90° | — | F | |
| F | A-4094-NBJ501 | 2766-4(501) | (18.69) .736 | (9.42) .371 | (3.63) .143 | (6.93) .273 | 90° | — | A-4094-NDC102 | 2766-40(102) | (23.80) .937 | (12.70) .500 | (3.15) .124 | (9.22) .363 | 90° | — | F | |
| F | A-4094-NBL102 | 2766-8(102) | (21.39) .842 | (3.81) .150 | (3.05) .120 | (17.60) .693 | 25° | — | A-4094-NA508 | 2766-3(508) | (17.45) .687 | (9.30) .366 | (3.15) .124 | (6.30) .248 | 90° | — | F | |
| F | A-4094-NBM102 | 2766-28(102) | (15.88) .625 | (5.79) .228 | (4.06) .160 | (6.30) .248 | 139° | — | A-4094-NDD102 | 2766-60(102) | (23.24) .915 | (9.53) .375 | (8.64) .340 | (6.35) .250 | 90° | — | F | |
| F | A-4094-NBP102 | 2766-3(102) | (17.45) .687 | (9.07) .357 | (7.87) .310 | (5.82) .229 | 105° | — | A-4094-NAR102 | 2766-26(102) | (14.99) .590 | (4.06) .160 | (8.03) .316 | (4.09) .161 | 90° | — | F | |
| D | A-4094-NBR501 | 2766-52(501) | (14.61) .575 | (9.30) .366 | (1.63) .064 | (4.90) .193 | 90° | — | A-4094-NAT102 | 2766-4(102) | (18.69) .736 | (8.26) .325 | (3.28) .129 | (12.75) .502 | 45° | — | D | |
| D | A-4094-NBT102 | 2766-39(102) | (12.70) .500 | (6.38) .251 | (2.79) .110 | (4.78) .188 | 90° | — | A-4094-NAT501 | 2766-4(501) | (18.69) .736 | (8.26) .325 | (3.28) .129 | (12.75) .502 | 45° | — | D | |
| D | A-4094-NCA102 | 2766-57(102) | (13.84) .545 | (5.23) .206 | (3.61) .142 | (6.30) .248 | 90° | — | A-4094-NDE501 | 2766-73(501) | (22.71) .894 | (9.98) .393 | (3.00) .118 | (11.00) .433 | 90° | — | D | |
| C | A-4094-NCC102 | 2766-73(102) | (22.71) .894 | (10.74) .423 | (3.25) .128 | (13.61) .536 | 60° | — | A-4094-NDF102 | 2766-16(102) | (22.23) .875 | (6.12) .241 | (11.05) .435 | (6.35) .250 | 90° | — | C | |
| C | A-4094-NCE102 | 2766-54(102) | (17.86) .703 | (9.14) .360 | (3.91) .154 | (6.10) .240 | 90° | — | A-4094-NDG102 | 2766-39(102) | (12.70) .500 | (4.60) .181 | (3.10) .122 | (6.30) .248 | 90° | — | C | |
| C | A-4094-NCM102 | 2766-1(102) | (14.22) .560 | (4.47) .176 | (5.92) .233 | (5.11) .201 | 90° | — | A-4094-NBK102 | 4166-11(102) | (16.51) .650 | (5.00) .197 | (7.67) .302 | (5.13) .202 | 90° | — | C | |
| B | UPDATE TITLE BLOCK EC NO: UCP2005-2329 DRAWN: ADERR 2005/07/26 CHKD: LSHMI DT 2005/07/27 APPR: FSH TH 2005/07/27 AD1 | | | | | | QUALITY SYMBOLS ◻=0 ◻=0 | | GENERAL TOLERANCES (UNLESS SPECIFIED) mm INCH 4 PLACES ± --- ± --- 3 PLACES ± --- ± .005 2 PLACES ± 0.13 ± .01 1 PLACE ± 0.25 ± --- ANGULAR ±1/2° | | DIMENSION STYLE MM/IN DRAWN BY DATE KSS 1984/09/10 CHECKED BY DATE NP 1984/09/10 APPROVED BY DATE KJA 1984/09/10 | | SCALE --- DESIGN UNITS INCH THIRD ANGLE PROJECTION | | TITLE WAFER ASSY FLAT MINI KK (4030 WITH BENT PINS) 4094 SERIES DRAWING MOLEX INCORPORATED | | MATERIAL NO. SEE CHART DOCUMENT NO. SDA-4094 SHEET NO. 2 OF 14 | |
| A | | | | | | | THIS DRAWING CONTAINS INFORMATION THAT IS PROPRIETARY TO MOLEX INCORPORATED AND SHOULD NOT BE USED WITHOUT WRITTEN PERMISSION | | | | | | DRAFT WHERE APPLICABLE MUST REMAIN WITHIN DIMENSIONS | | SIZE C | | SHEET NO. 2 OF 14 | |

| | 13 | 12 | 11 | 10 | 9 | 8 | 7 | 6 | 5 | 4 | 3 | 2 | 1 | |
|---|---------------|------------------|---------------|------------------|----------------|-----------------|----------------|-----------------|----------------|-----------------|----------------|-----------------|---|--|
| | A-4094-NA I02 | | A-4094-NA50 I | | A-4094-NAB I02 | | A-4094-NAC I02 | | A-4094-NAJ I02 | | A-4094-NAL I02 | | | |
| J | PART NO. | ENG. NO. | PART NO. | ENG. NO. | PART NO. | ENG. NO. | PART NO. | ENG. NO. | PART NO. | ENG. NO. | PART NO. | ENG. NO. | J | |
| | 22-05-2021 | * A-4094-2A I02 | 22-12-2021 | * A-4094-2A50 I | 22-05-2026 | A-4094-2AB I02 | | A-4094-2AC I02 | | A-4094-2AJ I02 | 22-05-2027 | A-4094-2AL I02 | | |
| | 22-05-2031 | * A-4094-3A I02 | 22-12-2031 | * A-4094-3A50 I | 22-05-2036 | A-4094-3AB I02 | | A-4094-3AC I02 | | A-4094-3AJ I02 | 22-05-2037 | A-4094-3AL I02 | | |
| | 22-05-2041 | * A-4094-4A I02 | 22-12-2041 | * A-4094-4A50 I | 22-05-2046 | A-4094-4AB I02 | | A-4094-4AC I02 | | A-4094-4AJ I02 | 22-05-2047 | A-4094-4AL I02 | | |
| I | 22-05-2051 | * A-4094-5A I02 | 22-12-2051 | * A-4094-5A50 I | 22-05-2056 | A-4094-5AB I02 | | A-4094-5AC I02 | | A-4094-5AJ I02 | 22-05-2057 | A-4094-5AL I02 | I | |
| | 22-05-2061 | * A-4094-6A I02 | 22-12-2061 | * A-4094-6A50 I | 22-05-2066 | A-4094-6AB I02 | | A-4094-6AC I02 | | A-4094-6AJ I02 | 22-05-2067 | A-4094-6AL I02 | | |
| | 22-05-2071 | * A-4094-7A I02 | 22-12-2071 | * A-4094-7A50 I | 22-05-2076 | A-4094-7AB I02 | | A-4094-7AC I02 | | A-4094-7AJ I02 | 22-05-2077 | A-4094-7AL I02 | | |
| | 22-05-2081 | * A-4094-8A I02 | 22-12-2081 | * A-4094-8A50 I | 22-05-2086 | A-4094-8AB I02 | | A-4094-8AC I02 | | A-4094-8AJ I02 | 22-05-2087 | A-4094-8AL I02 | | |
| | 22-05-2091 | * A-4094-9A I02 | 22-12-2091 | * A-4094-9A50 I | 22-05-2096 | A-4094-9AB I02 | | A-4094-9AC I02 | | A-4094-9AJ I02 | 22-05-2097 | A-4094-9AL I02 | | |
| H | 22-05-2101 | * A-4094-10A I02 | 22-12-2101 | * A-4094-10A50 I | 22-05-2106 | A-4094-10AB I02 | | A-4094-10AC I02 | | A-4094-10AJ I02 | 22-05-2107 | A-4094-10AL I02 | H | |
| | 22-05-2111 | * A-4094-11A I02 | 22-12-2111 | * A-4094-11A50 I | 22-05-2116 | A-4094-11AB I02 | | A-4094-11AC I02 | | A-4094-11AJ I02 | 22-05-2117 | A-4094-11AL I02 | | |
| | 22-05-2121 | * A-4094-12A I02 | 22-12-2121 | * A-4094-12A50 I | 22-05-2126 | A-4094-12AB I02 | | A-4094-12AC I02 | | A-4094-12AJ I02 | 22-05-2127 | A-4094-12AL I02 | | |
| | 22-05-2131 | * A-4094-13A I02 | 22-12-2131 | * A-4094-13A50 I | 22-05-2136 | A-4094-13AB I02 | | A-4094-13AC I02 | | A-4094-13AJ I02 | 22-05-2137 | A-4094-13AL I02 | | |
| | 22-05-2141 | * A-4094-14A I02 | 22-12-2141 | * A-4094-14A50 I | 22-05-2146 | A-4094-14AB I02 | | A-4094-14AC I02 | | A-4094-14AJ I02 | 22-05-2147 | A-4094-14AL I02 | | |
| | 22-05-2151 | * A-4094-15A I02 | 22-12-2151 | * A-4094-15A50 I | 22-05-2156 | A-4094-15AB I02 | | A-4094-15AC I02 | | A-4094-15AJ I02 | 22-05-2157 | A-4094-15AL I02 | | |
| G | 22-05-2161 | * A-4094-16A I02 | 22-12-2161 | * A-4094-16A50 I | 22-05-2166 | A-4094-16AB I02 | | A-4094-16AC I02 | | A-4094-16AJ I02 | 22-05-2167 | A-4094-16AL I02 | G | |
| | 22-05-2171 | * A-4094-17A I02 | 22-12-2171 | * A-4094-17A50 I | 22-05-2176 | A-4094-17AB I02 | | A-4094-17AC I02 | | A-4094-17AJ I02 | 22-05-2177 | A-4094-17AL I02 | | |
| | 22-05-2181 | * A-4094-18A I02 | 22-12-2181 | * A-4094-18A50 I | 22-05-2186 | A-4094-18AB I02 | | A-4094-18AC I02 | | A-4094-18AJ I02 | 22-05-2187 | A-4094-18AL I02 | | |
| | 22-05-2191 | * A-4094-19A I02 | 22-12-2191 | * A-4094-19A50 I | 22-05-2196 | A-4094-19AB I02 | | A-4094-19AC I02 | | A-4094-19AJ I02 | 22-05-2197 | A-4094-19AL I02 | | |
| | 22-05-2201 | * A-4094-20A I02 | 22-12-2201 | * A-4094-20A50 I | 22-05-2206 | A-4094-20AB I02 | | A-4094-20AC I02 | | A-4094-20AJ I02 | 22-05-2207 | A-4094-20AL I02 | | |
| | 22-05-2211 | * A-4094-21A I02 | 22-12-2211 | * A-4094-21A50 I | 22-05-2216 | A-4094-21AB I02 | | A-4094-21AC I02 | | A-4094-21AJ I02 | 22-05-2217 | A-4094-21AL I02 | | |
| F | 22-05-2221 | * A-4094-22A I02 | 22-12-2221 | * A-4094-22A50 I | 22-05-2226 | A-4094-22AB I02 | | A-4094-22AC I02 | | A-4094-22AJ I02 | 22-05-2227 | A-4094-22AL I02 | F | |
| | 22-05-2231 | * A-4094-23A I02 | 22-12-2231 | * A-4094-23A50 I | 22-05-2236 | A-4094-23AB I02 | | A-4094-23AC I02 | | A-4094-23AJ I02 | 22-05-2237 | A-4094-23AL I02 | | |
| | 22-05-2241 | * A-4094-24A I02 | 22-12-2241 | * A-4094-24A50 I | 22-05-2246 | A-4094-24AB I02 | | A-4094-24AC I02 | | A-4094-24AJ I02 | 22-05-2247 | A-4094-24AL I02 | | |
| | 22-05-2251 | * A-4094-25A I02 | 22-12-2251 | * A-4094-25A50 I | 22-05-2256 | A-4094-25AB I02 | | A-4094-25AC I02 | | A-4094-25AJ I02 | 22-05-2257 | A-4094-25AL I02 | | |
| | 22-05-2261 | A-4094-26A I02 | 22-12-2261 | A-4094-26A50 I | 22-05-2266 | A-4094-26AB I02 | | A-4094-26AC I02 | | A-4094-26AJ I02 | 22-05-2267 | A-4094-26AL I02 | | |
| E | 22-05-2271 | A-4094-27A I02 | 22-12-2271 | A-4094-27A50 I | 22-05-2276 | A-4094-27AB I02 | | A-4094-27AC I02 | | A-4094-27AJ I02 | 22-05-2277 | A-4094-27AL I02 | E | |
| | 22-05-2281 | A-4094-28A I02 | 22-12-2281 | A-4094-28A50 I | 22-05-2286 | A-4094-28AB I02 | | A-4094-28AC I02 | | A-4094-28AJ I02 | 22-05-2287 | A-4094-28AL I02 | | |

| UPDATE TITLE BLOCK EC NO: UCP2005-2329 DRAWN: ADERR 2005/07/26 CHKD: LSJHMI DT 2005/07/27 APPR: FSM TH 2005/07/27 REVISIONS AD1 | QUALITY SYMBOLS | GENERAL TOLERANCES (UNLESS SPECIFIED) <table border="1"> <thead> <tr> <th></th> <th>mm</th> <th>INCH</th> </tr> </thead> <tbody> <tr> <td>4 PLACES</td> <td>± ---</td> <td>± ---</td> </tr> <tr> <td>3 PLACES</td> <td>± ---</td> <td>± ---</td> </tr> <tr> <td>2 PLACES</td> <td>± ---</td> <td>± ---</td> </tr> <tr> <td>1 PLACE</td> <td>± ---</td> <td>± ---</td> </tr> </tbody> </table> | | mm | INCH | 4 PLACES | ± --- | ± --- | 3 PLACES | ± --- | ± --- | 2 PLACES | ± --- | ± --- | 1 PLACE | ± --- | ± --- | DIMENSION STYLE MM/IN | SCALE --- | DESIGN UNITS INCH | THIRD ANGLE PROJECTION |
|---|---------------------|--|--------------------|--|--------------------------|----------------------|-------|-------|----------|-------|-------|----------|-------|-------|---------|-------|-------|--------------------------|--------------|----------------------|------------------------|
| | | mm | INCH | | | | | | | | | | | | | | | | | | |
| | 4 PLACES | ± --- | ± --- | | | | | | | | | | | | | | | | | | |
| | 3 PLACES | ± --- | ± --- | | | | | | | | | | | | | | | | | | |
| 2 PLACES | ± --- | ± --- | | | | | | | | | | | | | | | | | | | |
| 1 PLACE | ± --- | ± --- | | | | | | | | | | | | | | | | | | | |
| | | DRAWN BY KSS | DATE 1984/09/10 | TITLE WAFER ASSY FLAT MINI KK (4030 WITH BENT PINS) 4094 SERIES DRAWING | | | | | | | | | | | | | | | | | |
| | | CHECKED BY NP | DATE 1984/09/10 | MOLEX INCORPORATED | | | | | | | | | | | | | | | | | |
| | | APPROVED BY KJA | DATE 1984/09/10 | MATERIAL NO. SEE CHART | DOCUMENT NO. SDA-4094 | SHEET NO. 4 OF 14 | | | | | | | | | | | | | | | |