

HANDLES

TYPE

PATTERN



THREAD OR BORE

LENGTH OF
MALE THREAD

RENKOL

17

Gloss finish duroplast

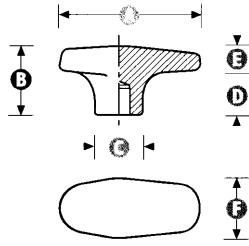

FEMALE	1345	60	30	20	18	12	25	M6	M8
Moulded thread	1346	80	30	22	18	12	30	M8	M10
	1347	100	35	25	20	15	32	M10	M12

Matt finish reinforced thermoplastic

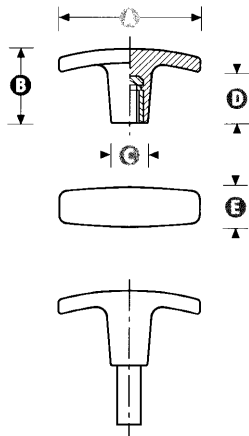
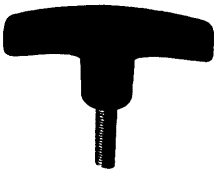

FEMALE	3750	50	24	14	16	16		M5	
Brass insert	3760	60	24	16	16	18		M6	
	3772	72	32	18	20	20		M8	
MALE	3750/M	50	24	14	16	16		M5	15 20
Plated steel insert	3760/M	60	32	16	22	18		M6	20 25
	3772/M	72	32	18	22	20		M8	20 30

Matt finish duroplast

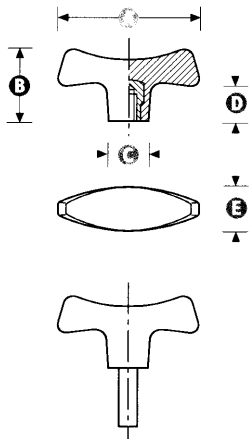
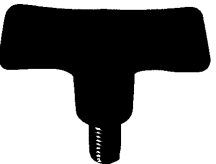

FEMALE											
Aluminium insert	1462	70	43	20	20	17		M6	M8	M10	
MALE	1462/M	70	43	20	20	17		M6	M8	M10	20 25
Plated steel insert											

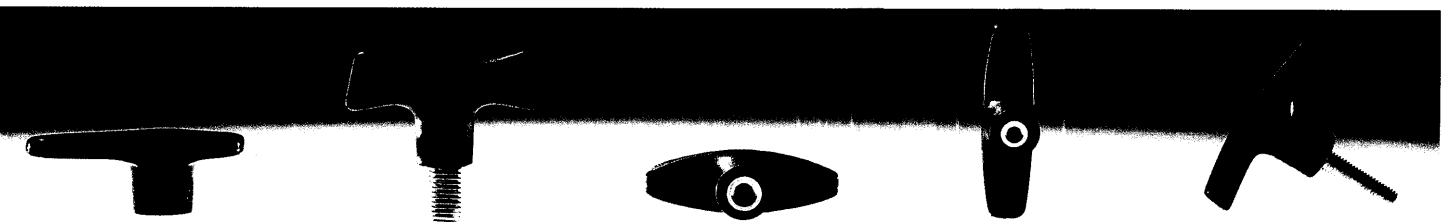

TYPE

PATTERN



THREAD OR BORE

LENGTH OF
MALE THREAD

Most patterns are available with imperial threads (Whitworth) or bores

Non standard thread diameters, lengths, insert materials and other modifications are available for minimum quantities. The standard colour is black. Some patterns are available in a choice of colours. Contact our sales department for details.

All dimensions in mm and are approximate