

# MM3Z2V4C-MM3Z75VC

## Zener Diodes

### Features

- Wide Zener Voltage Range Selection, 2.4V to 75V
- VZ Tolerance Selection of  $\pm 5\%$  (C Series)
- Very Small and Thin SMD package
- Clip Bonding Construction, Good Thermal Capability
- Matte Tin(Sn) finish, Pb Free



SOD-323F

### Connection Diagram

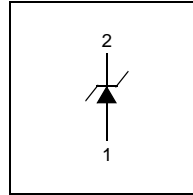

### Absolute Maximum Ratings T<sub>a</sub> = 25°C unless otherwise noted

| Symbol           | Parameter                    | Value                          | Units |
|------------------|------------------------------|--------------------------------|-------|
| P <sub>D</sub>   | Power Dissipation            | 200                            | mW    |
| T <sub>STG</sub> | Storage Temperature Range    | -65 to +150                    | °C    |
| T <sub>J</sub>   | Maximum Junction Temperature | 150                            | °C    |
| I <sub>ZM</sub>  | Maximum Regulator Current    | P <sub>D</sub> /V <sub>Z</sub> | mA    |

\* These ratings are limiting values above which the serviceability of the diode may be impaired.

### Thermal Characteristics

| Symbol           | Parameter                               | Value | Unit |
|------------------|---|-------|------|
| R <sub>θJA</sub> | Thermal Resistance, Junction to Ambient | 595   | °C/W |

\* Device mounted on PCB with minimum land pad.

### Electrical Characteristics T<sub>amb</sub> = 25°C unless otherwise specified

| Symbol         | Parameter/ Test condition               | Min. | Typ. | Max. | Unit |
|----------------|---|------|------|------|------|
| V <sub>F</sub> | Forward Voltage / I <sub>F</sub> =10 mA | --   | --   | 1.0  | V    |

### Package Marking and Ordering Information

| Device Marking              | Device                      | Package  | Packing     | Reel Size | Tape Width | Quantity |
|-----------------------------|-----------------------------|----------|-------------|-----------|------------|----------|
| Refer to Product table list | Refer to Product table list | SOD-323F | Tape & Reel | 7'        | 12mm       | 3,000    |

## Electrical Characteristics T<sub>A</sub>=25°C unless otherwise noted

| Device Type | Device Marking | V <sub>Z</sub> (V) @ I <sub>ZT</sub> |      |       | Z <sub>ZT</sub> (Ω)<br>@ I <sub>ZT</sub> | I <sub>ZT</sub><br>(mA) | Z <sub>ZK</sub> (Ω)<br>@ I <sub>ZK</sub> | I <sub>ZK</sub><br>(mA) | I <sub>R</sub> (μA)<br>@ V <sub>R</sub> | V <sub>R</sub> (V) |
|-------------|----------------|--------------------------------------|------|-------|--|-------------------------|--|-------------------------|---|--------------------|
|             |                | Min.                                 | Typ. | Max.  | Max.                                     | -                       | Max.                                     | -                       | Max                                     | -                  |
| MM3Z2V4C    | Z0             | 2.28                                 | 2.4  | 2.52  | 94                                       | 5                       | 564                                      | 1                       | 45                                      | 1                  |
| MM3Z2V7C    | Z1             | 2.57                                 | 2.7  | 2.84  | 94                                       | 5                       | 564                                      | 1                       | 18                                      | 1                  |
| MM3Z3V0C    | Z2             | 2.85                                 | 3    | 3.15  | 89                                       | 5                       | 564                                      | 1                       | 9                                       | 1                  |
| MM3Z3V3C    | Z3             | 3.14                                 | 3.3  | 3.47  | 89                                       | 5                       | 564                                      | 1                       | 4.5                                     | 1                  |
| MM3Z3V6C    | Z4             | 3.42                                 | 3.6  | 3.78  | 84                                       | 5                       | 564                                      | 1                       | 4.5                                     | 1                  |
| MM3Z3V9C    | Z5             | 3.71                                 | 3.9  | 4.1   | 84                                       | 5                       | 564                                      | 1                       | 2.7                                     | 1                  |
| MM3Z4V3C    | Z6             | 4.09                                 | 4.3  | 4.52  | 84                                       | 5                       | 564                                      | 1                       | 2.7                                     | 1                  |
| MM3Z4V7C    | Z7             | 4.47                                 | 4.7  | 4.94  | 75                                       | 5                       | 470                                      | 1                       | 2.7                                     | 2                  |
| MM3Z5V1C    | Z8             | 4.85                                 | 5.1  | 5.36  | 56                                       | 5                       | 451                                      | 1                       | 1.8                                     | 2                  |
| MM3Z5V6C    | Z9             | 5.32                                 | 5.6  | 5.88  | 37                                       | 5                       | 376                                      | 1                       | 0.9                                     | 2                  |
| MM3Z6V2C    | ZA             | 5.89                                 | 6.2  | 6.51  | 9  | 5                       | 141                                      | 1                       | 2.7                                     | 4                  |
| MM3Z6V8C    | ZB             | 6.46                                 | 6.8  | 7.14  | 14                                       | 5                       | 75                                       | 1                       | 1.8                                     | 4                  |
| MM3Z7V5C    | ZC             | 7.11                                 | 7.5  | 7.86  | 14                                       | 5                       | 75                                       | 1                       | 0.9                                     | 5                  |
| MM3Z8V2C    | ZD             | 7.79                                 | 8.2  | 8.61  | 14                                       | 5                       | 75                                       | 1                       | 0.63                                    | 5                  |
| MM3Z9V1C    | ZE             | 8.65                                 | 9.1  | 9.56  | 14                                       | 5                       | 94                                       | 1                       | 0.45                                    | 6                  |
| MM3Z10VC    | ZF             | 9.5                                  | 10   | 10.5  | 18                                       | 5                       | 141                                      | 1                       | 0.18                                    | 7                  |
| MM3Z11VC    | ZG             | 10.45                                | 11   | 11.55 | 18                                       | 5                       | 141                                      | 1                       | 0.09                                    | 8                  |
| MM3Z12VC    | ZH             | 11.4                                 | 12   | 12.6  | 23                                       | 5                       | 141                                      | 1                       | 0.09                                    | 8                  |
| MM3Z13VC    | ZJ             | 12.35                                | 13   | 13.65 | 28                                       | 5                       | 160                                      | 1                       | 0.09                                    | 8                  |
| MM3Z15VC    | ZK             | 14.25                                | 15   | 15.75 | 28                                       | 5                       | 188                                      | 1                       | 0.045                                   | 10.5               |
| MM3Z16VC    | ZL             | 15.2                                 | 16   | 16.8  | 37                                       | 5                       | 188                                      | 1                       | 0.045                                   | 11.2               |
| MM3Z18VC    | ZM             | 17.1                                 | 18   | 18.9  | 42                                       | 5                       | 212                                      | 1                       | 0.045                                   | 12.6               |
| MM3Z20VC    | ZN             | 19                                   | 20   | 21    | 51                                       | 5                       | 212                                      | 1                       | 0.045                                   | 14                 |
| MM3Z22VC    | ZP             | 20.9                                 | 22   | 23.1  | 51                                       | 5                       | 235                                      | 1                       | 0.045                                   | 15.4               |
| MM3Z24VC    | ZR             | 22.8                                 | 24   | 25.2  | 65                                       | 5                       | 235                                      | 1                       | 0.045                                   | 16.8               |
| MM3Z27VC    | ZS             | 25.65                                | 27   | 28.35 | 75                                       | 5                       | 282                                      | 0.5                     | 0.045                                   | 18.9               |
| MM3Z30VC    | ZT             | 28.5                                 | 30   | 31.5  | 75                                       | 5                       | 282                                      | 0.5                     | 0.045                                   | 21                 |
| MM3Z33VC    | ZU             | 31.35                                | 33   | 34.65 | 75                                       | 5                       | 306                                      | 0.5                     | 0.045                                   | 23                 |
| MM3Z36VC    | ZV             | 34.2                                 | 36   | 37.8  | 84                                       | 5                       | 329                                      | 0.5                     | 0.045                                   | 25.2               |
| MM3Z39VC    | ZW             | 37.05                                | 39   | 40.95 | 122                                      | 5                       | 329                                      | 0.5                     | 0.045                                   | 27.3               |
| MM3Z43VC    | ZX             | 40.85                                | 43   | 45.15 | 141                                      | 5                       | 353                                      | 0.5                     | 0.045                                   | 30.1               |
| MM3Z47VC    | ZY             | 44.65                                | 47   | 49.35 | 160                                      | 5                       | 353                                      | 0.5                     | 0.045                                   | 33                 |
| MM3Z51VC    | Z-             | 48.45                                | 51   | 53.55 | 169                                      | 5                       | 376                                      | 0.5                     | 0.045                                   | 35.7               |
| MM3Z56VC    | Z=             | 53.2                                 | 56   | 58.8  | 188                                      | 5                       | 400                                      | 0.5                     | 0.045                                   | 39.2               |
| MM3Z62VC    | Z≡             | 58.9                                 | 62   | 65.1  | 202                                      | 5                       | 423                                      | 0.5                     | 0.045                                   | 43.4               |
| MM3Z68VC    | Z>             | 64.6                                 | 68   | 71.4  | 226                                      | 5                       | 447                                      | 0.5                     | 0.045                                   | 47.6               |
| MM3Z75VC    | Z<             | 71.25                                | 75   | 78.75 | 240                                      | 5                       | 470                                      | 0.5                     | 0.045                                   | 52.5               |

## Notes :

- The Zener Voltage (V<sub>Z</sub>) is tested under pulse condition of 10mS.
- The device numbers listed have a standard tolerance on the nominal zener voltage of ±5%.
- The zener impedance is derived from the 60-cycle ac voltage, which results when an ac current having an rms value equal to 10% of the dc zener current (I<sub>ZT</sub> or I<sub>ZK</sub>) is superimposed to I<sub>ZT</sub> or I<sub>ZK</sub>.

## Typical Performance Characteristics

Figure 1. Zener current vs. Zener Voltage

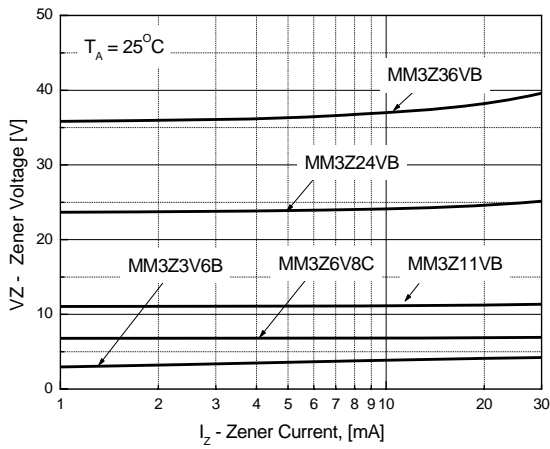

Figure 2. Zener current vs. Zener Impedance

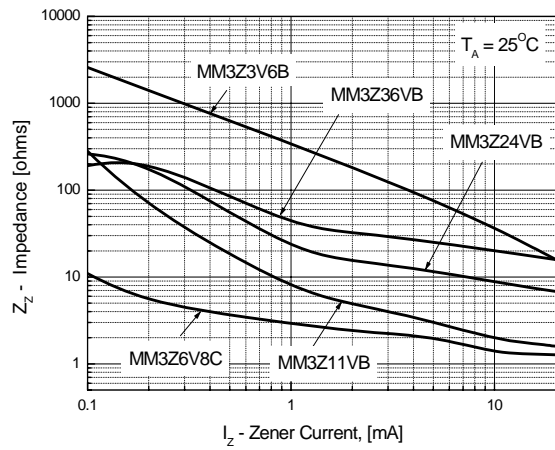

Figure 3. MM3Z3V6B  
Zener current vs. Zener Voltage

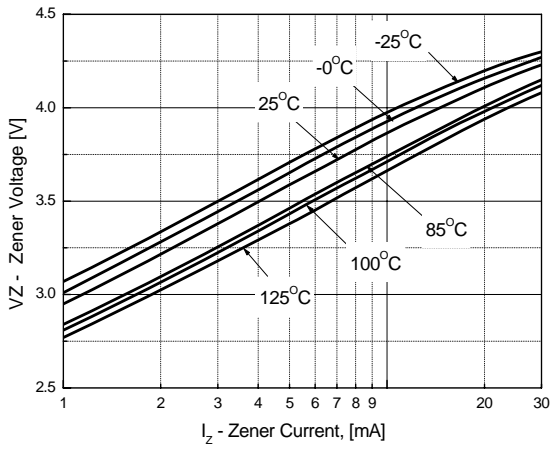

Figure 4. MM3Z6V8C  
Zener current vs. Zener Voltage

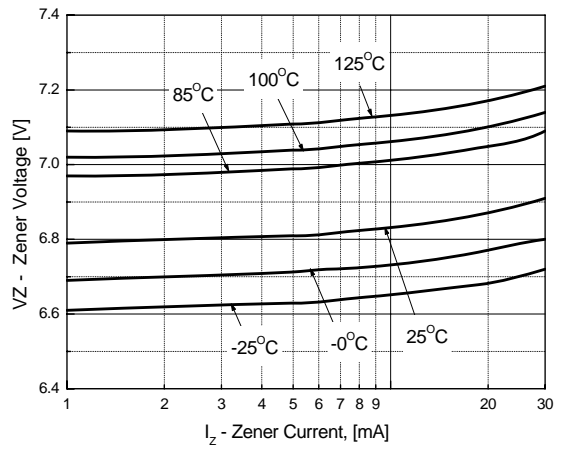

Figure 5. MM3Z11VB  
Zener current vs. Zener Voltage

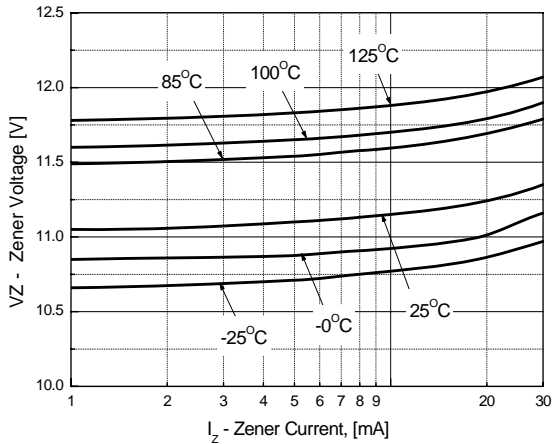
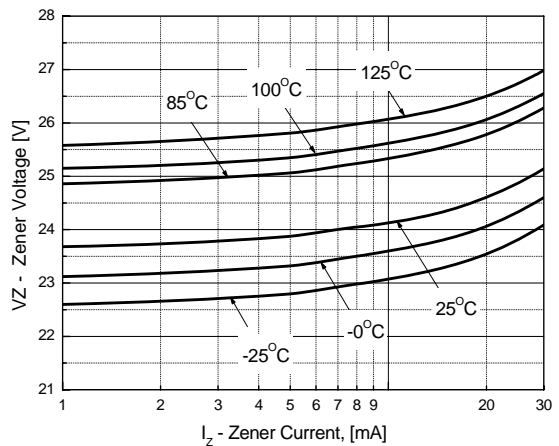
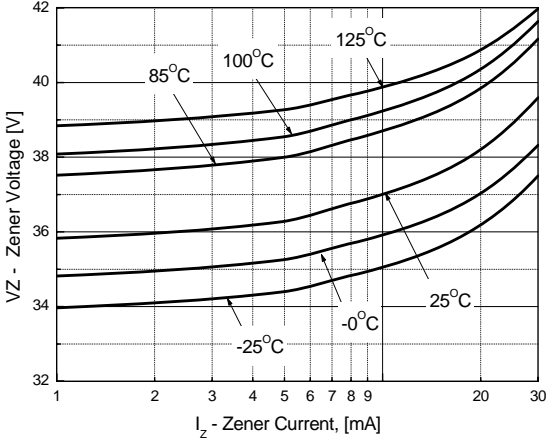

Figure 6. MM3Z24VB  
Zener current vs. Zener Voltage



Typical Performance Characteristics

Figure 7. MM3Z36VB  
Zener current vs. Zener Voltage



# Package Dimensions

## SOD - 323F

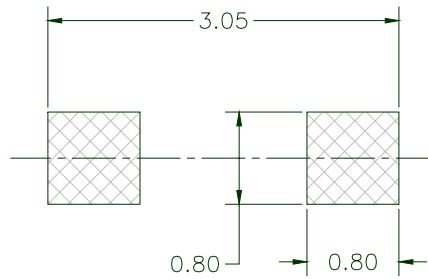
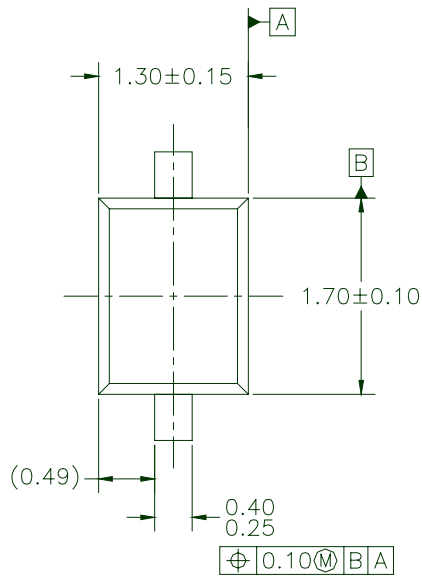

LAND PATTERN RECOMMENDATION

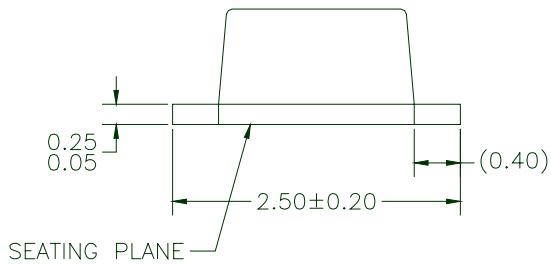

NOTES: UNLESS OTHERWISE SPECIFIED

- A) THIS PACKAGE IS COMPLIANT TO JEITA SC90 STANDARD EXCEPT FOR THE OVERALL PACKAGE HEIGHT.
- B) ALL DIMENSIONS ARE IN MILLIMETERS.
- C) DIMENSIONS ARE EXCLUSIVE OF BURRS, MOLD FLASH AND TIE BAR EXTRUSIONS.
- D) DIMENSIONING AND TOLERANCING PER ASME Y14.5M - 1994.



## TRADEMARKS

The following are registered and unregistered trademarks Fairchild Semiconductor owns or is authorized to use and is not intended to be an exhaustive list of all such trademarks.

|                                      |                    |                            |                 |
|--------------------------------------|--------------------|----------------------------|-----------------|
| ACEx™                                | GTO™               | PowerSaver™                | TinyBuck™       |
| Across the board. Around the world.™ | HiSeC™             | PowerTrench®               | TinyLogic®      |
| ActiveArray™                         | <i>i-Lo</i> ™      | Programmable Active Droop™ | TINYOPTO™       |
| Bottomless™                          | ImpliedDisconnect™ | QFET®                      | TinyPower™      |
| Build it Now™                        | IntelliMAX™        | QS™                        | TinyWire™       |
| CoolFET™                             | ISOPLANAR™         | QT Optoelectronics™        | TruTranslation™ |
| CROSSVOLT™                           | MICROCOUPLER™      | Quiet Series™              | μSerDes™        |
| CTL™                                 | MicroPak™          | RapidConfigure™            | UHC®            |
| <i>Current Transfer Logic</i> ™      | MICROWIRE™         | RapidConnect™              | UniFET™         |
| DOMET™                               | MSX™               | ScalarPump™                | VCX™            |
| E <sup>2</sup> CMOS™                 | MSXPro™            | SMART START™               | Wire™           |
| EcoSPARK®                            | OCX™               | SPM™                       |                 |
| EnSigna™                             | OCXPro™            | SuperFET™                  |                 |
| FACT Quiet Series™                   | OPTOLOGIC®         | SuperSOT™-3                |                 |
| FACT®                                | OPTOPLANAR™®       | SuperSOT™-6                |                 |
| FAST®                                | PACMAN™            | SuperSOT™-8                |                 |
| FASTr™                               | POP™               | TCM™                       |                 |
| FPS™                                 | Power220®          | The Power Franchise®       |                 |
| FRFET™                               | Power247®          | TinyBoost™                 |                 |
| GlobalOptoisolator™                  | PowerEdge™         |                            |                 |

## DISCLAIMER

FAIRCHILD SEMICONDUCTOR RESERVES THE RIGHT TO MAKE CHANGES WITHOUT FURTHER NOTICE TO ANY PRODUCTS HEREIN TO IMPROVE RELIABILITY, FUNCTION OR DESIGN. FAIRCHILD DOES NOT ASSUME ANY LIABILITY ARISING OUT OF THE APPLICATION OR USE OF ANY PRODUCT OR CIRCUIT DESCRIBED HEREIN; NEITHER DOES IT CONVEY ANY LICENSE UNDER ITS PATENT RIGHTS, NOR THE RIGHTS OF OTHERS. THESE SPECIFICATIONS DO NOT EXPAND THE TERMS OF FAIRCHILD'S WORLDWIDE TERMS AND CONDITIONS, SPECIFICALLY THE WARRANTY THEREIN, WHICH COVERS THESE PRODUCTS.

## LIFE SUPPORT POLICY

FAIRCHILD'S PRODUCTS ARE NOT AUTHORIZED FOR USE AS CRITICAL COMPONENTS IN LIFE SUPPORT DEVICES OR SYSTEMS WITHOUT THE EXPRESS WRITTEN APPROVAL OF FAIRCHILD SEMICONDUCTOR CORPORATION.

As used herein:

1. Life support devices or systems are devices or systems which, (a) are intended for surgical implant into the body, or (b) support or sustain life, or (c) whose failure to perform when properly used in accordance with instructions for use provided in the labeling, can be reasonably expected to result in significant injury to the user.

2. A critical component is any component of a life support device or system whose failure to perform can be reasonably expected to cause the failure of the life support device or system, or to affect its safety or effectiveness.

## PRODUCT STATUS DEFINITIONS

### Definition of Terms

| Datasheet Identification | Product Status         | Definition  |
|--------------------------|------------------------|---|
| Advance Information      | Formative or In Design | This datasheet contains the design specifications for product development. Specifications may change in any manner without notice.  |
| Preliminary              | First Production       | This datasheet contains preliminary data, and supplementary data will be published at a later date. Fairchild Semiconductor reserves the right to make changes at any time without notice in order to improve design. |
| No Identification Needed | Full Production        | This datasheet contains final specifications. Fairchild Semiconductor reserves the right to make changes at any time without notice in order to improve design.   |
| Obsolete                 | Not In Production      | This datasheet contains specifications on a product that has been discontinued by Fairchild semiconductor. The datasheet is printed for reference information only.   |

Rev. I23