

TOLERANCE UNLESS SPECIFIED =

.XXX= +/- .005

.XX= +/- .015

FRACTIONS= +/- .032

# PRODUCTION TESTS

VPP12-2400.DC2

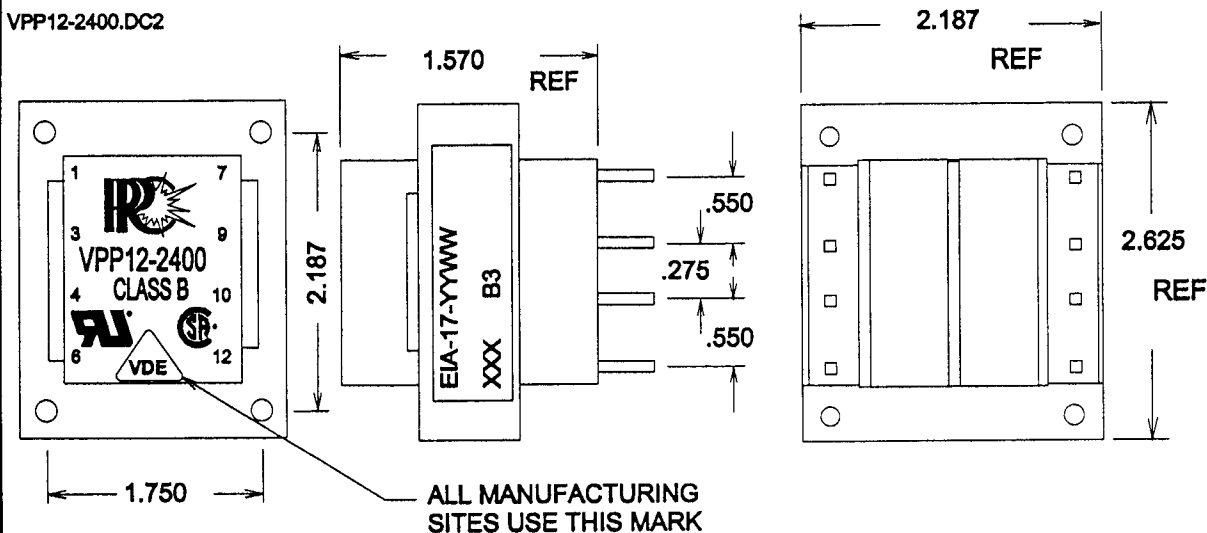

|                       |         |         |
|-----------------------|---------|---------|
| TURNS RATIO = 100%    |         |         |
| DC RESISTANCE IN OHMS | 1-3 =   | 51 NOM  |
|                       | 4-6 =   | 63 NOM  |
|                       | 7-9 =   | .24 NOM |
|                       | 10-12 = | .29 NOM |

MAX EXCITATION CURRENT = .040 A  
 APPLY 230V 60HZ 1-6 (3+4)  
 PRI WDGS 114.5 TO 115.5 V  
 SEC WDGS 7.45 TO 8.0 V

HIPOT: 4000V P-S  
 4000V P,S, TO CORE  
 600V P-P, S-S

IMPREGNATION NOTES: PREHEAT 2 HRS  
 PINS TO BE FREE OF IMPREGNATION

## FINAL ASSEMBLY NOTES

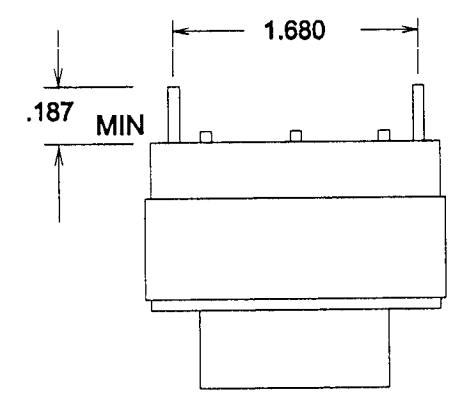
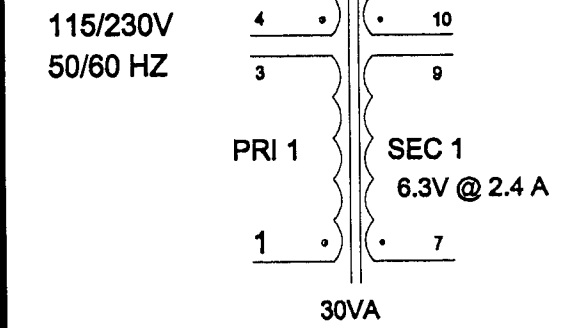

**METHOD** 1 X 1  
LEAVE OFF LAST "I" PCS

**MARKING** SEE LABEL DETAIL ABOVE  
APPLY PART NO. LABEL, AFTER IMPREGNATION.

PART NO.: VPP12-2400