

On phase-out, not recommended for new designs

PHASE-OUT



60.0VDC · 1.1 - 3.75A



Description

- PFRY is recommended as substitute

Standards

- UL 1434
- CSA C22.2 no. 0, TIL no. CA-3A

Approvals

- UL File Number: E172175

Applications

- Security and fire alarm systems
- Loud speakers
- Power transformers

References

[GeneralProductInformation](#)
Time-Current Curves see last page
[PackagingDetails](#)

Weblinks

Approvals: <http://www.schurter.com/approvals>
RoHS: <http://www.schurter.com/rohs>
CHINA-RoHS: <http://www.schurter.com/china-rohs>
Stock-Check: <https://sapportal.schurter.ch:8888/irj/portal/anonymous>

Technical Data

| | |
|---------------------------|------------------------------|
| V max | 60.0VDC |
| I max | 40A |
| I hold | 1.1 - 3.75A |
| Fastening | PCB,THT |
| Allowable Operation Temp. | -40 °C to 85 °C |
| Material: Terminals | Tin-Plated Copper |
| Weight | 0.35 g |
| Storage Conditions | 0 °C to 40 °C, max. 70% r.h. |
| Product Marking | Type, I hold |

| | |
|------------------------------|---|
| Soldering Methods | Wave |
| Solderability | 235 °C / 2 sec |
| Resistance to Soldering Heat | 260 °C / 10 sec |
| Passing Aging | +85 °C, 1000 Hours -> +/- 5% Typical Resistance Change |
| Humidity Aging | +85 °C, 85% r.h., 1000 Hours -> +/- 5% Typical Resistance Change |
| Thermal Shock | MIL-STD-202, Method 107 (+125 °C to -55 °C, 10 Cycles) -> +/- 15% Typical Resistance Change |
| Vibration | MIL-STD-883C, Method 2007.1, Test Condition A |
| Resistance to Solvents | MIL-STD-202, Methode 215 |
| Flammability | UL 94V-0 |

Dimensions

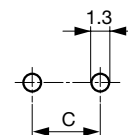
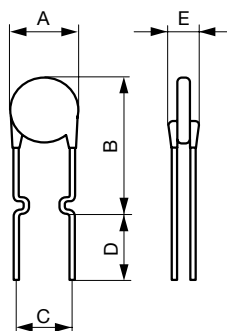

[Stock-Check](#)

Dimensions
[Stock-Check](#)

| A max [mm] | B max [mm] | C min [mm] | C max [mm] | D min [mm] | E max [mm] | Ø Lead [mm] | Order Number |
|------------|------------|------------|------------|------------|------------|-------------|--------------|
| 13 | 18 | 4.4 | 5.1 | 7.6 | 3.1 | 0.81 | PFRX.110 |
| 14.5 | 19.6 | 4.4 | 5.1 | 7.6 | 3.1 | 0.81 | PFRX.135 |
| 16.3 | 21.3 | 4.4 | 5.1 | 7.6 | 3.1 | 0.81 | PFRX.160 |
| 17.8 | 22.9 | 4.4 | 5.1 | 7.6 | 3.1 | 0.81 | PFRX.185 |
| 21.3 | 26.4 | 9.5 | 10.2 | 7.6 | 3.1 | 0.81 | PFRX.250 |
| 24.9 | 30 | 9.5 | 10.2 | 7.6 | 3.1 | 0.81 | PFRX.300 |
| 28.4 | 33.5 | 9.5 | 10.2 | 7.6 | 3.1 | 0.81 | PFRX.375 |

Thermal Derating Chart Ihold [A]
[Stock-Check](#)

| -40 °C | -20 °C | 0 °C | 23 °C | 40 °C | 50 °C | 60 °C | 70 °C | 85 °C | Order Number |
|--------|--------|------|-------|-------|-------|-------|-------|-------|--------------|
| 1.71 | 1.5 | 1.31 | 1.1 | 0.89 | 0.79 | 0.69 | 0.59 | 0.44 | PFRX.110 |
| 2.09 | 1.84 | 1.61 | 1.35 | 1.09 | 0.97 | 0.85 | 0.73 | 0.54 | PFRX.135 |
| 2.48 | 2.18 | 1.9 | 1.6 | 1.3 | 1.15 | 1.01 | 0.86 | 0.64 | PFRX.160 |
| 2.87 | 2.52 | 2.2 | 1.85 | 1.5 | 1.33 | 1.17 | 1 | 0.74 | PFRX.185 |
| 3.88 | 3.4 | 2.98 | 2.5 | 2.03 | 1.8 | 1.58 | 1.35 | 1 | PFRX.250 |
| 4.65 | 4.08 | 3.57 | 3 | 2.43 | 2.16 | 1.89 | 1.62 | 1.2 | PFRX.300 |
| 5.81 | 5.1 | 4.46 | 3.75 | 3.04 | 2.7 | 2.36 | 2.03 | 1.5 | PFRX.375 |

Electrical Characteristics at 23 °C
[Stock-Check](#)

| V max [VDC] | I max [A] | I hold [A] | I trip [A] | R initial min [Ω] | R initial max [Ω] | R 1hour max [Ω] | Max Time to trip [A] | Max Time to Trip [s] | Tripped Power Dissipation [W] | Order Number |
|-------------|-----------|------------|------------|-------------------|-------------------|-----------------|----------------------|----------------------|-------------------------------|--------------|
| 60.0 | 40 | 1.1 | 2.2 | 0.15 | 0.25 | 0.38 | 5.5 | 8.2 | 1.50 | PFRX.110 |
| 60.0 | 40 | 1.35 | 2.7 | 0.12 | 0.19 | 0.3 | 6.75 | 9.6 | 1.70 | PFRX.135 |
| 60.0 | 40 | 1.6 | 3.2 | 0.09 | 0.14 | 0.22 | 8 | 11.4 | 1.90 | PFRX.160 |
| 60.0 | 40 | 1.85 | 3.7 | 0.08 | 0.12 | 0.19 | 9.25 | 12.6 | 2.10 | PFRX.185 |
| 60.0 | 40 | 2.5 | 5 | 0.05 | 0.08 | 0.13 | 12.5 | 15.6 | 2.50 | PFRX.250 |
| 60.0 | 40 | 3 | 6 | 0.04 | 0.06 | 0.1 | 15 | 19.8 | 2.80 | PFRX.300 |
| 60.0 | 40 | 3.75 | 7.5 | 0.03 | 0.05 | 0.08 | 18.75 | 24 | 3.20 | PFRX.375 |

Packaging Unit

PFRX.xxx Bulk (500 pcs.)
 PFRX.110.2 - PFRX.160.2 Taped 34 cm Reel (1500 pcs.)
 PFRX.185.2 Taped 34 cm Reel (1000 pcs.)

Time-Current Curves

