

No. 392 / TE5®

IEC 60127-3/IV, 250 V, T

Specifications



Lead Free

Time-Current Characteristic
Time Lag (T)

Standard

According to IEC 60127-3/IV

Approvals

- VDE Expert Report
- SEMKO
- cULus Recognized
- METI-PSE
- CCC

Features

- Lead Free
- Reduced PCB space requirements
- Direct solderable or plug-in versions
- Internationally approved
- Low internal resistance
- Shocksafe casing
- Vibration resistant
- Halogen free

WebLinks

Further infos see:
www.wickmanngroup.com

Further application infos see
Fuseology:
www.wickmanngroup.com/download/fuseology.pdf



Packaging

- 000: Tape/Ammopack (1400 pcs.)
- 044: Short Leads - Bulk (1400 pcs.)

Materials

- Base/Cap: Brown Thermoplastic
Polyamide PA 6.6, UL 94 V0
- Round Pins: Copper, Sn plated

Operating Temperature

-40 °C to +85 °C (consider de-rating)

Climatic Category

-40 °C/+85 °C/21 days
(EN 60068-1,-2-1,-2-2,-78)

Stock Conditions

+10 °C to +60 °C
relative humidity ≤ 75 % yearly average,
without dew, maximum value for 30 days - 95 %

Vibration Resistance

- 24 cycles at 15 min. each (EN 60068-6)
- 10 - 60 Hz at 0.75 mm amplitude
- 60 - 2000 Hz at 10 g acceleration

Lead Pull Strength

10 N (IEC 60068-2-21)

Solderability

- 260 °C, ≤ 3 s (Wave)
- 350 °C, ≤ 3 s (Soldering iron)

Soldering Heat Resistance

260 °C, 10 s (IEC 60068-2-20)

Marking

Ⓢ, T, Current Rating, Approvals

Unit Weight

0.60 g (approx.)

Dimensions (mm)

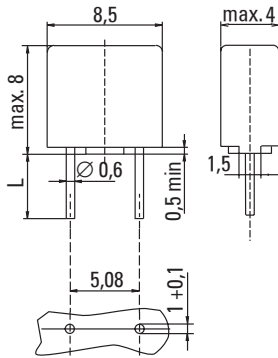

Holes in PCB

Long Leads (L=18.8 mm)
Short Leads (L=4.3 mm)



Limits for Pre-arcing Time

Rated Current	1.5 x I _N	2.1 x I _N	2.75 x I _N	4 x I _N	10 x I _N
800 mA ... 4.00 A	> 1 h	< 2 min	400 ms ... 10 s	150 ms ... 3 s	20 ms ... 150 ms

Permissible continuous operating current is ≤ 100 % at ambient temperature of 23 °C (73.4 °F).

Rated Current	Amp Code	Voltage Rating	Breaking Capacity 50-60Hz/cos φ=1.0	Voltage Drop 1.0 x I _N Ⓢ max. (mV)	Power Dissipation 1.5 x I _N Ⓢ max. (mW)	Melting Integral 10 x I _N Ⓢ min. (A ² s)	Approvals					
							VDE	SEMKO	cULus	METI-PSE	CCC	
800 mA	0800	250V	25A/250 V AC	110	280	3.80	G	•	•	•	•	•
1.00 A	1100	250V	25A/250 V AC	115	400	5.80	G	•	•	•	•	•
1.25 A	1125	250V	25A/250 V AC	100	500	9.75	G	•	•	•	•	•
1.60 A	1160	250V	25A/250 V AC	95	600	13.50	G	•	•	•	•	•
2.00 A	1200	250V	25A/250 V AC	90	700	21.00	G	•	•	•	•	•
2.50 A	1250	250V	25A/250 V AC	85	750	32.00	G	•	•	•	•	•
3.15 A	1315	250V	32A/250 V AC	80	1100	55.00	G	•	•	•	•	•
4.00 A	1400	250V	40A/250 V AC	75	1200	100.00	G	•	•	•	•	•

G = Expert Report



Order Information

Qty.	Order-Number	Series	Amp Code	Packaging
		392		

Specifications are subject to change without notice

TE5® / No. 392

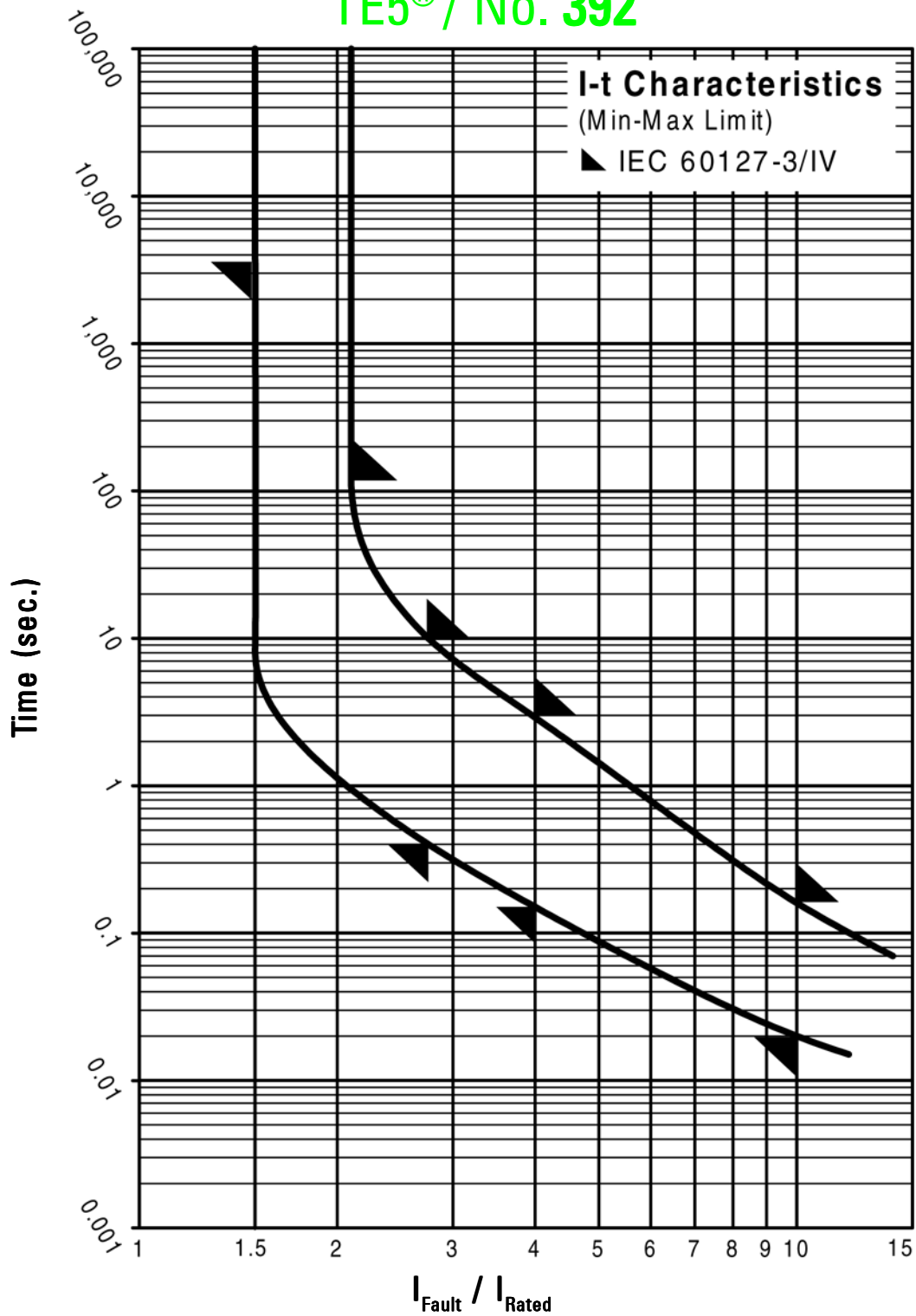

Contact WICKMANN for individual I-t curves