

●シリコンPN型フォト・ダイオード

型名	社名	電気・光学的特性 (T <sub>0</sub> =25°C)										最大定格 (T <sub>0</sub> =25°C)		外形	備考		
		光電流			暗電流		ピーク感度波長	上昇時間			端子間容量		逆電圧 V <sub>R</sub> (V)			動作温度 T <sub>opr</sub> (°C)	
		I <sub>L</sub> min (μA)	E (mW/cm <sup>2</sup> )	E <sub>V</sub> (lx)	I <sub>D</sub> max (nA)	V <sub>R</sub> (V)	λ <sub>p</sub> typ (nm)	t <sub>r</sub> typ (μs)	R <sub>L</sub> (Ω)	V <sub>R</sub> (V)	C <sub>T</sub> typ (pF)	V <sub>R</sub> (V)					
OLD43L	沖	2.3	-	100	1	1.5	825						20	-40~100	PD-1		
SP-SKL	光電子	typ.4	-	1000	-	-	880					17	0	10	-20~100	PD-2	基板埋込実装タイプ
SP-SKLT		typ.10	-	1000	-	-	880					17	0	10	-20~100	PD-3	
SP-1CL3		8	-	1000	0.5	5	900					50	0	20	-20~90	PD-4	3φ
SP-1CL3R2		5	-	1000	1	1	920					50	0	20	-20~90	PD-4	3φ、可視光カットタイプ
SP-101		1	-	1000	0.5	5	880					17	0	20	-25~90	PD-4	3φ
SP-1KL		18	-	1000	0.1	5	900					50	0	20	-25~120	PD-5	TO-18
SP-1ML		8	-	1000	0.1	5	900					50	0	20	-20~90	PD-6	
SP-12FS		10	-	1000	-	-	900					100	0	20	-20~80	PD-7	TO-92
SP-2ML		16	-	1000	-	-	900					190	0	5	-20~80	PD-8	
SP-3ML		54	-	1000	-	-	900					480	0	5	-20~80	PD-9	
SP-45ML		81	-	1000	10	5	900					1050	0	5	-20~90	PD-9	
SP-8K		290	-	1000	-	-	900					3400	0	5	-25~100	PD-10	TO-8
SP-8ML		270	-	1000	-	-	900					3400	0	5	-20~90	PD-11	
HP-1LR1		30	-	1000	0.5	5	940					4	0	20	-25~70	PD-12	5φ、可視光カットタイプ
HP-2FR4		20	-	1000	0.01	10	940					73	0	35	-30~70	PD-13	サイドビュー可視光カットタイプ
HP-2ML		typ.28	-	1000	1	5	900					60	0	5	-20~80	PD-8	
HP-202		typ.65	-	1000	100	10	900					155	0	10	-25~100	PD-15	TO-5
HP-3F		50	-	1000	-	-	900					175	0	10	-30~70	PD-14	
HP-3FR2		50	-	1000	0.03	10	940					175	0	35	-30~70	PD-14	可視光カットタイプ
HP-3ML		54	-	1000	1	5	900					180	0	5	-20~80	PD-9	
HP-3MLR2		typ.60	-	1000	10	5	940					180	0	5	-20~80	PD-9	
HP-5FR2		40	-	1000	0.03	10	940					175	0	35	-30~70	PD-16	可視光カットタイプ
HP-5FR3		20	-	1000	0.03	10	940					175	0	35	-30~70	PD-17	可視光カットタイプ
HP-5FR4	20	-	1000	0.03	10	940					175	0	35	-30~70	PD-16	可視光カットタイプ	
HP-7L	8	-	1000	0.5	5	900					4	0	20	-20~80	PD-18	3.3φ	
BP-2BC	typ.0.11	-	100	0.001	1	560					400	0	10	-20~60	PD-19	セラミックシステム、可視光用	
BP-5BC	typ.0.28	-	100	0.001	1	560					600	0	10	-20~60	PD-20	セラミックシステム、可視光用	
NJL611B	新日本無線	typ.10	2	-	0.001	1	850				30	0	15	-55~100	PD-21	TO-18	

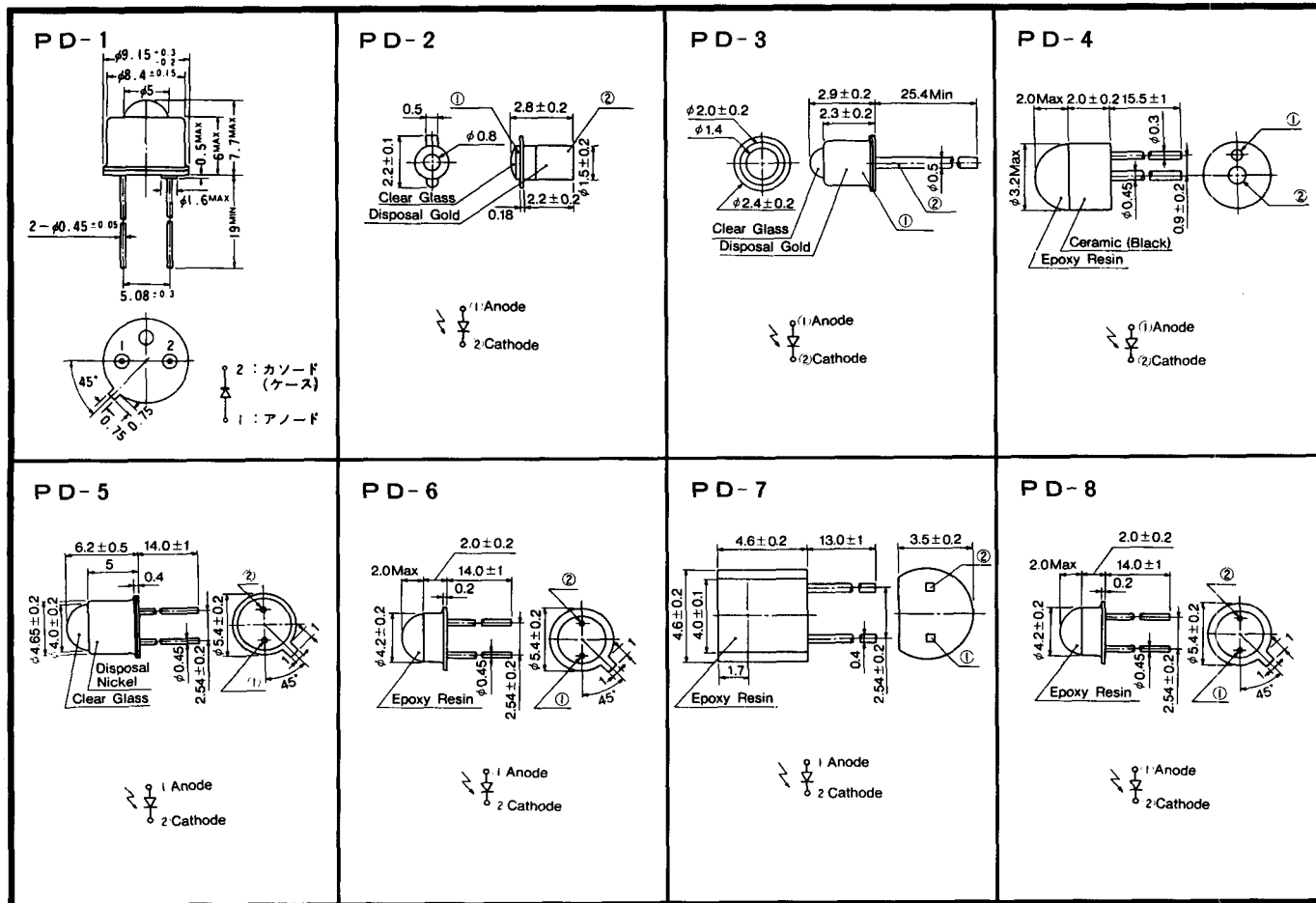

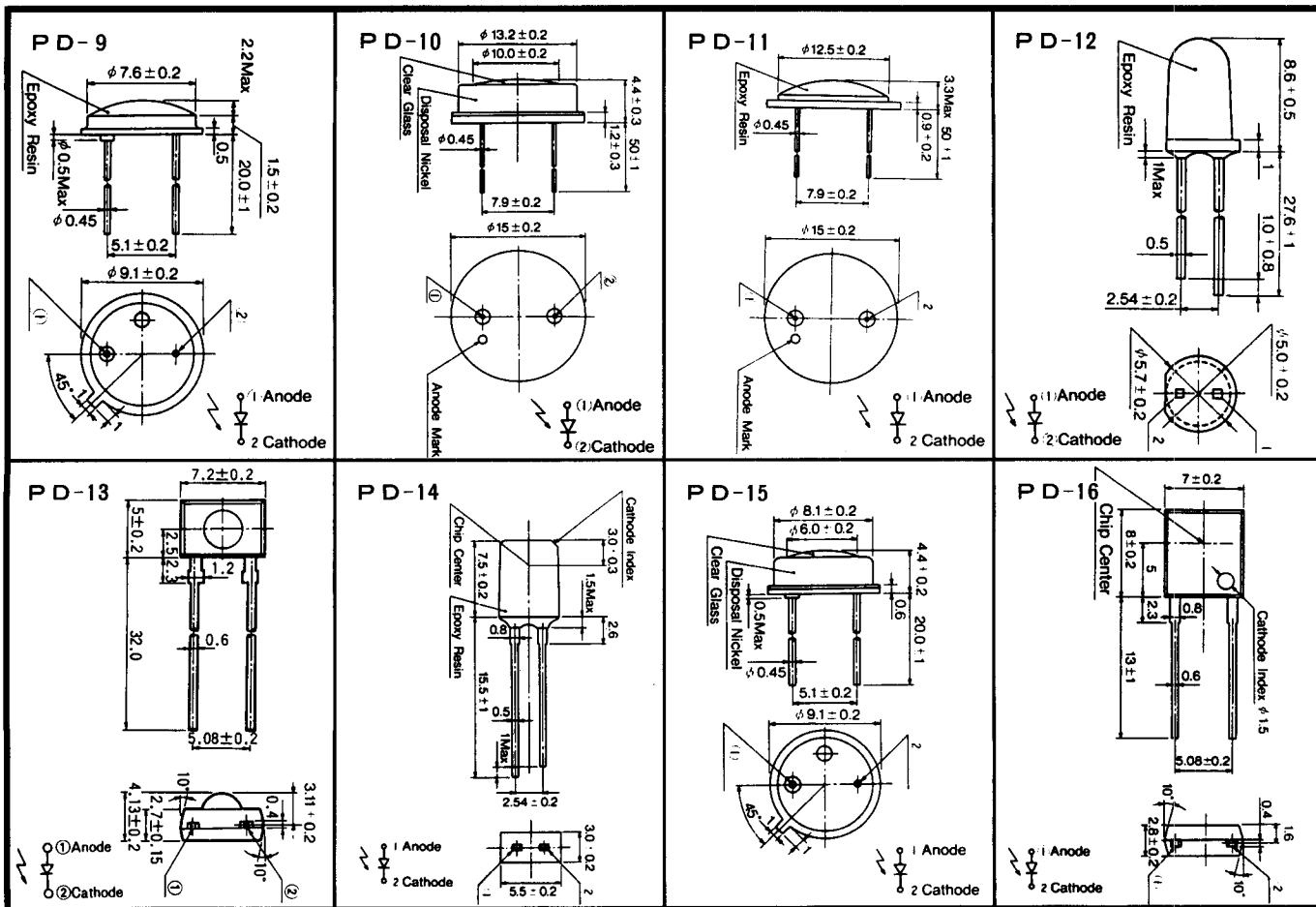



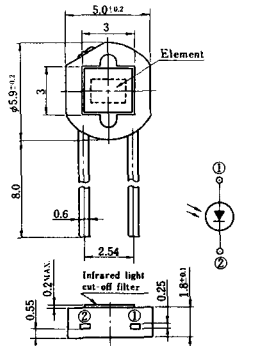
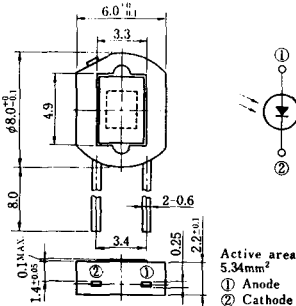

<p>PD-33</p>	<p>PD-34</p>  <p>① Anode ② Cathode</p> <p>Active area : 1.55mm<sup>2</sup></p>	<p>PD-35</p>	<p>PD-36</p>
<p>PD-37</p>	<p>PD-38</p>  <p>① Anode ② Cathode</p> <p>Active area 5.34mm<sup>2</sup></p>	<p>PD-39</p>	<p>PD-40</p>

PD-41

PD-42

PD-43

PD-44

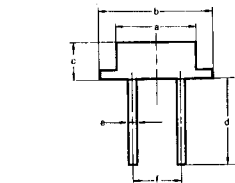

部名	Tol.	φa mm	φb mm	c mm	d mm	φc mm	f mm
PPK-111		4.7	5.25	2.7	15	0.45	2.54
PPK-122		8.1	9.1	2.7	15	0.45	5.8
PPK-123		8.1	9.1	2.7	15	0.45	5.5
PPK-155		14.1	16.0	2.7	15	0.45	9.2
PPK-166		14.1	16.0	2.7	15	0.45	9.2

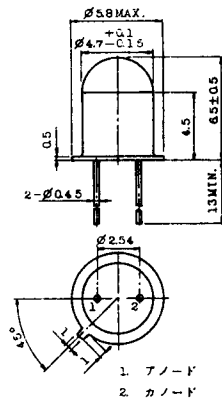
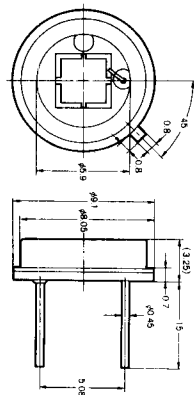

1. アノード
2. カソード

PD-45

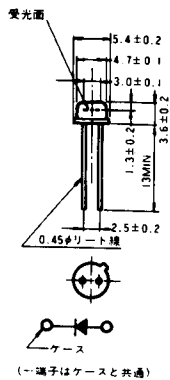

(一端子はケースと共通)

PD-46

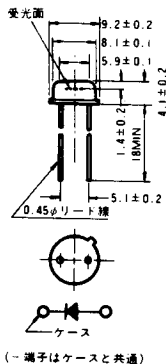

(一端子はケースと共通)

PD-47

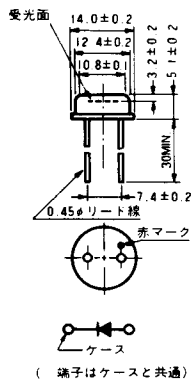

(一端子はケースと共通)

PD-48

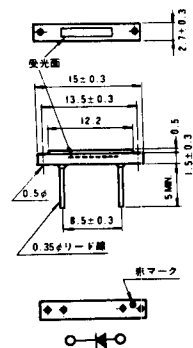

PD-49

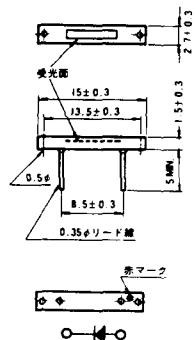

PD-50

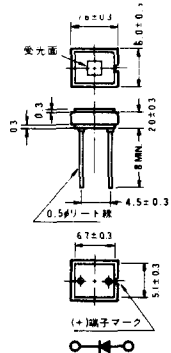

PD-51

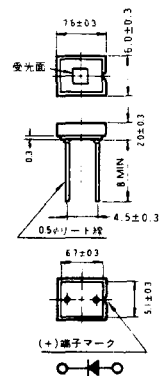

PD-52

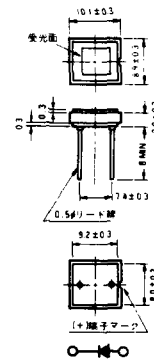

PD-53

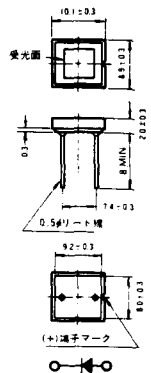

PD-54

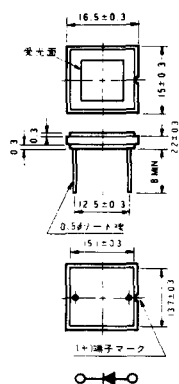

PD-55

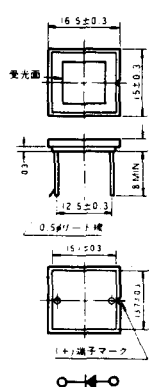

PD-56

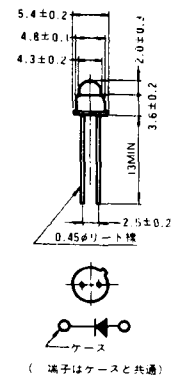



PD-57

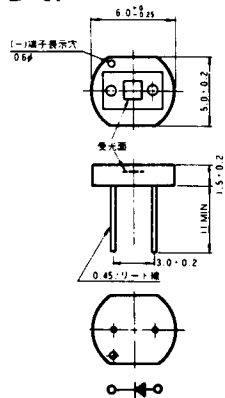

PD-58

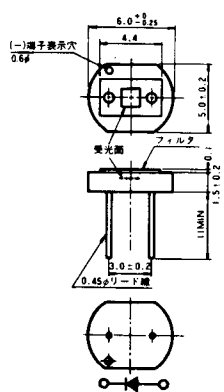

PD-59

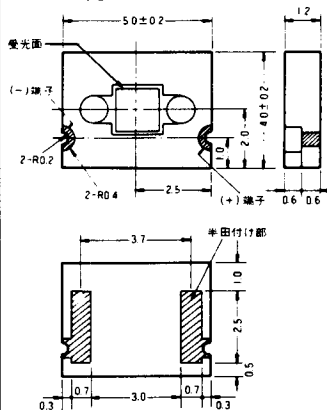

PD-60

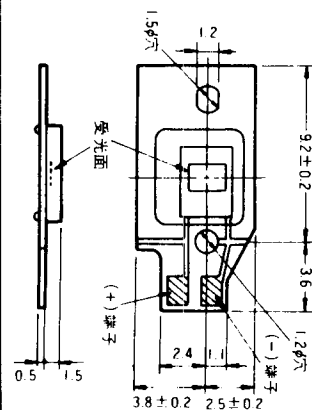

PD-61

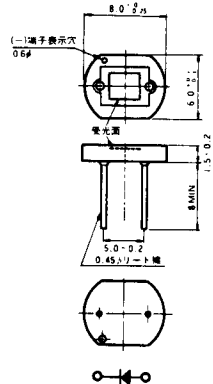

PD-62

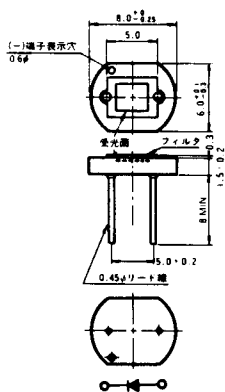

PD-63

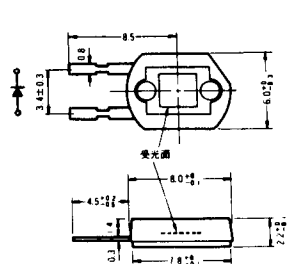

PD-64

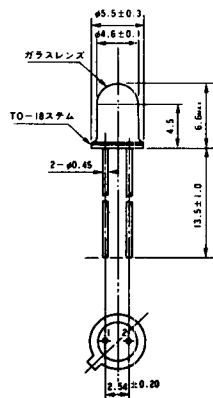









PD-97

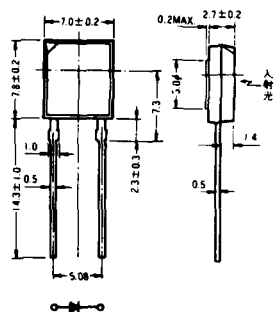

PD-98

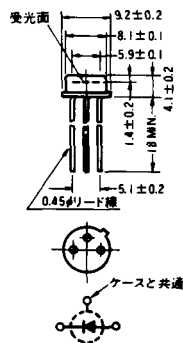

PD-99

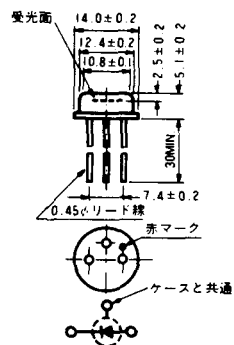

PD-100

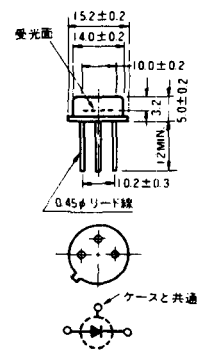

PD-101

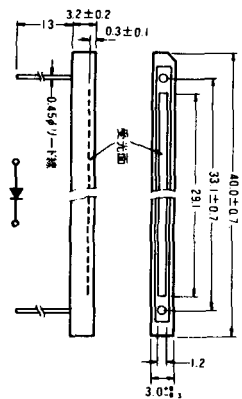

PD-102

PD-103

PD-104

PD-105	PD-106	PD-107	PD-108
<p><b>PD-109</b></p> <p>φ4.6±0.15 Glass lens 6.3±0.3 12.7min. 2-φ0.45±0.05 2.54±0.25 1.0±0.15 45±3° φ5.75max. 1: Anode 2: Cathode</p>	<p><b>PD-110</b></p> <p>φ4.6±0.15 Glass window 4.5±0.2 12.7min. 2-φ0.45±0.05 2.54±0.25 1.0±0.15 45±3° φ5.75max. 1: Anode 2: Cathode</p>	<p><b>PD-111</b></p> <p>φ8.1±0.2 Glass window 5.9±0.2 0.7 φ0.45 12.7min. 3.5max. 5.08 φ9.4max. 0.8 45° 1: Anode 2: Cathode</p>	<p><b>PD-112</b></p> <p>品名、極性カラー表示(黄)</p> <p>1.8 2.2±0.15 0.4±0.1 0.7 1.8 2.8±0.2 1.05±0.1 0.85±0.15 0.15 45° 10min. 10min. 3.2±0.3 3.2±0.3 0.9R 1: Cathode 2: Anode</p>

<p><b>PD-113</b></p> <p>1 : Cathode 2 : Anode</p>	<p><b>PD-114</b></p> <p>1 : Anode 2 : Cathode</p>	<p><b>PD-115</b></p>	<p><b>PD-116</b></p> <p>(1) Anode (2) Cathode</p>
<p><b>PD-117</b></p>	<p><b>PD-118</b></p>	<p><b>PD-119</b></p>	<p><b>PD-120</b></p>



