

P-Channel 1.5-V (G-S) MOSFET

PRODUCT SUMMARY			
V_{DS} (V)	$R_{DS(on)}$ (Ω)	I_D (A) ^a	Q_g (Typ.)
- 20	0.041 at $V_{GS} = - 4.5$ V	- 10.0	22 nC
	0.048 at $V_{GS} = - 2.5$ V	- 9.32	
	0.058 at $V_{GS} = - 1.8$ V	- 8.48	
	0.075 at $V_{GS} = - 1.5$ V	- 7.45	

FEATURES

- TrenchFET[®] Power MOSFET
- Ultra Small MICRO FOOT[®] Chipscale Packaging Reduces Footprint Area, Profile (0.62 mm) and On-Resistance Per Footprint Area

RoHS
COMPLIANT

APPLICATIONS

- Low Threshold Load Switch for Portable Devices
 - Low Power Consumption
 - Increased Battery Life

MICRO FOOT

Bump Side View

Backside View

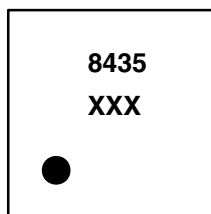
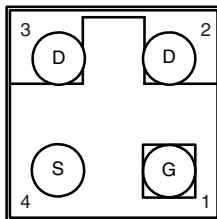
Device Marking: 8435

xxx = Date/Lot Traceability Code

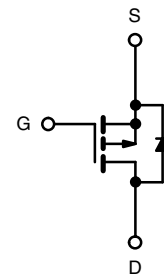
Ordering Information: Si8435DB-T1-E1 (Lead (Pb)-free)

P-Channel MOSFET

ABSOLUTE MAXIMUM RATINGS $T_A = 25$ °C, unless otherwise noted			
Parameter	Symbol	Limit	Unit
Drain-Source Voltage	V_{DS}	- 20	V
Gate-Source Voltage	V_{GS}	± 5	
Continuous Drain Current ($T_J = 150$ °C)	I_D	$T_C = 25$ °C	- 10.0
		$T_C = 70$ °C	- 8.06
		$T_A = 25$ °C	- 6.72 ^{b,c}
		$T_A = 70$ °C	- 5.37 ^{b,c}
Pulsed Drain Current	I_{DM}	- 15	A
Continuous Source-Drain Diode Current	I_S	$T_C = 25$ °C	
		$T_A = 25$ °C	- 2.31 ^{b,c}
Maximum Power Dissipation	P_D	$T_C = 25$ °C	6.25
		$T_C = 70$ °C	4.0
		$T_A = 25$ °C	2.78 ^{b,c}
		$T_A = 70$ °C	1.78 ^{b,c}
Operating Junction and Storage Temperature Range	T_J, T_{stg}	- 55 to 150	°C
Package Reflow Conditions ^d	IR/Convection	260	

Notes:

 a. Based on $T_C = 25$ °C.

b. Surface Mounted on 1" x 1" FR4 board.

 c. $t = 10$ s.

d. Refer to IPC/JEDEC (J-STD-020C), no manual or hand soldering.

e. In this document, any reference to the Case represents the body of the MICRO FOOT device and Foot is the bump.

THERMAL RESISTANCE RATINGS

Parameter	Symbol	Typical	Maximum	Unit
Maximum Junction-to-Ambient ^{a,b}	R_{thJA}	35	45	°C/W
Maximum Junction-to-Foot (Drain)	Steady State R_{thJF}	16	20	

Notes:

a. Surface Mounted on 1" x 1" FR4 board.

b. Maximum under Steady State conditions is 72 °C/W.

SPECIFICATIONS $T_J = 25\text{ °C}$, unless otherwise noted

Parameter	Symbol	Test Conditions	Min.	Typ.	Max.	Unit
Static						
Drain-Source Breakdown Voltage	V_{DS}	$V_{GS} = 0\text{ V}, I_D = -250\text{ }\mu\text{A}$	- 20			V
V_{DS} Temperature Coefficient	$\Delta V_{DS}/T_J$	$I_D = -250\text{ }\mu\text{A}$		- 15.5		mV/°C
$V_{GS(th)}$ Temperature Coefficient	$\Delta V_{GS(th)}/T_J$			2.5		
Gate-Source Threshold Voltage	$V_{GS(th)}$	$V_{DS} = V_{GS}, I_D = -250\text{ }\mu\text{A}$	- 0.35		- 1.0	V
Gate-Source Leakage	I_{GSS}	$V_{DS} = 0\text{ V}, V_{GS} = \pm 5\text{ V}$			± 100	nA
Zero Gate Voltage Drain Current	I_{DSS}	$V_{DS} = -20\text{ V}, V_{GS} = 0\text{ V}$			- 1	μA
		$V_{DS} = -20\text{ V}, V_{GS} = 0\text{ V}, T_J = 70\text{ °C}$			- 10	
On-State Drain Current ^a	$I_{D(on)}$	$V_{DS} \leq -5\text{ V}, V_{GS} = -4.5\text{ V}$	- 15			A
Drain-Source On-State Resistance ^a	$R_{DS(on)}$	$V_{GS} = -4.5\text{ V}, I_D = -1\text{ A}$		0.034	0.041	Ω
		$V_{GS} = -2.5\text{ V}, I_D = -1\text{ A}$		0.040	0.048	
		$V_{GS} = -1.8\text{ V}, I_D = -1\text{ A}$		0.048	0.058	
		$V_{GS} = -1.5\text{ V}, I_D = -1\text{ A}$		0.055	0.075	
Forward Transconductance ^a	g_{fs}	$V_{DS} = -10\text{ V}, I_D = -1\text{ A}$		10.5	16	S
Dynamic^b						
Input Capacitance	C_{iss}	$V_{DS} = -10\text{ V}, V_{GS} = 0\text{ V}, f = 1\text{ MHz}$		1600		pF
Output Capacitance	C_{oss}			265		
Reverse Transfer Capacitance	C_{rss}			175		
Total Gate Charge	Q_g	$V_{DS} = -10\text{ V}, V_{GS} = -5\text{ V}, I_D = -1\text{ A}$		23	35	nC
				22	33	
Gate-Source Charge	Q_{gs}	$V_{DS} = -16\text{ V}, V_{GS} = -4.5\text{ V}, I_D = -1\text{ A}$		3.25		
Gate-Drain Charge	Q_{gd}			1.95		
Gate Resistance	R_g	$V_{GS} = -0.1\text{ V}, f = 1\text{ MHz}$		20		Ω
Turn-On Delay Time	$t_{d(on)}$	$V_{DD} = -10\text{ V}, R_L = 10\text{ }\Omega$ $I_D \equiv -1\text{ A}, V_{GEN} = -4.5\text{ V}, R_g = 1\text{ }\Omega$		15	23	ns
Rise Time	t_r			29	44	
Turn-Off Delay Time	$t_{d(off)}$			230	345	
Fall Time	t_f			91	137	

SPECIFICATIONS $T_J = 25\text{ }^\circ\text{C}$, unless otherwise noted						
Parameter	Symbol	Test Conditions	Min.	Typ.	Max.	Unit
Drain-Source Body Diode Characteristics						
Continuous Source-Drain Diode Current	I_S	$T_C = 25\text{ }^\circ\text{C}$			- 5.21	A
Pulse Diode Forward Current	I_{SM}				- 15	
Body Diode Voltage	V_{SD}	$I_S = -1\text{ A}, V_{GS} = 0\text{ V}$		0.6	1.2	V
Body Diode Reverse Recovery Time	t_{rr}	$I_F = -1\text{ A}, dI/dt = 100\text{ A}/\mu\text{s}, T_J = 25\text{ }^\circ\text{C}$		116	174	ns
Body Diode Reverse Recovery Charge	Q_{rr}			203	305	nC
Reverse Recovery Fall Time	t_a			45		ns
Reverse Recovery Rise Time	t_b			71		

Notes:

- Pulse test; pulse width $\leq 300\text{ }\mu\text{s}$, duty cycle $\leq 2\%$.
- Guaranteed by design, not subject to production testing.

Stresses beyond those listed under "Absolute Maximum Ratings" may cause permanent damage to the device. These are stress ratings only, and functional operation of the device at these or any other conditions beyond those indicated in the operational sections of the specifications is not implied. Exposure to absolute maximum rating conditions for extended periods may affect device reliability.

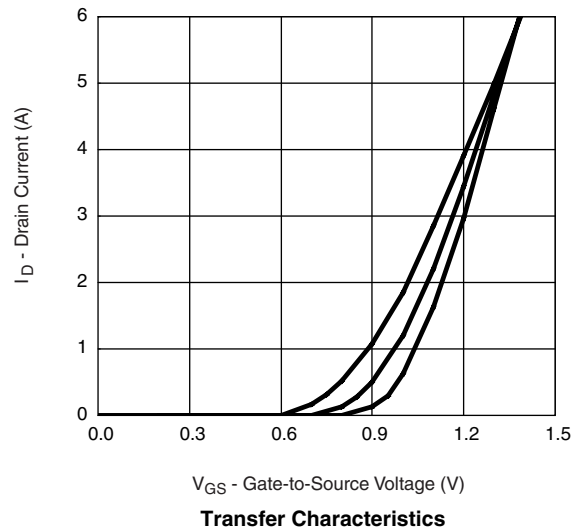
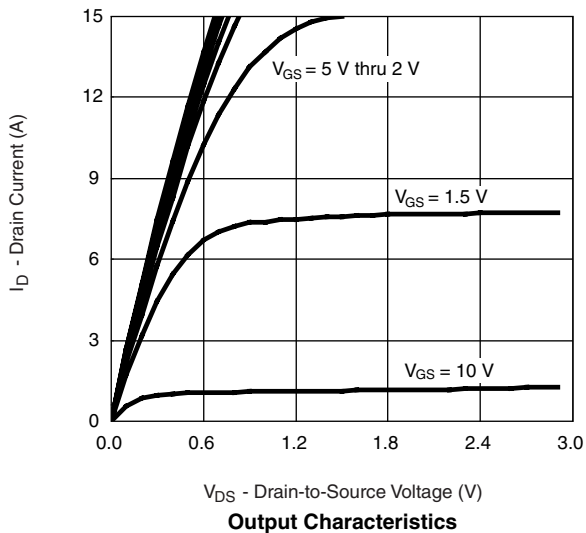
TYPICAL CHARACTERISTICS $T_A = 25\text{ }^\circ\text{C}$, unless otherwise noted

TYPICAL CHARACTERISTICS $T_A = 25\text{ }^\circ\text{C}$, unless otherwise noted

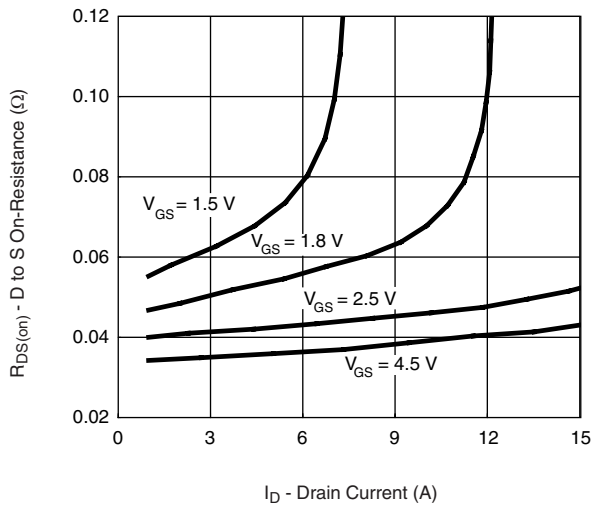

$R_{DS(on)}$ vs. Drain Current

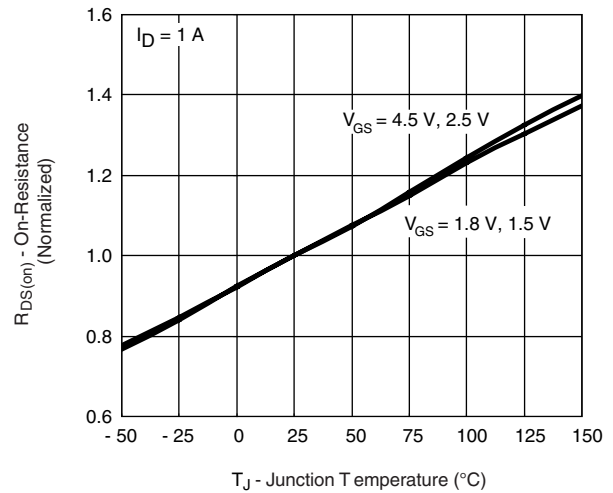

On-Resistance vs. Junction Temperature

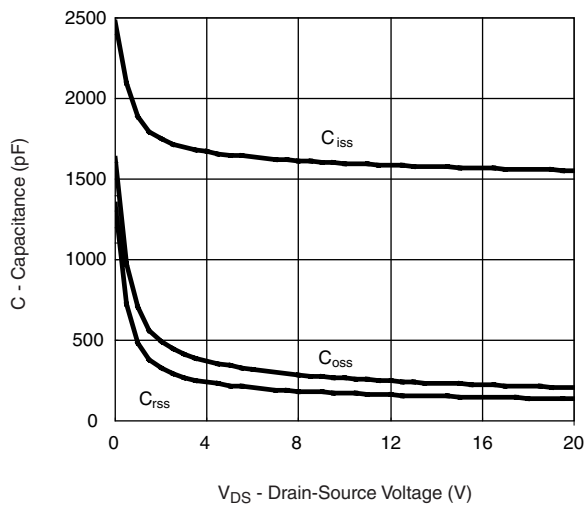

Capacitance

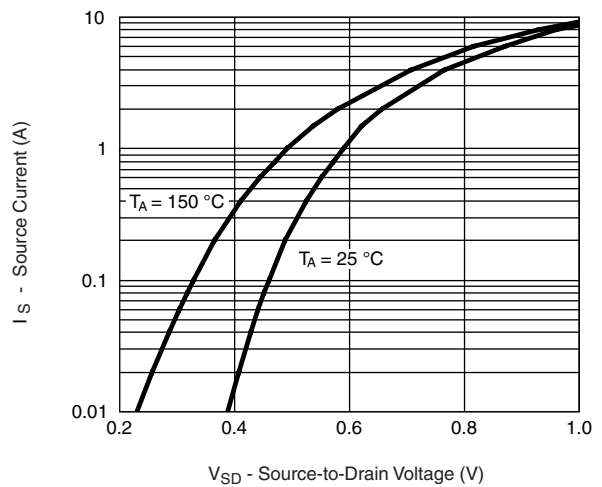

Forward Diode Voltage vs. Temp.

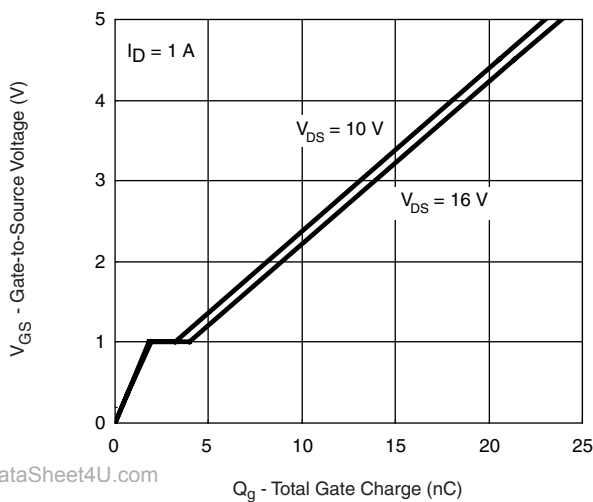

Gate Charge

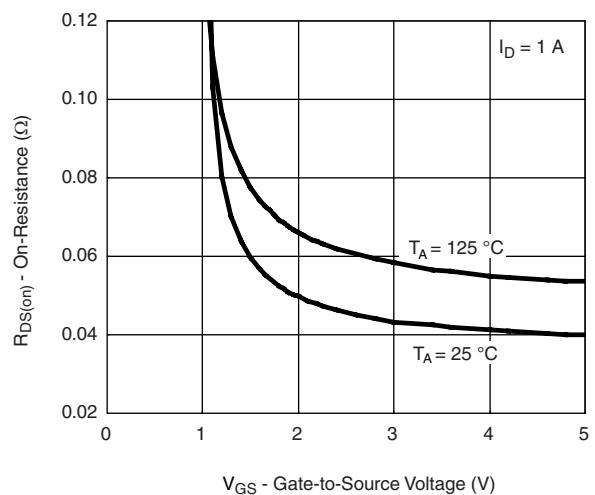

$R_{DS(on)}$ vs. V_{GS} vs Temperature

TYPICAL CHARACTERISTICS $T_A = 25\text{ }^\circ\text{C}$, unless otherwise noted

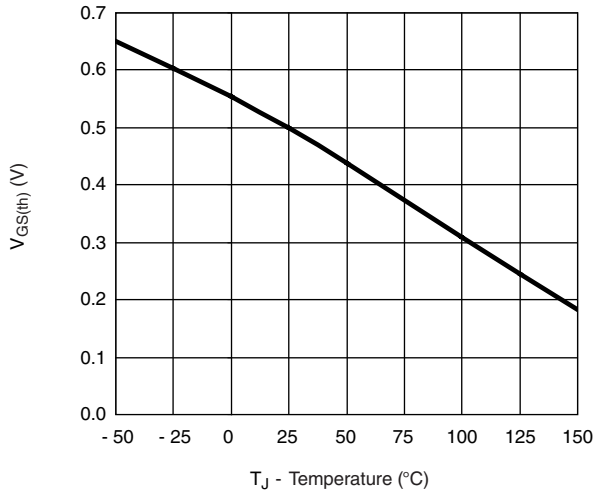

Threshold Voltage

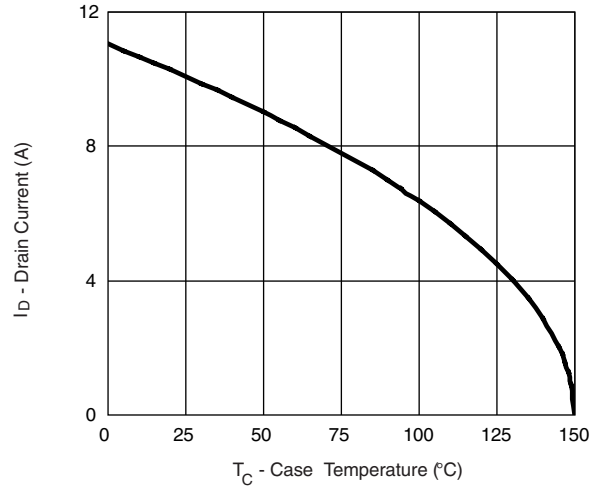

Current Derating**

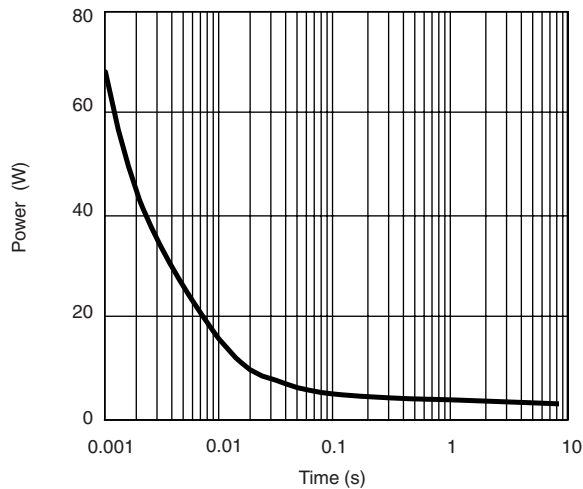

Single Pulse Power, Junction-to-Ambient

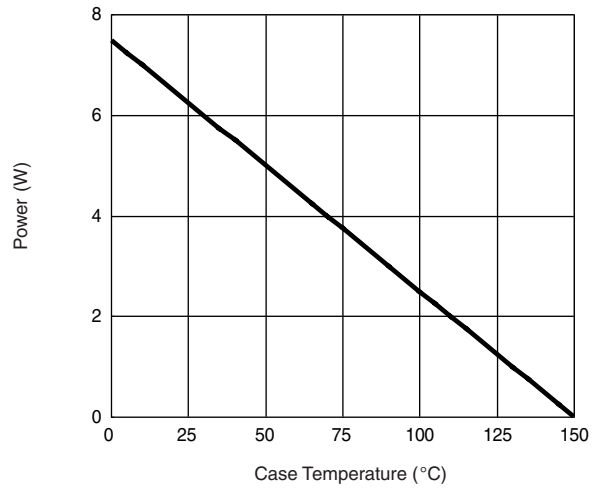

Power Derating

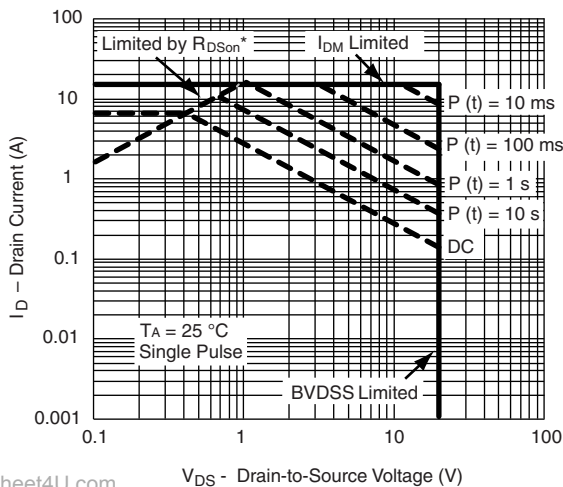

* $V_{GS} >$ minimum V_{GS} at which $R_{DS(on)}$ is specified

Safe Operating Area, Junction-to-Ambient

** The power dissipation P_D is based on $T_{J(max)} = 150\text{ }^\circ\text{C}$, using junction-to-foot thermal resistance, and is more useful in settling the upper dissipation limit for cases where additional heatsinking is used. It is used to determine the current rating, when this rating falls below the package limit.

TYPICAL CHARACTERISTICS $T_A = 25\text{ }^\circ\text{C}$, unless otherwise noted

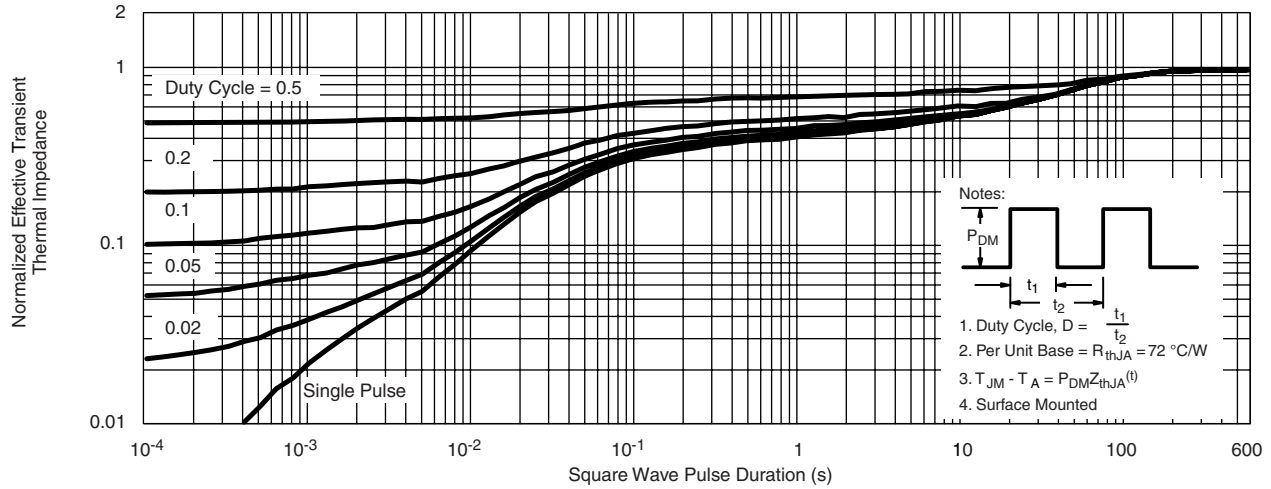

Normalized Thermal Transient Impedance, Junction-to-Ambient

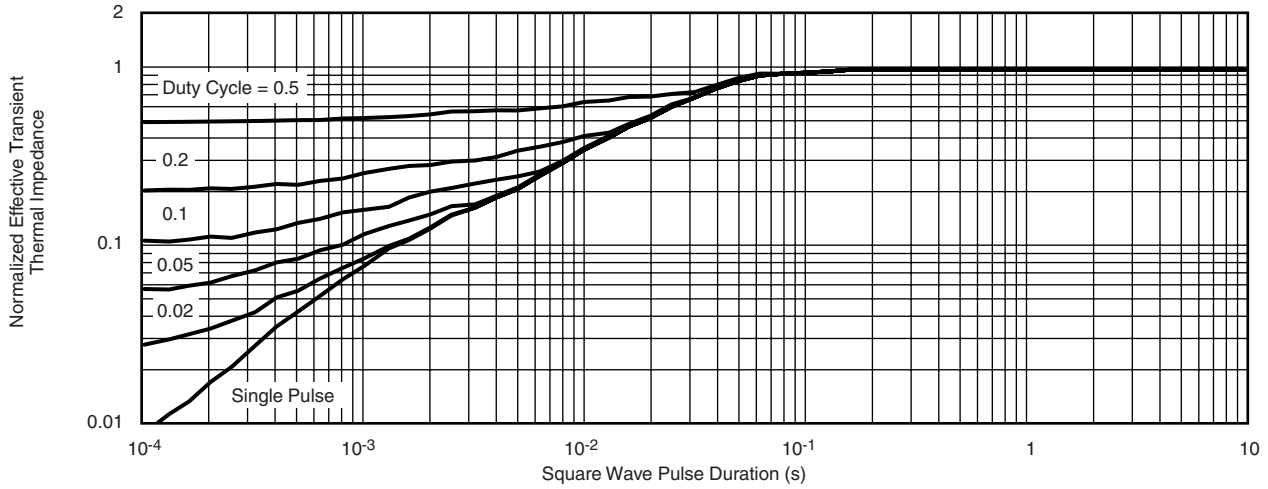

Normalized Thermal Transient Impedance, Junction-to-Foot

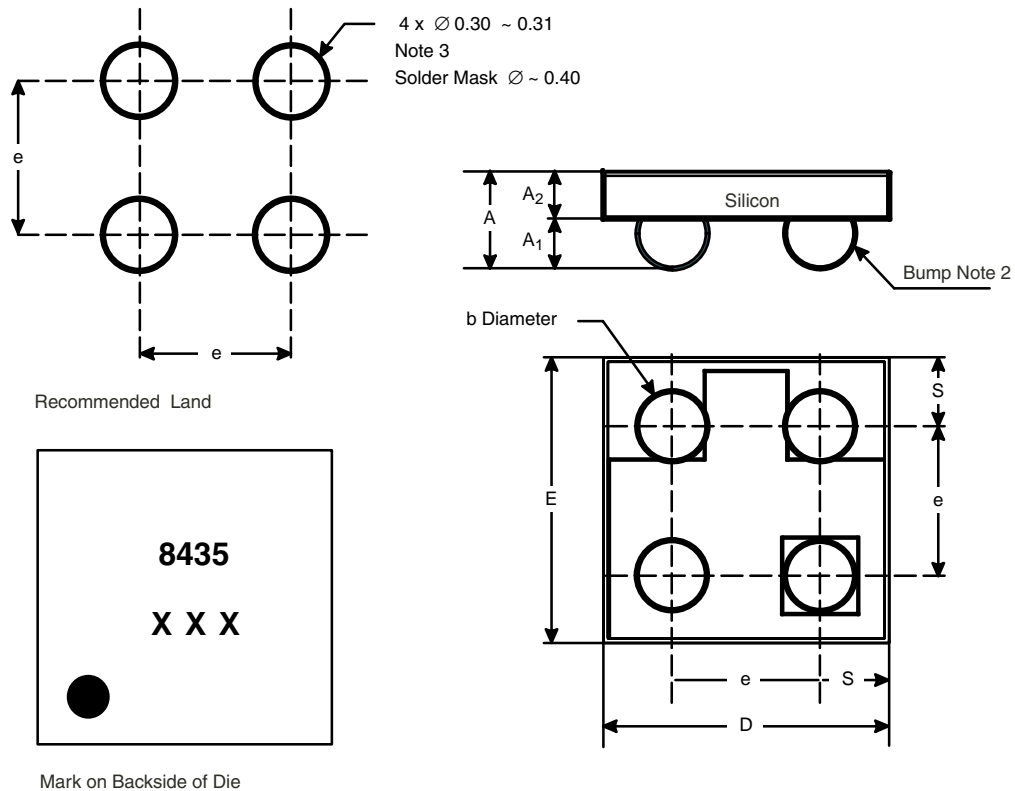
PACKAGE OUTLINE
MICRO FOOT: 4-BUMP (2 x 2, 0.8 mm PITCH)

Notes (Unless Otherwise Specified):

1. Laser mark on the silicon die back, coated with a thin metal.
2. Bumps are Sn/Ag/Cu.
3. Non-solder mask defined copper landing pad.
4. The flat side of wafers is oriented at the bottom.

Dim.	Millimeters ^a		Inches	
	Min.	Max.	Min.	Max.
A	0.600	0.650	0.0236	0.0256
A ₁	0.260	0.290	0.0102	0.0114
A ₂	0.340	0.360	0.0134	0.0142
b	0.370	0.410	0.0146	0.0161
D	1.520	1.600	0.0598	0.0630
E	1.520	1.600	0.0598	0.0630
e	0.750	0.850	0.0295	0.0335
S	0.370	0.380	0.0146	0.0150

Notes:

- a. Use millimeters as the primary measurement.



Disclaimer

All product specifications and data are subject to change without notice.

Vishay Intertechnology, Inc., its affiliates, agents, and employees, and all persons acting on its or their behalf (collectively, "Vishay"), disclaim any and all liability for any errors, inaccuracies or incompleteness contained herein or in any other disclosure relating to any product.

Vishay disclaims any and all liability arising out of the use or application of any product described herein or of any information provided herein to the maximum extent permitted by law. The product specifications do not expand or otherwise modify Vishay's terms and conditions of purchase, including but not limited to the warranty expressed therein, which apply to these products.

No license, express or implied, by estoppel or otherwise, to any intellectual property rights is granted by this document or by any conduct of Vishay.

The products shown herein are not designed for use in medical, life-saving, or life-sustaining applications unless otherwise expressly indicated. Customers using or selling Vishay products not expressly indicated for use in such applications do so entirely at their own risk and agree to fully indemnify Vishay for any damages arising or resulting from such use or sale. Please contact authorized Vishay personnel to obtain written terms and conditions regarding products designed for such applications.

Product names and markings noted herein may be trademarks of their respective owners.