



# TAI-SAW TECHNOLOGY CO., LTD.

No. 3, Industrial 2nd Rd., Ping-Chen Industrial District,  
Taoyuan, 324, Taiwan, R.O.C.

TEL: 886-3-4690038 FAX: 886-3-4697532

E-mail: [tstsales@mail.taisaw.com](mailto:tstsales@mail.taisaw.com) Web: [www.taisaw.com](http://www.taisaw.com)

## Approval Sheet For Product Specification

Issued Date:

Product Name: SAW Filter 1086 MHz SMD3.0X3.0 mm

TST Parts No.:TA0404A

Customer Parts No.:\_\_\_\_\_

|                    |
|--------------------|
| Company:_____      |
| Division:_____     |
| Approved by :_____ |
| Date:_____         |

Checked by:\_\_\_\_\_ Elvis Chiu

Approval by:\_\_\_\_\_ Francis Chen

Date:\_\_\_\_\_ 2004/12/29



# TAI-SAW TECHNOLOGY CO., LTD.

No. 3, Industrial 2nd Rd., Ping-Chen Industrial District,  
Taoyuan, 324, Taiwan, R.O.C.

TEL: 886-3-4690038 FAX: 886-3-4697532

E-mail: [tstsales@mail.taisaw.com](mailto:tstsales@mail.taisaw.com) Web: [www.taisaw.com](http://www.taisaw.com)

## SAW Filter 1086 MHz

MODEL NO.: TA0404A

REV. NO.:1

### A. MAXIMUM RATING:

1. Operating Temperature: -40°C ~ +85°C
2. Storage Temperature: -40°C ~ +85°C

RoHS Compliant  
Lead free  
Lead-free soldering

### B. CHARACTERISTICS :

Balanced to Balanced operation

Terminating source impedance :  $Z_s = 200 \Omega$

Terminating load impedance :  $Z_L = 200 \Omega$

| Characteristics                          |         |     |    | Value |      |      | Note |
|--|---------|-----|----|-------|------|------|------|
|  |         |     |    | Min.  | Typ. | Max. |      |
| Center frequency                         | $F_c$   | MHz | -  | 1086  | -    | -    |      |
| Insertion loss( 1081~1091 MHz)           | I.L.min | dB  | -  | 2.6   | 4.5  | -    |      |
| Ripple ( 1081~1091MHz)(over 6MHz)        |         | dB  | -  | 0.6   | 1.5  | -    |      |
| Attenuation:( Reference level from 0dB ) |         |     |    |       |      |      |      |
| 500~988                                  | MHz     | dB  | 43 | 50    | -    | -    |      |
| 988~1002                                 | MHz     | dB  | 43 | 50    | -    | -    |      |
| 1038~1046                                | MHz     | dB  | 40 | 45    | -    | -    |      |
| 1156~1600                                | MHz     | dB  | 40 | 50    | -    | -    |      |
| Group delay ripple(p-p) ( 1081~1091MHz)  |         | ns  | -  | 10    | -    |      |      |

### C. Frequency Characteristics :

Sdd21 Response

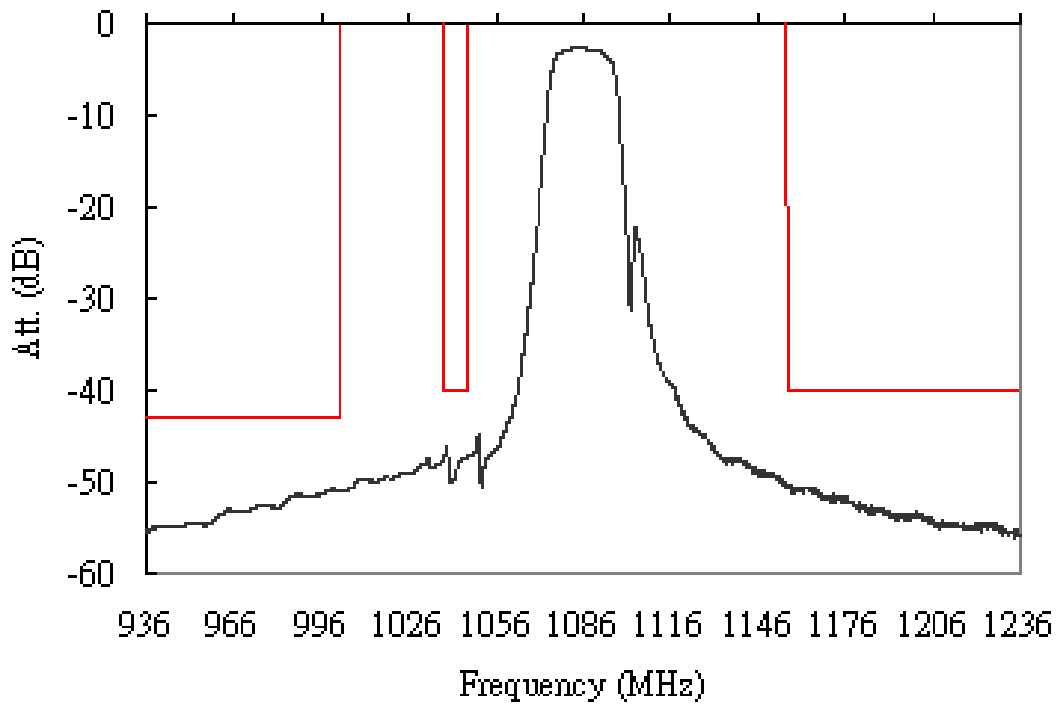
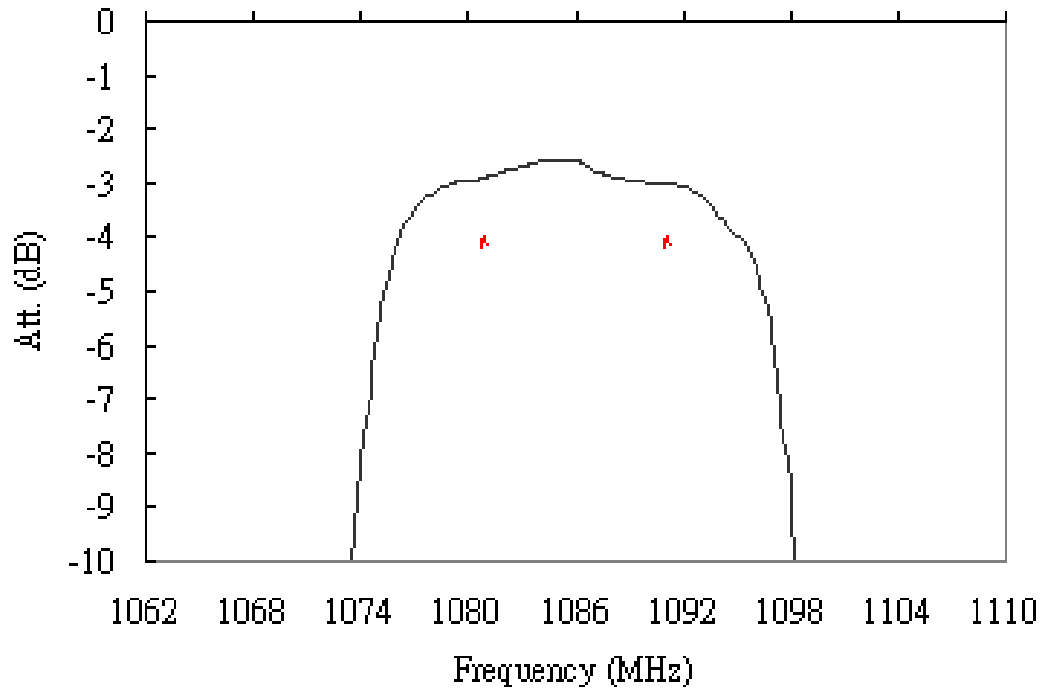

## Wideband

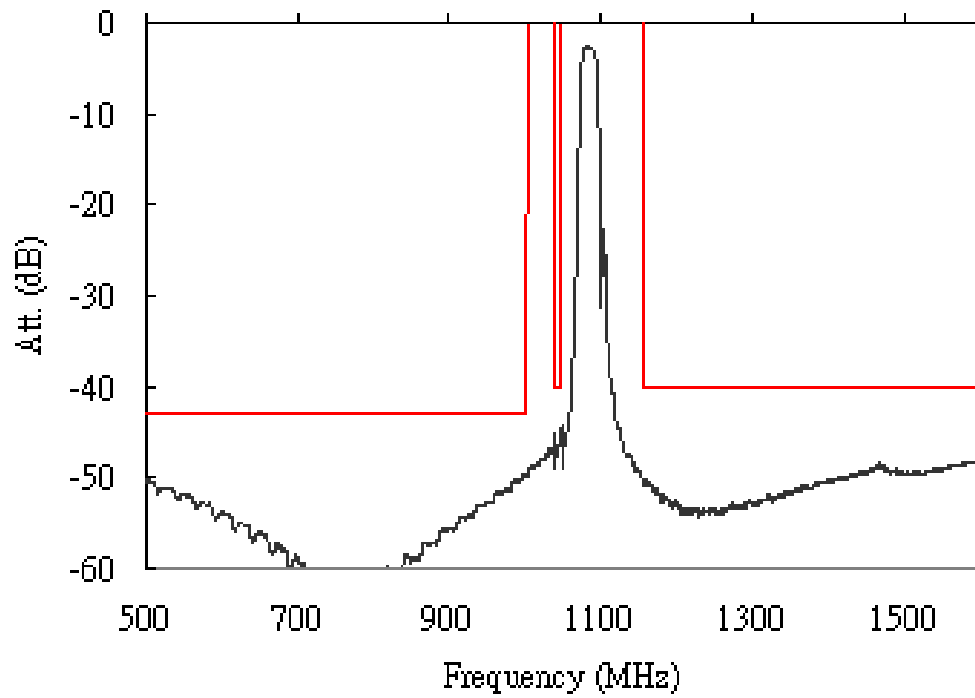

## D. Measurement Circuit:

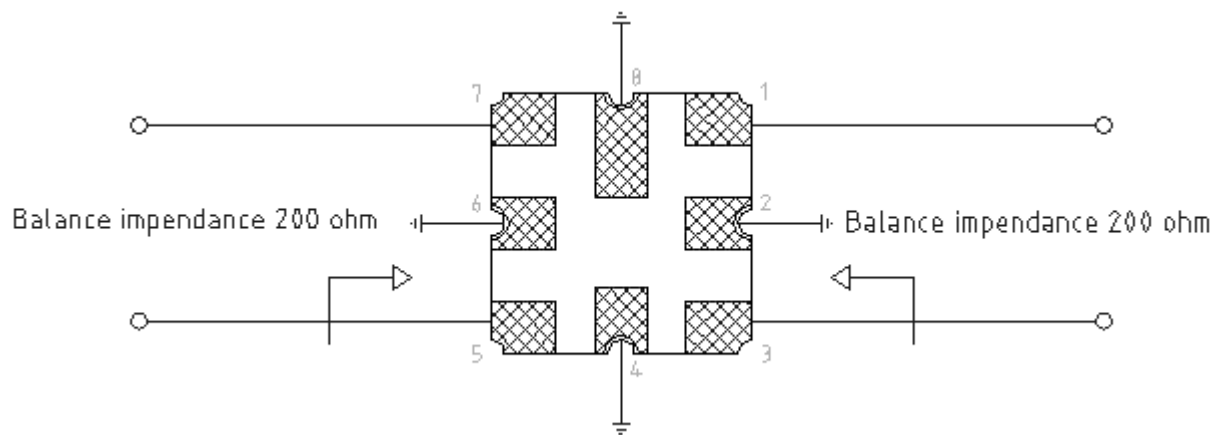

**E. Outline Drawing:**

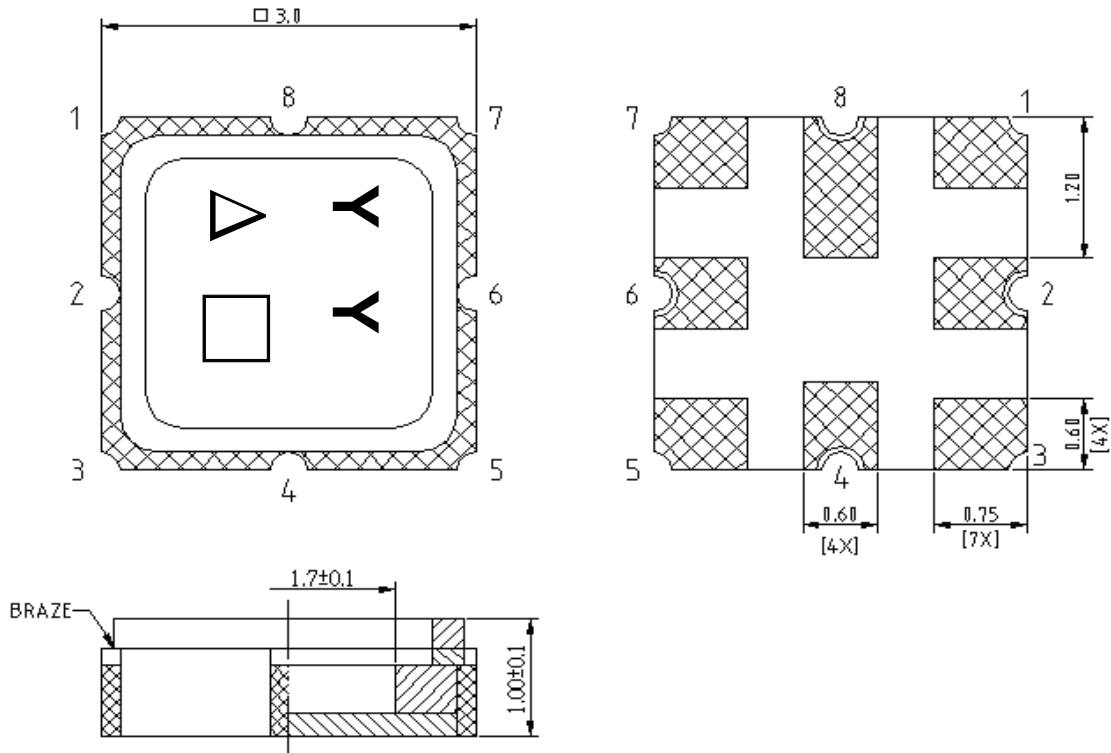

**Pin configuration**

- 1,3: Balanced Input
- 5,7: Balanced Output
- 2,4,6,8: ground
- Δ: Year code
- : Date code

**F. PCB FOOTPRINT:**

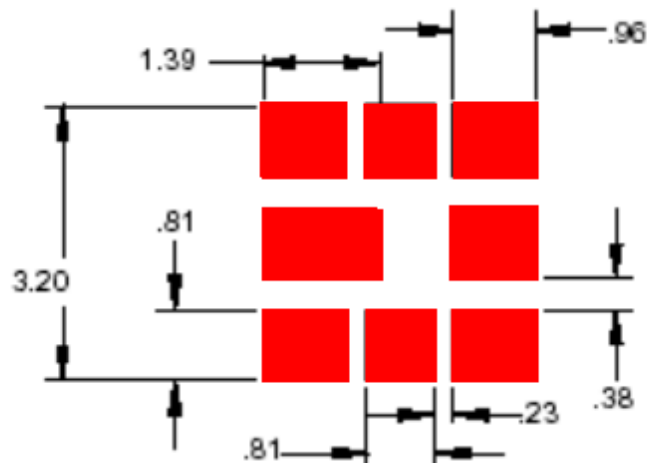

**G. PACKING:**

**1. REEL DIMENSION**

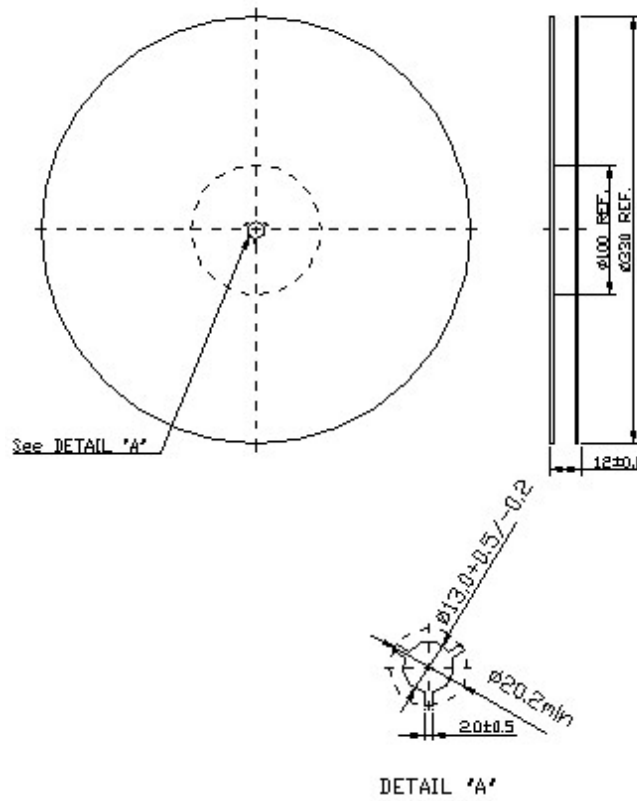

**2. TAPE DIMENSION**

