



SwE81800(8V180AH)



Specifications

| | | |
|-------------------------------|--------------|-----------------------|
| Nominal Voltage | | 8V |
| Rated capacity (10 hour rate) | | 180 Ah |
| Dimensions | Total Height | 300 mm (11.81 inches) |
| | Height | 295 mm (11.61 inches) |
| | Length | 260 mm (10.23 inches) |
| | Width | 182mm (7.17 inches) |
| Weight Approx | | 36.5Kg (64.09lbs) |

Characteristics

| | | |
|--|---|---|
| Capacity 25°C(77°F) | 10 hour rate(18.0A) 5 hour rate(28.8A) 1 hour rate(108A) | 180 AH 144 AH 108 AH |
| Internal Resistance | Full charged Battery at 25°C(77°F) | Approx 2.2 mΩ |
| Capacity affected by Temperature (10hour rate) | 40°C(104°F) 25°C(77°F) 0°C(32°F) -15°C(5°F) | 102% 100% 85% 65% |
| Self-Discharge at 25°C(77°F) | Capacity after 3 month storage Capacity after 6 month storage Capacity after 12 month storage | 91% 82% 64% |
| Terminal | T19 | |
| Charge (constant Voltage) | Cycle | Initial Charging Current less than 72 A Voltage 9.40-9.60V |
| | Float | Voltage 9.00-9.20V |

Outer dimensions (mm)

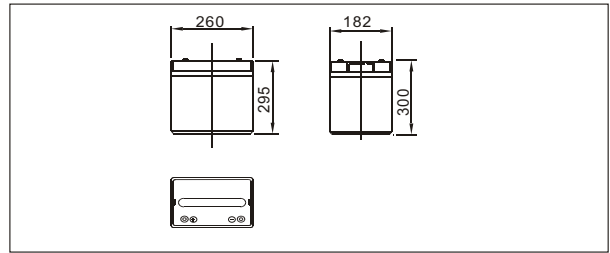

Terminal Type (mm)

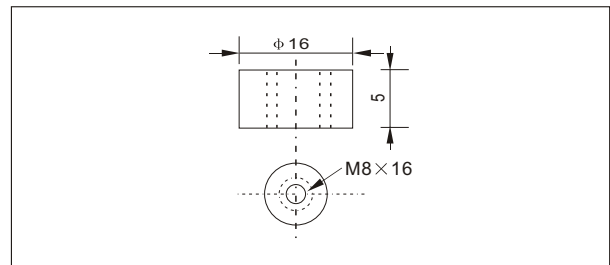

Curves of cycle life(25°C)

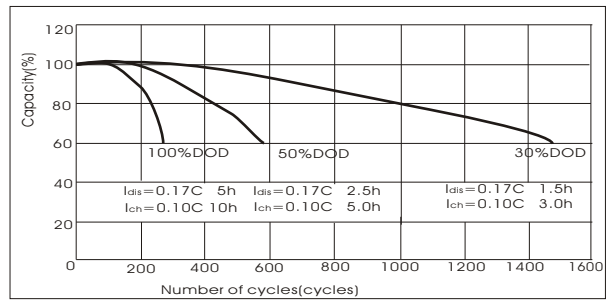

Discharge Curves 25°C(77°F)

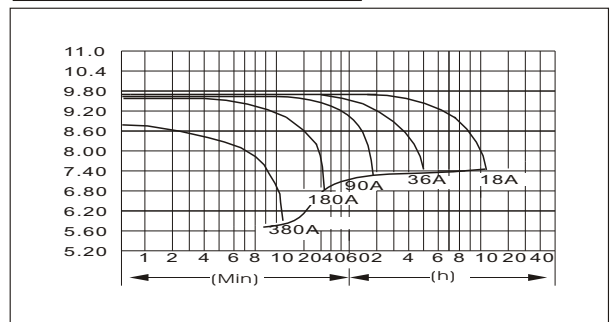

Constant Current(Amp) and Constant Power(Watt) Discharge Table at 25°C(77°F)

| Time | | 5min | 10min | 15min | 30min | 1h | 2h | 3h | 4h | 5h | 8h | 10h | 20h |
|-------|---|------|-------|-------|-------|-----|-----|-----|-----|-----|------|------|------|
| 6.40V | A | 577 | 380 | 306 | 205 | 108 | 63 | 46 | 36 | 30 | 21.1 | 18.9 | 10.2 |
| | W | 3967 | 2704 | 2189 | 1471 | 778 | 461 | 343 | 270 | 225 | 161 | 146 | 79 |
| 6.80V | A | 558 | 343 | 288 | 196 | 102 | 60 | 45 | 35 | 29 | 20.5 | 18.5 | 9.9 |
| | W | 3976 | 2551 | 2151 | 1468 | 765 | 462 | 347 | 272 | 227 | 160 | 145 | 77 |
| 7.00V | A | 540 | 307 | 252 | 184 | 98 | 59 | 44 | 35 | 29 | 20.3 | 18.2 | 9.9 |
| | W | 3933 | 2325 | 1919 | 1409 | 759 | 454 | 341 | 270 | 225 | 159 | 143 | 78 |
| 7.20V | A | 521 | 289 | 234 | 169 | 95 | 57 | 43 | 34 | 28 | 19.8 | 18.0 | 9.7 |
| | W | 3894 | 2221 | 1800 | 1307 | 738 | 447 | 337 | 268 | 221 | 156 | 143 | 77 |
| 7.40V | A | 503 | 271 | 216 | 151 | 92 | 56 | 41 | 33 | 27 | 19.3 | 17.1 | 9.2 |
| | W | 3803 | 2090 | 1679 | 1179 | 720 | 440 | 328 | 263 | 218 | 154 | 138 | 74 |