

PLEASE CHECK WWW.MOLEX.COM FOR LATEST PART INFORMATION

Part Number: [0475976101](#)
Status: **Active**
Description: LGA 1156 Shoulder Screw for 1U Server, 3.80mm (.150") Thread, Lead-free

Documents:

[Drawing \(PDF\)](#) [RoHS Certificate of Compliance \(PDF\)](#)
[Product Specification PS-47596-001 \(PDF\)](#)

General

Product Family	Processor Sockets
Series	47596
Component Type	Screw
Product Name	LGA1156

Physical

Circuits (Loaded)	N/A
Durability (mating cycles max)	20
Packaging Type	Bag
Pitch - Mating Interface (in)	0.000 In
Pitch - Mating Interface (mm)	0.00 mm
Temperature Range - Operating	-25°C to +100°C
Termination Interface: Style	Screw or Lug

Electrical

Current - Maximum per Contact	N/A
Voltage - Maximum	N/A

Material Info

Reference - Drawing Numbers

Product Specification	PS-47596-001
Sales Drawing	SD-47597-009

Intel and Nehalem and relevant names are either trademarks or registered trademarks of Intel Corporation

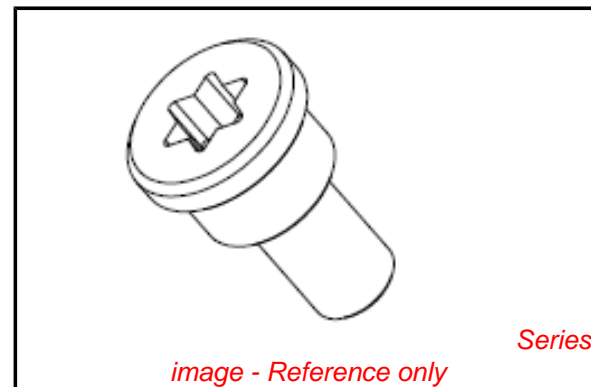

EU RoHS

**ELV and RoHS
Compliant**
**REACH SVHC
Contains SVHC: No
Halogen-Free
Status**

China RoHS



**Need more information on product
environmental compliance?**

Email productcompliance@molex.com
 For a multiple part number RoHS Certificate of Compliance, [click here](#)

Please visit the [Contact Us](#) section for any non-product compliance questions.

Search Parts in this Series
47596Series

Mates With
Intel* Nehalem Processor

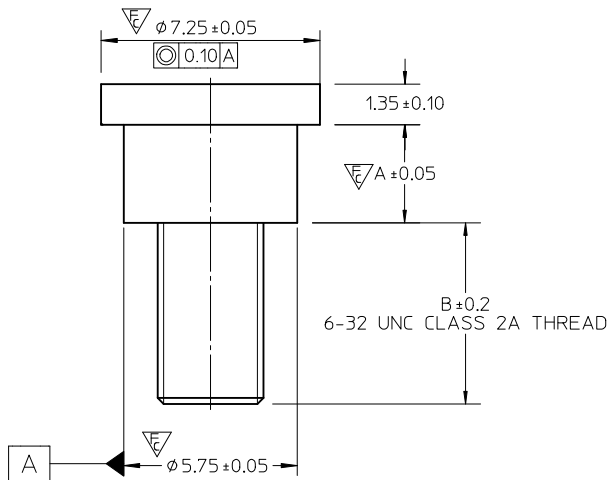
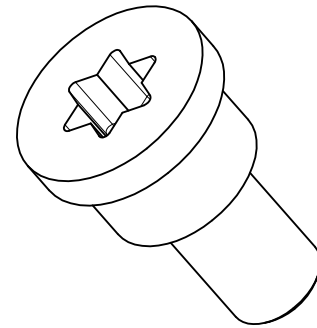
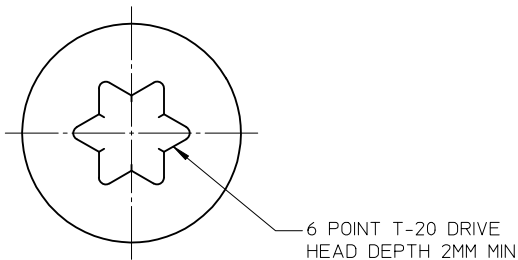

NOTES:

- MATERIAL: LOW CARBON STEEL.
MIN HARDNESS-ROCKWELL HARDNESS B70.
- PLATING: 2 MICRON MINIMUM ELECTROLYTIC NICKEL.
PROCESS TEST: 48 HOURS AT 85°C/85% HUMIDITY WITH NO VISIBLE CORROSION.
- REMOVE ALL BURRS OR SHARP EDGES AROUND PERIMETER OF PART.
SHARPNESS OF EDGES SUBJECT TO HANDLING ARE REQUIRED TO MEET UL1439 TEST.
- BREAK ALL SHARP CORNERS, EDGES, AND BURRS TO 0.10MM MAX.
- PART SHALL BE DEGREASED AND FREE OF OIL AND DIRT MARKS.
- THE PART IS COMPLAINT TO RoHS DIRECTIVE 2002/95/EC AND ELV DIRECTIVE 2000/53/EC.

47597-6201	3.35	6.0
47597-6101	3.25	3.8
47597-6001	3.25	6.0
MATERIAL NUMBER	DIM A	DIM B

ENTER DESCRIPTION EC NO: SH2010-0330 DRWN: ZHANG11 2010/01/06 CHKD: 2010/02/08 APPR: WFDENG 2010/02/24	QUALITY SYMBOLS $\sqrt{A}=0$ $\sqrt{B}=3$ $\sqrt{C}=0$	GENERAL TOLERANCES (UNLESS SPECIFIED)		DIMENSION STYLE	SCALE	DESIGN UNITS	THIRD ANGLE PROJECTION		
				MM ONLY	6:1	METRIC			
				DRAWN BY	DATE	TITLE			
				CHECKED BY	DATE	SOCKET H1 ILM SHOULDER SCREW			
		APPROVED BY		DATE	MOLEX MOLEX INCORPORATED			SHEET NO.	
		WFDENG		2010/02/08	DOCUMENT NO.				
		MATERIAL NO.		SEE TABLE			SD-47597-009	1 OF 1	
DRAFT WHERE APPLICABLE MUST REMAIN WITHIN DIMENSIONS		ANGULAR $\pm 1^\circ$		THIS DRAWING CONTAINS INFORMATION THAT IS PROPRIETARY TO MOLEX INCORPORATED AND SHOULD NOT BE USED WITHOUT WRITTEN PERMISSION					