

PLEASE CHECK WWW.MOLEX.COM FOR LATEST PART INFORMATION

Part Number: [0022051101](#)
Status: **Active**
Description: 2.50mm (.098") Pitch Header, Right Angle, Square Pin, 10 Circuits, Tin (Sn) Plating

Documents:

| | |
|---|---|
| 3D Model | Product Specification PS-3094-002 (PDF) |
| Drawing (PDF) | Product Specification PS-99020-0088 (PDF) |
| Product Specification PS-3094-001 (PDF) | RoHS Certificate of Compliance (PDF) |

Agency Certification

| | |
|-----|---------|
| CSA | LR19980 |
| UL | E29179 |

General

| | |
|----------------|----------------------|
| Product Family | PCB Headers |
| Series | 3094 |
| Application | Wire-to-Board |
| Product Name | N/A |

Physical

| | |
|--------------------------------|-----------------|
| Breakaway | No |
| Circuits (Loaded) | 10 |
| Circuits (maximum) | 10 |
| Color - Resin | Natural (White) |
| Flammability | 94V-0 |
| Glow-Wire Compliant | No |
| Lock to Mating Part | None |
| Material - Metal | Brass |
| Material - Plating Mating | Tin |
| Material - Plating Termination | Tin |
| Material - Resin | Nylon |
| Number of Rows | 1 |
| Orientation | Right Angle |
| PC Tail Length (in) | 0.134 In |
| PC Tail Length (mm) | 3.40 mm |
| PCB Locator | No |
| PCB Retention | None |
| PCB Thickness Recommended (in) | 0.062 In |
| PCB Thickness Recommended (mm) | 1.60 mm |
| Packaging Type | Bag |
| Pitch - Mating Interface (in) | 0.098 In |
| Pitch - Mating Interface (mm) | 2.50 mm |
| Plating min: Mating (µin) | 200 |
| Plating min: Mating (µm) | 5 |
| Plating min: Termination (µin) | 200 |
| Plating min: Termination (µm) | 5 |
| Polarized to Mating Part | No |
| Polarized to PCB | No |
| Shrouded | No |
| Stackable | Yes |
| Temperature Range - Operating | -40°C to +105°C |
| Termination Interface: Style | Through Hole |

Electrical

| | |
|-------------------------------|------|
| Current - Maximum per Contact | 3A |
| Voltage - Maximum | 250V |

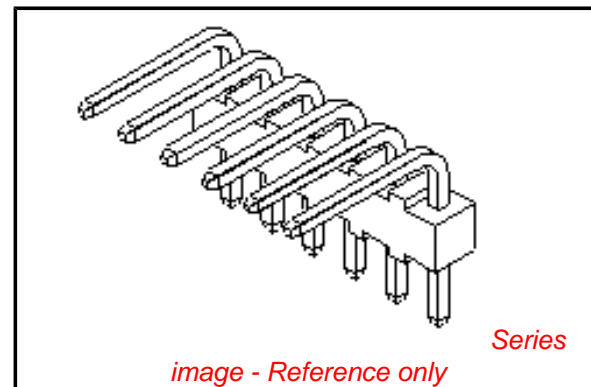

image - Reference only

EU RoHS

**ELV and RoHS
Compliant**
REACH SVHC
 Not Reviewed
**Halogen-Free
Status**

China RoHS



**Need more information on product
environmental compliance?**

Email productcompliance@molex.com
 For a multiple part number RoHS Certificate of Compliance, [click here](#)

Please visit the [Contact Us](#) section for any non-product compliance questions.

Search Parts in this Series

[3094Series](#)

Mates With

[5051](#) , [7534](#)

Solder Process Data

Lead-free Process Capability

Wave Capable (TH only)

Material Info

Old Part Number

3094-10A

Reference - Drawing Numbers

Product Specification

PS-3094-001, PS-3094-002, PS-99020-0088

Sales Drawing

SD-3094-NA, SDAE-3094-N*(*)

This document was generated on 04/15/2010

PLEASE CHECK WWW.MOLEX.COM FOR LATEST PART INFORMATION

8 7 6 5 4 2 1

ENG. NO. 22-05-1**1 SD -3094-NA

EDP NO. 22-05-1**1

MM DIMENSIONS IN METRIC DO NOT SCALE DRAWING

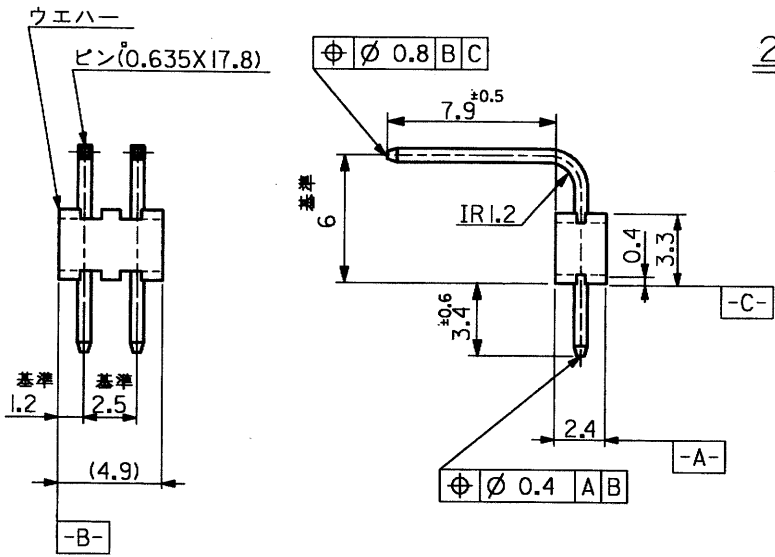

2 極

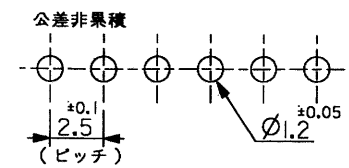

基板取付穴推奨寸法

NOTES:

1. ウエハーのソリは、長さ 25.4mm に対して 0.2mm MAX.
2. () 内寸法は参考値。

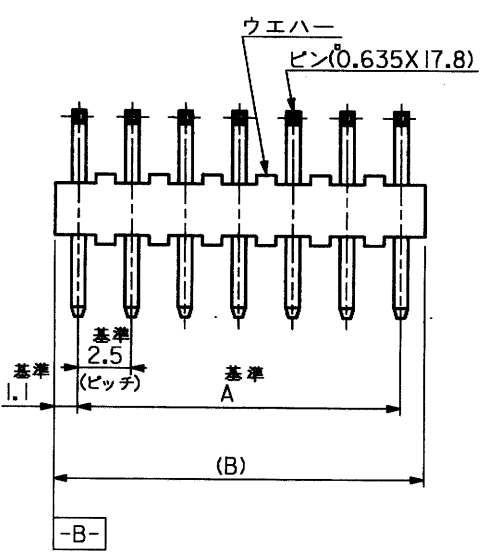

3 極 ~ 20 極

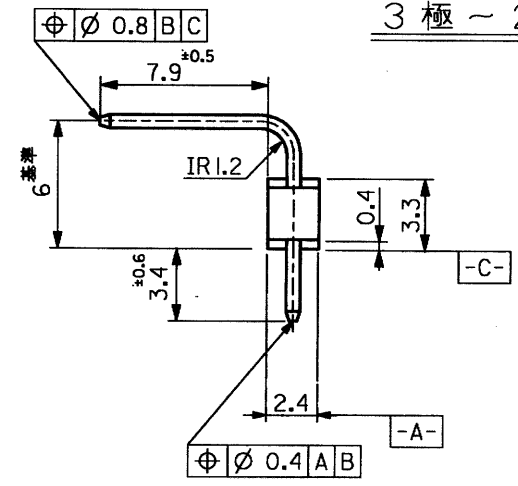

| | | | | |
|------|------|------------|----------|----|
| 47.5 | 49.7 | 22-05-1201 | 3094-20A | 20 |
| 45 | 47.2 | -1191 | -19A | 19 |
| 42.5 | 44.7 | -1181 | -18A | 18 |
| 40 | 42.2 | -1171 | -17A | 17 |
| 37.5 | 39.7 | -1161 | -16A | 16 |
| 35 | 37.2 | -1151 | -15A | 15 |
| 32.5 | 34.7 | -1141 | -14A | 14 |
| 30 | 32.2 | -1131 | -13A | 13 |
| 27.5 | 29.7 | -1121 | -12A | 12 |
| 25 | 27.2 | -1111 | -11A | 11 |
| 22.5 | 24.7 | -1101 | -10A | 10 |
| 20 | 22.2 | -1091 | -09A | 9 |
| 17.5 | 19.7 | -1081 | -08A | 8 |
| 15 | 17.2 | -1071 | -07A | 7 |
| 12.5 | 14.7 | -1061 | -06A | 6 |
| 10 | 12.2 | -1051 | -05A | 5 |
| 7.5 | 9.7 | -1041 | -04A | 4 |
| 5 | 7.2 | -1031 | -03A | 3 |
| 2.5 | 4.9 | 22-05-1021 | 3094-02A | 2 |
| A | (B) | EDP. NO. | ENG. NO. | 極数 |

| | | | | |
|-------------------------|-------|---|--------------------|-----------|
| 角度 ANGLE | ±3° | | | |
| 30 以上 OVER | ±0.3 | J | REVISED BY | Y. M |
| 10 以上 OVER 30 UNDER | ±0.25 | H | REDRAWN W/O CHANGE | K.K |
| 10 未満 UNDER | ±0.2 | | ECN NO. 4648 | 1/9 |
| 一般公差 GENERAL TOLERANCES | | | 変更内容 | DR. 日付 |
| | | | REVISION RECORD | CHK. DATE |

| | |
|-------------------|-----------------------|
| 材料 MATERIAL | ウエハー: 66ナイロン, UL94V-0 |
| 仕上げ FINISH | — |
| 適用電線範囲 WIRE RANGE | — |
| 適用外径 INS. RANGE | — |
| DRAWN BY | K.KAMATA |
| CHK'D BY | |
| APP'D BY | |
| 尺度 | 4 - 1 |

| | |
|--------------------------------------|----------------------|
| MOLEX-JAPAN CO., LTD. 日本モレックス株式会社 | |
| EDP. NO. | 22-05-1**1 |
| ENG. NO. | SD -3094-NA |
| TITLE 名称 | K.K. 2.5 WAFER ASS'Y |
| REV | J |

THIS DRAWING CONTAINS INFORMATION THAT IS PROPRIETARY TO MOLEX/JAPAN AND SHOULD NOT BE USED WITHOUT WRITTEN PERMISSION
本図面は日本モレックス(株)の所有する情報を含むもので当社の許可なく複製を禁止する。

PART NO. SEE CHART
 DWG. NO. SDAE-3094-N*(*)

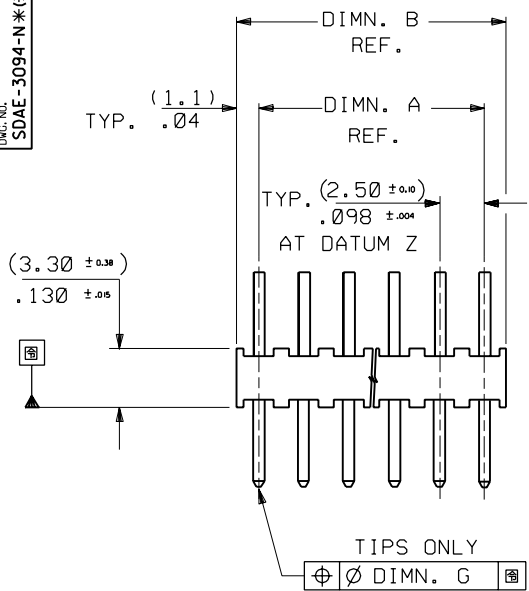

TERMINAL PIN, (0.64)/.025 SQ. FOR PART NOS, PLATING & MATERIAL SEE CHARTS

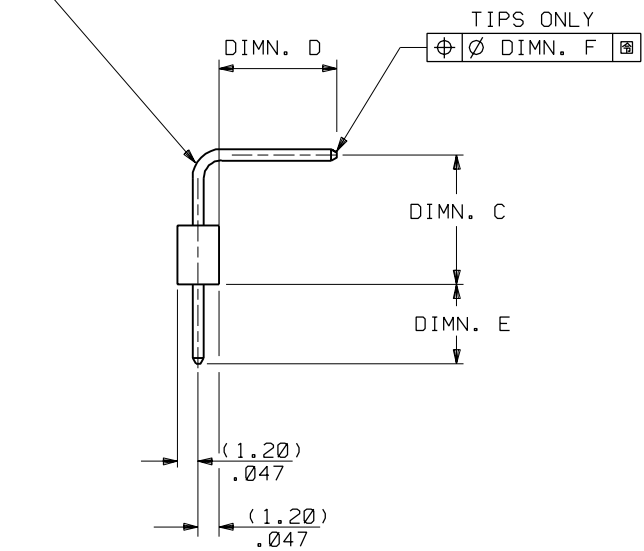

AE-3094-N*(*)
 PLATING CODE WHERE APPLICABLE
 NO. OF CKTS. VERSION

NOTES:

1. WAFER MATL. NYLON 6/6, 94V-0.
2. PIN PUSH OUT FORCE (0.907 KG)/2 LBS. MIN.
3. PARTS ARE STACKABLE END TO END AND SIDE TO SIDE ON (2.50)/.098 CENTRES.
4. FOR DIMENSIONS C,D,E,F & G SEE SUBSEQUENT SHEETS.
5. PINS MUST CONFORM TO MOLEX SOLDERABILITY SPEC. ES-152.

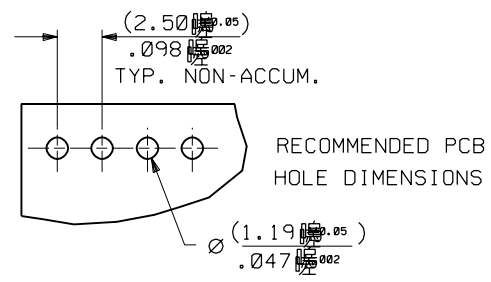

| | | |
|--------------|--------------------------------|--------------------------------|
| 20 | 喉47.50 ± 0.25 1.870 ± 0.010 | 喉49.70 ± 0.16 1.957 ± 0.014 |
| 19 | 喉45.00 ± 0.20 1.772 ± 0.009 | 喉47.20 ± 0.33 1.858 ± 0.013 |
| 18 | 喉42.50 ± 0.20 1.673 ± 0.009 | 喉44.70 ± 0.10 1.760 ± 0.013 |
| 17 | 喉40.00 ± 0.20 1.575 ± 0.008 | 喉42.20 ± 0.10 1.662 ± 0.012 |
| 16 | 喉37.50 ± 0.20 1.476 ± 0.008 | 喉39.70 ± 0.10 1.563 ± 0.012 |
| 15 | 喉35.00 ± 0.20 1.378 ± 0.008 | 喉37.2 ± 0.10 1.462 ± 0.012 |
| 14 | 喉32.50 ± 0.20 1.280 ± 0.007 | 喉34.70 ± 0.10 1.367 ± 0.011 |
| 13 | 喉30.00 ± 0.18 1.181 ± 0.007 | 喉32.20 ± 0.10 1.268 ± 0.011 |
| 12 | 喉27.50 ± 0.18 1.083 ± 0.007 | 喉29.70 ± 0.10 1.169 ± 0.011 |
| 11 | 喉25.00 ± 0.15 .984 ± 0.006 | 喉27.20 ± 0.10 1.071 ± 0.010 |
| 10 | 喉22.50 ± 0.15 .886 ± 0.006 | 喉24.70 ± 0.10 .972 ± 0.010 |
| 9 | 喉20.00 ± 0.13 .787 ± 0.005 | 喉22.20 ± 0.10 .874 ± 0.009 |
| 8 | 喉17.50 ± 0.13 .689 ± 0.005 | 喉19.70 ± 0.10 .776 ± 0.009 |
| 7 | 喉15.00 ± 0.13 .591 ± 0.005 | 喉17.20 ± 0.10 .677 ± 0.009 |
| 6 | 喉12.50 ± 0.10 .492 ± 0.004 | 喉14.70 ± 0.10 .578 ± 0.009 |
| 5 | 喉10.00 ± 0.10 .394 ± 0.004 | 喉12.20 ± 0.10 .480 ± 0.008 |
| 4 | 喉7.50 ± 0.10 .295 ± 0.004 | 喉9.70 ± 0.10 .382 ± 0.008 |
| 3 | 喉5.00 ± 0.10 .197 ± 0.004 | 喉7.20 ± 0.10 .284 ± 0.008 |
| 2 | 喉2.50 ± 0.10 .098 ± 0.004 | 喉4.70 ± 0.10 .185 ± 0.008 |
| NO. OF CCTS. | DIMN. A | DIMN. B |

| | |
|---|----------|
| 2 | G |
| 1 | J |
| | SH. REV. |

FOR PREVIOUS DRAWING ISSUES SEE MRI.

ECN E00230
 COLOUR CHANGE
 90.NOV.29 P.M.M

REVISIONS

| DIMENSIONS SHOWN (METRIC) INCH | |
|---|---|
| UNLESS OTHERWISE SPECIFIED TOLERANCES: ANGULAR ± 1/2° | |
| 3 PLACE | ± .010 |
| 2 PLACE | ± .014 |
| 1 PLACE | ± .035 |
| DRAFT WHERE APPLICABLE MUST REMAIN WITHIN DIMENSIONS | |
| DESIGN DIMENSION (PRIMARY) | <input checked="" type="checkbox"/> (MM) <input type="checkbox"/> IN. |
| EQUIVALENT DIMENSION (SECONDARY) | <input type="checkbox"/> (MM) <input checked="" type="checkbox"/> IN. |

DRWG BY MCC
 CHK'D BY
 APP'D BY
 SCALE 4:1

REVISE ONLY ON CAD SYSTEM

CAD/CAM FILE NAME: SA3094X1.DGN

TITLE: WAFER ASSY, RT. ANGLE (2.50)/.098 CENTRES (0.64)/.025 SQ. PIN

MOLEX MOLEX EUROPE

SHEET NO. DATE: 1 OF 2 9 / 2 / 88

PART NO. SEE CHART DWG NO. SDAE-3094-N*(*) SIZE B

PART NO. SEE CHART
 DWG. NO. SDAE-3094-N*(*)

| PIN MATERIAL | |
|--------------------|------------------|
| DIMn. C | ± (0.51) .020 |
| DIMn. D | ± (1.02) .040 |
| DIMn. E | ± (0.51) .020 |
| DIMn. F | |
| DIMn. G | |
| No. OF CCTS. | |
| 2 | |
| 3 | |
| 4 | |
| 5 | |
| 6 | |
| 7 | |
| 8 | |
| 9 | |
| 10 | |
| 11 | |
| 12 | |
| 13 | |
| 14 | |
| 15 | |
| 16 | |
| 17 | |
| 18 | |
| 19 | |
| 20 | |
| PLATING TO E.S. 88 | |

| AE-3094-NA | | |
|--|-------------|------|
| BRASS | | |
| | (5.95)/.234 | |
| | (7.50)/.295 | |
| | (3.43)/.135 | |
| | (0.76)/.030 | |
| | (0.38)/.015 | |
| PART No. | ENG. No. | |
| 22-05-1021 | AE-3094- | 2 A |
| ↑ 1031 | ↑ | 3 A |
| 1041 | | 4 A |
| 1051 | | 5 A |
| 1061 | | 6 A |
| 1071 | | 7 A |
| 1081 | | 8 A |
| 1091 | | 9 A |
| 1101 | | 10 A |
| 1111 | | 11 A |
| 1121 | | 12 A |
| 1131 | | 13 A |
| 1141 | | 14 A |
| 1151 | | 15 A |
| 1161 | | 16 A |
| 1171 | | 17 A |
| 1181 | | 18 A |
| 1191 | | 19 A |
| 22-05-1201 | AE-3094- | 20 A |
| (0.005)/.0002 MIN. ELECTRO-TIN OVER (0.0025)/.0001 MIN. COPPER | | |

| AE-3094-NAG | | |
|---|-------------|-------|
| BRASS | | |
| | (5.95)/.234 | |
| | (7.50)/.295 | |
| | (3.43)/.135 | |
| | (0.76)/.030 | |
| | (0.38)/.015 | |
| PART No. | ENG. No. | |
| 22-12-1021 | AE-3094- | 2 AG |
| ↑ 1031 | ↑ | 3 AG |
| 1041 | | 4 AG |
| 1051 | | 5 AG |
| 1061 | | 6 AG |
| 1071 | | 7 AG |
| 1081 | | 8 AG |
| 1091 | | 9 AG |
| 1101 | | 10 AG |
| 1111 | | 11 AG |
| 1121 | | 12 AG |
| 1131 | | 13 AG |
| 1141 | | 14 AG |
| 1151 | | 15 AG |
| 1161 | | 16 AG |
| 1171 | | 17 AG |
| 1181 | | 18 AG |
| 1191 | | 19 AG |
| 22-12-1201 | AE-3094- | 20 AG |
| (0.0005)/.00002 MIN. GOLD OVER (0.00076)/.00003 MIN. NICKEL | | |

| AE-3094-NF | | |
|--|-------------|------|
| BRASS | | |
| | (4.00)/.157 | |
| | (9.86)/.388 | |
| | (3.10)/.122 | |
| | (0.76)/.030 | |
| | (0.38)/.015 | |
| PART No. | ENG. No. | |
| 22-05-1029 | AE-3094- | 2 F |
| ↑ 1039 | ↑ | 3 F |
| 1049 | | 4 F |
| 1059 | | 5 F |
| 1069 | | 6 F |
| 1079 | | 7 F |
| 1089 | | 8 F |
| 1099 | | 9 F |
| 1109 | | 10 F |
| 1119 | | 11 F |
| 1129 | | 12 F |
| 1139 | | 13 F |
| 1149 | | 14 F |
| 1159 | | 15 F |
| 1169 | | 16 F |
| 1179 | | 17 F |
| 1189 | | 18 F |
| 1199 | | 19 F |
| 22-05-1209 | AE-3094- | 20 F |
| (0.005)/.0002 MIN. ELECTRO-TIN OVER (0.0025)/.0001 MIN. COPPER | | |

| AE-3094-NT(102) | | |
|--|------------------------------|------------|
| PHOS. BRONZE | | |
| | (4.00)/.157 ± (0.38) .015 | |
| | (15.68)/.617 | |
| | (3.50)/.138 | |
| | (0.76)/.030 | |
| | (0.38)/.015 | |
| PART No. | ENG. No. | |
| NOT TOOLED | AE-3094- | 2 T (102) |
| 38-00-1446 | ↑ | 3 T ↑ |
| NOT TOOLED | | 4 T |
| 38-00-1447 | | 5 T |
| 38-00-1448 | | 6 T |
| 38-00-1449 | | 7 T |
| NOT TOOLED | | 8 T |
| NOT TOOLED | | 9 T |
| 38-00-1450 | | 10 T |
| NOT TOOLED | | 11 T |
| ↑ | | 12 T |
| | | 13 T |
| | | 14 T |
| | | 15 T |
| | | 16 T |
| | | 17 T |
| | | 18 T |
| ↓ | | 19 T ↓ |
| NOT TOOLED | AE-3094- | 20 T (102) |
| (0.005)/.0002 MIN. ELECTRO-TIN OVER (0.0025)/.0001 MIN. COPPER | | |

FOR PREVIOUS DRAWING ISSUES SEE MRI.

G SEE SHEET I.

LTR REVISIONS

| | |
|----------------|--------|
| 3 PLACE ± .010 | |
| 2 PLACE ± .014 | ± 0.25 |
| 1 PLACE | ± 0.35 |

DRAFT WHERE APPLICABLE MUST REMAIN WITHIN DIMENSIONS

DESIGN DIMENSION (PRIMARY) IN. (MM)

EQUIVALENT DIMENSION (SECONDARY) IN. (MM)

DRWG BY MCC

CHK'D BY

APP'D BY

SCALE

| | | | |
|--|---|---------------------------------|------|
| REVISE ONLY ON CAD SYSTEM | | SHL | REV. |
| CAD/CAM FILENAME SA3094X2 DGN | THIS DRAWING CONTAINS INFORMATION THAT IS PROPRIETARY TO MOLEX INC. & SHOULD NOT BE USED WITHOUT WRITTEN PERMISSION | | |
| TITLE WAFER ASSY, RT. ANGLE (2.50)/.098 CENTRES (0.64)/.025 SQ. PIN | | | |
| molex MOLEX EUROPE | | SHEET NO. DATE 20F2 5 /2 /88 | |
| PART NO. SEE CHART | DWG NO. SDAE-3094-N*(*) | SIZE B | |