

PLEASE CHECK WWW.MOLEX.COM FOR LATEST PART INFORMATION

Part Number: [0191640807](#)
Status: **Active**
Description: Perma-Seal™ Male Snap Plug for 18-22 AWG Wire, Diameter 3.96mm (.156"), Mylar Tape Carrier

Documents:

[Drawing \(PDF\)](#) [RoHS Certificate of Compliance \(PDF\)](#)

Agency Certification

UL E152602

General

Product Family Quick Disconnects
 Series [19164](#)
 Crimp Quality Equipment Yes
 Product Name Perma-Seal™
 Type Snap Plug

Physical

Barrel Type Closed
 Flammability 94V-2
 Gender Male
 Glow-Wire Compliant No
 Insulation NiAc™
 Lock to Mating Part None
 Material - Metal Copper
 Orientation Straight
 Packaging Type Adhesive Tape on Reel
 Tab Thickness N/A
 Tab Width N/A
 Temperature Range - Operating -55°C to +125°C
 Wire Insulation Diameter 5.97mm (.235") max.
 Wire Size AWG 18, 20, 22
 Wire Size mm² 0.25 - 1.50

Electrical

Voltage - Maximum 600V

Material Info

Old Part Number SA-269T

Reference - Drawing Numbers

Sales Drawing SD-19164-031



image - Reference only

Series

EU RoHS

ELV and RoHS Compliant

REACH SVHC

Not Reviewed

Halogen-Free

Status

Not Reviewed

China RoHS



Need more information on product environmental compliance?

Email productcompliance@molex.com
 For a multiple part number RoHS Certificate of Compliance, [click here](#)

Please visit the [Contact Us](#) section for any non-product compliance questions.

Search Parts in this Series

[19164Series](#)

	13	12	11	10	9	8	7	6	5	4	3	2	1
J	MATERIAL NUMBER	ENGINEERING NUMBER	MATERIAL NUMBER TAPE	ENGINEERING NUMBER TAPE	WIRE AWG	MWID $\triangle 4$	ID MIN	INSULATION COLOR					
	I91640010	SA-269	I91640807	SA-269T	22-18	.235/5.97	.054/1.37	RED					
	I91640040	SB-289	I91640315	SB-289T	16-14	.264/6.71	.080/2.03	BLUE					

(A)

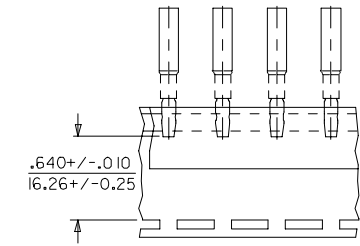

PARTS ON TAPE

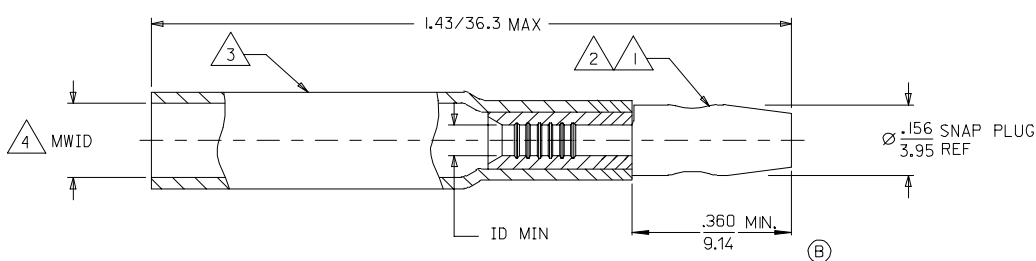

SALES DRAWING

NOTES:

- $\triangle 1$ TERMINAL MATERIAL: COPPER ALLOY
- $\triangle 2$ FINISH: ELECTRO TIN PLATE.
- $\triangle 3$ INSULATION MATERIAL: HEAT SHRINKABLE TUBING WITH HOTMELT ADHESIVE INNER LINER. COLOR: SEE CHART
- $\triangle 4$ MWID = MAXIMUM WIRE INSULATION DIAMETER.

RELEASED FC NO: ETC2007-0054 DRWN: JLOMASTRO 2006/08/16 CHKD: RDEROSS 2006/08/16 APPR: JMACNEIL 2006/08/17 REVISIONS DESCRIPTION	QUALITY SYMBOLS	GENERAL TOLERANCES (UNLESS SPECIFIED)		DIMENSION STYLE	SCALE	DESIGN UNITS	THIRD ANGLE PROJECTION	
	$\nabla = 0$ $\nabla = 0$	mm	INCH	IN/MM	---	INCH		
		4 PLACES ± ---	± ---	ASAYDEH	DATE	TITLE		
		3 PLACES ± ---	± ---	CHECKED BY	DATE	.156 BULLET PLUG PERMA-SEAL		
	2 PLACES ± ---	± ---	JLOMASTRO	05/12/13				
	1 PLACE ± ---	± ---	APPROVED BY	DATE				
	ANGULAR ± --- °	± --- °	RDEROSS	05/12/13				
			MATERIAL NO.	DOCUMENT NO.	MOLEX INCORPORATED			
			SEE CHART	SD-19164-031	SHEET NO. 1 OF 1			
			DRAFT WHERE APPLICABLE MUST REMAIN WITHIN DIMENSIONS				THIS DRAWING CONTAINS INFORMATION THAT IS PROPRIETARY TO MOLEX INCORPORATED AND SHOULD NOT BE USED WITHOUT WRITTEN PERMISSION	