

PLEASE CHECK WWW.MOLEX.COM FOR LATEST PART INFORMATION

Part Number: **0191640040**
Status: **Active**
Description: Perma-Seal™ Male Snap Plug for 14-16 AWG Wire, Diameter 3.96mm (.156")

Documents:

[Drawing \(PDF\)](#) [RoHS Certificate of Compliance \(PDF\)](#)

Agency Certification

CSA LR18689
 UL E152602

General

Product Family Quick Disconnects
 Series 19164
 Crimp Quality Equipment Yes
 Product Name Perma-Seal™
 Type Snap Plug

Physical

Barrel Type Closed
 Flammability 94V-2
 Gender Male
 Glow-Wire Compliant No
 Insulation NiAc™
 Lock to Mating Part None
 Material - Metal Copper
 Orientation Straight
 Packaging Type Bag
 Tab Thickness N/A
 Tab Width N/A
 Temperature Range - Operating -55°C to +125°C
 Wire Insulation Diameter 6.71mm (.264") max.
 Wire Size AWG 14, 16
 Wire Size mm² 1.00 - 2.50

Electrical

Voltage - Maximum 600V

Material Info

Old Part Number SB-289

Reference - Drawing Numbers

Sales Drawing SD-19164-031

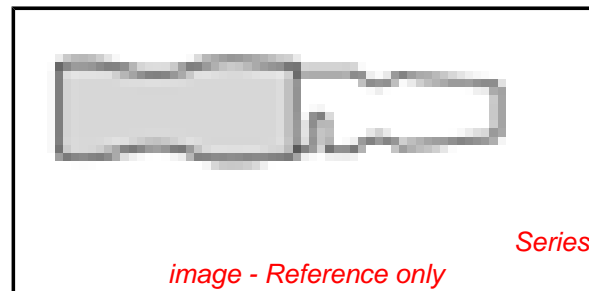

EU RoHS

**ELV and RoHS
 Compliant**
**REACH SVHC
 Contains SVHC: No**
**Halogen-Free
 Status
 Not Reviewed**

China RoHS



**Need more information on product
 environmental compliance?**

Email productcompliance@molex.com
 For a multiple part number RoHS Certificate of
 Compliance, [click here](#)

Please visit the [Contact Us](#) section for any
 non-product compliance questions.

Search Parts in this Series

19164Series

Application Tooling | FAQ

*Tooling specifications and manuals are
 found by selecting the products below.
 Crimp Height Specifications are then
 contained in the Application Tooling
 Specification document.*

Global

Description	Product #
Hand Crimp Tool	0640010100

13	12	11	10	9	8	7	6	5	4	3	2	1
MATERIAL NUMBER	ENGINEERING NUMBER	MATERIAL NUMBER TAPE	ENGINEERING NUMBER TAPE	WIRE AWG	MWID $\triangle 4$	ID MIN	INSULATION COLOR					
191640010	SA-269	191640807	SA-269T	22-18	.235/5.97	.054/1.37	RED					
191640040	SB-289	191640315	SB-289T	16-14	.264/6.71	.080/2.03	BLUE					

(A)

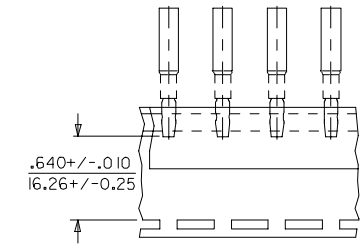

PARTS ON TAPE

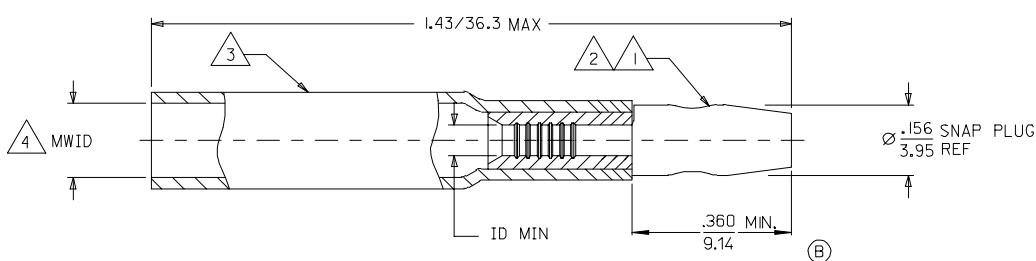

SALES DRAWING

NOTES:

- $\triangle 1$ TERMINAL MATERIAL: COPPER ALLOY
- $\triangle 2$ FINISH: ELECTRO TIN PLATE.
- $\triangle 3$ INSULATION MATERIAL: HEAT SHRINKABLE TUBING WITH HOTMELT ADHESIVE INNER LINER. COLOR: SEE CHART
- $\triangle 4$ MWID = MAXIMUM WIRE INSULATION DIAMETER.

RELEASED FC NO: ETC2007-0054 DRWN: JLOMASTRO 2006/08/16 CHKD: RDEROSS 2006/08/16 APPR: JMACNEIL 2006/08/17 REVISIONS DESCRIPTION	QUALITY SYMBOLS	GENERAL TOLERANCES (UNLESS SPECIFIED)		DIMENSION STYLE	SCALE	DESIGN UNITS	THIRD ANGLE PROJECTION
	$\nabla = 0$	mm	INCH	IN/MM	---	INCH	\triangle
	$\nabla = 0$	4 PLACES ± ---	± ---	ASAYDEH	DATE	TITLE	
		3 PLACES ± ---	± ---	CHECKED BY	DATE	.156 BULLET PLUG PERMA-SEAL	
	2 PLACES ± ---	± ---	JLOMASTRO	05/12/13	MOLEX INCORPORATED		
	1 PLACE ± ---	± ---	APPROVED BY	DATE	DOCUMENT NO.		
	ANGULAR ± --- °	± --- °	RDEROSS	05/12/13	SD-19164-031		
			MATERIAL NO.		SHEET NO.		
					1 OF 1		
			DRAFT WHERE APPLICABLE MUST REMAIN WITHIN DIMENSIONS		THIS DRAWING CONTAINS INFORMATION THAT IS PROPRIETARY TO MOLEX INCORPORATED AND SHOULD NOT BE USED WITHOUT WRITTEN PERMISSION		