

KLB-520 O

KLB-520 O is a high bright InGaAlP Orange LED, and has the optimized optical characteristics.

Features

- Transparent epoxy lens
- High Optical Output

Applications

- Display
- Indicator
- Signage
- Camera

DIMENSIONS

Unit : [mm]

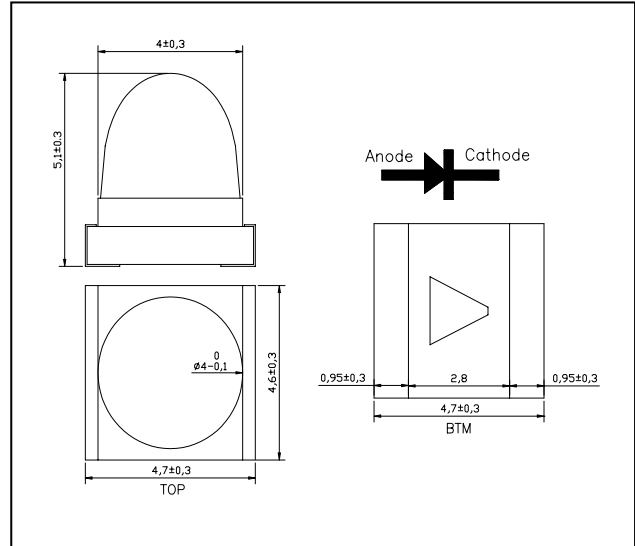

Maximum Ratings

[Ta=25°C]

| Parameter | Symbol | Ratings | Unit |
|--------------------------|------------|------------|------|
| Reverse voltage | V_R | 5 | V |
| Forward current | I_F | 80 | mA |
| Pulse forward current *1 | I_{FP} | 0.5 | A |
| Power dissipation | P_D | 250 | mW |
| Operating temperature | $T_{opr.}$ | -30 ~ +85 | °C |
| Storage temperature | $T_{stg.}$ | -40 ~ +100 | °C |
| Soldering Temperature *2 | $T_{sol.}$ | 260 | °C |

*1. I_{FP} Measured under duty $\frac{1}{10}$ @ 1KHz

*2. Soldering time $\frac{1}{2}$ Sec

Keep the distance more than 3mm from soldering foundation.

Electro-Optical Characteristics

[Ta=25°C]

| Parameter | Symbol | Conditions | Min | Typ | Max | Unit |
|--------------------------|-----------------------|-----------------------|-----|-----|-----|---------------|
| Forward voltage | V_F | $I_F = 20 \text{ mA}$ | - | 2.5 | 3.2 | V |
| Reverse current | I_R | $V_R = 5 \text{ V}$ | - | - | 50 | μA |
| Luminous Intensity | I_v | $I_F = 20 \text{ mA}$ | 20 | 30 | - | cd |
| Peak emission wavelength | λ_P | $I_F = 20 \text{ mA}$ | - | 610 | - | nm |
| Doninant Wave Length | λ_d | $I_F = 20 \text{ mA}$ | 600 | - | 620 | nm |
| Spectral half bandwidth | $\Delta\lambda$ | $I_F = 20 \text{ mA}$ | - | 15 | - | nm |
| Half angle | $2\Delta\theta_{1/2}$ | $I_F = 20 \text{ mA}$ | - | 8 | - | deg. |

KLB-520 O

Forward current vs. Ambient temperature

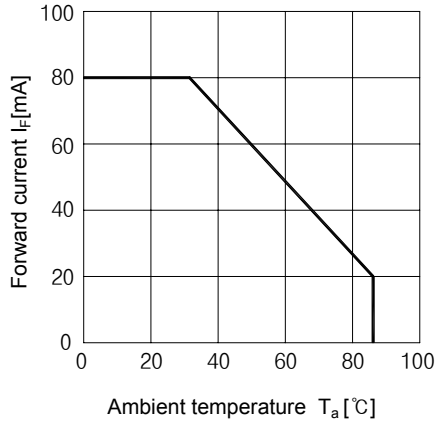

Radiant Intensity vs. Forward current

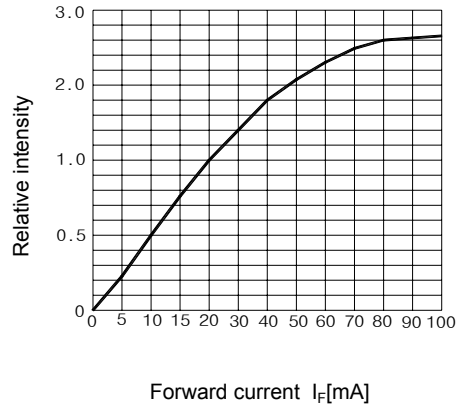

Relative radiant intensity vs. Ambient temperature

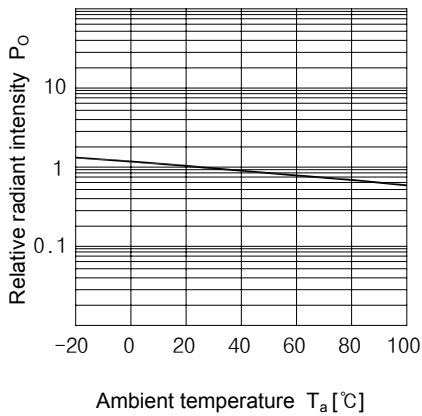

Relative intensity vs. Wavelength

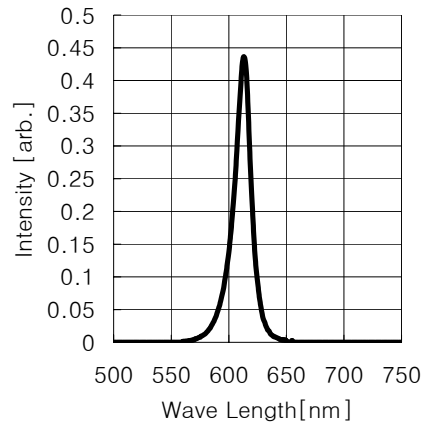

Forward current vs. Forward voltage

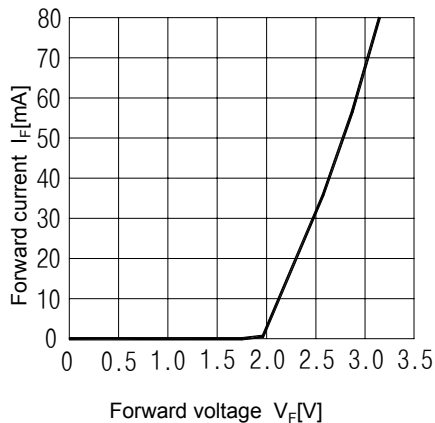

Radiant Pattern

