

PLEASE CHECK WWW.MOLEX.COM FOR LATEST PART INFORMATION

Part Number: [0714330002](#)
Status: **Active**
Overview: ultra_vhdc
Description: VHDCI Female Jackpost, M2-by-0.4mm Internal Thread

Documents:

[Drawing \(PDF\)](#) [RoHS Certificate of Compliance \(PDF\)](#)

General

Product Family	Accessories
Series	71433
Component Type	Screw
Overview	ultra_vhdc
Product Name	VHDCI

Physical

Circuits (Loaded)	N/A
Lock to Mating Part	Yes
Material - Metal	Steel
Packaging Type	Bag

Material Info

Reference - Drawing Numbers

Sales Drawing	SD-71433-005
---------------	--------------

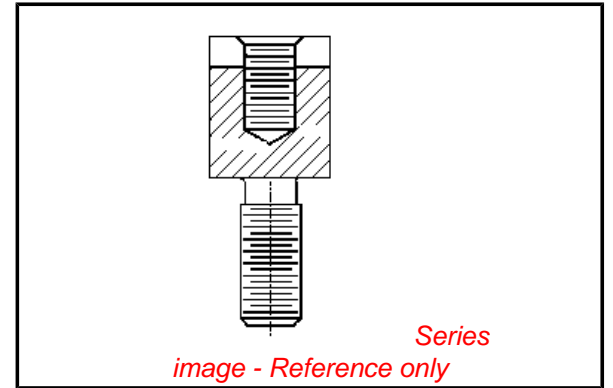

EU RoHS

RoHS Compliant by Exemption

REACH SVHC

Not Reviewed

Halogen-Free

Status

Not Reviewed

China RoHS



Need more information on product environmental compliance?

Email productcompliance@molex.com
 For a multiple part number RoHS Certificate of Compliance, [click here](#)

Please visit the [Contact Us](#) section for any non-product compliance questions.

Search Parts in this Series

[71433Series](#)

Use With

[74337](#) Ultra+™ VHDCI Wire-to-Board Receptacle. [71430](#) Ultra+™ VHDCI Receptacle

NOTES:

1. MATERIAL: HOT ROLLED STEEL.
2. FINISH: NICKEL PLATE
3. PACKAGING: 200 PARTS TO BE BULK PACKED IN BAGS.

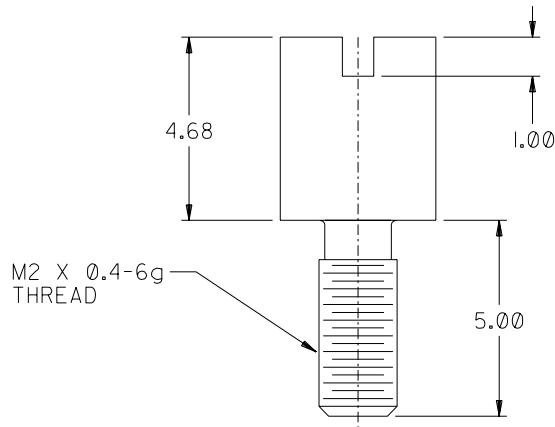
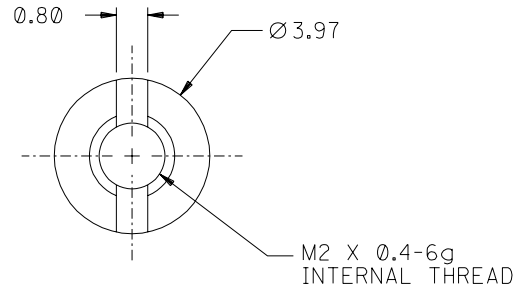

ADD PACKAGING NOTE
 EC NO. UCP2003-0129
 DRWN: SCHMIDCA 07/22/02
 CHK: MBANAKIS 07/23/02
 APPR: MBANAKIS 07/23/02

QUALITY SYMBOLS
 MAJOR
 MINOR
 CRITICAL

	GENERAL TOLERANCES: (UNLESS SPECIFIED)	
	mm	INCH
4 PLACES	±0.	±.
3 PLACES	±0.	±.
2 PLACES	±0.13	±.
1 PLACE	±0.	±.

SCALE 8 : 1	DESIGN UNITS <input checked="" type="checkbox"/> mm <input type="checkbox"/> INCH
DRAWN BY & DATE SSAMPSON 98/04/08	
CHECKED BY & DATE DBOWEN 98/04/08	
APPROVED BY & DATE DBOWEN 98/04/08	

DIMENSIONS: <input type="checkbox"/> mm <input type="checkbox"/> INCH <input checked="" type="checkbox"/> mm ONLY		SHT	REV
THIRD ANGLE PROJECTION		REVISE ON CAD ONLY	
TITLE: VHDCI M2 X 0.4 mm FEMALE ROUND SCREWLOCK			
MOLEX INCORPORATED			

ANGULAR: ± 1/2°
 DRAFT WHERE APPLICABLE MUST REMAIN WITHIN DIMENSIONS

CAD FILENAME NONE.	MATERIAL NO. 71433-0002	DRAWING NO. SD-71433-005	SHEET NO. 1 OF 1
THIS DRAWING CONTAINS INFORMATION THAT IS PROPRIETARY TO MOLEX INCORPORATED AND SHOULD NOT BE USED WITHOUT WRITTEN PERMISSION.			SIZE B