



# TAI-SAW TECHNOLOGY CO., LTD.

No. 3, Industrial 2nd Rd., Ping-Chen Industrial District,  
Taoyuan, 324, Taiwan, R.O.C.

TEL: 886-3-4690038 FAX: 886-3-4697532

E-mail: [tstsales@mail.taisaw.com](mailto:tstsales@mail.taisaw.com) Web: [www.taisaw.com](http://www.taisaw.com)

## Approval Sheet For Product Specification

Issued Date:

Product Name: SAW Filter 159.0125MHz SMD 7.0×5.0 mm

TST Parts No.:TA0289A

Customer Parts No.:\_\_\_\_\_

Company: _____
Division: _____
Approved by : _____
Date: _____

Checked by: \_\_\_\_\_ Bob Chau

Approval by: \_\_\_\_\_ Francis Chen

Date: \_\_\_\_\_ 2006/08/24



# TAI-SAW TECHNOLOGY CO., LTD.

No. 3, Industrial 2nd Rd., Ping-Chen Industrial District,  
Taoyuan, 324, Taiwan, R.O.C.

TEL: 886-3-4690038 FAX: 886-3-4697532

E-mail: [tstsales@mail.taisaw.com](mailto:tstsales@mail.taisaw.com) Web: [www.taisaw.com](http://www.taisaw.com)

## SAW Filter 159.0125 MHz

MODEL NO.: TA0289A

REV. NO.:2

### A. MAXIMUM RATING:

1. Input Power Level: 10 dB<sub>m</sub>
2. DC voltage: 5 V
3. Operating Temperature: -25°C to +70°C
4. Storage Temperature: -40°C to +85°C

### B. ELECTRICAL CHARACTERISTICS:

Item		Specification			
		Unit	Min.	Typ.	Max.
Center Frequency	F <sub>c</sub>	MHz	-	159.0125	-
Insertion Loss	IL <sub>min</sub> (reference level)	dB	-	1.85	2.8
Bandwidth	BW <sub>-3dB</sub>	MHz	6.025	8.2	-
Absolute Attenuation(reference to IL <sub>min</sub> dB)					
F <sub>c</sub> -50 ~ F <sub>c</sub> -30	MHz	dB	42	57	-
F <sub>c</sub> -30 ~ F <sub>c</sub> -15	MHz	dB	36	43	-
F <sub>c</sub> +30 ~ F <sub>c</sub> +50	MHz	dB	42	57	-
Source impedance	Z <sub>s</sub>	Ω	-	50	-
Load impedance	Z <sub>L</sub>	Ω	-	50	-

Note: IL<sub>min</sub> is the minimum of the pass band attenuation. The center frequency F<sub>c</sub> is the mean value of the upper and lower frequencies at the 3dB filter attenuation level relative to the IL<sub>min</sub>.

### C. Frequency Characteristics :

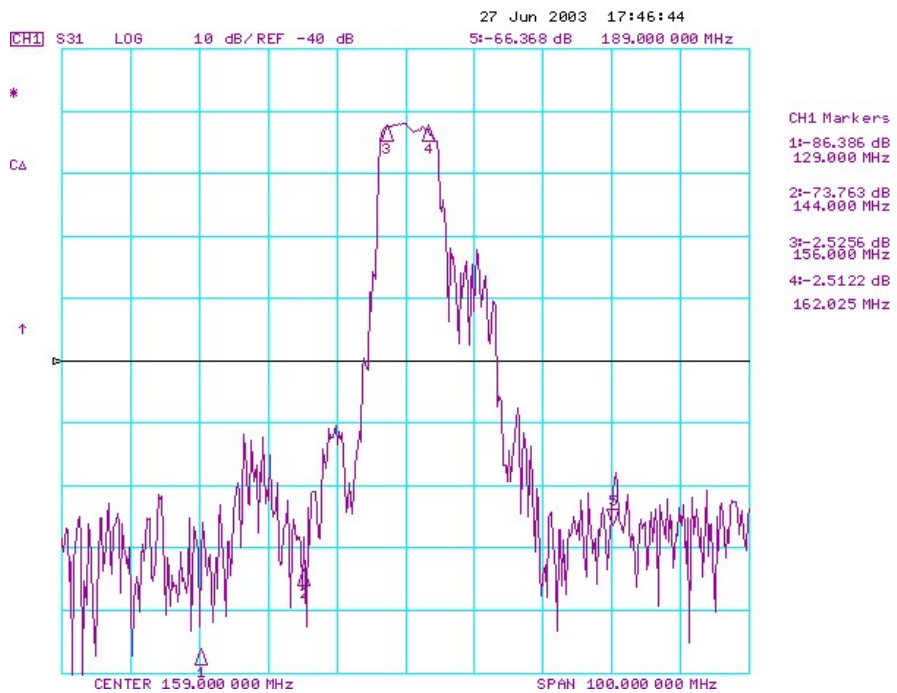
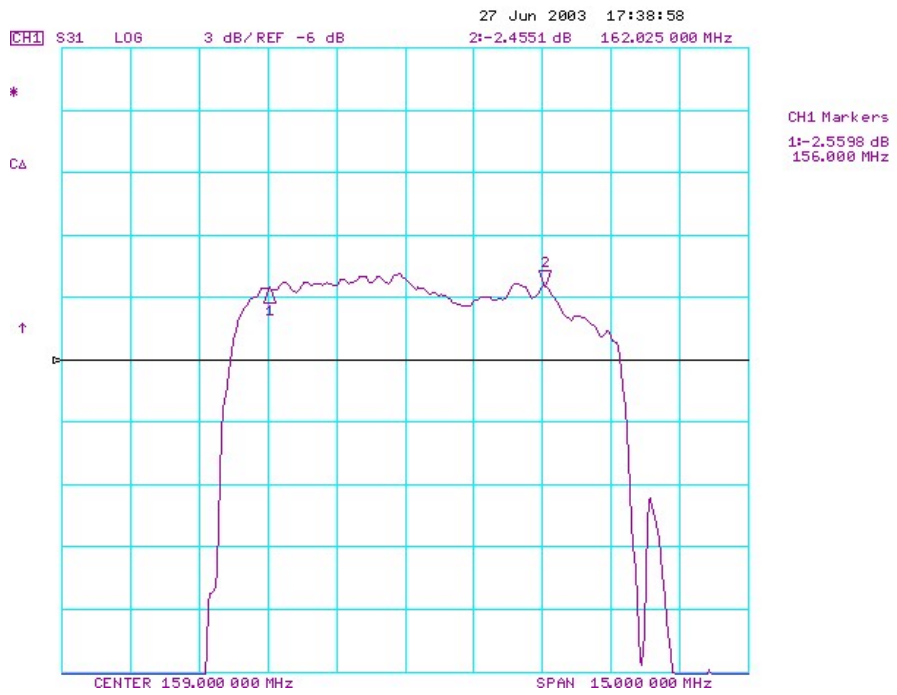

**D. MEASUREMENT CIRCUIT:**

HP Network analyzer

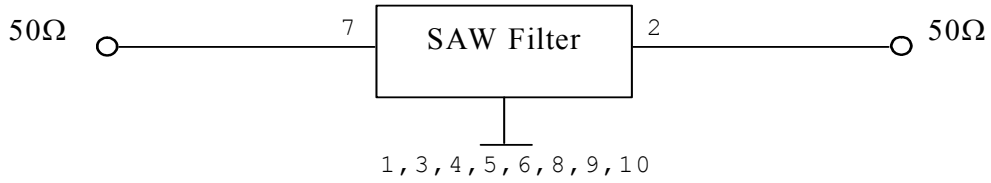

**E. OUTLINE DRAWING:**

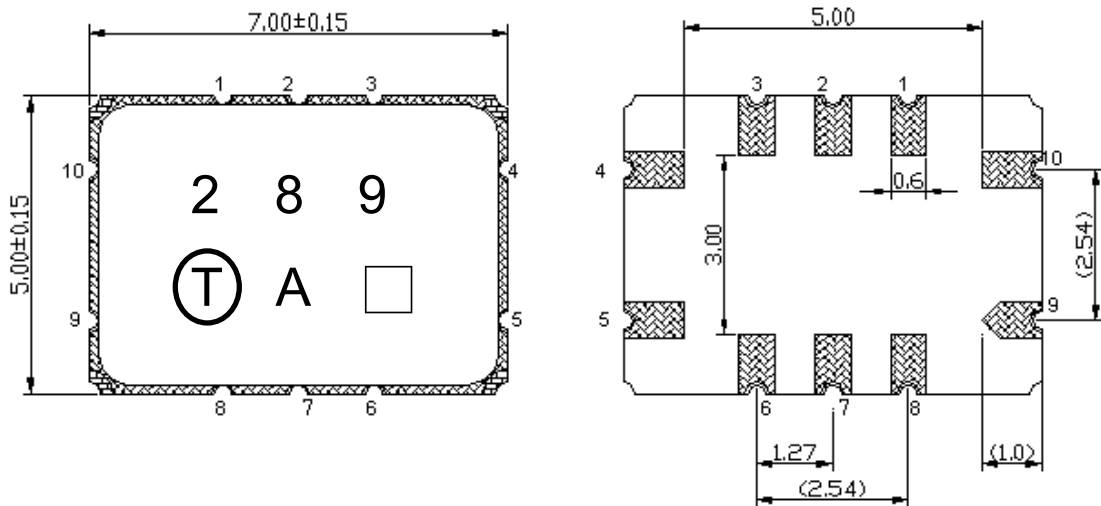

Pin configuration:

7: Input

2: Output

1,3,4,5,6,8,9,10: Ground

□ : Date Code

Unit: mm

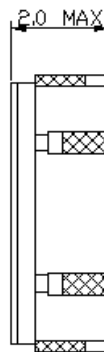

**Product Year Code**

Year	2001 2005	2002 2006	2003 2007	2004 2008
Product Code	A	a	Ⓐ	Ⓐ

**F. PCB Footprint :**

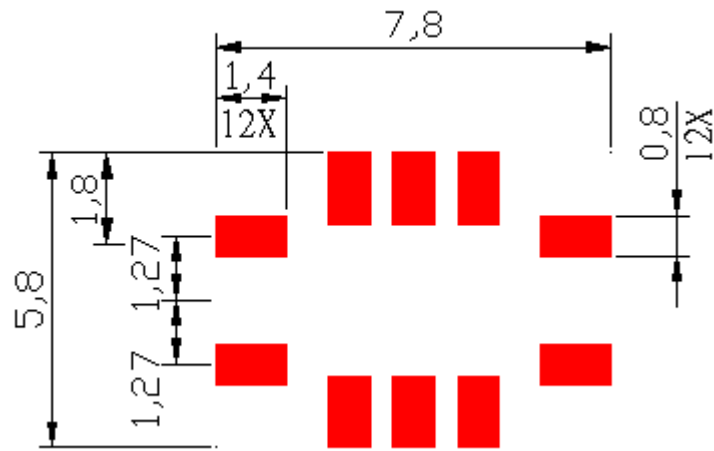

**G. PACKING:**

**1. REEL DIMENSION**

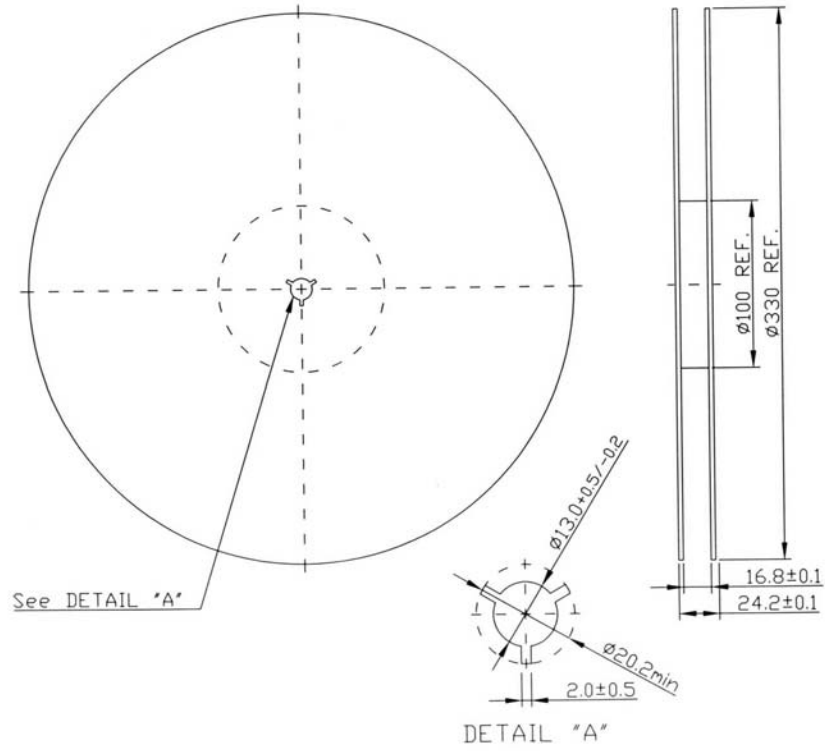

**2. TAPE DIMENSION**

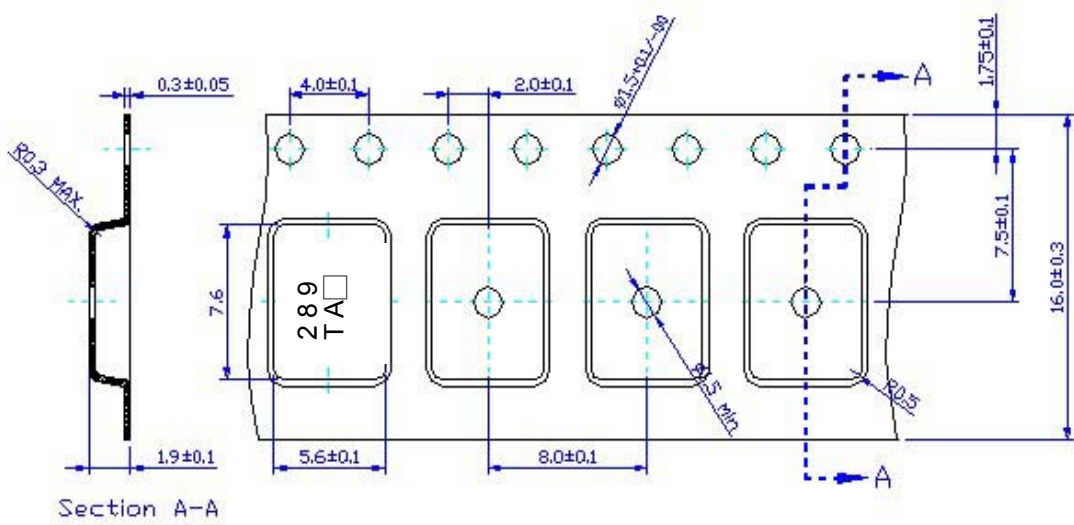

**H. RECOMMENDED REFLOW PROFILE :**

