

REV.	DATE	DESCRIPTION
NC	01/02/07	INITIAL RELEASE

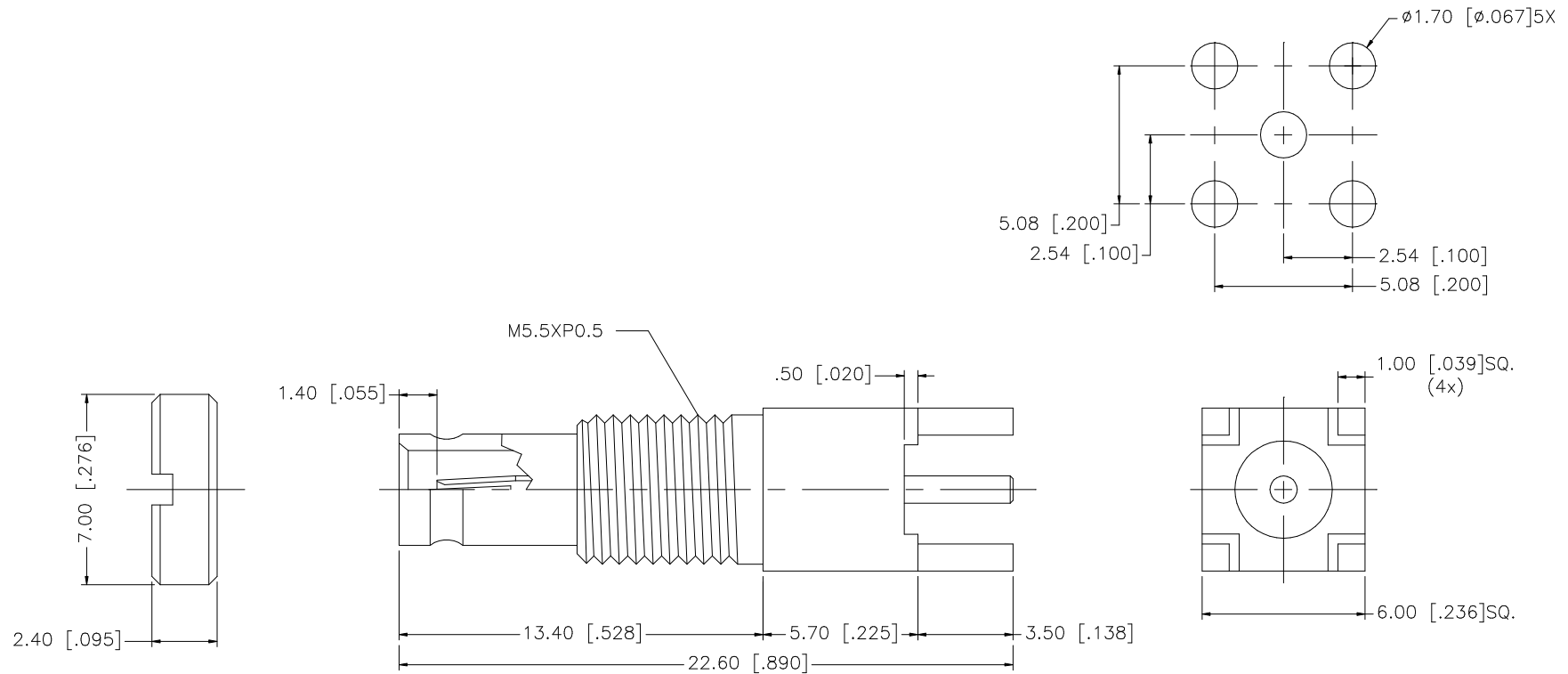

8				<small>UNLESS OTHERWISE SPECIFIED DIMENSIONS ARE IN MILLIMETERS. DIMENSIONS IN [] ARE IN INCHES AND FOR CUSTOMER REFERENCE ONLY.</small> <small>UNLESS OTHERWISE SPECIFIED TOLERANCES FOR MILLIMETERS ARE: 0.5 - 8mm \pm 0.20mm 8 - 30mm \pm 0.40mm 30 - 120mm \pm 0.50mm</small> <small>UNLESS OTHERWISE SPECIFIED TOLERANCES FOR INCHES ARE: .020 - .315 = \pm 0.007" .315 - 1.180 = \pm 0.015" 1.180 - 4.724 = \pm 0.020"</small>	APPROVALS	DATE	<h1 style="color: blue;">Amphenol Connex</h1>			
7			DRAWN		G.R.S.	01/02/07		PART DESCRIPTION 1.0/2.3 PCB BULKHEAD RECEPTACLE - 75ohm		
6			CHECKED							
5			ISSUED							
4	SPANNER NUT	BRASS	NICKEL		1				PART NO. 282121-75	
3	CONTACT PIN	BER. COPPER	GOLD	1						
2	INSULATOR	TEFLON	NATURAL	1						
1	BODY	BRASS	GOLD	1						
	DESCRIPTION	MATERIAL	FINISH	QTY	DO NOT SCALE DRAWING	CAD FILE C:/282/282121-75.DWG	DWG. NO. 282121-75.DWG	REV. A	SIZE A	SCALE NA