

PLEASE CHECK WWW.MOLEX.COM FOR LATEST PART INFORMATION

Part Number: [0343450001](#)
Status: **Active**
Overview: [mx150](#)
Description: MLX 150 Cavity Plug Sealed

Documents:

[3D Model](#) [Product Specification PS-33476-000 \(PDF\)](#)
[Drawing \(PDF\)](#) [RoHS Certificate of Compliance \(PDF\)](#)
[Product Specification PS-33472-000 \(PDF\)](#)

General

Product Family	Crimp Housings
Series	34345
Comments	Meets USCAR 2, Rev. 3 Specification
Overview	mx150
Product Name	MX150™

Physical

Breakaway	No
Circuits (maximum)	0
Color - Resin	Natural
Gender	Plug
Glow-Wire Compliant	No
Keying to Mating Part	Yes
Lock to Mating Part	Yes
Material - Resin	Polyester
Number of Rows	0
Packaging Type	Bag
Panel Mount	No
Pitch - Mating Interface (in)	0.000 In
Pitch - Mating Interface (mm)	0.00 mm
Pitch - Term. Interface (in)	0.000 In
Pitch - Term. Interface (mm)	0.00 mm
Polarized to Mating Part	N/A
Ports	0
Stackable	No
Temperature Range - Operating	-40°C to +125°C

Material Info

Reference - Drawing Numbers

Packaging Specification	PK-31300-438
Product Specification	PS-33472-000, PS-33476-000
Sales Drawing	SD-34345-001

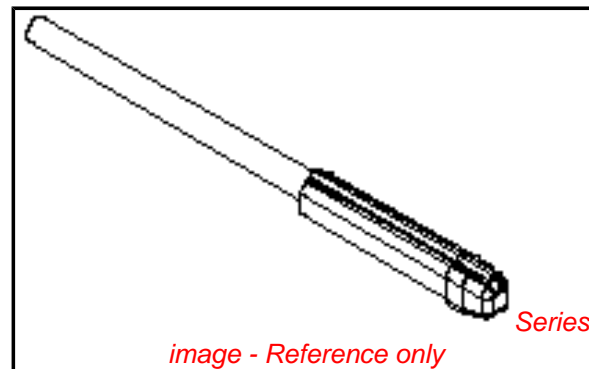

EU RoHS

**ELV and RoHS
Compliant**
**REACH SVHC
Contains SVHC: No**
**Halogen-Free
Status**

China RoHS



**Need more information on product
environmental compliance?**

Email productcompliance@molex.com
 For a multiple part number RoHS Certificate of
 Compliance, [click here](#)

Please visit the [Contact Us](#) section for any
 non-product compliance questions.

Search Parts in this Series

[34345Series](#)

Mates With

[33471](#) , [33481](#) , [33472](#) , [33482](#) , [33476](#) ,
[33486](#)

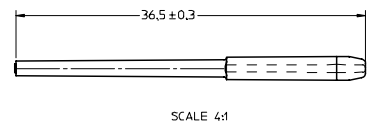
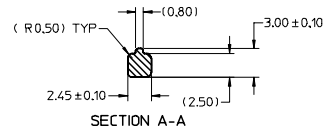
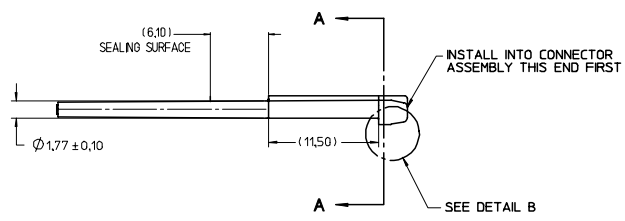

REAR VIEW FEMALE CONNECTOR ASSEMBLY

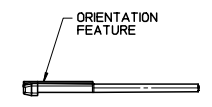
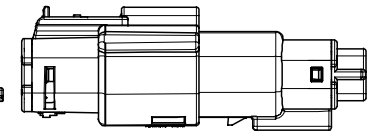
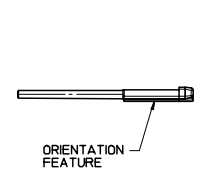
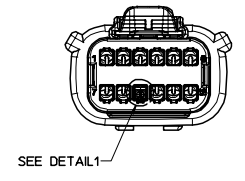

REAR VIEW MALE CONNECTOR ASSEMBLY

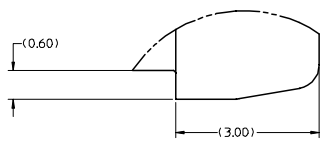
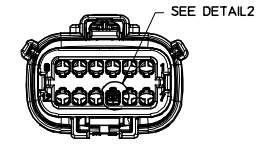

DETAIL B SCALE 20:1

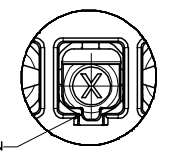

DETAIL 1 SCALE 10:1
INSTALL SEAL PLUG INTO RECEPTACLE ASSEMBLY AS SHOWN ONLY SEE NOTE 7

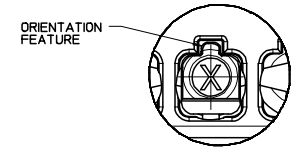

DETAIL 2 SCALE 10:1
INSTALL SEAL PLUG INTO BLADE ASSEMBLY AS SHOWN ONLY SEE NOTE 7

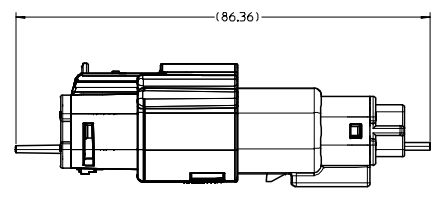

VIEW SHOWING SEAL PLUG ASSEMBLED WITH MOLEX CONNECTORS SEE NOTE 5 SCALE 2:1

NOTES: UNLESS OTHERWISE SPECIFIED

1. MATERIAL: POLYESTER (PBT), GLASS FILLED.
2. MEETS USCAR 2, REV 3 SPECIFICATION.
3. SHALL CONFORM TO PRODUCT SPECIFICATION: PS-33471-000, PS-33472-000, PS-33476-000
4. SHALL CONFORM TO PACKAGING SPECIFICATION: PK-31300-438
5. MATES WITH MOLEX MX150 CONNECTORS 33471, 33481, 33472, 33482, 33476, 33486.
6. DO NOT USE SEAL PLUG IN A SHORTING BAR CAVITY LOCATION THAT IS MATED TO SHORTING BAR MALE TERMINAL P/N (31296-0008). A STUBBING CONDITION WOULD OCCUR.
7. SEAL PLUG WILL LOCK INTO HOUSING LOCKING FINGER WHEN INSTALLED IN PROPER ORIENTATION. USE PUSH, CLICK, PULL METHOD FOR INSTALLATION.
8. PLEASE REFER TO MX150 USER MANUAL FOR APPLICATION AND PROCESSING INFO AT WWW.MOLEX.COM.

ENTER DESCRIPTION EC NO: UAU2007-0167 DRAWN BY: HHS 2006/09/14 CHECKED BY: HHS 2006/09/14 APPR: SHARCEAU 2006/09/14	QUALITY SYMBOLS	GENERAL TOLERANCES (UNLESS SPECIFIED)		DIMENSION STYLE		SCALE	DESIGN UNITS	THIRD ANGLE PROJECTION		
	▼=0 ▽=0	4 PLACES ± --- ± ---	mm	INCH	MM ONLY		4:1	METRIC	MX150 CAVITY PLUG SEALED MOLEX INCORPORATED	
		3 PLACES ± --- ± ---			DRAWN BY	DATE				
		2 PLACES ± 0.10 ± ---			CHECKED BY	DATE				
1 PLACE ± 0.3 ± ---			APPROVED BY	DATE						
		ANGULAR ± 3 °		SHARCEAU 10/27/05						
	DRAFT WHERE APPLICABLE MUST REMAIN WITHIN DIMENSIONS		MATERIAL NO.		DOCUMENT NO.		SHEET NO.			
	SIZE D		343450001		SD-34345-001		1 OF 1			
THIS DRAWING CONTAINS INFORMATION THAT IS PROPRIETARY TO MOLEX INCORPORATED AND SHOULD NOT BE USED WITHOUT WRITTEN PERMISSION										