

PLEASE CHECK WWW.MOLEX.COM FOR LATEST PART INFORMATION

Part Number: [0191410065](#)
Status: **Active**
Description: Krimptite™ Spade Tongue Terminal for 14-16 AWG Wire

Documents:

[Drawing \(PDF\)](#) [RoHS Certificate of Compliance \(PDF\)](#)

Agency Certification

CSA LR18689
 UL E32244

General

Product Family Ring and Spade Terminals
 Series [19141](#)
 Crimp Quality Equipment Yes
 Mil-Spec N/A
 Product Name Krimptite™
 Type Spade

Physical

Barrel Type Closed
 Insulation None
 Material - Plating Mating Tin
 Packaging Type Bag
 Plating min: Mating (µin) 100
 Plating min: Mating (µm) 2.5
 Plating min: Termination (µin) 100
 Plating min: Termination (µm) 2.5
 Stud Size 10 (M5)
 Wire Size AWG 14, 16
 Wire Size mm² 1.30 - 2.00

Material Info

Old Part Number BB-127-10

Reference - Drawing Numbers

Sales Drawing BBCD10302, SD-19141-001

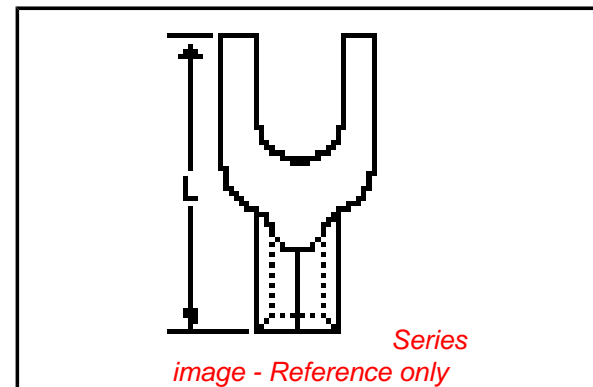

EU RoHS

ELV and RoHS Compliant
REACH SVHC Contains SVHC: No
Halogen-Free Status

China RoHS



Need more information on product environmental compliance?

Email productcompliance@molex.com
 For a multiple part number RoHS Certificate of Compliance, [click here](#)

Please visit the [Contact Us](#) section for any non-product compliance questions.

Search Parts in this Series

[19141Series](#)

Application Tooling | [FAQ](#)

Tooling specifications and manuals are found by selecting the products below. Crimp Height Specifications are then contained in the Application Tooling Specification document.

Global

| Description | Product # |
|--|----------------------------|
| Hand Crimp Tool | 0640030100 |
| Crimp Head for the AT-200™ Pneumatic Hand Tool | 0640070100 |

NOTES:

- ① MAT'L: COPPER (STOCK TKN. $\frac{.031}{.79}$) $\pm .001$
- PLATING: ELECTRO-TIN (.0003 MIN.)

STUD SIZES: ($\pm .005$)

- 02 = .094
- 04 = .119
- 06 = .146
- 08 = .173
- 10 = .198
- 14 = .265
- 56 = .328
- 38 = .390

"UL" LISTING *E32244
 "CSA" LISTING #18689

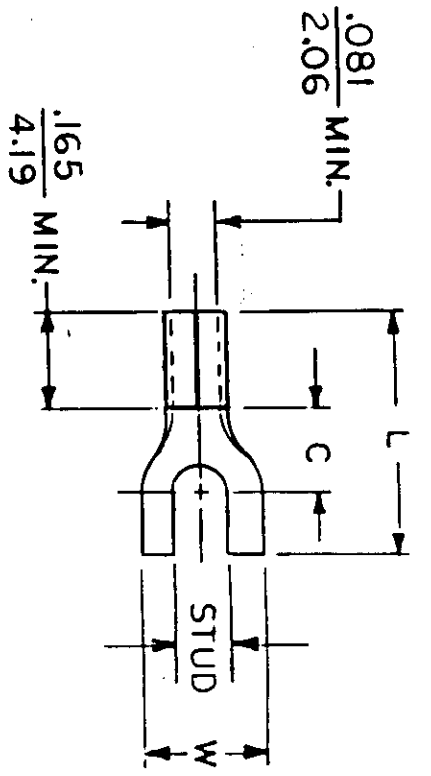

ALL DIMENSIONS = $\frac{\text{INCHES}}{\text{M M}}$

WIRE SIZE: 16 - 14 AWG
 1.0 - 2.5 MM²

| PART NUMBER | "W" ±.010 | "C" MIN. | "L" MAX. | AVAILABLE STUD SIZES | TITLE: | |
|---|---------------------|---------------------|----------------------|----------------------|-----------------------|-----------------------|
| | | | | | SPADE TONGUE TERMINAL | KRIMP TITE 100-SERIES |
| BB-107- | $\frac{.245}{6.22}$ | $\frac{.209}{5.31}$ | $\frac{.565}{14.35}$ | 04, 06 | DRWN. BY: <i>h</i> | DATE: 10-18-84 |
| BB-124- | $\frac{.295}{7.49}$ | $\frac{.211}{5.36}$ | $\frac{.564}{14.33}$ | 04, 06, 08 | CHKD. BY: <i>GT</i> | DATE: 11-2-84 |
| BB-127- | $\frac{.362}{9.19}$ | $\frac{.269}{6.83}$ | $\frac{.687}{17.45}$ | 06, 08, 10 | APPRD. BY: | |
| DIMENSIONAL TOLERANCES UNLESS OTHERWISE SPECIFIED | | | | | SCALE: NTS | |
| FRAC. DEC. ANG. | | | | | | |



DWG. NO. A CUSTOMER DWG.

| 10 | 9 | 8 | 7 | 6 | 5 | | | |
|-----------------|------------------|-----------|------------------|------------------|--------------|--------------|-------------|--------------|
| MATERIAL NUMBER | ALTERNATE NUMBER | STUD SIZE | "S" ±.005/(0.13) | "W" ±.010/(0.25) | "C" MIN (A1) | "L" MAX (A1) | PACKAGING | |
| 191410050 | BB-107-04 | 4 | .119/(3.02) | .245/(6.22) | .209/(5.31) | .565/(14.35) | LOOSE PIECE | |
| 191410052 | BB-107-06 | 6 | .146/(3.71) | .245/(6.22) | .209/(5.31) | .565/(14.35) | | |
| 191410054 | BB-124-04 | 4 | .119/(3.02) | .295/(7.49) | .211/(5.36) | .564/(14.33) | | |
| 191410056 | BB-124-06 | 6 | .146/(3.71) | .295/(7.49) | .211/(5.36) | .564/(14.33) | | |
| 191410058 | BB-124-08 | 8 | .173/(4.39) | .295/(7.49) | .211/(5.36) | .564/(14.33) | | |
| 191410061 | BB-127-06 | 6 | .146/(3.71) | .362/(9.19) | .269/(6.83) | .687/(17.45) | | |
| 191410063 | BB-127-08 | 8 | .173/(4.39) | .388/(9.85) | .269/(6.83) | .687/(17.45) | | |
| 191410065 | BB-127-10 | 10 | .198/(5.03) | .388/(9.85) | .269/(6.83) | .687/(17.45) | | |
| 191410051 | BB-107-04T | 4 | .119/(3.02) | .245/(6.22) | .209/(5.31) | .565/(14.35) | | TAPE MOUNTED |
| 191410053 | BB-107-06T | 6 | .146/(3.71) | .245/(6.22) | .209/(5.31) | .565/(14.35) | | |
| 191410055 | BB-124-04T | 4 | .119/(3.02) | .295/(7.49) | .211/(5.36) | .564/(14.33) | | |
| 191410057 | BB-124-06T | 6 | .146/(3.71) | .295/(7.49) | .211/(5.36) | .564/(14.33) | | |
| 191410059 | BB-124-08T | 8 | .173/(4.39) | .295/(7.49) | .211/(5.36) | .564/(14.33) | | |
| 191410062 | BB-127-06T | 6 | .146/(3.71) | .362/(9.19) | .269/(6.83) | .687/(17.45) | | |
| 191410064 | BB-127-08T | 8 | .173/(4.39) | .388/(9.85) | .269/(6.83) | .687/(17.45) | | |
| 191410066 | BB-127-10T | 10 | .198/(5.03) | .388/(9.85) | .269/(6.83) | .687/(17.45) | | |

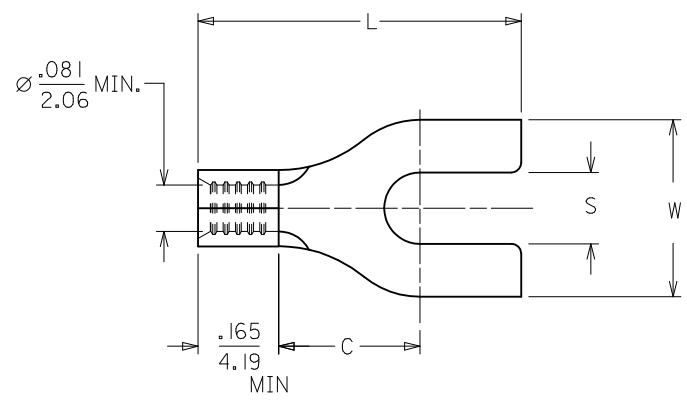
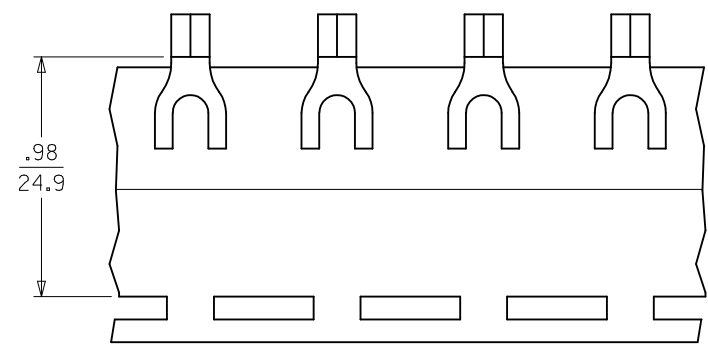

CUSTOMER DRAWING

NOTES:
 1. MATERIAL: COPPER .031/(.79) THICK.
 2. PLATING: ELECTRO-TIN.
 3. PARTS ARE ROHS COMPLIANT. (A1)

| | | | | | | | |
|---|-----------------|---|-----------------|---|--------------|--|------------------|
| ADD MISSING TOLRNC EC NO: WNA2010-0362 DRAWN: THRODAHL 2009/12/21 CHKD: JMACNEIL 2009/12/21 APPR: JMACNEIL 2009/12/21 A1 | QUALITY SYMBOLS | GENERAL TOLERANCES (UNLESS SPECIFIED) | DIMENSION STYLE | SCALE | DESIGN UNITS | THIRD ANGLE PROJECTION | |
| | ▼=0 ∇=0 | mm INCH 4 PLACES ± --- ± --- 3 PLACES ± --- ± .005 2 PLACES ± 0.13 ± .01 1 PLACE ± 0.25 ± --- ANGULAR ± ---° | IN/MM | --- | INCH | DRAWN BY DATE HEB 1999/11/12 CHECKED BY DATE RWD 1999/11/12 APPROVED BY DATE RWD 1999/11/12 | |
| | | DRAFT WHERE APPLICABLE MUST REMAIN WITHIN DIMENSIONS | SEE CHART | TITLE SPADE TONGUE TERMINAL 16-14 AWG KRIMPTITE SERIES | | MOLEX INCORPORATED DOCUMENT NO. SD-19141-001 | SHEET NO. 1 OF 1 |
| | | | | THIS DRAWING CONTAINS INFORMATION THAT IS PROPRIETARY TO MOLEX INCORPORATED AND SHOULD NOT BE USED WITHOUT WRITTEN PERMISSION | | | |