

FEATURES

- Cispr 22'B', Vcci'B', Fcc'B' Compliance
- Light Weight: 140g only
- Efficiency 67%~77%
- Over-Voltage Protective Installation
- Short-circuit Protective Installation
- Protection Type: Auto-Recover
- Operating Temperature 0°C~40°C



SPECIFICATION

Item \ Model	SP9715	* SP9715A	* SP9715B	SP9715C	SP9715D	
Output Voltage	5V	6V	9V	12V	15V	
Output Current	2.0A	1.8A	1.5A	1.2A	1.0A	
Input Voltage	AC 90~264V			AC 90~132V or 180~264V		
Input Frequency	47~63Hz					
Input Current	0.3A or 0.6A Maximum					
Inrush Current	30A Maximum					
Line Regulation	2% Maximum					
Load Regulation	± 5%					
Ripple & Noise	1% Maximum					
Efficiency	67% Typical	69% Typical	72% Typical	76% Typical	77% Typical	
Temperature Coefficient	0.05%/°C					
Over-Voltage Protection	10V Maximum	12V Maximum	18V Maximum	24V Maximum	30V Maximum	
Operating Temperature	0~40°C					
Storage Temperature	-20~85°C					
Safety Description	Fig. A	UL, CUL, CE, PSE	---	---	UL, CUL, CB, LPS, CE, BSMI, PSE	UL, CUL, CB, LPS, CE, BSMI, PSE
	Fig. B	CE	---	---	RCM, CB, LPS, CE, BSMI	CE
	Fig. C	BSI, CE	---	---	BSI, CB, LPS, CE, BSMI	CE
	Fig. D	TUV, CB, CE	---	---	TUV, CB, LPS, CE, BSMI	TUV, CB, LPS, CE, BSMI
	Fig. E	---	---	---	---	---

(*): Under Development (I/P): In Process

Bothhand USA. e-mail: sales@bothhandusa.com <http://www.bothhand.com>

462 Boston St - Topsfield, MA 01983 - Phone: 978-887-8050 - Fax: 978-887-5434

ORDERING INFORMATION

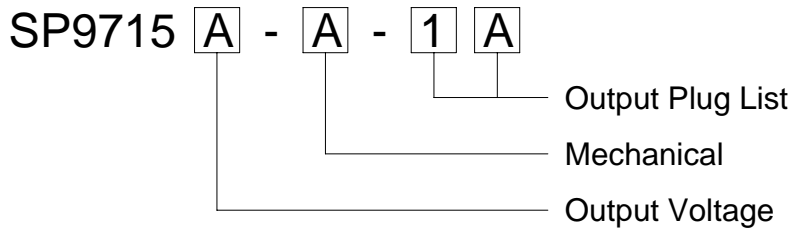

MECHANICAL

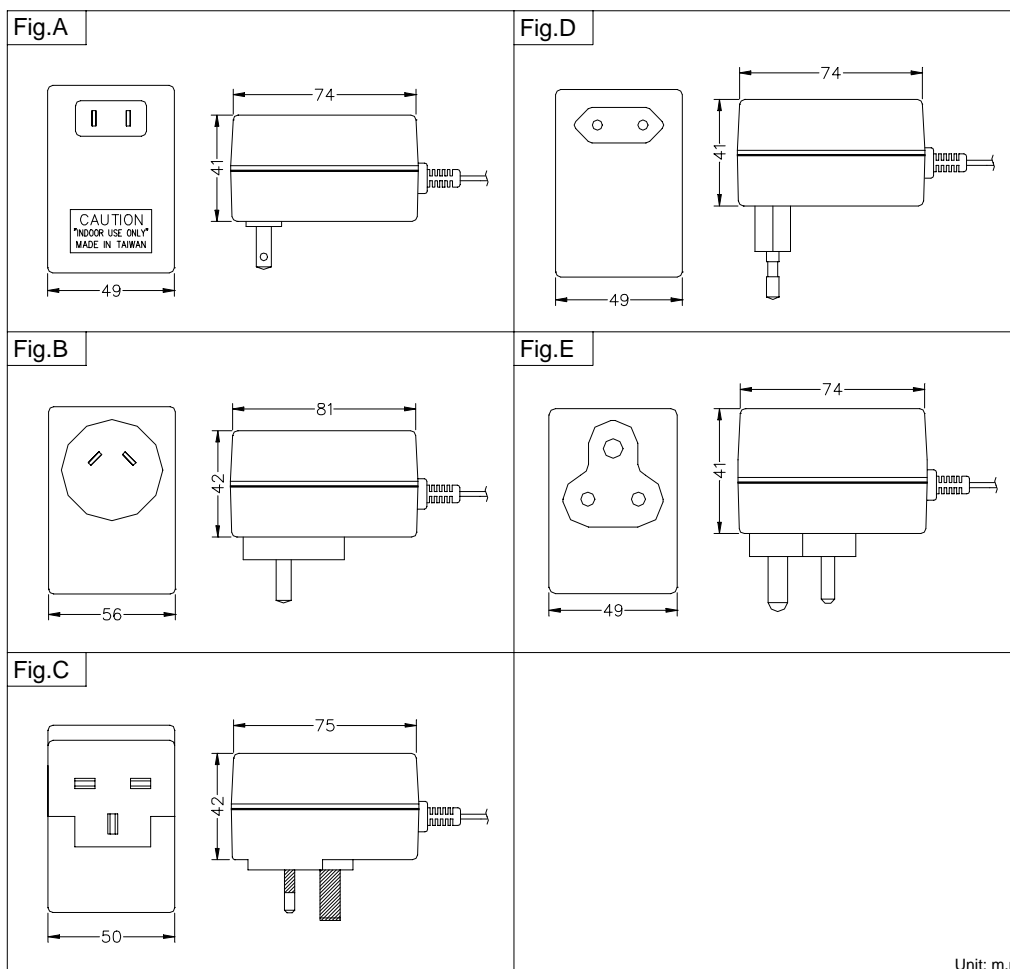

Standard Output Cable:
 5V~6V: 18AWG, UL SPT-1, 1800mm
 9V~15V: 20AWG, UL 2468, 1800mm



Bothhand USA. e-mail: sales@bothhandusa.com <http://www.bothhand.com>

462 Boston St - Topsfield, MA 01983 - Phone: 978-887-8050 - Fax: 978-887-5434