

1. PART NO. EXPRESSION :

PDC1307-1R5MF
 (a) (b) (c) (d)(e)

- (a) Series code
- (b) Dimension code
- (c) Inductance code : 1R5 = 1.5uH
- (d) Tolerance code : K = ±10%, M = ±20%
- (e) F : Lead Free

2. CONFIGURATION & DIMENSIONS :

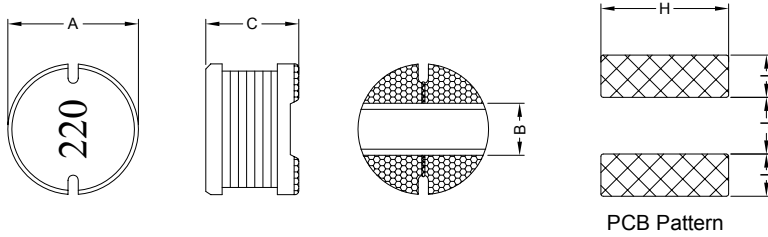

Unit : mm

A	B	C	H	I	J
13.0±0.5	4.5 Ref.	7.0±0.3	14.0 Ref.	4.75 Ref.	4.5 Ref.

3. SCHEMATIC :

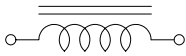

4. MATERIALS :

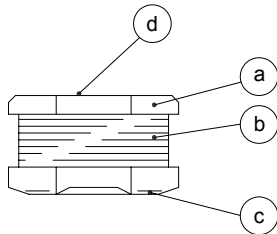

- (a) Core : DRT Ferrite Core
- (b) Wire : Enamelled Copper Wire
- (c) Terminal : Ag+Cu+Ni+Sn
- (d) Ink : Bon Margue

5. GENERAL SPECIFICATION :

- a) Ambient temp. : 20°C
- b) Operating temp. : -20°C to 80°C
- c) Heat Rated Current (Irms) : Will cause the coil temp. rise approximately ΔT=40°C.
- d) Saturation Current (Isat) : Will cause L₀ to drop approximately 10%.



RoHS Compliant

NOTE : Specifications subject to change without notice. Please check our website for latest information.

12.05.2008



SUPERWORLD ELECTRONICS (S) PTE LTD

6. ELECTRICAL CHARACTERISTICS :

Part No.	Inductance (μ H)	Test Frequency (Hz)	DCR (m Ω) Max.	I _{rms} (A) Max.	I _{sat} (A) Max.
PDC1307-1R5MF	1.5 \pm 20%	0.1V / 100K	5.0	9.50	22.0
PDC1307-2R2MF	2.2 \pm 20%	0.1V / 100K	6.0	9.00	20.0
PDC1307-2R7MF	2.7 \pm 20%	0.1V / 100K	8.0	8.20	18.0
PDC1307-3R3MF	3.3 \pm 20%	0.1V / 100K	8.7	7.50	17.0
PDC1307-4R7MF	4.7 \pm 20%	0.1V / 100K	11.8	7.00	15.0
PDC1307-5R6MF	5.6 \pm 20%	0.1V / 100K	15.0	6.50	13.0
PDC1307-6R8MF	6.8 \pm 20%	0.1V / 100K	17.0	6.00	11.5
PDC1307-8R2MF	8.2 \pm 20%	0.1V / 100K	19.0	5.80	10.8
PDC1307-100MF	10.0 \pm 20%	0.1V / 100K	23.0	5.60	10.2
PDC1307-120MF	12.0 \pm 20%	0.1V / 100K	30.0	4.80	9.00
PDC1307-150MF	15.0 \pm 20%	0.1V / 100K	34.0	4.50	8.00
PDC1307-180MF	18.0 \pm 20%	0.1V / 100K	40.0	4.20	7.50
PDC1307-220MF	22.0 \pm 20%	0.1V / 100K	47.0	3.60	7.00
PDC1307-270MF	27.0 \pm 20%	0.1V / 100K	60.0	3.30	6.00
PDC1307-330KF	33.0 \pm 10%	0.1V / 100K	70.0	3.10	5.50
PDC1307-390KF	39.0 \pm 10%	0.1V / 100K	75.0	2.90	5.10
PDC1307-470KF	47.0 \pm 10%	0.1V / 100K	82.0	2.70	4.70
PDC1307-560KF	56.0 \pm 10%	0.1V / 100K	112.0	2.50	4.30
PDC1307-680KF	68.0 \pm 10%	0.1V / 100K	120.0	2.30	4.00
PDC1307-820KF	82.0 \pm 10%	0.1V / 100K	140.0	2.10	3.70
PDC1307-101KF	100.0 \pm 10%	0.1V / 100K	180.0	1.90	3.20
PDC1307-121KF	120.0 \pm 10%	0.1V / 100K	230.0	1.80	3.00
PDC1307-151KF	150.0 \pm 10%	0.1V / 100K	260.0	1.60	2.70
PDC1307-181KF	180.0 \pm 10%	0.1V / 100K	350.0	1.50	2.40
PDC1307-221KF	220.0 \pm 10%	0.1V / 100K	380.0	1.30	2.20
PDC1307-271KF	270.0 \pm 10%	0.1V / 100K	480.0	1.20	1.90
PDC1307-331KF	330.0 \pm 10%	0.1V / 100K	520.0	1.10	1.70
PDC1307-391KF	390.0 \pm 10%	0.1V / 100K	650.0	1.00	1.60
PDC1307-471KF	470.0 \pm 10%	0.1V / 100K	800.0	0.90	1.50
PDC1307-561KF	560.0 \pm 10%	0.1V / 100K	1100.0	0.85	1.30
PDC1307-681KF	680.0 \pm 10%	0.1V / 100K	1150.0	0.80	1.20
PDC1307-821KF	820.0 \pm 10%	0.1V / 100K	1600.0	0.75	1.10
PDC1307-102KF	1000.0 \pm 10%	0.1V / 100K	1700.0	0.65	1.00

NOTE : Specifications subject to change without notice. Please check our website for latest information.

12.05.2008



SUPERWORLD ELECTRONICS (S) PTE LTD

7. PACKAGING INFORMATION : (Unit : mm)

7-1. Reel & Tape Dimension

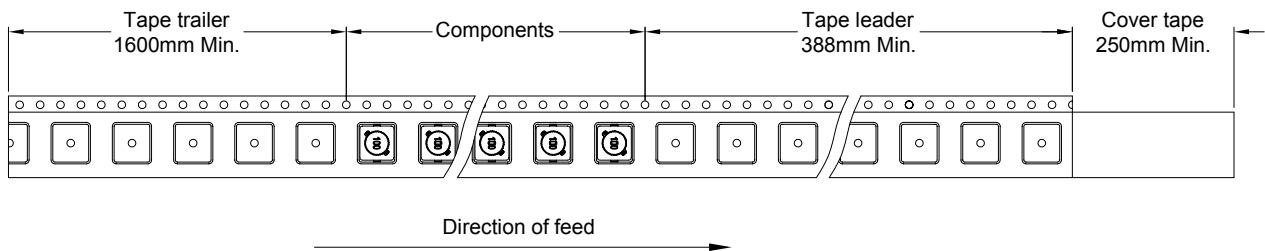
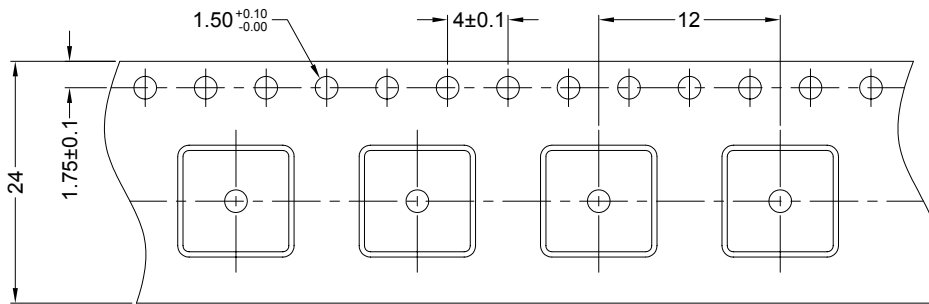
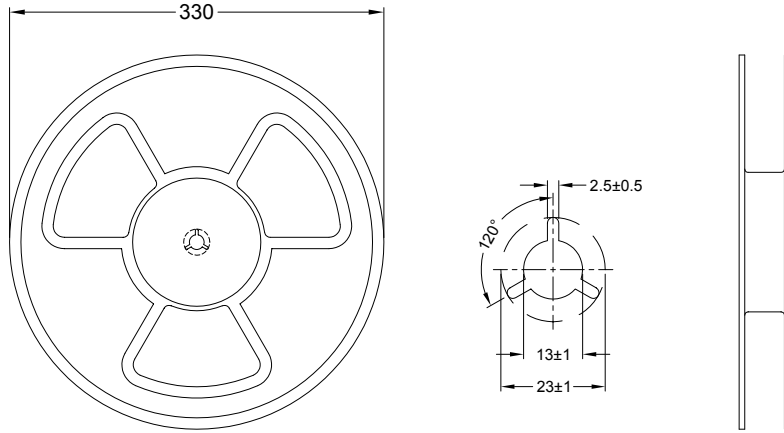

7-2. Quantity & G.W. per package

SERIES	INNER : REEL			OUTER : CARTON		
	Q'TY (PCS)	G.W. (Kg)	STYLE	Q'TY (PCS)	G.W. (Kg)	SIZE (cm)
PDC1307	400	1.8	13-24	3200	17	36 x 36 x 40



RoHS Compliant

NOTE : Specifications subject to change without notice. Please check our website for latest information.

12.05.2008



SUPERWORLD ELECTRONICS (S) PTE LTD

7-3. Tearing Off Force

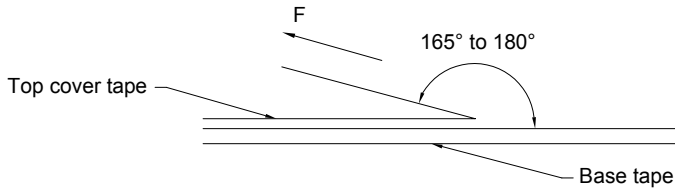

The force for tearing off cover tape is 10 to 60 grams in the arrow direction.



RoHS Compliant

NOTE : Specifications subject to change without notice. Please check our website for latest information.

12.05.2008



SUPERWORLD ELECTRONICS (S) PTE LTD