

IEC Plug I, Cord Connector (Rewireable), Straight

**Description**

Screwing cable terminal, Pin temperature 70 °C, Protection class I, Cable

- We recommend for new applications the type [4796](#)
- Note: Please order pvc strain relief separately, mating strain reliefs please find under accessories.

Approvals

- VDE License Number: 40008629
- UL License Number: E45115
- CSA License Number: 27324

Technical Data

| | |
|---------------------------|---|
| Ratings IEC | 16 A / 250 VAC; 50 Hz |
| Ratings UL/CSA | 21 A / 250 VAC; 60 Hz |
| Dielectric Strength | > 4 kVAC between L-N > 2 kVAC between L/N-PE (1 min/50 Hz) |
| Allowable Operation Temp. | -25 °C to 70 °C |
| Degree of Protection | from front side IP 40 acc. to IEC 60529 |
| Protection Class | Suitable for appliances with protection class 1 acc. to IEC 61140 |
| Terminal | Screw Clamp |
| Material: Housing | UL 94V-0 |

References

[General Product Information](#)

Weblinks

[Approvals](#), [RoHS](#), [CHINA-RoHS](#), [Mating Connectors](#), [e-Store](#), [Distributor-Stock-Check](#), [Accessories](#)

Plug

I acc. to IEC/EN 60320-1
UL 498, CSA C22.2 no. 42 (for cold conditions) pin-temperature 70 °C, 16 A, Protection Class 1

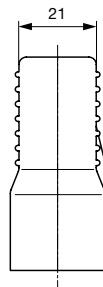
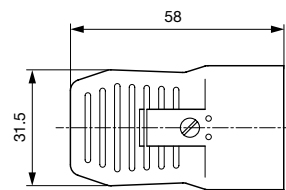
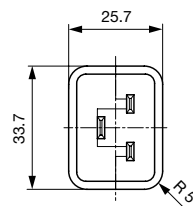
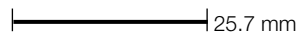
Dimensions

Config. Code

Product Configurator

0106 - H - A B C 0 - D - E J

The characters are placeholders for the correspondingly keys of selections from the key tables.

0106 - H - A B C 0 - D - E J = Type

| Type | Configuration key |
|--------------------|-------------------|
| protection class 1 | X |

0106 - H - A B C 0 - D - E J = Terminals

| Terminal L | Configuration key |
|----------------|-------------------|
| screw terminal | A |

0106 - H - A B C 0 - D - E J = Terminals

| Terminal N | Configuration key |
|----------------|-------------------|
| screw terminal | A |

Symbols similar as in table A

0106 - H - A B C 0 - D - E J = Terminals

| Terminal Ground | Configuration key |
|-----------------|-------------------|
| screw terminal | A |

Symbols similar as in table A

0106 - H - A B C 0 - D - E J = Color

| Color | Configuration key |
|-----------------------|-------------------|
| jet black; RAL9005 | A |
| silver grey; RAL7001 | B |
| pure white; RAL9010 | D |
| standard color: black | |

0106 - H - A B C 0 - D - E J = Style

| Style | Configuration key |
|-------------------|-------------------|
| for cord assembly | 8 |

0106 - H - A B C 0 - D - E J = Condition

| Condition | Configuration key |
|--------------|-------------------|
| assembled | 1 |
| disassembled | 2 |

Variants

| Config. Code | Description | Order Number |
|------------------|--|--------------|
| 0106-X-AAA0-A-81 | 0106, IEC Plug, I, 70°C, version: 1, L: screw terminal, N: screw terminal, ground: screw terminal, color: jet black; RAL9005, design: for cord assembly, condition:assembled | 4310.0008 |
| 0106-X-AAA0-B-81 | 0106, IEC Plug, I, 70°C, version: 1, L: screw terminal, N: screw terminal, ground: screw terminal, color: silver grey; RAL7001, design: for cord assembly, condition:assembled | 4310.0009 |

The listed variants should be available from stock. Other versions on request www.schurter.com/contact

Packaging unit 50 Pcs

Accessories

Description



HN 14.109
PVC Strain Relief



HN 14.41
PVC Strain Relief



HN 14.43
PVC Strain Relief

Mating Outlets/Connectors

Category / Description



[Appliance inlets/-outlets Overview complete](#)

| | |
|---|------|
| Plug Coupler IEC C20 / IEC J, Screw-on Mounting | 4730 |
|---|------|

[Appliance inlets/-outlets further types to 0106](#)



[Appliance Outlet Overview complete](#)

| | |
|---|------|
| IEC Appliance Outlet J, Screw-on Mounting, Front Side, Solder or Quick-connect Terminal | 0723 |
|---|------|

| | |
|---|------|
| IEC Appliance Outlet J, Snap-in/Screw-on Mounting, Front Side, Solder or Quick-connect Terminal | 4797 |
|---|------|

| | |
|--|------|
| IEC Appliance Outlet J, Snap-in Mounting, Front Side, Quick-connect Terminal | 5013 |
|--|------|

| | |
|---|------|
| IEC Appliance Outlet J, Screw-on Mounting, Front Side, Quick-connect Terminal | 5016 |
|---|------|

| | |
|---|------|
| IEC Appliance Outlet J, Screw-on Mounting, Front Side, Quick-connect Terminal | 5017 |
|---|------|

[Appliance Outlet further types to 0106](#)

...

[Connector Overview complete](#)



| | |
|---|------|
| IEC Connector C19, Rewireable, Straight | 0104 |
|---|------|

| | |
|---------------------------------------|------|
| IEC Connector C19, Rewireable, Angled | 1651 |
|---------------------------------------|------|

| | |
|---|------|
| IEC Connector C19, Rewireable, Straight | 1652 |
|---|------|

| | |
|---------------------------------------|------|
| IEC Connector C19, Rewireable, Angled | 4790 |
|---------------------------------------|------|

| | |
|---|------|
| IEC Connector C19, Rewireable, Straight | 4795 |
|---|------|

[Connector further types to 0106](#)