

Features

- High performance magnetics for puls absorption (20dB attenuation at 1kV pulse).
- High insertion loss characteristics.

Applications

- PCs, Copiers, Printers, Office appliances, Measuring devices and Control systems.
- SUP-E□H-EP Series (Vinyl lead) (1~3A)



Safety Agency : Standard		File No.
UL	: UL-1283	E78644
CSA	: C22.2, No.8-M1986	LR60681
SEMKO	: EN133200	SE/0142-13 SE/0142-14

The "ENCE" mark is a common European product certification mark based on testing to harmonised European safety standard.

- SUP-E□H-EP Series (Screw terminal) (5~15A, 20A)

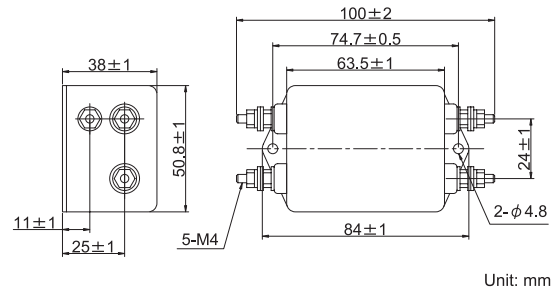
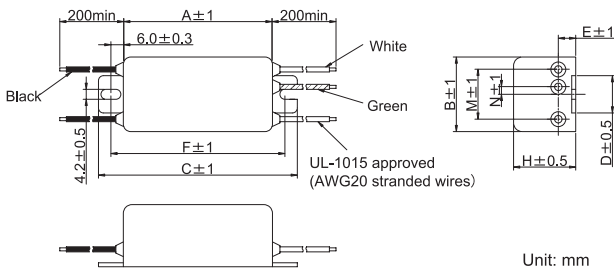

Dimensions

Model number	A	B	C	D	E	F	H	M	N
SUP-E1H-EP	60	30	80	15	7.0	70	25	20	3
SUP-E2H-EP	60	30	80	15	7.0	70	25	20	3
SUP-E3H-EP	60	40	80	20	7.0	70	25	25	4

Circuit

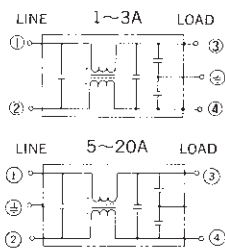

Static characteristics

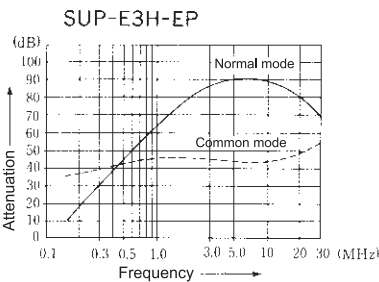

TVSS Characteristics Puls width 800nsec

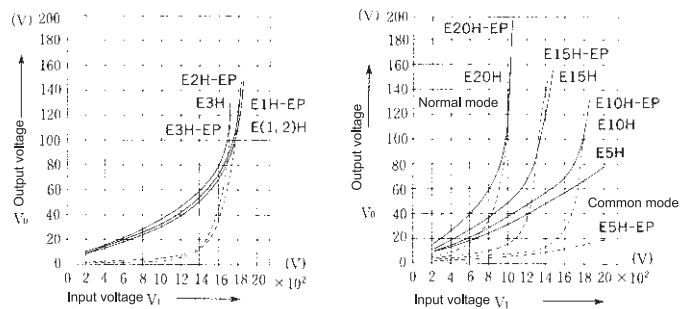

Electrical Specifications

Rated Voltage 250VAC

Safety Agency	Model Number	Rated Current (A)	Test Voltage	Insulation Resistance	Leakage Current (max)	Voltage Drop (max)	Temperature Rise (max)	Operating Temperature (°C)	Insertion losses	
									Normal Mode (MHz)	Common Mode (MHz)
	SUP-E1H-EP	1	Line to Line 1100Vrms 50/60Hz 60sec Line to Ground 2240Vrms 50/60Hz 60sec	Line to Line 3000MΩmin Line to Ground 6000MΩmin (at 500V _{DC})	0.6mA (at 250Vrms 60Hz)	1.0Vrms	30deg	-25 ~ +55	0.7 ~ 30	0.7 ~ 30
	SUP-E2H-EP	2								0.7 ~ 30
	SUP-E3H-EP	3								0.7 ~ 30
	SUP-E5H-EP	5								0.8 ~ 30
	SUP-E10H-EP	10								1.0 ~ 30
	SUP-E15H-EP	15								1.5 ~ 30
SUP-E20H-EP	20	6.0 ~ 30								

Guaranteed attenuation is more than 40dB in normal mode, more than 25dB at 1~3A and more than 35dB at 5~20A in common mode.