



Part Number	Package	Application	Last Modified
802-RF869.0M-A	3.0 x 3.0 SMD	Wireless	Mar. 2, 2007

TYPE :
Wireless, RF SAW Filter



PART NUMBER :
802-RF869.0M-A

OPERATING CONDITIONS / ELECTRICAL CHARACTERISTICS

PARAMETERS	Condition	Minimum	Typical	Maximum	Units
Center Frequency (Fo)	-	-	869.0	-	MHz
Maximum Insertion Loss	868.0~ 870.0 MHz	-	2.8	4.0	dB
Stop Band Attenuation:	825.0~ 828.0 MHz	40	47	-	dB
	835.0~ 842.0 MHz	30	39	-	
	891.0~ 894.0MHz	30	42	-	
	910.0~ 913.0 MHz	40	47	-	
Source Impedance (single ended)*	-	-	50	-	ohm
Load Impedance (single ended)*	-	-	50	-	ohm
Amplitude Ripple	868.0~ 870.0 MHz	-	0.2	1.5	dBp-p
Maximum DC Voltage	-	-	-	3	V
Maximum Input Power	-	-	-	17	dBm
Operating Temperature	-	-10	-	+60	°C

* No Matching Network(Ref. Testing Enviroment Circuit as shown below)

PACKAGE OUTLINE (mm)

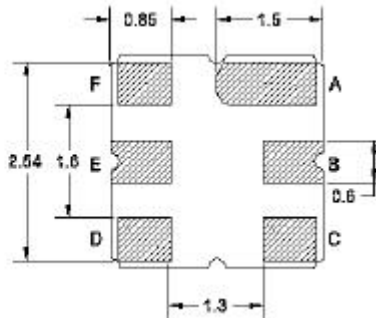
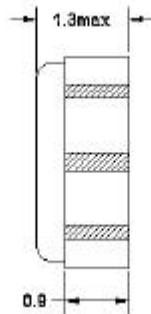
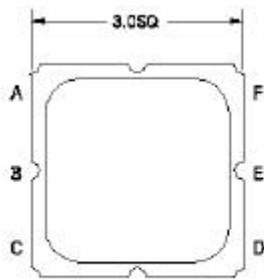

PIN LAYOUT	
A	Ground
B	Out
C	Ground
D	Ground
E	In
F	Ground

TEST FIXTURE

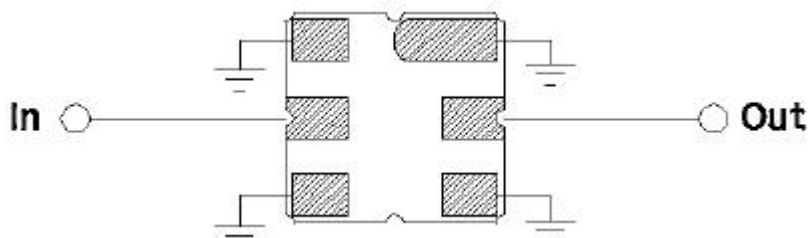

Load/ Source Impedance = 50 ohms

FREQUENCY RESPONSE

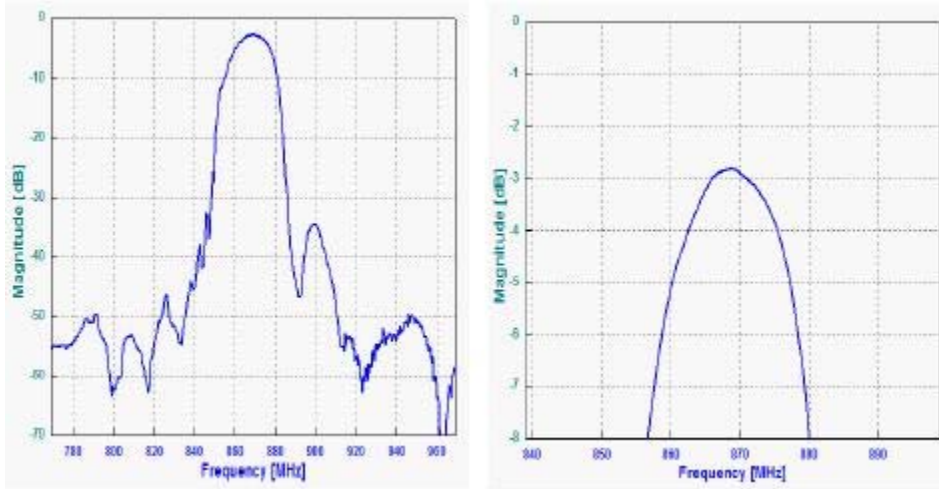

WIDE BAND

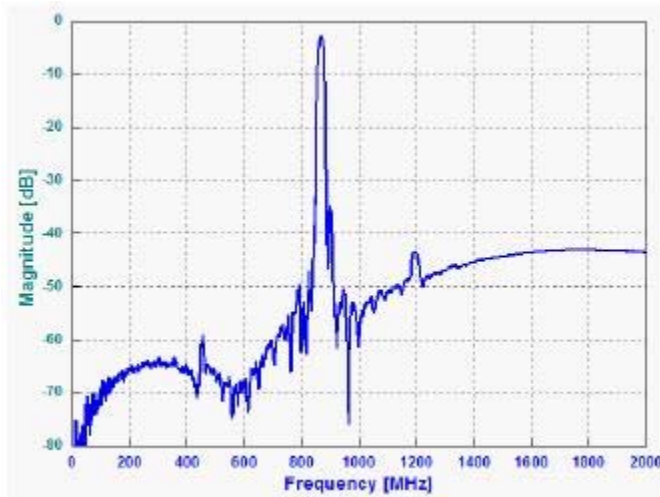

SMITH CHART

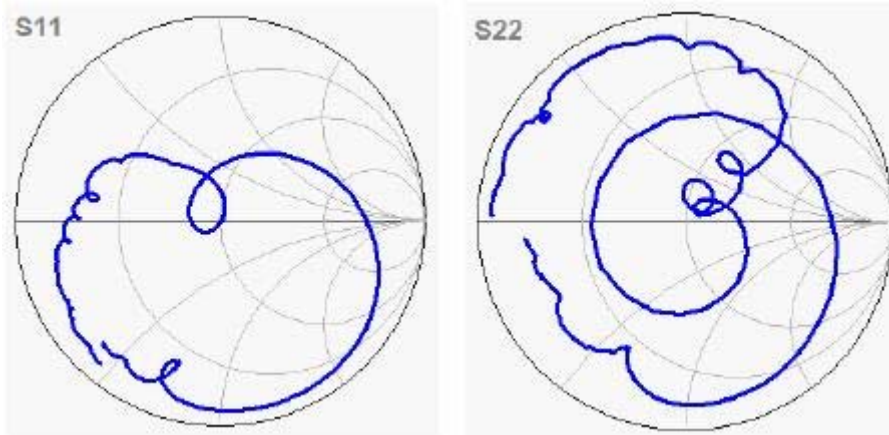

Oscilent Corporation - CALL **949.252.0522**

Part No.: 802-RF869.0M-A

18195 East McDermott Street, Building D, Irvine, CA 92614, USA
Fax: 949.252.0599, E-Mail: Sales@Oscilent.com

