

HER101 THRU HER108

HIGH EFFICIENCY PLASTIC RECTIFIER

VOLTAGE: 50-1000V

CURRENT: 1.0A

FEATURES

- Low power loss, high efficiency
- Low leakage
- Low forward voltage
- High current capability
- High speed switching
- High surge capability
- High reliability

MECHANICAL DATA

- **Case:** Molded plastic
- **Epoxy:** UL94V-0 rate flame retardant
- **Lead:** MIL-STD- 202E, Method 208 guaranteed
- **Polarity:**Color band denotes cathode end
- **Mounting position:** Any
- **Weight:** 0.33 grams

DO-41

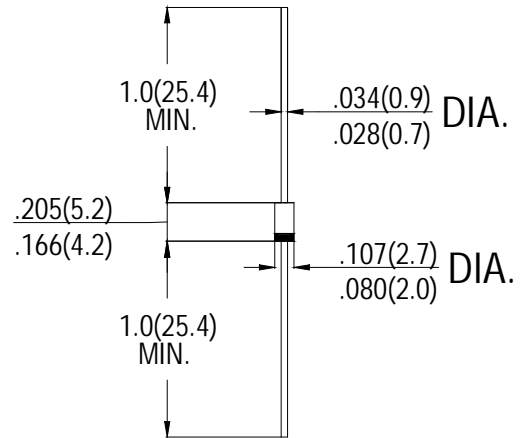

Dimensions in inches and (millimeters)

MAXIMUM RATINGS AND ELECTRICAL CHARACTERISTICS

Ratings at 25°C ambient temperature unless otherwise specified.

Single phase, half wave, 60Hz, resistive or inductive load.

For capacitive load, derate current by 20%.

	SYMBOL	HER 101	HER 102	HER 103	HER 104	HER 105	HER 106	HER 107	HER 108	units
Maximum Recurrent Peak Reverse Voltage	V_{RRM}	50	100	200	300	400	600	800	1000	V
Maximum RMS Voltage	V_{RMS}	35	70	140	210	280	420	560	700	V
Maximum DC Blocking Voltage	V_{DC}	50	100	200	300	400	600	800	1000	V
Maximum Average Forward rectified Current at $T_A=50^\circ\text{C}$	I_o	1.0								A
Peak Forward Surge Current 8.3ms single half sine-wave superimposed on rate load (JEDEC method)	I_{FSM}	30								A
Maximum Instantaneous forward Voltage at 1.0A DC	V_F	1.0		1.3		1.7				V
Maximum DC Reverse Current at Rated DC Blocking Voltage $T_A=25^\circ\text{C}$	I_R	5.0								μA
Maximum Full Load Reverse Current Full Cycle Average, .375"(9.5mm) lead length at $T_L=55^\circ\text{C}$		100								
Maximum Reverse Recovery Time (Note 1)	t_{rr}	50				75				nS
Typical Junction Capacitance (Note 2)	C_J	15				12				pF

Notes: 1. Test Conditions: $I_F=0.5\text{A}$, $I_R=1.0\text{A}$, $I_{RR}=0.25\text{A}$

2. Measured at 1MHz and applied reverse voltage of 4.0 volts