

Silicon PNP Power Transistors

2SA1443

DESCRIPTION

- With TO-220Fa package
- Low collector saturation voltage
- Fast switching speed
- High DC current gain

APPLICATIONS

- High speed power switching applications

PINNING

PIN	DESCRIPTION
1	Emitter
2	Collector
3	Base

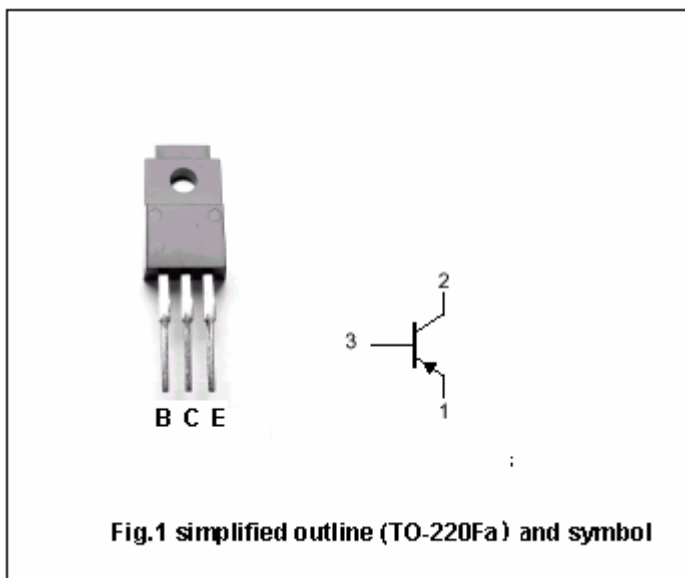

Absolute maximum ratings(Ta=25)

SYMBOL	PARAMETER	CONDITIONS	VALUE	UNIT
V_{CBO}	Collector-base voltage	Open emitter	-100	V
V_{CEO}	Collector-emitter voltage	Open base	-60	V
V_{EBO}	Emitter-base voltage	Open collector	-7	V
I_C	Collector current		-10	A
I_{CM}	Collector current-peak		-20	A
I_B	Base current		-5	A
P_C	Collector power dissipation	$T_C=25$	30	W
		$T_a=25$	2	
T_j	Junction temperature		150	
T_{stg}	Storage temperature		-55~150	

Silicon PNP Power Transistors

2SA1443

CHARACTERISTICS

T_j=25 unless otherwise specified

SYMBOL	PARAMETER	CONDITIONS	MIN	TYP.	MAX	UNIT
V _{CEO(SUS)}	Collector-emitter sustaining voltage	I _C =-6A, I _B =-0.6A; L=1mH	-60			V
V _{CEsat-1}	Collector-emitter saturation voltage	I _C =-6A, I _B =-0.3A			-0.3	V
V _{CEsat-2}	Collector-emitter saturation voltage	I _C =-8A, I _B =-0.4A			-0.5	V
V _{BEsat-1}	Base-emitter saturation voltage	I _C =-6A, I _B =-0.3A			-1.2	V
V _{BEsat-2}	Base-emitter saturation voltage	I _C =-8A, I _B =-0.4A			-1.5	V
I _{CBO}	Collector cut-off current	V _{CB} =-60V, I _E =0			-10	μA
I _{CEX}	Collector cut-off current	V _{CE} =-60V, V _{BE} =1.5V T _a =125			-10 -1.0	μA mA
I _{EBO}	Emitter cut-off current	V _{EB} =-5V, I _C =0			-10	μA
h _{FE-1}	DC current gain	I _C =-1A; V _{CE} =-2V	100			
h _{FE-2}	DC current gain	I _C =-2A; V _{CE} =-2V	100		400	
h _{FE-3}	DC current gain	I _C =-6A; V _{CE} =-2V	60			
C _{ob}	Output capacitance	I _E =0; V _{CB} =-10V, f=1MHz		230		pF
f _T	Transition frequency	I _C =-1A; V _{CE} =-10V		80		MHz

Switching times

t _{on}	Turn-on time	I _C =-6A; R _L =8.3 I _{B1} =- I _{B2} =-0.3A V _{CC} -50V			0.3	μs
t _s	Storage time				1.5	μs
t _f	Fall time				0.3	μs

◆ h_{FE-2} Classifications

M	L	K
100-200	150-300	200-400

Silicon PNP Power Transistors

2SA1443

PACKAGE OUTLINE

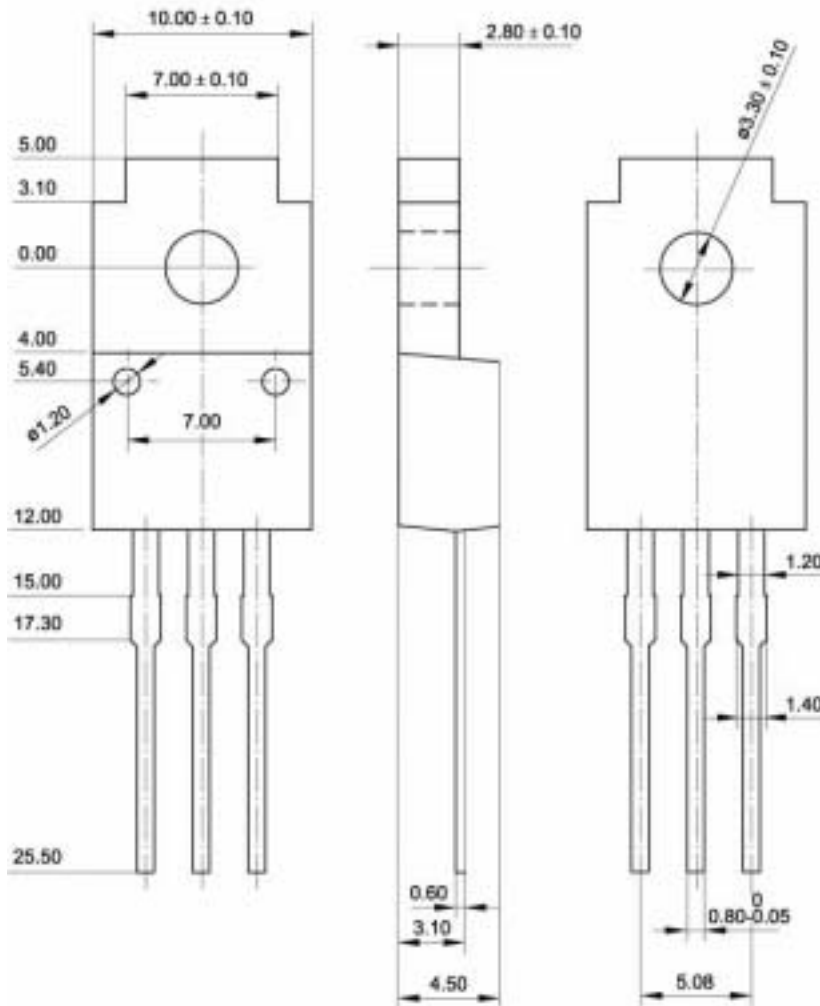

Fig.2 Outline dimensions (unindicated tolerance: ± 0.15 mm)