



# TAI-SAW TECHNOLOGY CO., LTD.

No. 3, Industrial 2nd Rd., Ping-Chen Industrial District,  
Taoyuan, 324, Taiwan, R.O.C.

TEL: 886-3-4690038 FAX: 886-3-4697532

E-mail: [tstsales@mail.taisaw.com](mailto:tstsales@mail.taisaw.com) Web: [www.taisaw.com](http://www.taisaw.com)

## Approval Sheet For Product Specification

Issued Date:

Product Name: SAW Filter 280MHz SMD 5.0x5.0mm

TST Parts No.:TA0510A

Customer Parts No.:\_\_\_\_\_

Company: _____
Division: _____
Approved by : _____
Date: _____

Checked by: \_\_\_\_\_ Elvis Chiu

Approval by: \_\_\_\_\_ Francis Chen

Date: \_\_\_\_\_ 2005/08/15



# TAI-SAW TECHNOLOGY CO., LTD.

No. 3, Industrial 2nd Rd., Ping-Chen Industrial District,  
Taoyuan, 324, Taiwan, R.O.C.

TEL: 886-3-4690038 FAX: 886-3-4697532

E-mail: [tstsales@mail.taisaw.com](mailto:tstsales@mail.taisaw.com) Web: [www.taisaw.com](http://www.taisaw.com)

## SAW Filter 280 MHz

MODEL NO.: TA0510A

REV. NO.:1

### A. MAXIMUM RATING:

1. Input Power Level: 0 dB<sub>m</sub>
2. DC voltage: 5 V
3. Operating Temperature: -10°C to +50°C
4. Storage Temperature: -40°C to +85°C

RoHS Compliant  
Lead free  
Lead-free soldering

### B. ELECTRICAL CHARACTERISTICS:

Item	Unit	Min.	Type.	Max.
Center frequency Fc	MHz	-	280	-
Insertion Loss IL <sub>max.</sub>	Fc ± 4MHz dB	-	3.0	4.5
3dB Bandwidth BW <sub>-3dB</sub>	MHz	8	12.5	-
Ripple Fc±4MHz	dB	-	0.8	2
Absolute Attenuation:(Reference level from 0dB)				
F <sub>c</sub> -100 to F <sub>c</sub> -37.5	MHz	42	53	-
F <sub>c</sub> +37.5 to F <sub>c</sub> +100	MHz	48	60	-
	dB			-
	dB			-
	dB			-

Note: IL<sub>min</sub> is the minimum of the pass band attenuation. The bandwidth BW<sub>-3dB</sub> is the difference value of the upper and lower frequencies at the 3dB filter attenuation level relative to the IL<sub>min</sub>.

### C. MEASUREMENT CIRCUIT:

HP Network analyzer

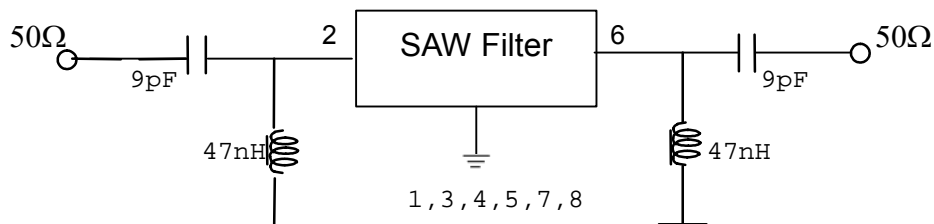

### C. FREQUENCY CHARACTERISTICS::

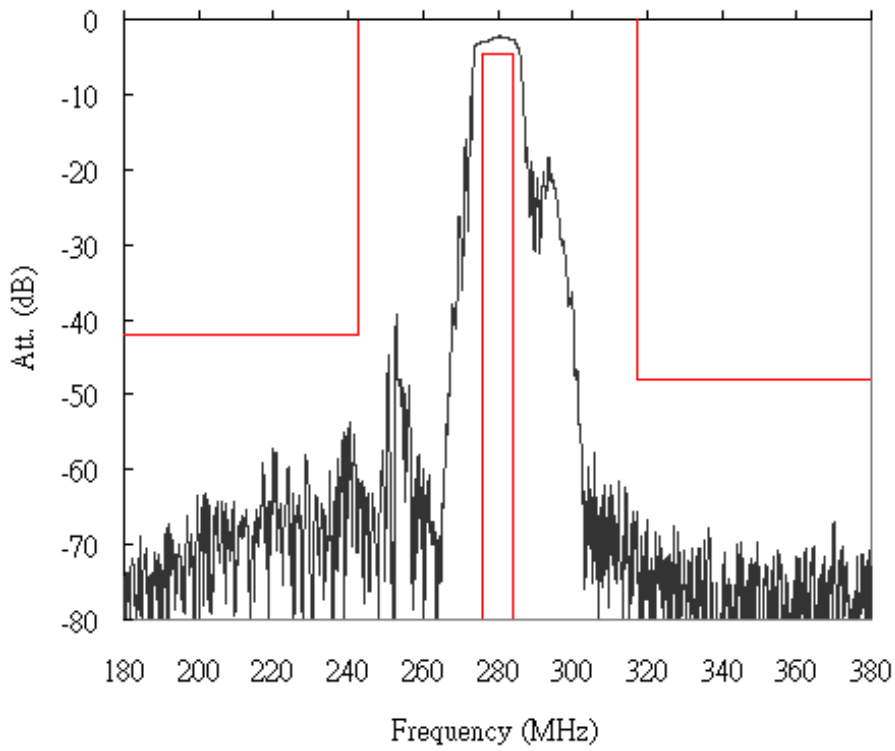
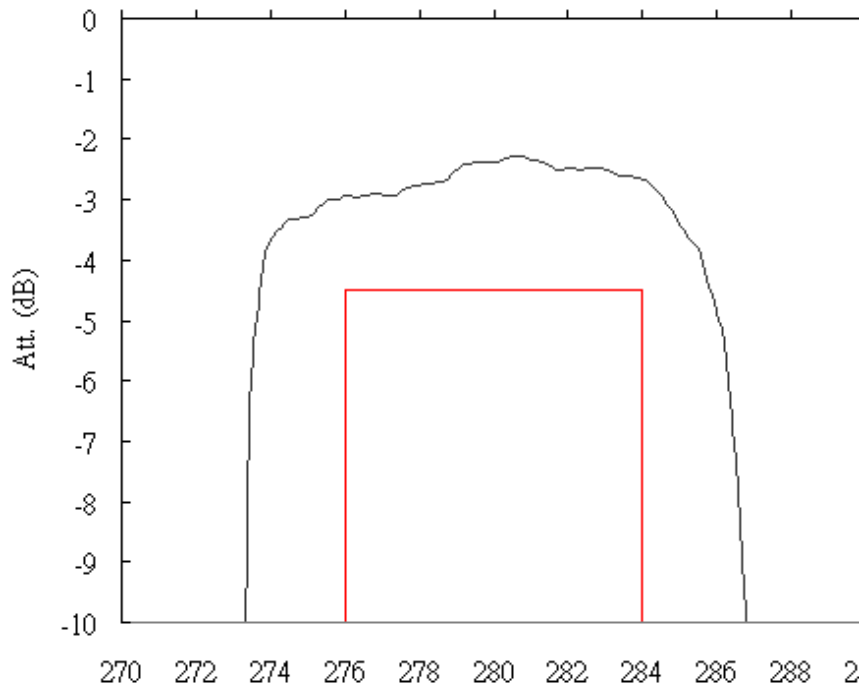

**D.OUTLINE DRAWING:**

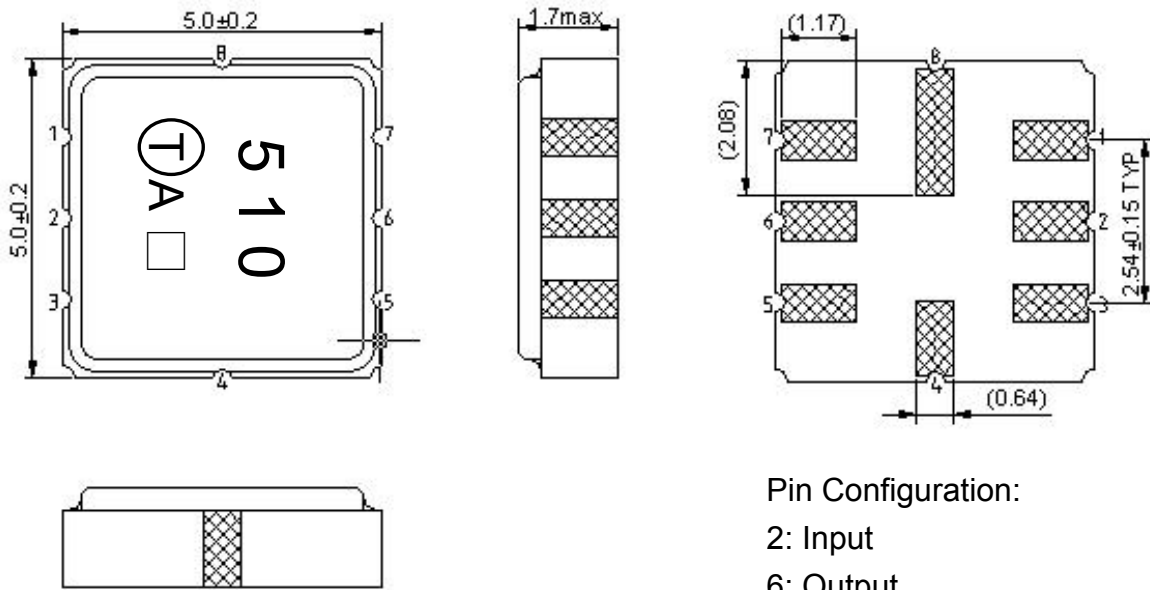

Pin Configuration:

2: Input

6: Output

1,3,4,5,7,8: Ground

□ : Date Code

Unit: mm

**E. PCB FOOTPRINT:**

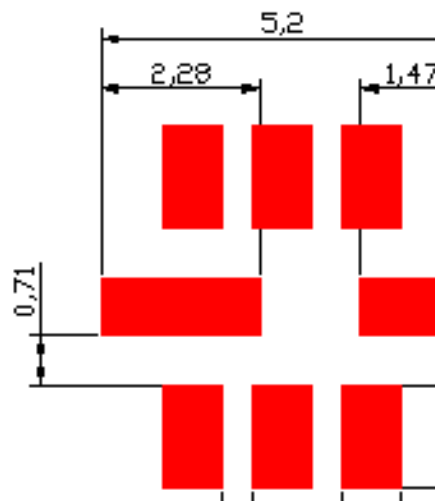

**F. PACKING:**

**1. REEL DIMENSION**

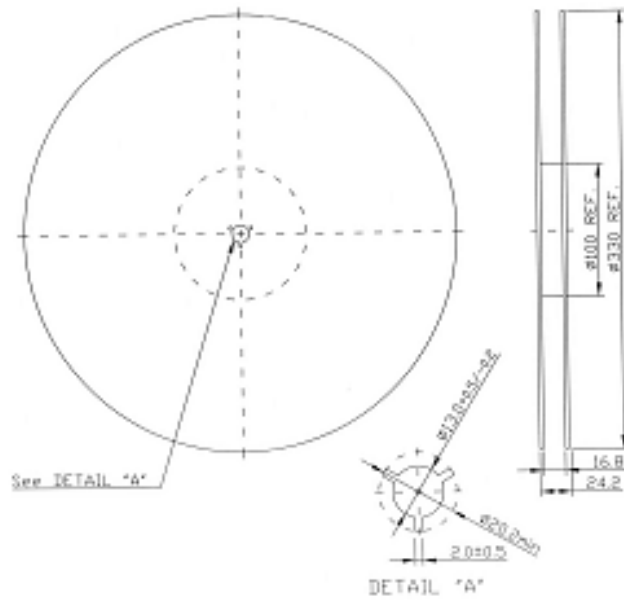

**2. TAPE DIMENSION**

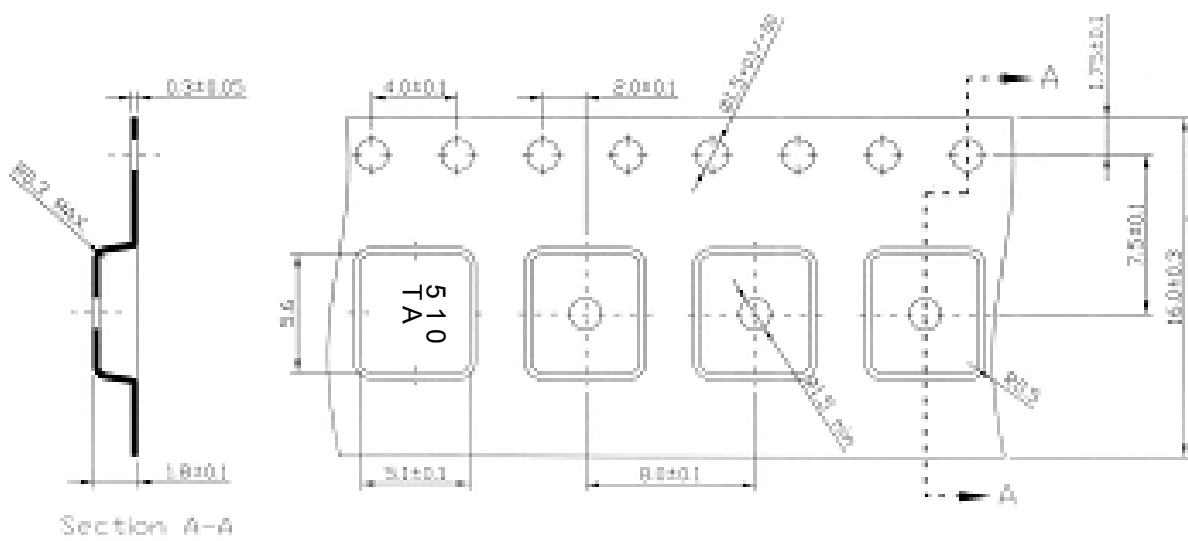

Direction of Feed

